

**Appendix A: Site and Ground Investigation Location
Plans**

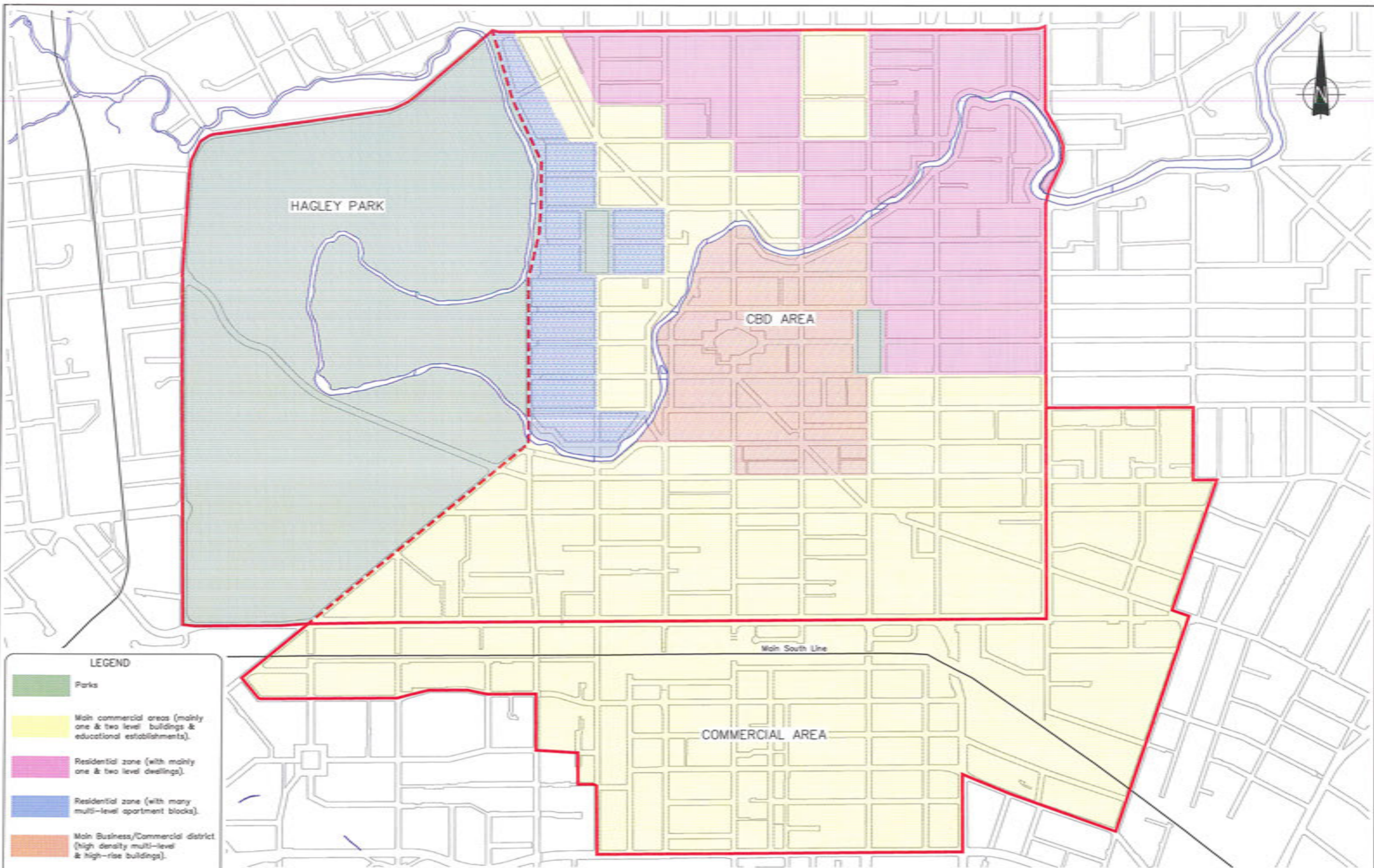

LEGEND

- Parks
- Main commercial areas (mainly one & two level buildings & educational establishments).
- Residential zone (with mainly one & two level dwellings).
- Residential zone (with many multi-level apartment blocks).
- Main Business/Commercial district (high density multi-level & high-rise buildings).

NOTES:
 1. Street map sourced from Terralink International (Copyright 2002-2005 Terralink International Limited and its licensors).

SCALE 1:12,500

0 100 200 300 400 500 600 700 800 (m)

Christchurch City Council

Tonkin & Taylor

Environmental and Engineering Consultants
 33 Parkhouse Road, Wilgan, Christchurch
 www.tonkin.co.nz

DRAWN	NSW	04.11
DRAFTING CHECKED	RAP	JJ
APPROVED	JFF	JJ
FILE	\\52000.301-A1-A2.dwg	
SCALE (AT A3 SIZE)	1:12500	
PROJECT No.	52000.301	

CHRISTCHURCH CITY COUNCIL
 GEOLOGICAL INTERPRETATIVE REPORT
 CHRISTCHURCH CENTRAL CITY
 Site Location and Land Use Plan

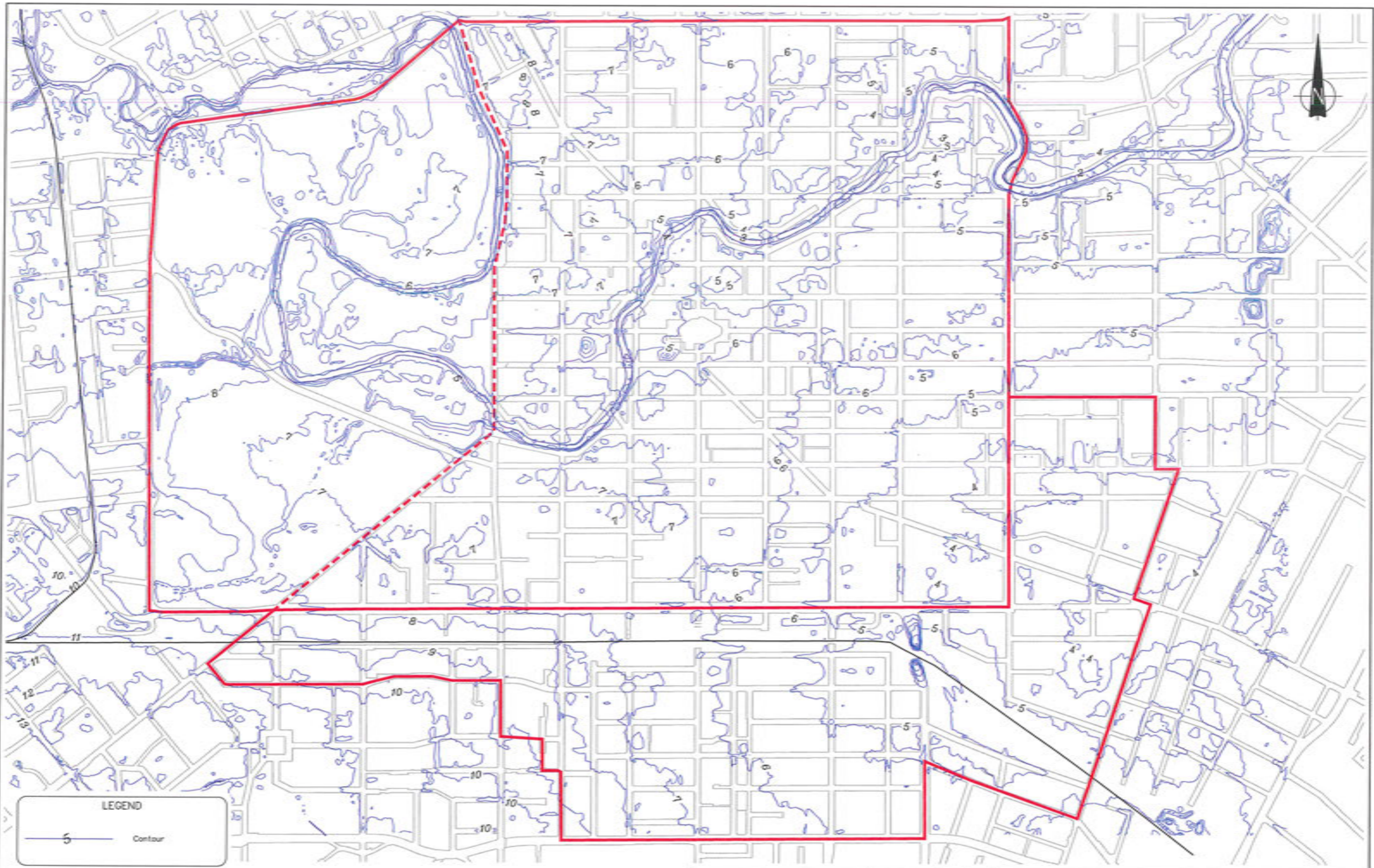

NOTES:
 1. Street map sourced from Terralink International (Copyright 2002-2005 Terralink International Limited and its licensors).
 2. Ground elevations based on LIDAR survey conducted by New Zealand Aerial Mapping (NZAM, February 2011).

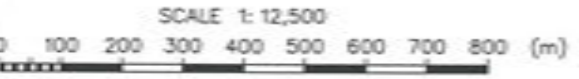

Tonkin & Taylor
 Environmental and Engineering Consultants
 33 Parkhouse Road, Wigram, Christchurch
 www.tonkin.co.nz

DRAWN	NSW	Oct. 11
DRAFTING CHECKED	RAP	27
APPROVED	APP	1
STYLE: \\S2000.301-A1-A2.dwg SCALES (AT A3 SIZE) 1: 12500 PROJECT No: S2000.301		

CHRISTCHURCH CITY COUNCIL
 GEOLOGICAL INTERPRETATIVE REPORT
 CHRISTCHURCH CENTRAL CITY
 Topographical Plan

FIG. No. A2

REV. 0

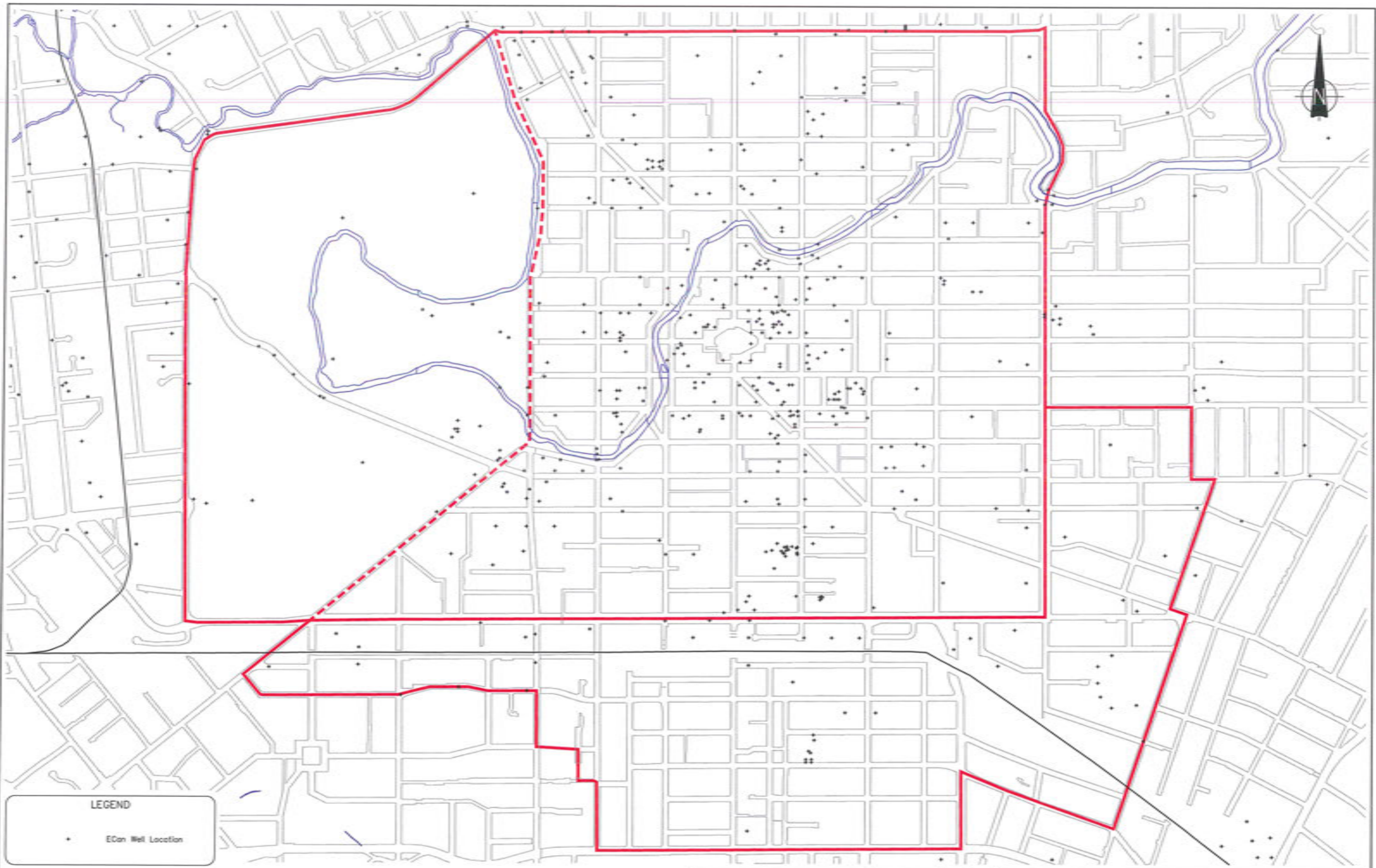

LEGEND

• ECan Well Location

NOTES:
 1. Street map sourced from Terralink International (Copyright 2002–2005 Terralink International Limited and its licensors).
 2. Well locations obtained from Environment Canterbury.
 3. See zone factual reports for Large scale location plans, well identification numbers and logs.
 4. Note that more than one well record may be present at individual locations.

SCALE 1: 12,500

0 100 200 300 400 500 600 700 800 (m)



Tonkin & Taylor
 Environmental and Engineering Consultants
 33 Parkhouse Road, Wilgram, Christchurch
 www.tonkin.co.nz

DRAWN	NSW	Oct 11
DRAFTING CHECKED	RAP	#
APPROVED	ATF	#
DATE	\\52000.301-A3-A6.dwg	
SCALE (AT A3 SIZE)	1: 12500	
PROJECT No.	52000.301	

CHRISTCHURCH CITY COUNCIL
 GEOLOGICAL INTERPRETATIVE REPORT
 CHRISTCHURCH CENTRAL CITY
 Environment Canterbury Well Locations

FIG. No. A3

REV. 0

P:\S2000\52000_3010\WorkingMaterial\CAD\52000_301-A3-A6.dwg, A4, 1/12/2011 3:58:50 p.m., nsw

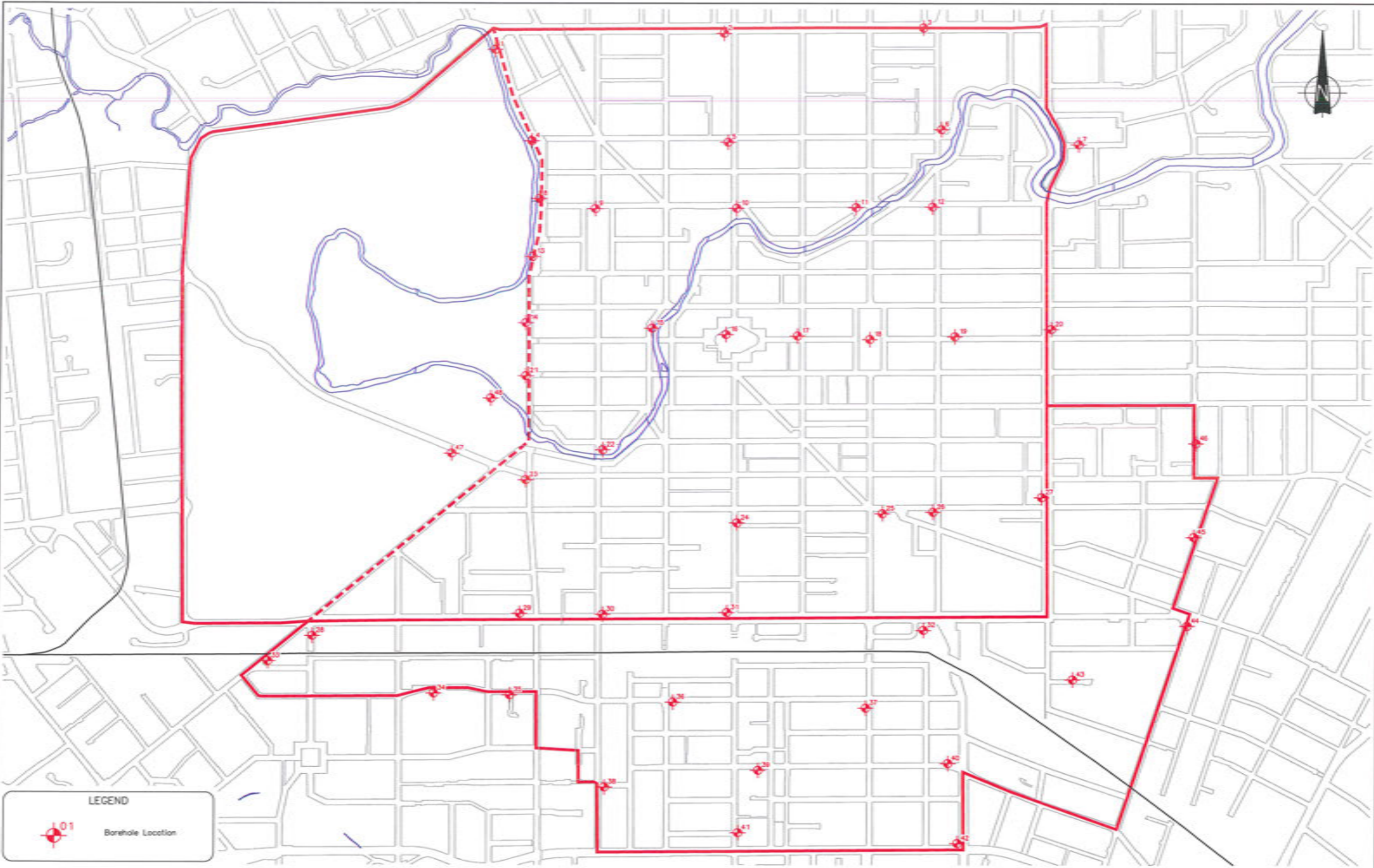

LEGEND

 Borehole Location

- NOTES:**
1. Street map sourced from Temalink International (Copyright 2002-2005 Temalink International Limited and its licensors).
 2. See Zone Factual Reports for large scale location plans and borehole logs/core photographs.
 3. All borehole numbers are prefixed by "BH-CBD-".

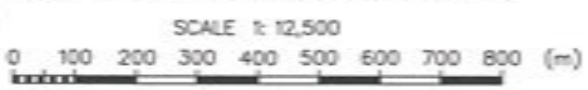

Tonkin & Taylor
 Environmental and Engineering Consultants
 33 Parkhouse Road, Wigram, Christchurch
 www.tonkin.co.nz

DRAWN	NSW	0ct.11
DRAFTING CHECKED	YAP	11
APPROVED	APP	8
DRIFILE	\\52000.301-A3-A6.dwg	
SALES (if A3 SIZE)	1:12500	
PROJECT No.	52000.301	

CHRISTCHURCH CITY COUNCIL
 GEOLOGICAL INTERPRETATIVE REPORT
 CHRISTCHURCH CENTRAL CITY
 Borehole Location Plan

P:\52000\52000_3010\WorkingMaterial\CAD\52000_301-A3-A6.dwg, A5, 1/12/2011 3:59:26 p.m., nsw

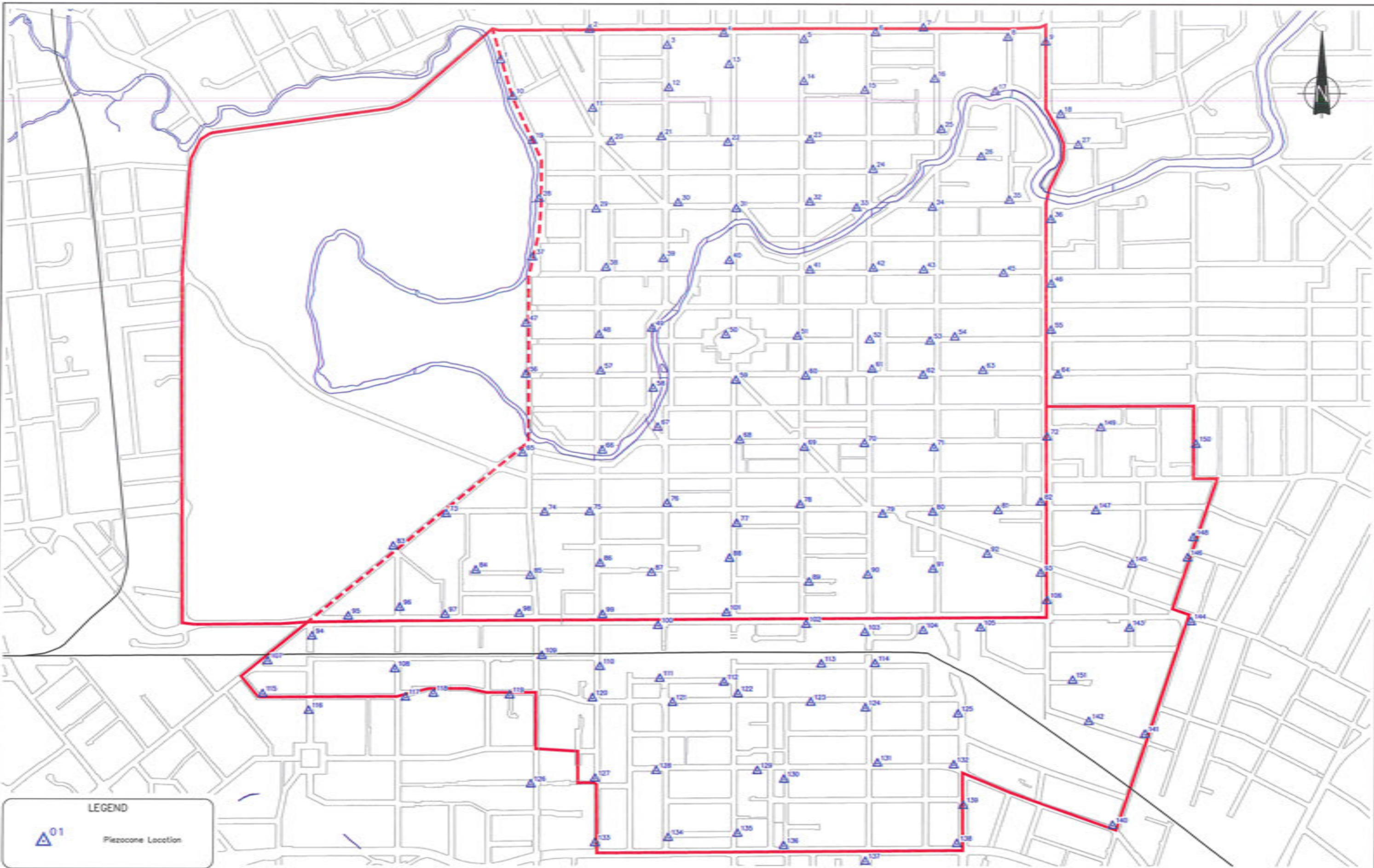

LEGEND

 Piezocone Location

- NOTES:**
1. Street map sourced from Terralink International (Copyright 2002-2005 Terralink International Limited and its licensors).
 2. See Zone Factual Reports for large scale location plan and piezocone records.
 3. All CPT numbers are prefixed by "CPT-CBD-".

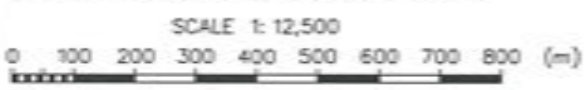

Tonkin & Taylor
 Environmental and Engineering Consultants
 33 Parkhouse Road, Wilgram, Christchurch
 www.tonkin.co.nz



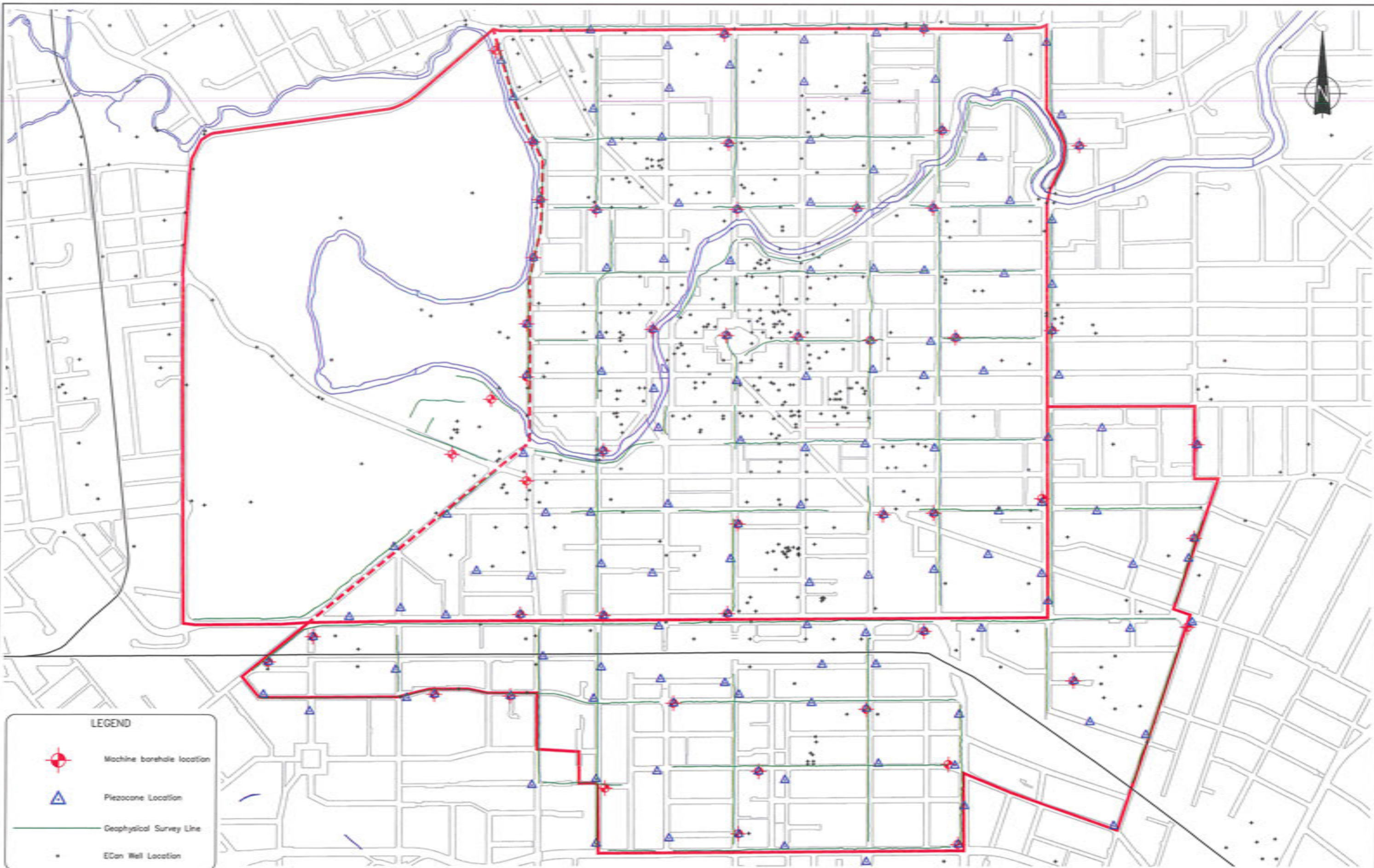

DRAWN	NSW	Oct.11
DRAWING CHECKED	MAP	11
APPROVED	AFF	8
FILE	\\52000_301-A3-A6.dwg	
SALES (AT A3 SIZE)	1: 12500	
PROJECT No.	52000.301	

CHRISTCHURCH CITY COUNCIL
 GEOLOGICAL INTERPRETATIVE REPORT
 CHRISTCHURCH CENTRAL CITY
 Piezocone Location Plan

P:\52000\52000_3000\52000_3010\WorkingMaterial\CAD\52000_301-A3-A6.dwg, A6, 1/12/2011 4:00:00 p.m., nsw



LEGEND

-  Machine borehole location
-  Piezocene Location
-  Geophysical Survey Line
-  ECan Well Location

NOTES:

1. Street map sourced from Terralink International (Copyright 2002-2005 Terralink International Limited and its licensors).
2. See Zone Factual Reports for large scale location plans.
3. See figures A8 to A11 for detailed geophysical survey location plans.

SCALE 1: 12,500

0 100 200 300 400 500 600 700 800 (m)



Tonkin & Taylor
 Environmental and Engineering Consultants
 33 Parkhouse Road, Wigram, Christchurch
 www.tonkin.co.nz

Drawn	NSW	Oct, 11
Drafting Checked	RAP	JY
Approved	RF	
Profile	52000.301-A3-A6.dwg	
Scales	[AT A3 SIZE]	
Scale	1: 12500	
Project No.	52000.301	

CHRISTCHURCH CITY COUNCIL
 GEOLOGICAL INTERPRETATIVE REPORT
 CHRISTCHURCH CENTRAL CITY
 Composite Ground Investigation Location Plan

REV. No. **A6** REV. **0**

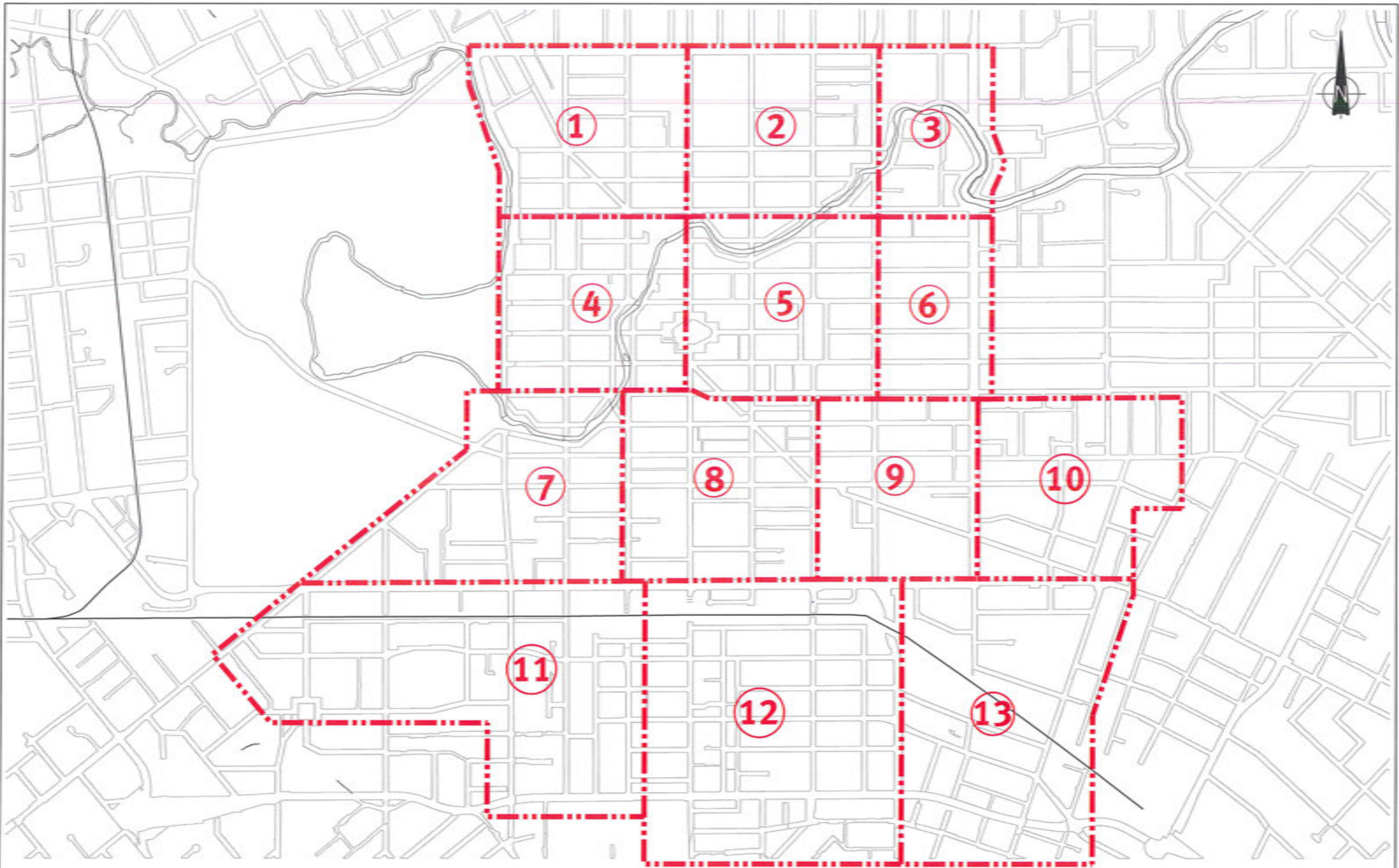

P:\52000\52000_3000\52000_3010\WorkingMaterial\CAD\CAD\52000_301-A7.dwg, A7, 5/12/2011 9:20:19 a.m., nsw

NOTES:

1. Street map sourced from Terralink International (Copyright 2002-2005 Terralink International Limited and its licensors).
2. Location of geophysical survey lines provided by Southern Geophysical Ltd (October, 2011)



Tonkin & Taylor
 Environmental and Engineering Consultants
 33 Parkhouse Road, Wilton, Christchurch
 www.tonkin.co.nz

DRAWN	NSW	Oct 11
DRAFTING CHECKED	CAF	A
APPROVED	AFF	11
PROFILE	\52000.301-A7.dwg	
SCALES	(AT A3 SIZE)	
NTS		
PROJECT No.	52000.301	

CHRISTCHURCH CITY COUNCIL
GEOLOGICAL INTERPRETATIVE REPORT
CHRISTCHURCH CENTRAL CITY
 Factual Report Zones

FIG. No. A7

REV. 0

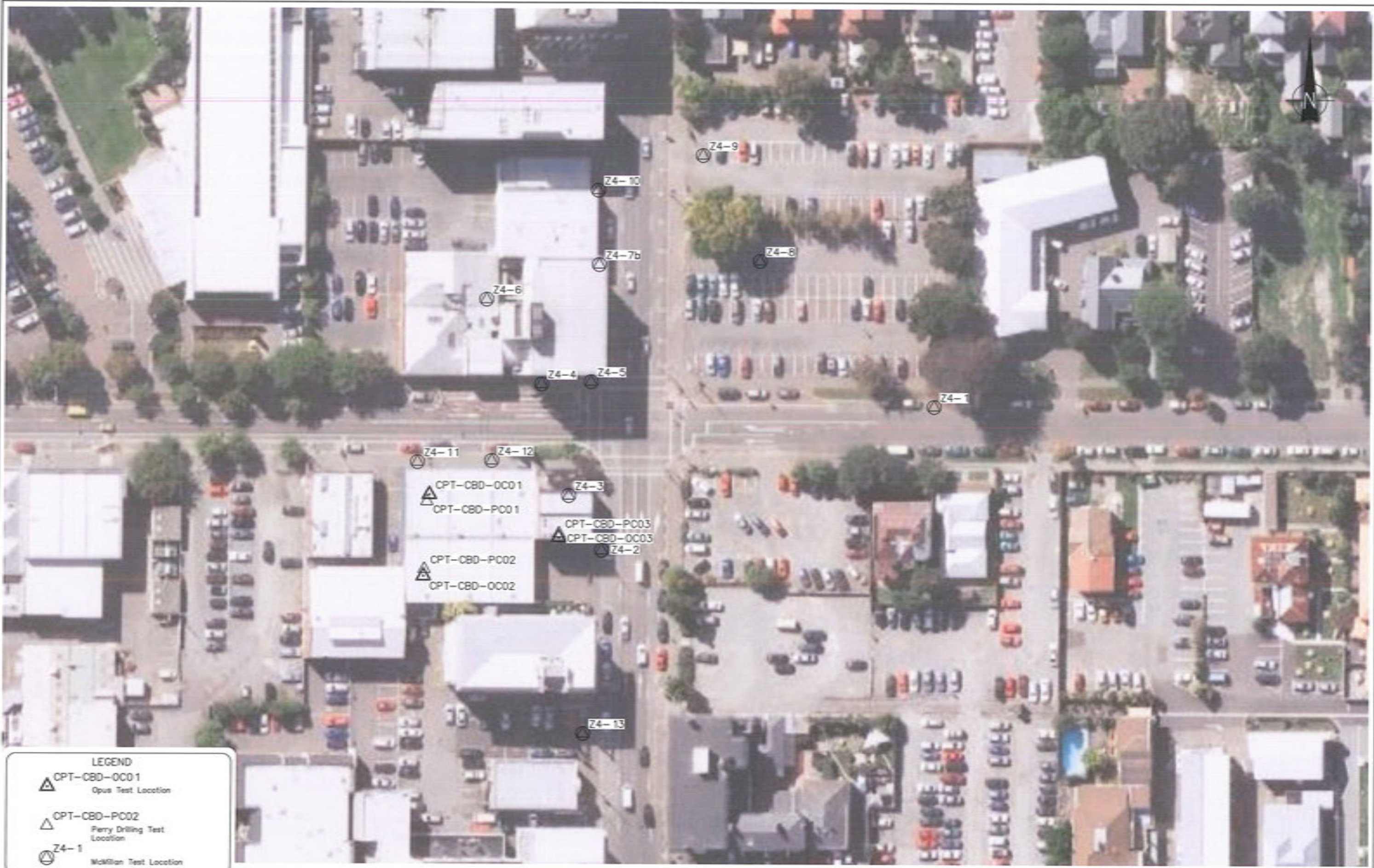

P:\52000\52000-3000\52000-3010\WorkingMaterial\CAD\CAD\52000-301-AB.dwg, A7, 5/12/2011 9:20:49 a.m., nww

LEGEND

- CPT-CBD-OC01
Opus Test Location
- CPT-CBD-PC02
Perry Drilling Test Location
- Z4-1
McMillan Test Location

NOTES:

1. Aerial image sourced from Terralink International (Copyright 2002-2005 Terralink International Limited and its licensors).
2. University of Canterbury piezocone hole locations are approximate only (not surveyed).

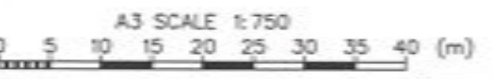

Tonkin & Taylor
Environmental and Engineering Consultants
33 Parkhouse Road, Wigram, Christchurch
www.tonkin.co.nz

DRAWN	LJD	Nov.11
DRAWING CHECKED	GH	
APPROVED	APF	
PROFILE 52000.301-AB.dwg		
SCALES (AT A3 SIZE)		
1:750		
PROJECT No.	52000.301	

CHRISTCHURCH CITY COUNCIL
GEOLOGICAL INTERPRETATIVE REPORT
CHRISTCHURCH CENTRAL CITY
Piezocone Calibration Testing Location Plan

P:\52000\52000_3010\WorkingMaterial\CAD\CAD\52000_301-A9-A12.dwg, A9, 5/12/2011 9:33:05 a.m., nzw

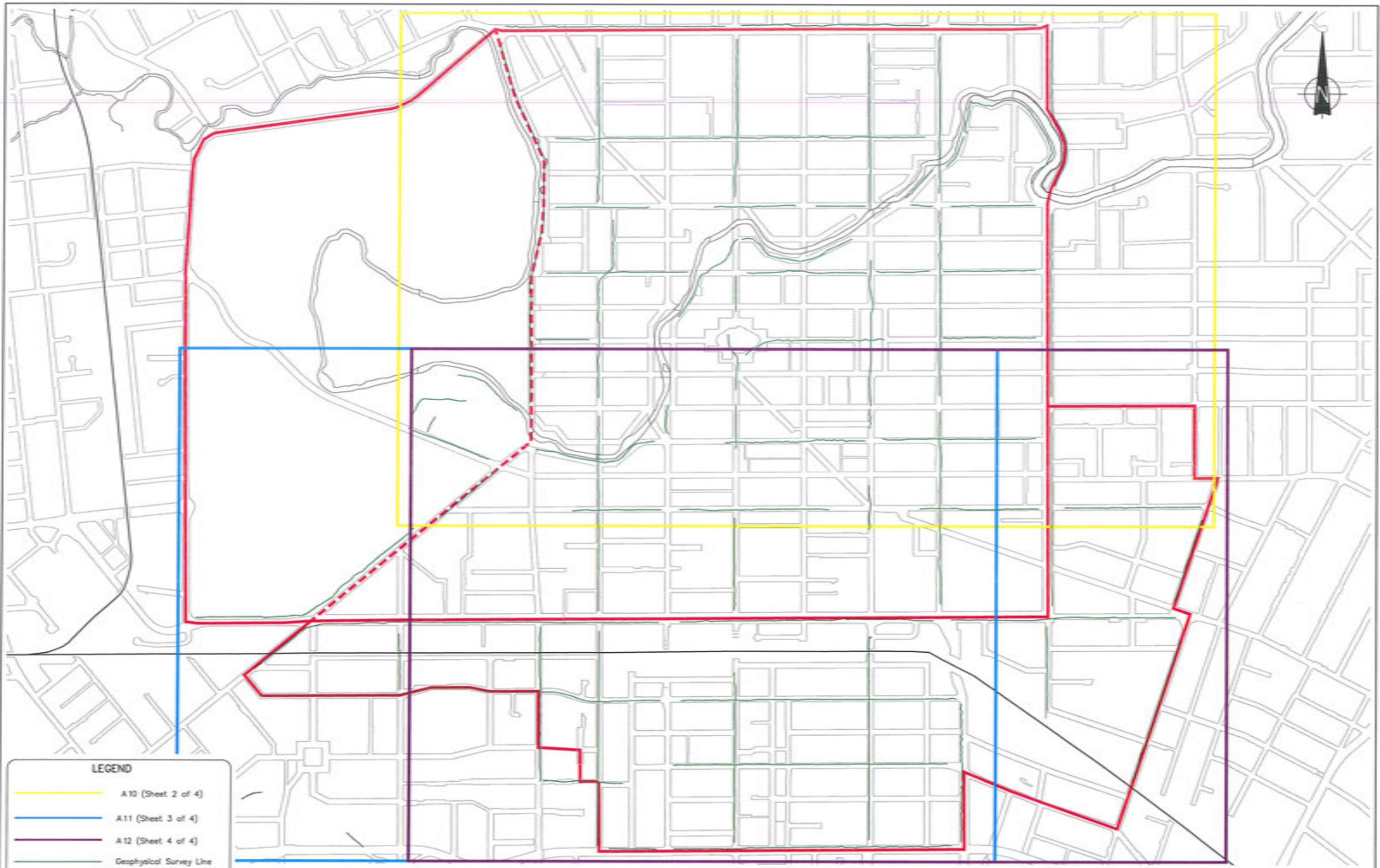

LEGEND	
	A10 (Sheet 2 of 4)
	A11 (Sheet 3 of 4)
	A12 (Sheet 4 of 4)
	Geophysical Survey Line

NOTES:
 1. Street map sourced from Terralink International (Copyright 2002-2005 Terralink International Limited and its licensors).
 2. Location of geophysical survey lines provided by Southern Geophysical Ltd (October, 2011)

SCALE 1:12,500



Tonkin & Taylor
 Environmental and Engineering Consultants
 33 Parkhouse Road, Wigram, Christchurch
 www.tonkin.co.nz

DRAWN	NSW	Oct. 11
DRAFTING CHECKED	CAF	11
APPROVED	APP	11
PROFILE	\\52000.301-A9-A12.dwg	
SCALES (at A3 size)	1:12500	
PROJECT No.	52000.301	

CHRISTCHURCH CITY COUNCIL
GEOLOGICAL INTERPRETATIVE REPORT
CHRISTCHURCH CENTRAL CITY
 Geophysical Survey Location Plan (Sheet 1 of 4)



FIG. No. **A9**

REV. **0**

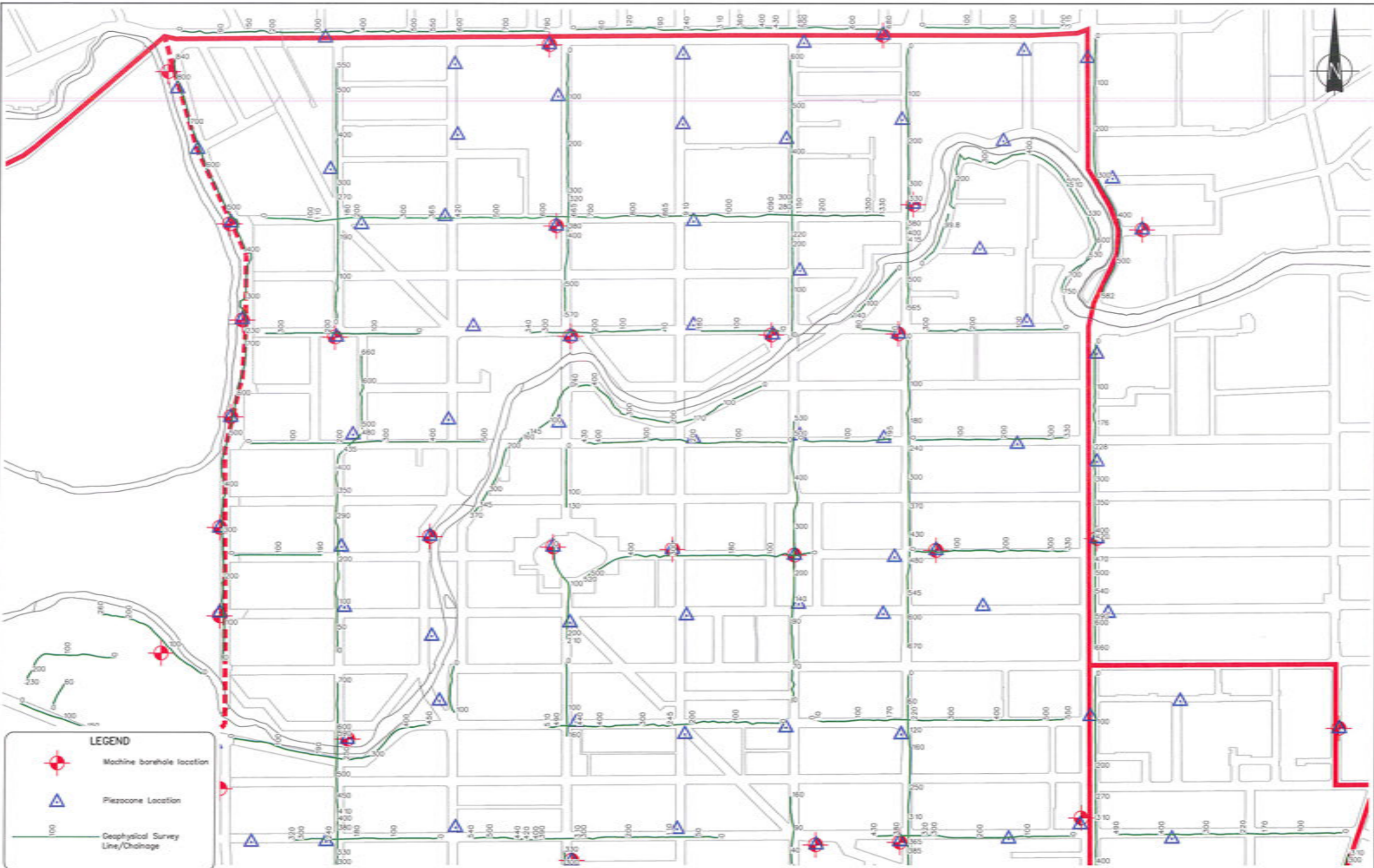
P:\52000\52000_3010\WorkingMaterial\CAD\52000_301-A9-A12.dwg, A10, 5/12/2011 9:33:52 a.m., new



LEGEND

-  Machine borehole location
-  Piezocene Location
-  Geophysical Survey Line/Chainage

NOTES:

- Street map sourced from TerraLink International (Copyright 2002-2005 TerraLink International Limited and its licensors).
- Location of geophysical survey lines provided by Southern Geophysical Ltd (October, 2011)

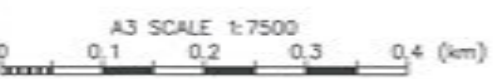

Tonkin & Taylor
Environmental and Engineering Consultants
33 Parkhouse Road, Wigram, Christchurch
www.tonkin.co.nz

DRAWN	NSW	Oct 11
DRAFTING CHECKED	CAF	11
APPROVED	AFK	11

DATE: 5/12/2011
FILE: 52000_301-A9-A12.dwg
SCALE: (AT A3 SIZE)
T: 7500
PROJECT No. 52000.301

CHRISTCHURCH CITY COUNCIL
GEOLOGICAL INTERPRETATIVE REPORT
CHRISTCHURCH CENTRAL CITY
Geophysical Survey Location Plan (Sheet 2 of 4)



FIG. No. A 10

REV. 0

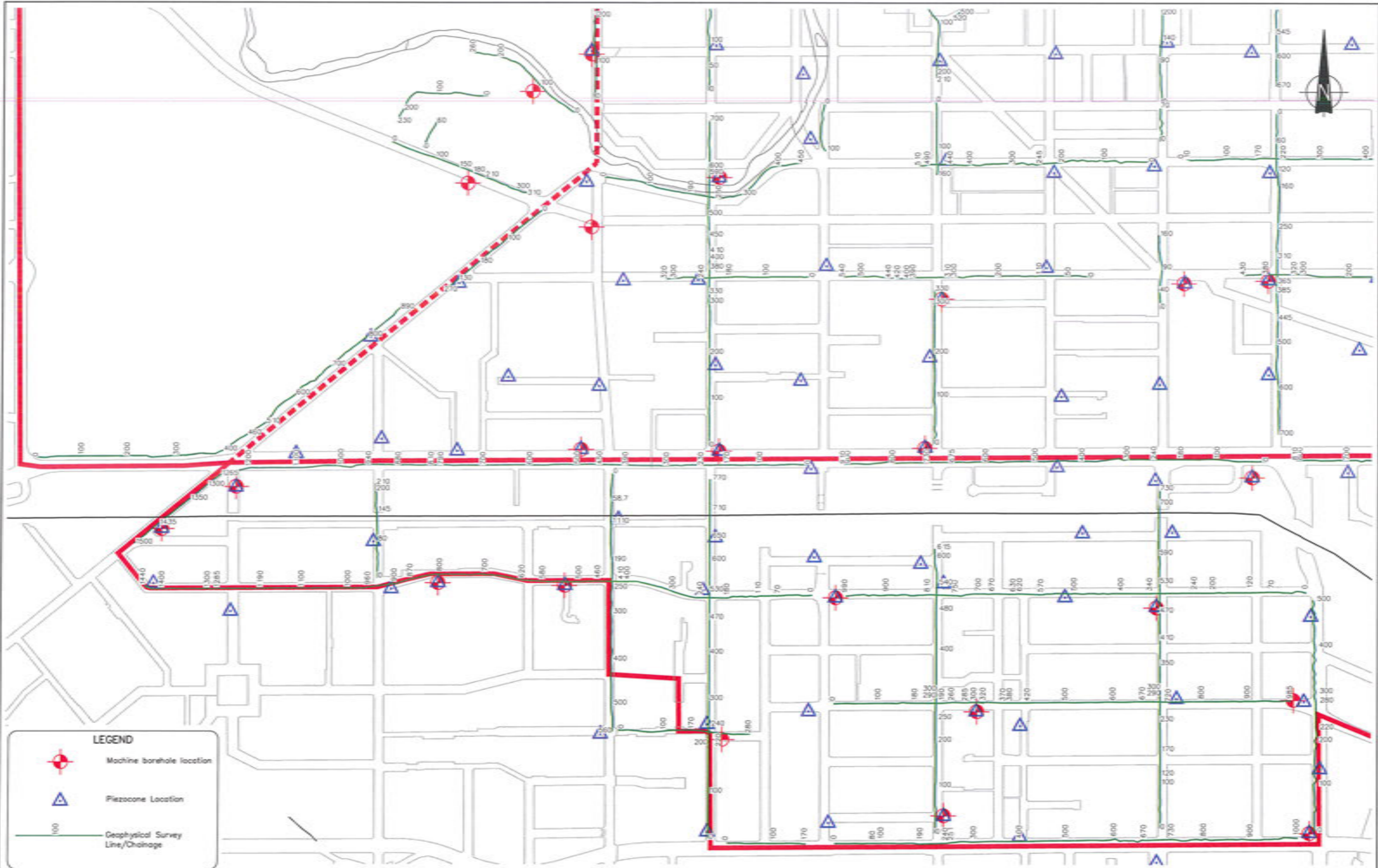
P:\52000\52000_3010\WorkingMaterial\CAD\52000_301-A9-A12.dwg, A11, 5/12/2011 9:40:47 a.m., nsw



LEGEND

-  Machine borehole location
-  Piezometer Location
-  Geophysical Survey Line/Charge

- NOTES:**
1. Street map sourced from TerraLink International (Copyright 2002-2005 TerraLink International Limited and its licensors).
 2. Location of geophysical survey lines provided by Southern Geophysical Ltd (October, 2011)

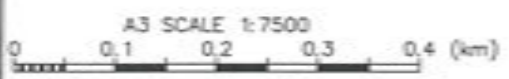

Christchurch City Council



Tonkin & Taylor

Environmental and Engineering Consultants
 23 Parkhouse Road, Wilgram, Christchurch
 www.tonkin.co.nz

Drawn	NSW	Oct 11
Drawing Checked	CAF	✓
Approved	HF	✓
CADFILE: \\52000.301-A9-A12.dwg SCALES (AT A3 SIZE) 1:7500 PROJECT No. 52000.301		



CHRISTCHURCH CITY COUNCIL
GEOLOGICAL INTERPRETATIVE REPORT
CHRISTCHURCH CENTRAL CITY
 Geophysical Survey Location Plan (Sheet 3 of 4)

FIG. No.	A11	REV.	0
----------	-----	------	---

P:\152000\52000_3010\WorkingMaterial\CAD\52000_301-A9-A12.dwg, A12, 5/12/2011 9:41:23 a.m., nsw



LEGEND

-  Machine borehole location
-  Piezometer Location
-  Geophysical Survey Line/Drainage

NOTES:
 1. Street map sourced from Terralink International (Copyright 2002-2005 Terralink International Limited and its licensors).
 2. Location of geophysical survey lines provided by Southern Geophysical Ltd (October, 2011)

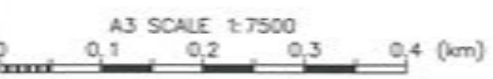

Tonkin & Taylor
 Environmental and Engineering Consultants
 33 Parkhouse Road, Wigram, Christchurch
 www.tonkin.co.nz

Drawn	NSW	Oct. 11
DRAWING CHECKED	CAF	
APPROVED	AFB	
CADFILE - \\52000.301-A9-A12.dwg SCALES (AT A3 SIZE) 1:7500 PROJECT No. 52000.301		

CHRISTCHURCH CITY COUNCIL
 GEOLOGICAL INTERPRETATIVE REPORT
 CHRISTCHURCH CENTRAL CITY
 Geophysical Survey Location Plan (Sheet 4 of 4)

REV. No. **A 12** REV. **0**



Z8-1
Z8-2
Z8-3
Z8-4

Z8-7
Z8-11
Z8-6

Z5-1
Z5-2
Z5-3
Z5-5

Z1-1
Z1-8
Z1-3

Z1-4
Z1-5
Z1-6

Z1-10
Z1-7
Z1-9

Z2-6
Z2-7
Z2-5
Z2-11

Z2-4
Z2-2b
Z2-9
Z2-10

Z2-1

Z4-10
Z4-7a&b
Z4-6
Z4-4
Z4-5
Z4-11
Z4-12
Z4-3
Z4-2
Z4-13

Z4-9
Z4-8
Z4-1

LEGEND

Z1-1 University of Canterbury Piezocone Test Location

NOTES:
1. Aerial image sourced from Terralink International (Copyright 2002-2005 Terralink International Limited and its licensors).
2. University of Canterbury piezocone hole locations are approximate only (not surveyed).

A3 SCALE 1:3000
0 30 60 90 120 150 (m)

Christchurch City Council

Tonkin & Taylor
Environmental and Engineering Consultants
33 Parkhouse Road, Wilgram, Christchurch
www.tonkin.co.nz

DRAWN	LJD	Nov 11
DRAFTING CHECKED	Chy	
APPROVED	AFK	
TITLE: \\S2000.301-A13.dwg SCALES (at A3 size) 1:3000 PROJECT No. S2000.301		

CHRISTCHURCH CITY COUNCIL
GEOLOGICAL INTERPRETATIVE REPORT
CHRISTCHURCH CENTRAL CITY
University of Canterbury Piezocone Location Plan

FIG. No. A13

REV. 0

P:\S2000\52000-3000\52000-3010\WorkingMaterial\CAD\CAD\52000-301-A13.dwg, A12, 5/12/2011 9:42:29 a.m., nww