

PROJECT NAME

WEST WATSON PARK

ADDRESS

9 Bean Street, Hillmorton, Christchurch

CLIENT

Christchurch City Council

COMMUNITY PARK TREE PLANTING STUDY

Issued date

28/02/2023



SHEET NO.	SHEET TITLE	SHEET SUBTITLE
P 00	WEST WATSON PARK	Community Park Tree Planting Study
P 01	WEST WATSON PARK	Existing Planting
P 02	WEST WATSON PARK	Tree Planting Zones
P 03	WEST WATSON PARK	Lot Boundary Cross Sections
P 04	WEST WATSON PARK	Sports Field Cross Sections
P 05	WEST WATSON PARK	Shade Study - Winter Solstice - 8 am
P 06	WEST WATSON PARK	Shade Study - Winter Solstice - 10 am
P 07	WEST WATSON PARK	Shade Study - Winter Solstice - 12 noon
P 08	WEST WATSON PARK	Shade Study - Winter Solstice - 2 pm
P 09	WEST WATSON PARK	Shade Study - Winter Solstice - 4 pm
P 10	WEST WATSON PARK	Shade Study - Winter Solstice - 6 pm
P 11	WEST WATSON PARK	Indicative Tree Planting Plan
P 12	WEST WATSON PARK	Tree Planting Guidelines



PREPARED BY



Te Uruti Building, 48 Hereford St, PO Box 2833, Christchurch 8140
Mountaineer Building, 32 Rees St, Queenstown 9300

T. 03 366 8181 E. admin@kamommarsh.co.nz W. kamommarsh.co.nz

REFERENCE NO.

5323

WEST WATSON PARK

Community Park Tree Planting

ADDRESS
9 Bean Street, Hillmorton,
Christchurch

CLIENT
Christchurch City Council

WEST WATSON PARK
Existing Planting

LEGEND

-  Existing Tree/
Vegetation
-  Sports field/ Court

REV	DATE	BY	ISSUE
E	28.02.23	JG	PRELIMINARY
D	22.02.23	JG	PRELIMINARY
C	16.01.23	JG	PRELIMINARY
B	29.11.22	JG	PRELIMINARY
A	23.11.22	TS	PRELIMINARY



Te Uruli Building, 48 Hereford St, PO Box 2833, Christchurch 8140
Mountaineer Building, 32 Rees St, Queenstown 9300

T. 03 3668 181
E. admin@kamommarsh.co.nz
W. kamommarsh.co.nz

Design TS Date 28/02/2023
Drawn TS/JG Scale 1:1000 @ A3
Check TS

REF. NO. PAGE P 01
5323 REVISION E

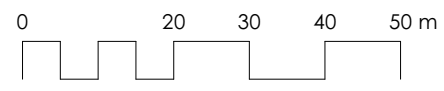
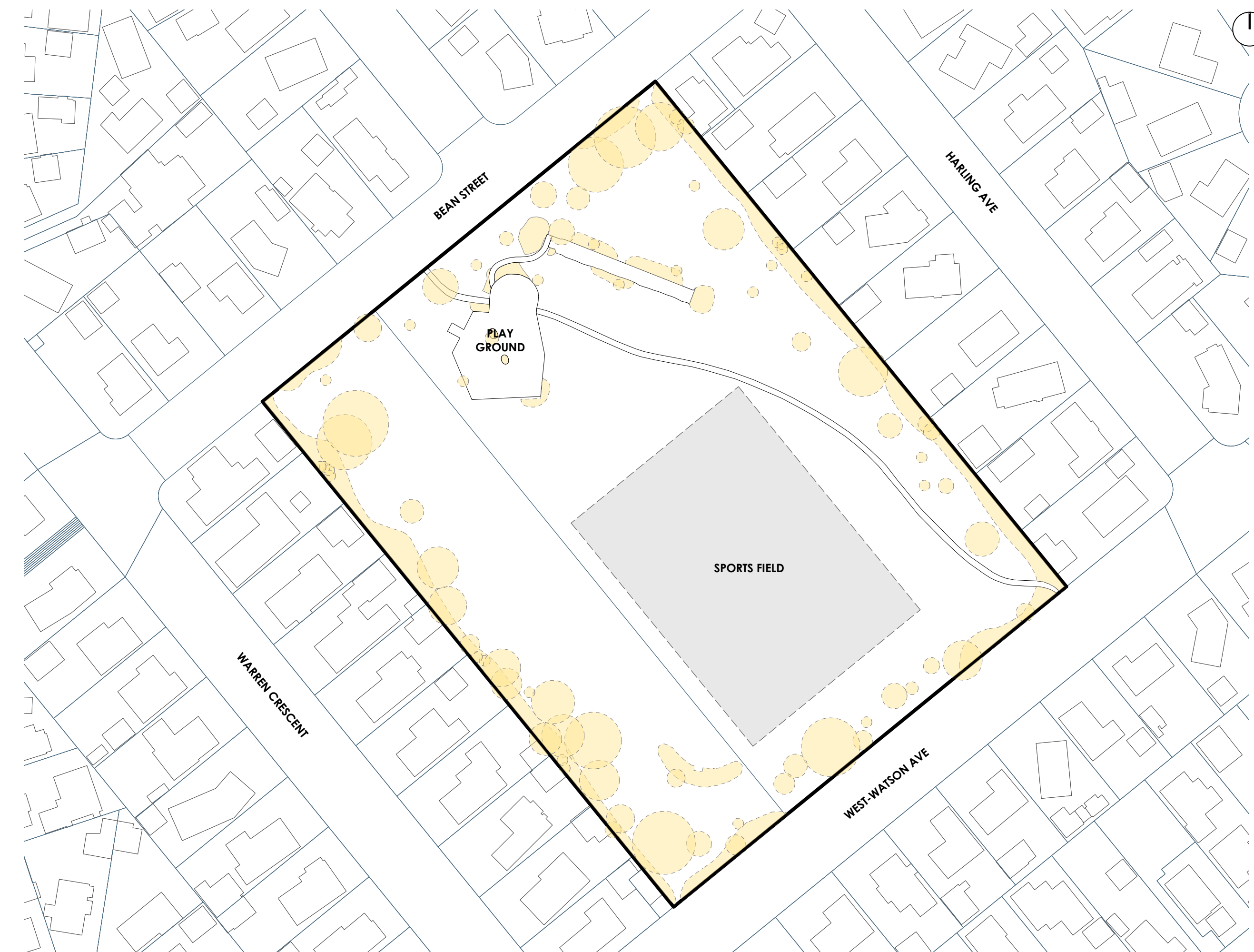

WEST WATSON PARK

Community Park Tree Planting

ADDRESS
9 Bean Street, Hillmorton, Christchurch

CLIENT
Christchurch City Council

WEST WATSON PARK
Tree Planting Zones

LEGEND

-  Existing Tree/ Vegetation
-  Sports field/ Court

Potential Tree Planting Areas

-  5m - 10m Trees Height Zone
-  10m - 20m Trees Height Zone
-  20m+ Trees Height Zone

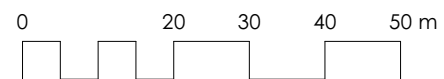
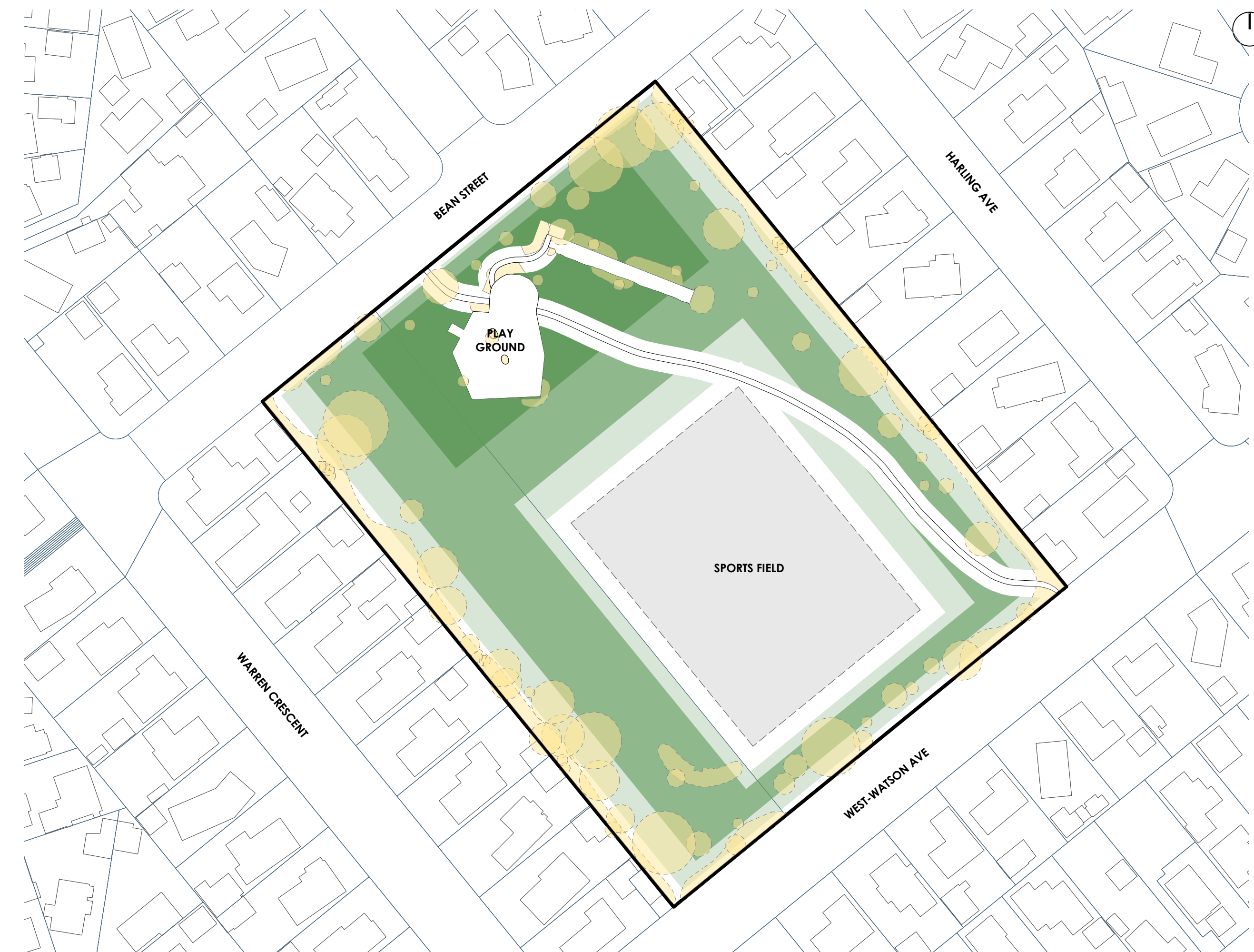

REV	DATE	BY	ISSUE
E	28.02.23	JG	PRELIMINARY
D	22.02.23	JG	PRELIMINARY
C	16.01.23	JG	PRELIMINARY
B	29.11.22	JG	PRELIMINARY
A	23.11.22	TS	PRELIMINARY



Te Uruli Building, 48 Hereford St, PO Box 2833, Christchurch 8140
Mountaineer Building, 32 Rees St, Queenstown 9300

T. 03 3668 181
E. admin@kamommarsh.co.nz
W. kamommarsh.co.nz

Design TS Date 28/02/2023
Drawn TS/JG Scale 1:1000 @ A3
Check TS

REF. NO. 5323 PAGE P 02
REVISION E



WEST WATSON PARK

Community Park Tree Planting

ADDRESS
9 Bean Street, Hillmorton,
Christchurch

CLIENT
Christchurch City Council

WEST WATSON PARK



Tree Planting Zones

Lot Boundary Cross Sections

LEGEND

-  Existing Tree/
Vegetation
-  Sports field/ Court

Potential Tree Planting Areas

-  5m - 10m
Trees Height Zone
-  10m - 20m
Trees Height Zone
-  20m+
Trees Height Zone

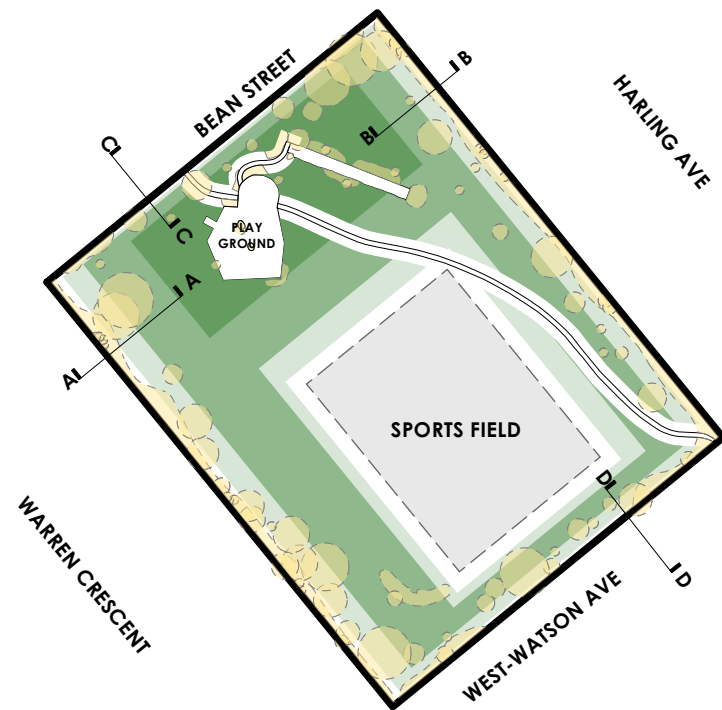

Location Plan @ 1:2000

INDICATIVE CROSS SECTION THROUGH THE BOUNDARIES

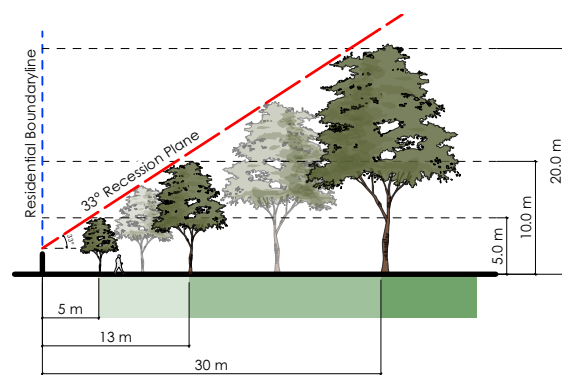

Cross Section A-A

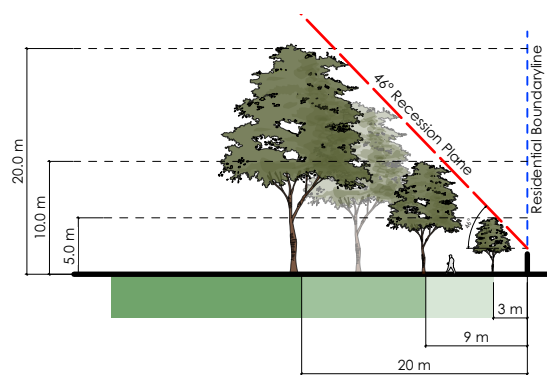

Cross Section B-B

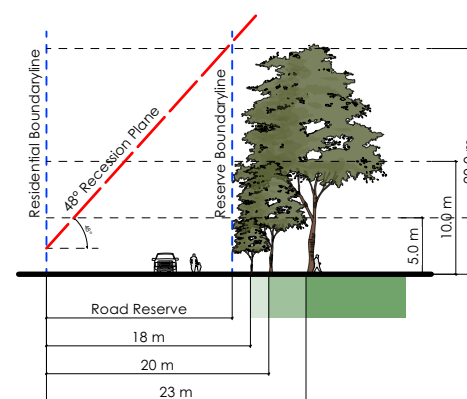

Cross Section C-C

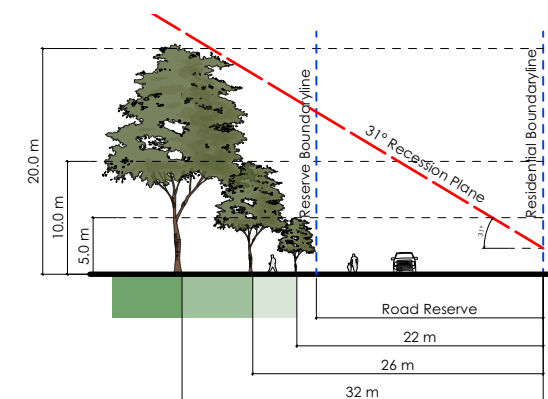

Cross Section D-D

REV	DATE	BY	ISSUE
E	28.02.23	JG	PRELIMINARY
D	22.02.23	JG	PRELIMINARY
C	16.01.23	JG	PRELIMINARY
B	29.11.22	JG	PRELIMINARY
A	23.11.22	TS	PRELIMINARY



Te Urūi Building, 48 Hereford St, PO Box 2833, Christchurch 8140
Mountaineer Building, 32 Rees St, Queenstown 9300

T. 03 3668 181
E. admin@kamommarsh.co.nz
W. kamommarsh.co.nz

Design TS
Drawn TS/JG
Check TS

Date 28/02/2023
Scale Not to scale

REF. NO. 5323
PAGE P 03
REVISION E



WEST WATSON PARK
 Community Park Tree Planting

ADDRESS
 9 Bean Street, Hillmorton,
 Christchurch

CLIENT
 Christchurch City Council

WEST WATSON PARK
 Tree Planting Zones

Sports Field Cross Sections

LEGEND

- Existing Tree/ Vegetation
- Sports field/ Court

- Potential Tree Planting Areas
- 5m - 10m Trees Height Zone
 - 10m - 20m Trees Height Zone
 - 20m+ Trees Height Zone

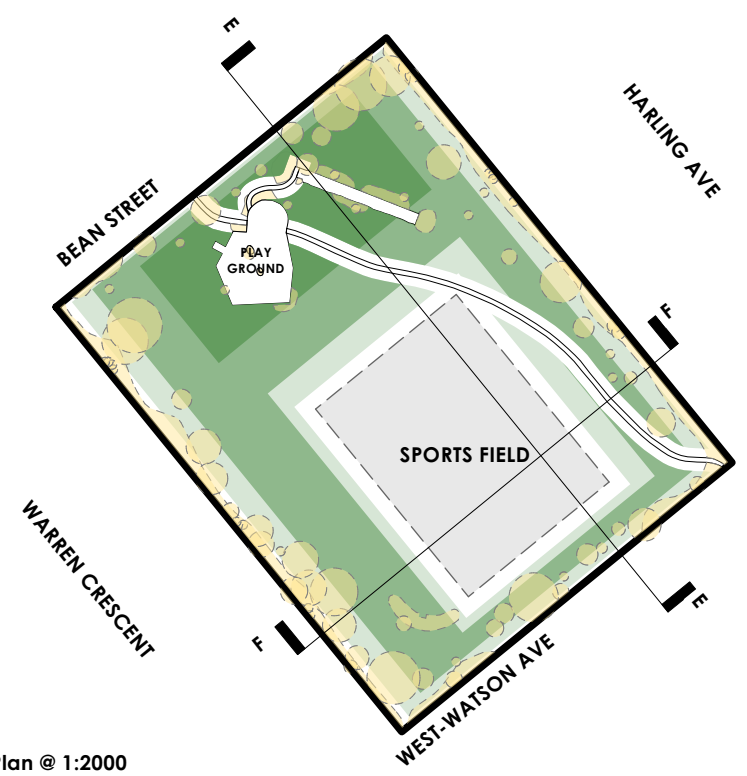

Location Plan @ 1:2000

INDICATIVE CROSS SECTION THROUGH THE SPORTS FIELD

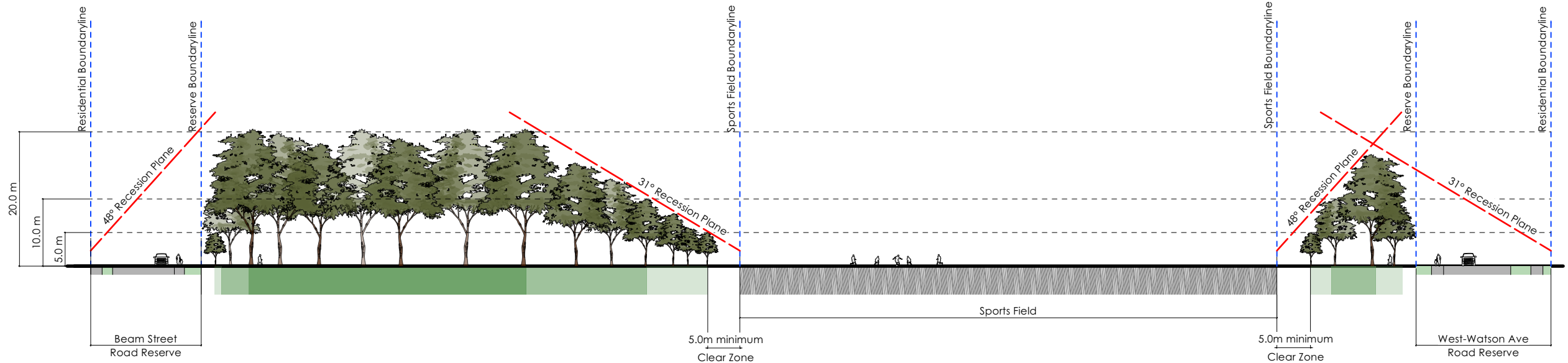

Cross Section E-E

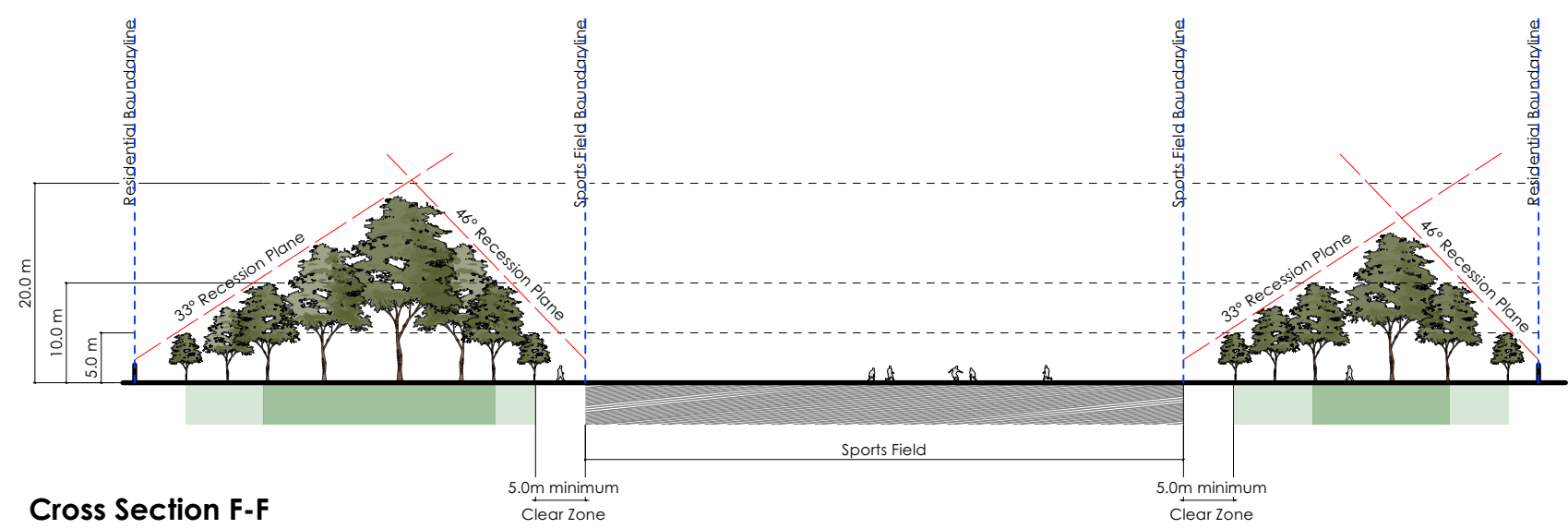

Cross Section F-F

REV	DATE	BY	ISSUE
E	28.02.23	JG	PRELIMINARY
D	22.02.23	JG	PRELIMINARY
C	16.01.23	JG	PRELIMINARY
B	29.11.22	JG	PRELIMINARY
A	23.11.22	TS	PRELIMINARY

Kamo Marsh

Te Uruli Building, 48 Hereford St, PO Box 2833, Christchurch 8140
 Mountaineer Building, 32 Rees St, Queenstown 9300

T. 03 3668 181
 E. admin@kamomash.co.nz
 W. kamomash.co.nz

Design TS	Date 28/02/2023
Drawn TS/JG	Scale Not to Scale
Check TS	
REF. NO. 5323	PAGE P 04 REVISION E

Winter Solstice

Date: 22nd June

8AM



WEST WATSON PARK Community Park Tree Planting

ADDRESS
9 Bean Street, Hillmorton,
Christchurch

CLIENT
Christchurch City Council

WEST WATSON PARK
Shade Study - Winter Solstice

8AM

Note:
Trees in the model are shown
at 5m, 10m, 20m height

REV	DATE	BY	ISSUE
E	28.02.23	JG	PRELIMINARY
D	22.02.23	JG	PRELIMINARY
C	16.01.23	JG	PRELIMINARY
B	29.11.22	JG	PRELIMINARY
A	23.11.22	TS	PRELIMINARY



Te Uruli Building, 48 Hereford St, PO Box 2833, Christchurch 8140
Mountaineer Building, 32 Rees St, Queenstown 9300

T. 03 3668 181
E. admin@kamommarsh.co.nz
W. kamommarsh.co.nz

Design TS Date 28/02/2023
Drawn TS/JG Scale Not to Scale
Check TS

REF. NO. 5323 PAGE P 05
REVISION E

Winter Solstice

Date: 22nd June

10AM



WEST WATSON PARK

Community Park Tree Planting

ADDRESS
9 Bean Street, Hillmorton,
Christchurch

CLIENT
Christchurch City Council

WEST WATSON PARK
Shade Study - Winter Solstice

10AM

Note:
Trees in the model are shown
at 5m, 10m, 20m height

REV	DATE	BY	ISSUE
E	28.02.23	JG	PRELIMINARY
D	22.02.23	JG	PRELIMINARY
C	16.01.23	JG	PRELIMINARY
B	29.11.22	JG	PRELIMINARY
A	23.11.22	TS	PRELIMINARY



Ta Ururu Building, 48 Hereford St, PO Box 2833, Christchurch 8140
Mountaineer Building, 32 Rees St, Queenstown 9300

T. 03 3668 181
E. admin@kamommarsh.co.nz
W. kamommarsh.co.nz

Design TS
Drawn TS/JG
Check TS

Date 28/02/2023
Scale Not to Scale

REF. NO.
5323

PAGE P 06
REVISION E

Winter Solstice

Date: 22nd June

12 NOON

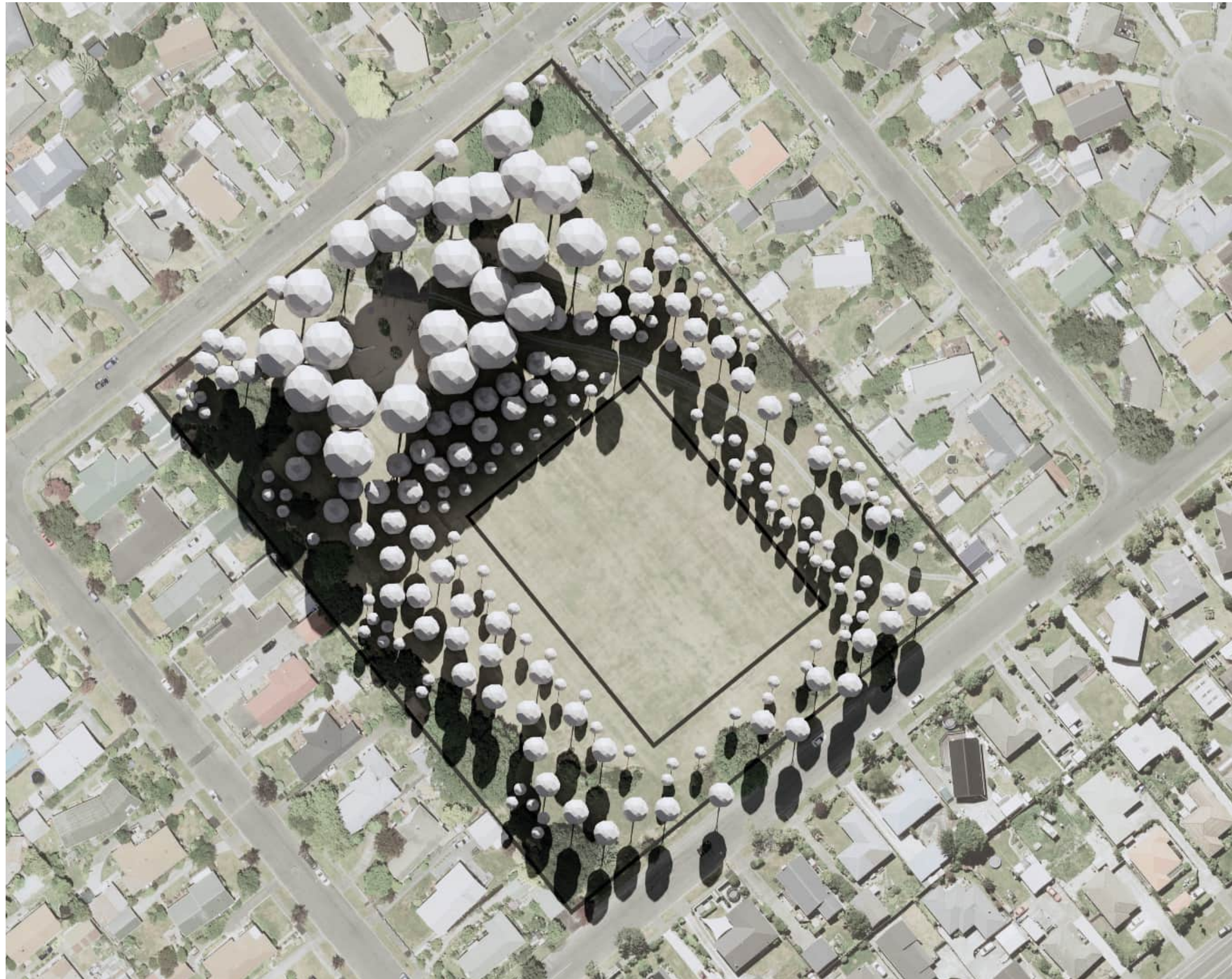

WEST WATSON PARK Community Park Tree Planting

ADDRESS
9 Bean Street, Hillmorton,
Christchurch

CLIENT
Christchurch City Council

WEST WATSON PARK
Shade Study - Winter Solstice

12NOON

Note:
Trees in the model are shown
at 5m, 10m, 20m height

REV	DATE	BY	ISSUE
E	28.02.23	JG	PRELIMINARY
D	22.02.23	JG	PRELIMINARY
C	16.01.23	JG	PRELIMINARY
B	29.11.22	JG	PRELIMINARY
A	23.11.22	TS	PRELIMINARY



Te Ururu Building, 48 Hereford St, PO Box 2833, Christchurch 8140
Mountaineer Building, 32 Rees St, Queenstown 9300

T. 03 3668 181
E. admin@kamommarsh.co.nz
W. kamommarsh.co.nz

Design TS Date 28/02/2023
Drawn TS/JG Scale Not to Scale
Check TS

REF. NO. 5323 PAGE P 07
REVISION E

Winter Solstice

Date: 22nd June

2PM



WEST WATSON PARK

Community Park Tree Planting

ADDRESS
9 Bean Street, Hillmorton,
Christchurch

CLIENT
Christchurch City Council

WEST WATSON PARK

Shade Study - Winter Solstice

2PM

Note:
Trees in the model are shown
at 5m, 10m, 20m height

REV	DATE	BY	ISSUE
E	28.02.23	JG	PRELIMINARY
D	22.02.23	JG	PRELIMINARY
C	16.01.23	JG	PRELIMINARY
B	29.11.22	JG	PRELIMINARY
A	23.11.22	TS	PRELIMINARY



Te Ururu Building, 48 Hereford St, PO Box 2833, Christchurch 8140
Mountaineer Building, 32 Rees St, Queenstown 9300

T. 03 3668 181
E. admin@kamommarsh.co.nz
W. kamommarsh.co.nz

Design TS
Drawn TS/JG
Check TS

Date 28/02/2023
Scale Not to Scale

REF. NO. 5323
PAGE REVISION P 08 E

Winter Solstice

Date: 22nd June

4PM



WEST WATSON PARK

Community Park Tree Planting

ADDRESS
9 Bean Street, Hillmorton,
Christchurch

CLIENT
Christchurch City Council

WEST WATSON PARK
Shade Study - Winter Solstice

4PM

Note:
Trees in the model are shown
at 5m, 10m, 20m height

REV	DATE	BY	ISSUE
E	28.02.23	JG	PRELIMINARY
D	22.02.23	JG	PRELIMINARY
C	16.01.23	JG	PRELIMINARY
B	29.11.22	JG	PRELIMINARY
A	23.11.22	TS	PRELIMINARY



Ta Ururu Building, 48 Hereford St, PO Box 2833, Christchurch 8140
Mountaineer Building, 32 Rees St, Queenstown 9300

T. 03 3668 181
E. admin@kamommarsh.co.nz
W. kamommarsh.co.nz

Design TS Date 28/02/2023
Drawn TS/JG Scale Not to Scale
Check TS

REF. NO. 5323 PAGE P 09
REVISION E

Winter Solstice

Date: 22nd June

6PM



WEST WATSON PARK Community Park Tree Planting

ADDRESS
9 Bean Street, Hillmorton,
Christchurch

CLIENT
Christchurch City Council

WEST WATSON PARK
Shade Study - Winter Solstice

6PM

Note:
Trees in the model are shown
at 5m, 10m, 20m height

REV	DATE	BY	ISSUE
E	28.02.23	JG	PRELIMINARY
D	22.02.23	JG	PRELIMINARY
C	16.01.23	JG	PRELIMINARY
B	29.11.22	JG	PRELIMINARY
A	23.11.22	TS	PRELIMINARY



Te Uruli Building, 48 Hereford St, PO Box 2833, Christchurch 8140
Mountaineer Building, 32 Rees St, Queenstown 9300

T. 03 3668 181
E. admin@kamommarsh.co.nz
W. kamommarsh.co.nz

Design TS Date 28/02/2023
Drawn TS/JG Scale Not to Scale
Check TS

REF. NO. 5323 PAGE P 10
REVISION E

WEST WATSON PARK

Community Park Tree Planting

ADDRESS
9 Bean Street, Hillmorton, Christchurch

CLIENT
Christchurch City Council

WEST WATSON PARK
Indicative Tree Planting Plan

LEGEND

-  Existing Tree/ Vegetation
-  Sports field/ Court

Potential Tree Planting Areas

-  5m - 10m Trees Height Zone
-  10m - 20m Trees Height Zone
-  20m+ Trees Height Zone

PLANT SCHEDULE - EST WATSON PARK

ID	Qty	Botanical Name	Common Name
TREE HEIGHT 5-10M			
Ac.b.	5	Acer buergerianum	Trident Maple
Ar. s.	10	Aristotelia serrata	Wineberry/Makamako
Ch.v.	3	Chionanthus virginicus	Fringe Tree
Co.ro.	3	Coprosma robusta	Karamu
Fr.s.	13	Fraxinus sieboldiana	Siebold Ash
Gr.lu.	7	Griselinia lucida	Puka/Broadleaf
My.a.	5	Myrsine australis	Red Matipo
My.l.	5	Myoporum laetum	Ngaio
Pi.t.	7	Pittosporum tenuifolium	Kohuhu
Pr.c.N.	8	Prunus cerasifera 'Nigra'	Flowering Plum
Pr.y.	9	Prunus yedoensis	Flowering Cherry
Ps.co	9	Pseudowintera colorata	Mountain hotopito
Py.c.A.	8	Pyrus calleryana 'Aristocrat'	Ornamental Pear
So.mi.	11	Sorbus microphylla	Small Leaf Rowan
TREE HEIGHT 11-15M			
Al.i.	8	Alnus incana	Grey Alder
Ca.be.	7	Carpinus betulus	European Hornbeam
Pl.r.	14	Plagianthus regius	Ribbonwood / Manatu
TREE HEIGHT 16-20M			
Al.e.	5	Alectryon excelsus	NZ oak/titoki
Co.a.	6	Cordyline australis	Cabbage tree / Ti Kouka
El.d.	1	Elaeocarpus dentatus	Hinau
Ho.a.	6	Hoheria angustifolia	Narrow leafed lacebark / Houhere
Li.f.	3	Liquidambar formosana	Formosan Gum
Pi.eu.	3	Pittosporum eugenioides	Lemonwood / Tarata
So.m.	5	Sophora microphylla	Kowhai
TREE HEIGHT 20M+			
Fr.or.	2	Fraxinus ornus	Manna Ash
Pl.ac.	1	Platanus x acerifolia	London Plane
Po.t.	4	Podocarpus totara	Totara

Note:
Contractor to confirm service and irrigation locations using on site service locators prior to commencing work.

REV	DATE	BY	ISSUE
E	28.02.23	JG	PRELIMINARY
D	22.02.23	JG	PRELIMINARY
C	16.01.23	JG	PRELIMINARY
B	29.11.22	JG	PRELIMINARY
A	23.11.22	TS	PRELIMINARY



Te Uruli Building, 48 Hereford St, PO Box 2833, Christchurch 8140
Mountaineer Building, 32 Rees St, Queenstown 9300

T. 03 3668 181
E. admin@kamommarsh.co.nz
W. kamommarsh.co.nz

Design TS
Drawn TS/JG
Check TS

Date 28/02/2023
Scale 1:1000@A3

REF. NO. 5323
PAGE REVISION P 11 E

WEST WATSON PARK	
Park Canopy Cover Summary	
Existing number of trees	77
Existing canopy cover	approx. 20%
Proposed number of new trees	168
Proposed net canopy cover (existing vegetation and proposed)	approx. 61%

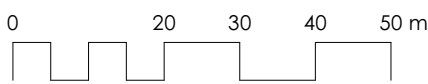
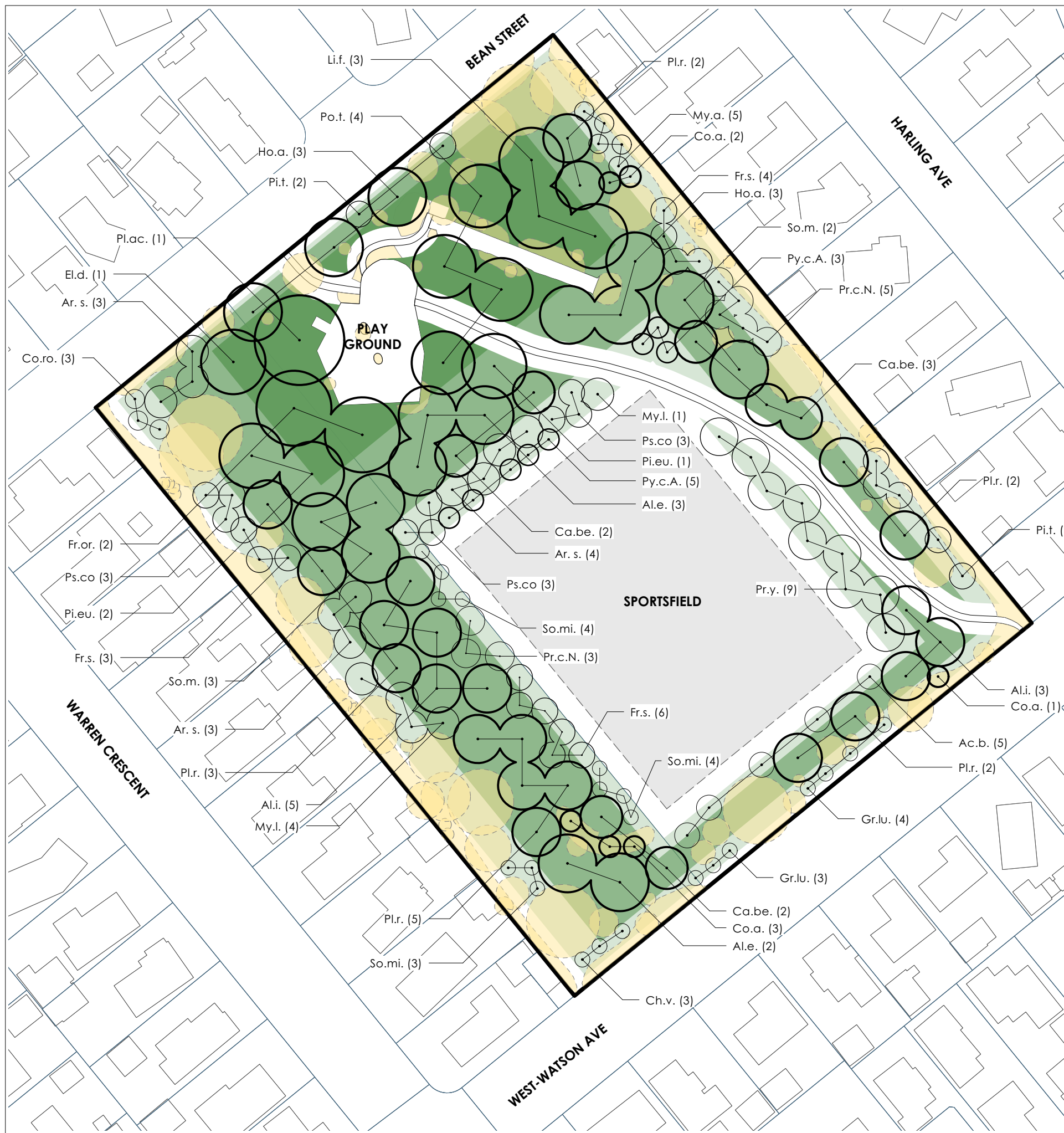



WEST WATSON PARK

Community Park Tree Planting

ADDRESS
9 Bean Street, Hillmorton,
Christchurch

CLIENT
Christchurch City Council

WEST WATSON PARK
Tree Planting Guidelines

LEGEND

- Existing Tree/ Vegetation
- Sports field/ Court

Potential Tree Planting Areas

- 5m - 10m Trees Height Zone
- 10m - 20m Trees Height Zone
- 20m+ Trees Height Zone

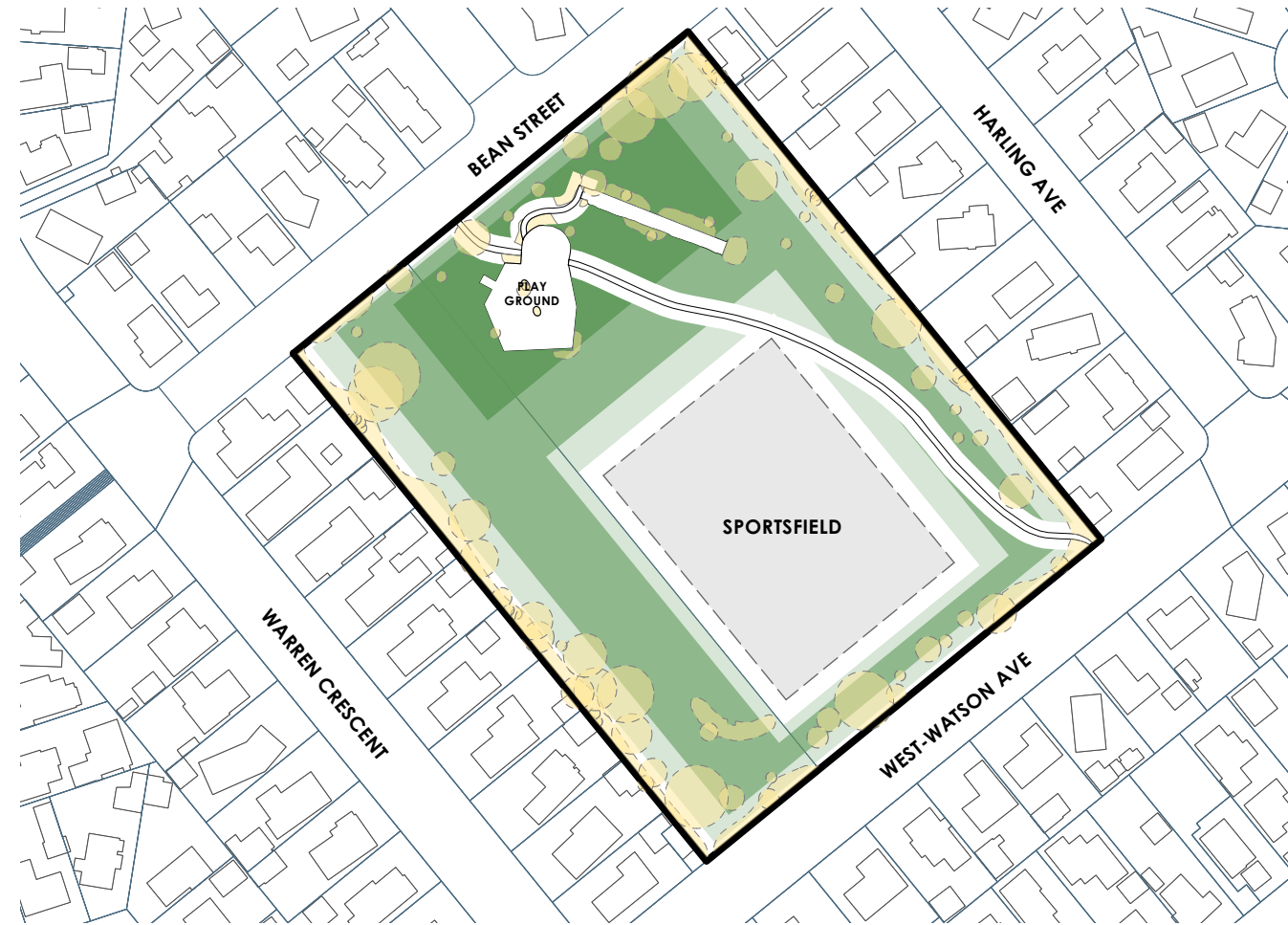

Guideline Summary

- Tree planting to Special Character Parks will continue the established theme.
- Trees will be positioned appropriately to allow for debris management.
- Tree species shall be well suited to the local conditions.
- Planting along waterways will be predominantly native species.
- CCC will aim for 40-60% of new tree plantings as natives.

Tree Setbacks & Spacings

- No tree shall intrude through the recession plane.
- No tree shall be planted closer than 3.0m from a pathway.
- No tree shall be planted closer than 5.0m from a sports field and no tree canopy drip line shall extend above a sports field.
- Tree spacings shall be a minimum of 5.0m apart to allow for easy lawn mowing.
- Min. 2m offset for low voltage power
- Min. 3m offset for 11kv power
- Min. 5m offset for 33-66kv
- Min. 1m offset for all other services and hard paving not mentioned above.

Typical tree planting pattern

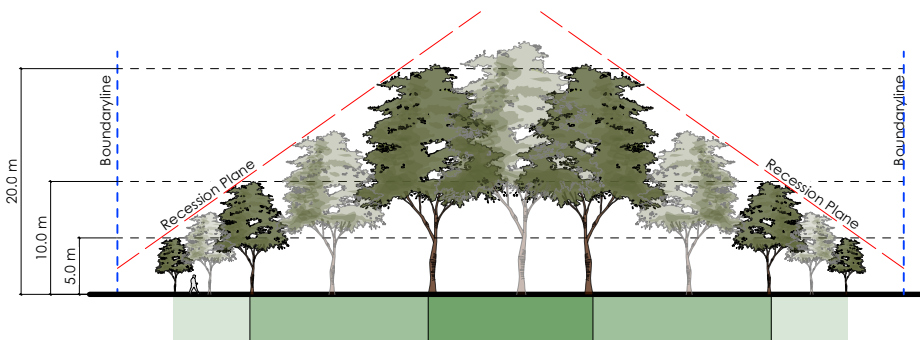

REV	DATE	BY	ISSUE
E	28.02.23	JG	PRELIMINARY
D	22.02.23	JG	PRELIMINARY
C	16.01.23	JG	PRELIMINARY
B	29.11.22	JG	PRELIMINARY
A	23.11.22	TS	PRELIMINARY



Te Uruli Building, 48 Hereford St, PO Box 2833, Christchurch 8140
Mountaineer Building, 32 Rees St, Queenstown 9300

T. 03 3668 181
E. admin@kamommarsh.co.nz
W. kamommarsh.co.nz

Design TS
 Drawn TS/JG
 Check TS

Date 28/02/2023
 Scale Not to Scale

REF. NO. 5323
 PAGE REVISION P 12 E