

## Organisations

Submission ID	Support/ do not support	Comments - Please be as specific as possible to help us understand your views	Name	Organisation and role
42030	Yes	I am part of the group that would like to see this used as a community garden and I see it as a very valuable community asset. The location is central for people to walk or bike to and is close to the school so there can be a cross over here, where the teachers and children could visit.	John Grater	john grater member of diamond harbour community garden group
44037	Yes	The Christchurch Envirohub provide support to environmental and community groups in the wider Christchurch area. I live in the Diamond Harbour area and will be able to support development of the community garden as a local resident and by providing connections and inspirations through the Christchurch Envirohub. The main purpose of a community garden is to not only develop a food resilience for a community but mostly to bring a community together. It is very important any oppositions are understood and solutions are agreed before proceeding. Diamond Harbour has a strong and connected community, the last thing we want is to create a community divide.	Katrina Miller	Christchurch Envirohub Network Coordinator
43855	No	<p>Hi, I am submitting on behalf of the Diamond Harbour Volunteer Fire Brigade. We are not submitting on the merits or otherwise of the proposed project, rather we submit on the effect it will have on the Emergency Services operational response in our area of responsibility. We currently have no formal permissions or authority over the use of Laurenson Park but we have had a long held use of the park in the following situations.</p> <ol style="list-style-type: none"> <li>1. Our Brigade in partnership with St John frequently use the park as a "Landing Zone" for the Rescue Helicopter. The area is ideal in that it is safe for use 24 hours a day. Seriously injured or ill patients are transported to the park for "medivac" to Christchurch Hospital. This park area is ideal in that it has space, openness and no existing hazards affecting the helicopter. It is easy to "secure" when needed.</li> <li>2. It is used as a "water refill" zone for helicopters when dealing with larger scrub fires. The park has two large hydrants available close by that are used to support a refill function for the helicopters monsoon buckets. With the arrival of helicopters fitted with under-belly water tanks, these are able to refill from a temporary portable dam we set up in the park. We practice these operations frequently.</li> <li>3. Because of the nature of the topography in Diamond Harbour and and Bays, the brigade uses the park itself as a training ground. Not only to practice medivacs or monsoon bucket refills, but general drills and various other spontaneous scenarios.</li> </ol> <p>It has been suggested that an area for a "Landing Zone" could be established within the current proposal. Our thoughts around this include the face that "Landing Zones" need to be as debris free as possible. It is felt that a helicopter landing in this sort of mixed use area would be endangered by the amount of loose material associated with gardening, and would blow chip, soil, bags, dirt and plants in all directions. All of this is dangerous for helicopters and personnel managing an operation there.</p> <p>It has been suggested that the school playground nearby could be a "Landing Zone" for all the above three reasons, but against this are the facts that our appliances are unable to drive into the grounds due to buildings now restricting our access, and we would need to manage large numbers of children when using this during school hours (not at all ideal). Even after hours the school grounds are well used by nearby children and their families.</p> <p>So whilst we have no position, as a brigade, on the merits or otherwise of a community garden we felt it important for your decision making to be aware of the impact of such a proposal for use of this land by emergency services.</p> <p>Clearly we would try and identify other areas in the vicinity but these would not fit our requirements for all the above operational needs.</p>	Bob Palmer	Fire and Emergency NZ - Diamond Harbour Fire Brigade Chief Fire Officer

## Individuals

### Support - no comments

Submission ID	Support/ do not support	Name
42624	Yes	Cody Cooper
41871	Yes	Williamson Beth
42078	Yes	marilyn wells
41986	Yes	Bob Frame
41937	Yes	Denise Kidd
41882	Yes	Olivia Sinclair
41881	Yes	Ingrid Willis
41875	Yes	Coultas Matthew
41867	Yes	Janice Collins
41857	Yes	GREG BRAY
41852	Yes	Rasa Whitaker
41850	Yes	Troy Beaumont

## Individuals

### Support - with comments

Submission ID	Support/ do not support	Comments - Please be as specific as possible to help us understand your views	Name
44097	Yes	I like the idea of a community garden where people come together not only to garden but to connect, built relationships, exchange their knowledge and products. This is a great place for young and old and i can only see a benefit for the Community of the whole Harbour Basin. The group that has proposed this project is well equipped and able to manage a Community garden of that scale. I applaud their enthusiasm! I suggest that the council can lease the land to them on a "token"basis to avoid costs.	Nilguen Kulpe
44072	Yes	This is a unique opportunity for the community to take responsibility and develop a future food source, as well as a community building, congregation and support area.	Gordon Hammer
43960	Yes	I support the park being leased for a community garden. However, my property backs right on to the park. As a resident it would be good to have a 5m buffer around the whole perimeter of the park to provide some space between their activities and our homes. This would help enable better privacy for residents, help maintain the sense of spaciousness that currently exists (when we all bought our sections) and may reduce the sense of 'overwhelm' some residents may be feeling by the physical presence of new structures and gardens. It may also help with a better sense of security and safety for houses.	Laura Beck
43925	Yes	<p>We live at the rear of the park and enjoy it's current quietness and space (a reason why we purchased our property).</p> <p>It would be good to see a portion of the park used for a community garden, but we would not like to see the entire park consumed by this. Our concerns relate to the location of sheds, compost bins, water run off, access to the backyard, upkeep and tidiness of the gardens, concern of attracting vandals and unwanted disturbance to a currently quiet place.</p> <p>We do not wish for any construction to be located near our boundary because we don't want to restrict access to the back of our property for emergency or occasional vehicle access. It was mentioned at a recent meeting by a member of the garden group that they would consider a 3m border around the park. This however would not be sufficient and should be more like 6m.</p> <p>We are also worried that the garden may attract vandals and increase noise to the area.</p>	Nigel and Jenny Pitts

Submission ID	Support/ do not support	Comments - Please be as specific as possible to help us understand your views	Name
		<p>An increase in watering of the community garden could exacerbate the problem of water run off onto our property.</p> <p>If there is to be a community garden we would wish it to be kept tidy and for compost bins to be well away from houses so not to attract pests or create bad odours.</p> <p>If this lease were to come into disrepair, will there be official channels to go through to rectify any problems?</p> <p>We would appreciate the council and community board to address our above concerns before giving the garden group permission.</p>	
43901	Yes	I wish to declare my full support for the community garden plans proposed for Laurensen Reserve. It will be an incredible community asset for everyone.	Ashley Murphy
43825	Yes	<p>Laurensen Park is an underutilised green space and the community garden concept developed by the Te Ahu Patiki/Mt Herbert Community Garden Group for this area will transform the park into a community hub with social, environmental and cultural benefits.</p> <p>The project fits well with all four pillars of the (draft) Otautahi Christchurch Community Strategy. The Council being committed to supporting such an initiative still intends to charge a standard rate for the lease of the park. Typically a standard, commercial lease arrangement, for instance for grazing, means that the leased property is commercially used (i.e. for private advantage) and not accessible to the public. This does not apply to this project; the Community Garden Group is a charitable entity and the community garden will remain a public space accessible to all community members. The ongoing maintenance of the park will become the responsibility of the Community Garden Group and thus will save Council a considerable amount of money. I therefore urge Council to look at charging a peppercorn lease rather than a standard rate.</p>	Michele Cherry
43535	Yes	A fantastic initiative which benefits the community greatly.	Aaron Simon
43511	Yes	<p>Laurensen Park is an ideal area for a community garden, as it is central to the whole area from Purau to Teddington.</p> <p>It is also close to the new subdivisions, Diamond Harbour, commercial area and school so makes a good hub for the community.</p> <p>The garden will enhance the park with greater use, living edible plants and be a real community focus for all.</p>	Annette Richards
43507	Yes	This space would be ideal for a community garden, it is a big space and in my opinion currently underutilised. Many locals would contribute to its upkeep, including my family. Being on a slope and in full sun, having it landscaped with the different garden/tree zones proposed would make it an appropriate location for a community garden and a very special space which would be appreciated by many.	Jade Durney
43222	Yes	We only would support this if the council or the Te Ahu Patiki/Mt Herbert Community Garden Group maintain the hedge. We live the other side of the hedge and it has grown too tall and has not been trimmed, which the council use to do, we find that the hedge is growing taller and taller and needs the height to be reduced. There is also a problem with rats and mice in the area so the Community Garden Group would need to maintain control of the vermin as this will get worse if fruit and vegetables are left to fall.	Trudy and David Ruske
43208	Yes	<p>Diamond Harbour and the adjoining bays are accessible by one road only for supplies, including food supplies. Relative remoteness can be an advantage for many who like their peace and quiet and the natural surrounds. However when situations change, when disaster strikes, this can turn into a major disadvantage.</p> <p>Te Ahu Patiki/Mt Herbert Community Garden Group is seeking the use of Laurensen Park at 123 Marine Drive, Diamond Harbour, to develop a community garden for the benefit of residents in the wider Purau to Teddington area. This community garden would provide many different types of gardening opportunities, including individual plots. Most importantly though is the community development of this project, and the long term view of sustainability and resilience of the whole of the community.</p> <p>Diamond Harbour is growing fast and in this process Te Ahu Patiki facilitates and brings people together for the common good. Gardening together, discussing future planting and planning and especially nurturing a growing awareness of the role this community garden can play in community resilience. Everyone can find a way to be involved and there are different benefits for each person or family: from learning to garden and become more self sufficient to learning about different species of herbs to enhance cooking; from planting natives and fruit trees to enjoying the harvest and learning how to preserve and store and how to use the native medicinal plants; from looking after your own family only to sharing the joys and products and being part of a resilient community. And in looking to the future, knowing that you will have enough for your own family and to share.</p> <p>In the 'CCC Community Gardens Guidelines, 2016', Council points out how it can help community gardens and at this point number 4, 5 and 12 could be particularly</p>	Margreet Stronks

Submission ID	Support/ do not support	Comments - Please be as specific as possible to help us understand your views	Name
		<p>useful to keep in mind.</p> <p>4. Pepper-corn rentals for Council land used by community gardens.</p> <p>5. Council waving fees related to consent and approval processes.</p> <p>As the group develops the land bit by bit, it may be reasonable to start the lease agreement with a peppercorn rent and over time build up to the required lease for the total area. Council of course will not have to maintain this land anymore once the lease is signed, saving itself considerable cost. Progress could be reviewed at the 5 year mark, when the lease is renewed and then decide what would be a reasonable lease contribution for the next 5 years.</p> <p>Waving the fees involved would be an additional manner in which to support this fledgling group to get their feet firmly planted in the soil.</p> <p>Alternatively Council may want to consider the 'Adopt a Park' scheme 1993, under which some community gardens are supported with CCC lawn mowing, pruning and other maintenance services in exchange for keeping the park planted, and in general looking presentable through community development and input. In that case there would be no financial contribution from the group to CCC and Council would still be involved when and where needed. (nr 12. of ' How Council can help')</p> <p>In conclusion I would propose that Council look favourably on the proposal to develop Laurenson Park as intended by Te Ahu Patiki Mount Herbert Community Garden and support the community group with knowledge and financial support as outlined in their document ' Council Community Garden Guidelines' for all our futures and especially the ones of our children and grandchildren. Thank you.</p>	
43068	Yes	I think this is a great idea from an educational, community and well-being perspective as long as it has no detrimental impact on those residing directly adjacent to the park, which I can't see how it will. I don't understand why anyone would object to this in favour of a dog walking park given how many dog walking opportunities already exist in Diamond Harbour.	Jonathan Wright
43011	Yes	It sounds like a good use of space as it is an underused park. I would also like to see it include some native plants that are eco sourced.	Sarah Pritchett
42542	Yes	We own a Bach in diamond harbour and love the quietness and green spaces in diamond harbour and also know there is a lot of pressure to add more housing. I am in favour of developing this park as described for the neighbours and maintaining the character of diamond harbour	Ian Wells
42185	Yes	<p>I am fully supportive of the community garden on this site.</p> <p>As an active volunteer for the DH RMC, my only concern is that no recognised environmental weed species be propagated on the site. Food plants that can be weedy include: Banana passionfruit, Cherry trees, Cherry-plum trees, ginger, kiwifruit and others.</p> <p>Currently, there are a number of pampas grass (Cortaderia selloana) on the site. Pampas is a threat to our native habitats, it produces abundant seeds that can spread far and wide. It is listed on the national pest plant accord as an unwanted organism in NZ. I would like to see all pampus removed.</p> <p>The RMC can provide eco-sourced native plants for this site if needed.</p>	Peter Ozich
42155	Yes	Great idea A very under utilised park at present.	Phil Swallow
42081	Yes	<p>Reasons for Supporting - (1) Food prices are forever on the rise, while incomes for many people struggle to keep pace with such rises; prices for individual products purchased from our newly established supermarket can be up to \$5 or more compared with prices on the same or similar products purchased in the City. (2) A consumer often has little control on the quality of food from supermarkets, etc, whereas they can have all control on what is grown and how it is grown, and if an active participant in a community garden. (3) This is not a commercial enterprise. (4) Because people in Diamond Harbour/Church and Charteris Bays may not have their own space or conditions for an eatable foods garden, a community garden is a very attractive proposition. (5) In passing by this Park I rarely see it being visited by people, and therefore see its alternative use as a community eatable gardens will substantially increase its amenity and use values for the Diamond Harbour/Church and Charteris Bays community. (6) This proposal should also greatly help to restore and strengthen community connectiveness, as we proceed through the current pandemic crisis which is causing a substantial cost to social cohesion. (7) For the said reasons (1-6) I further ask the Council to settle the lease with a peppercorn rental only.</p> <p>Thank you</p>	Adrian Daly

Submission ID	Support/ do not support	Comments - Please be as specific as possible to help us understand your views	Name
42034	Yes	It seems to meet the needs of many of our residents and will be a great place for people to come together.	Caroline Martin
42015	Yes	I support the idea of a Community Garden over some of the park, though it is important to still have an area that the Westpac Helicopter can land for medical emergencies.	Christine Turner
42008	Yes	I think a community garden in Diamond Harbour would be a great opportunity to provide a community food hub to our village. Food resilience will become crucial in years to come so starting the process now will set up our community (even wider) should climate/natural events occur in our region. The Laurenson park location is ideal for capturing local walkers, parents and children, in an easily accessible environment, providing opportunities to engage the community and visitors. It's a great size for opportunities, and not otherwise widely utilised. Access for those who back on to it or walk through can be kept, and I have seen a willingness to work with other groups to keep the feeling of inclusion, particularly dog walkers, emergency services, school and youth clubs.	Helen Alpe
41998	Yes	Much better to have the park used to produce food than in grass needing to be mown regularly using petrol and time which could help towards other Parks maintenance.  Really good for the community and yet another example of how well we work together.  No doubt the school will get involved which is another plus.	Karen Colyer
41997	Yes	Great, get the space used	Ritchie Eroica
41972	Yes	Sounds very exciting. Reflects food resilience, protection of pollinators, community coming together, diverse use all in a sustainable way. My full support.	Gina St J Ives
41966	Yes	This sounds like a brilliant idea for the community - growing food and flowers in a shared garden is a great way to share knowledge and skills, build food resilience, take care of the land, encourage children and young people to become involved in gardening and strengthen community bonds. I hope that the garden will be managed sustainably and organically so that it enhances soil health and increases habitat for insects.	Rose Collins
41945	Yes	I am happy to support this project provided the council provides a place for dog owners to exercise there dogs and an open space for residents to do in the event of a fire. A dog park and community gathering space on the Whero/ hunter road land that is undergoing consultation would be amazing.	Paula Arbouw
41931	Yes	It's a great idea, but here should be an area fenced off for running and exercising dogs off-lead, as it's an already existing function of the park which should remain a possibility.	Tamas Nemeth
41919	Yes	I think it would encourage more community spirit	Charmaine Vincent
41893	Yes	I fully support the group aspirations and value the contributions this endeavor will make to the local communities.  I don't believe it is reasonable to charge a standard rate to this non-profit group, given it has not been established with a revenue generating purpose. Furthermore the use of the land will remove the maintenance costs currently incurred by Council, which likely more than offset the stated fees and costs for the lease. I propose an alternative pepper corn lease arrangement.	Pete Simpson
41891	Yes	I fully support this much better use of what is currently a bare piece of land covered in grass which has to be mowed for minimal value return to the community.	Adrian Heath
41890	Yes	since I've moved here I've noticed the standard of peoples homes and gardens are amazing and the fact that they all want to create something to help and rewarding for other people is a big opportunity to not be missed, let these people give back and do some good, that space atm is a total waste of space with dog crap all over it, it needs to be changed into something and I couldn't think of anything better	juanita toki
41889	Yes	This sounds like a good way to unite the community, buildings not so sure about though. Garden and playground is a yes	Izzy France
41887	Yes	This will be a fantastic resource and will help to build an inclusive, diverse and sustainable community.	Margaret MacDonald
41886	Yes	I like the idea of a community garden and food forest but think it would be better placed on some of the land at the top of Whero Avenue. The land at the top of Whero Avenue would be ideal because there are already several well established, big fruit trees (apple and plum) on flat council land, alongside the school track. If the open land at the top of Whero Ave. cannot be used then I am ok with Laurenson park being used for this purpose. However, I think it is important to have some open grass park space available somewhere in the community for use to play with dogs or flying a kite, etc. In that case, the field at Whero ave should be opened up to the public for this purpose.	Catherine Gongol

Submission ID	Support/ do not support	Comments - Please be as specific as possible to help us understand your views	Name
41885	Yes	The current layout of the park is unappealing and hence it is poorly utilised. community garden would make it much more useable.	Helen Farley
41884	Yes	For a community garden longer than 15 years would make more sense.  But it's great this is happening.	Kate Kate
41883	Yes	Anything that benefits our wonderful community will be supported by our family.	Dawe Cheryl
41880	Yes	We're concerned over the lease charges. Could they please be changed to a nominal amount in order for the community to benefit from this amazing initiative.	Michele Kiely
41878	Yes	Great idea, I really support this and would be happy to commit to some volunteer days to help make it happen. The wildflower area is a particularly good addition. How about adding in some dedicated planting to encourage native birds to the area, especially focused to linking in with the Tui corridor project?  Adding a decent playground for the kids would be great. Maybe a pump track around the outside? Would help to keep the kids happy while the adults can get stuck in to maintaining the community garden	Bradley Newall
41877	Yes	It will be wonderful to see this park better utilized, for a community project, that will provide some local resilience and security in case of a natural disaster.	Ollie Gale
41876	Yes	It's great that people are willing to work together to provide food for themselves and the community. This space is central and on the main road for protection from vandals. (A previous community garden in Purau was destroyed by one disturbed individual) It will be good yo see if used a lotmore than if is now. The lease charge should be very low as locals would be caring for the space instead of Council staff. Environmental commitments made by the council demand local self sufficiency, healthy home grown food and reduction of transport and production of packaged foods.	Joy McLeod
41872	Yes	We live on Ranui Crescent which has access to the Park. I use it daily to walk our dogs. There is no other open space close by. We have lived here for 14 years. I am strongly opposed to the leasing of Laurenson Park for a community garden.  The park is currently used by many, many dog owners, lots of kids use it as an area to run around and play. Our kids have learnt to ride their bikes here as the footpaths around this are are a hazard as too narrow and overgrown so the park is a safe place for kids. Our community has camped here to get away from the earthquakes and the noise of aftershocks.  There is a garden at the local school 100m away which has been completely under-utilised and is an opportunity to be used by this group, the fact they have not utilised this proves they could not be capable of running another project elsewhere. I have serious concerns about this area being given up to such minor groups and for the majority to lose this valuable free open space.  Yes, I am available to be contacted further about this. As long as there is still public walk through access track through park between Ranui Cres and Marine Dr	Denissa Hora
41870	Yes	Fantastic idea. The park is hardly used except as a walk through. It is a perfect place for social gathering and working together in a community garden. Good luck!	Mashhour Heba
41869	Yes	I think it is a great idea to provide for our community. Kai is vital to physical, family, mental and spiritual health and the community garden allows a space to bring these benefits to our community.	Nicholas Alpe
41864	Yes	I think it will be a wonderful asset to our community	Anna Roberts
41863	Yes	I think it's a great idea! A fantastic way to build the community!	Andrew Hibbert
41859	Yes	Such a wonderful community project. A great opportunity for young knowledge growth a great learning experience for the whole family.	Janette West
41855	Yes	We have two young children and would love to see this space used to bring together the community in a positive way. Some bbq space and possibly natural wooden climbing/play equipment (photo idea attached) would be fantastic and enhance the appeal for parents to come and spend time as the playgrounds are lacking in DH.	Rebecca Newall

**Submission #41855**



**[Back to submissions](#)**

Submission ID	Support/ do not support	Comments - Please be as specific as possible to help us understand your views	Name
41854	Yes	This piece of green space would be enhanced by the project. A great opportunity for community development.	Jill Ryde
41853	Yes	A wonderful and appropriate proposal. It's a defined community here, but sadly there's a lack of community projects and gathering places. Growing and sharing food is the WAY FORWARD.	Melanie Gliddon
41851	Yes	Love the idea of a community garden but it's a dangerous bit of road with no crossing and no footpaths and as such is a terribly dangerous idea for a family oriented playground area.	James Grant
41830	Yes	<p>Laurensen Park is an underutilised green space and the community garden concept developed by the Te Ahu Patiki/Mt Herbert Community Garden Group for this area will transform the park into a community hub with social, environmental and cultural benefits.</p> <p>The project fits well with all four pillars of the (draft) Otautahi Christchurch Community Strategy. The Council being committed to supporting such an initiative still intends to charge a standard rate for the lease of the park. Typically a standard, commercial lease arrangement, for instance for grazing, means that the leased property is commercially used (i.e. for private advantage) and not accessible to the public. This does not apply to this project; the Community Garden Group is a charitable entity and the community garden will remain a public space accessible to all community members. The ongoing maintenance of the park will become the responsibility of the Community Garden Group and thus will save Council a considerable amount of money. I therefore urge Council to look at charging a peppercorn lease rather than a standard rate.</p> <p>If Council has concerns about safeguarding the underlying values of the development plan for the park then these principle could be written into the lease contract. Also, Council could consider entering into a co-governance arrangement where Council representatives sit on the body responsible for establishing and running the planned community garden.</p>	Thomas Kulpe
41823	Yes	A community garden would be very beneficial for our community in Te Waipapa. I would love to see the grassy area be turned into something viable, not just for the people of Diamond Harbour, but also for the fauna out here	Meghan Sheehan
41815	Yes	This is a great idea and there appear to be a number of local residents who are keen to make it happen.	Jane Harrison
41814	Yes	yes as I am one of the group members I know this will develop an area for the community to meet - not just those who garden. It will also provide food sustainability and provide a place for education on how to grow your own food and how to actually cook it etc. As it is open to the public it will turn an area that is grass only with a few trees into an area that will attract wildlife and be pleasant for those using it.	Dawn Sutton
41813	Yes	An excellent initiative that will support community resilience and education about sustainable food production.	Richard Swatton
41808	Yes	i am very happy about this proposal as it will benefit the community in learning together to grow healthy food and socially connect with each other	Mareile Stoppel
41804	Yes	We would be happy if the lease was for a longer term	Vincent POOCH

## Individuals

### Do not support – no comments

Submission ID	Support/ do not support	Name
41985	No	Caroline Mackenzie



## Individuals

### Do not support – with comments

Submission ID	Support / do not support	Comments - Please be as specific as possible to help us understand your views	Name
44135	No	<p>I am strongly opposed to the proposal to develop a community garden at Laurensen Park at 123 Marine Drive.</p> <p>Our property at 26 Ranui Crescent will be very much affected by this proposal. We bought the property specifically because it backed onto the park. My children were always in the park playing cricket, bike riding, flying kites etc and I expect my grandchildren to be able to do the same.</p> <p>I am concerned about the scale of the garden taking up all of the park leaving no recreation area for the children.</p> <p>In addition to this I am concerned about the following:-</p> <ul style="list-style-type: none"> <li>• Potential water run off and erosion. Our property is on the down side of the park and will have a lot of water run off from people watering their gardens, there is potential for hoses to be left on for long periods of time and even over night.</li> <li>• Smell from compost etc The original plan sent to the council showed the buildings compost bins etc in the middle of the park but now they have been relocated down to the boundary of my property. This will not only have the potential to give off odour but also attract rodents, seagulls and possible other undesirable animals bordering my property. Not to mention the flies???</li> <li>• The use of Insecticides, fertilizer etc is a real concern. These are poisonous and I have 4 young grandchildren who enjoy being outside. - These poisons could be carried in the wind and I would have to watch every movement the grandchildren make if this garden goes ahead.</li> <li>• Who will have control/ responsibility for this garden? Will there be any rules? Who has a say about what happens there. Will the CCC still have any control?</li> <li>• The garden could become an area for people to come together for more undesirable things rather than gardening.</li> <li>• We have no high rise apartments in Diamond Harbour and everybody has their own land on which to grow fruit trees and veges etc. so there is no need for this.</li> </ul> <p>I am also concerned about my lack of peace and quiet that I currently enjoy. I can sit on my deck and enjoy looking at the park and the open space. I do not want to be looking at the back of sheds, compost bins and garden waste.</p> <p>I believe that this would also devalue my property. I do not want to live next door to a community garden and I believe a lot of other people share my views.</p> <p>I bought the property because of the park and now you want to take it away.</p>	Barbara Myall
44086	No	<p>I do not support this proposal because it is not fair on the people living around the park to change the use so drastically. People buy houses next to parks because they are beautiful, open green spaces to enjoy and changing this use will impact their ability to enjoy their neighborhood. Allotments and community gardens are untidy and messy with partitions, random shelters and buildings which will attract pests, both human and animal as well as be detrimental to the look and character of the area. By the way - I do not live next to the park; I feel really sorry for the poor people who do. This would be a fantastic project to have in a school or similar institution such as a retirement home, mental hospital etc where you would have plenty of willing labour, or out in a field away from people's homes. Why not look into putting it elsewhere instead of upsetting lots of people who live close to the already beautiful and utilised green open space that is Laurensen park. Plus what happens when there's no money for the upkeep, or there aren't enough volunteers to keep it going? It will just turn into a wasteland and a haven for vandals. At the moment it is neat, green and utilised by the community. There is no need to change it, furthermore, changing the use risks making the area less attractive, upsets the people living close by and puts a great strain on the people of Diamond Harbour to put a lot of time and money into something that is not needed. Please, listen to the people who live next to the park - this must be causing them an immense amount of stress - why do that? Surely they should be spoken to first before any proposals are put forward.</p>	K Pedersen

Submission ID	Support / do not support	Comments - Please be as specific as possible to help us understand your views	Name
44079	No	<p>We have a family bach at 26 Ranui Crescent which backs onto Laurenson Park. We have concerns about the proposal and its effect on our family and the wider community. Our main family concern is that we stand to lose the recreation amenity of the reserve which we have enjoyed for over 30 years. My brothers &amp; I as children used to play cricket, fly kites, and play all throughout the reserve and I hope that my children aged 0, 2, &amp; 4 will get to enjoy the reserve as we did growing up. If the proposal is to proceed we stand to lose significantly. Whilst we are against the proposal going ahead we are also concerned about the lack of planning and organisation around the proposal. There are no plans aside from a hand drawn sketch to show the scale of the proposal and the ongoing maintenance of the garden would be immense. We see absolutely no need for garden allotments or a community garden in Laurenson Park as there is no high density housing in Diamond Harbour and every garden enthusiast who lives in the area has a more than sufficient area within their own household for a large vegetable garden.</p> <p>Further Concerns</p> <ul style="list-style-type: none"> <li>• Smell from compost area</li> <li>• Additional SW runoff potentially contaminated from fertiliser/insecticides</li> <li>• Scale of proposal (8,500m2)!</li> <li>• Location of buildings</li> <li>• No landscape plans provided</li> <li>• Loss of security from neighbouring houses being able to visually see onto park.</li> <li>• No development plans provided</li> <li>• No urban design assessment</li> <li>• Loss of usable park space</li> <li>• Structure of garden management</li> <li>• Ongoing maintenance of garden</li> <li>• No where for children to play cricket, soccer etc.</li> <li>• Hard landscaping</li> </ul>	Mark Myall
44070	No	<p>We support in principle the creation of a community garden in Diamond Harbour, but oppose the proposed development of Laurenson Park. Key concerns include:</p> <ul style="list-style-type: none"> <li>- A community garden is unlikely to be compatible with existing uses such as off-lead dog exercise, resulting in some local residents effectively losing access to Laurenson Park. This is a poor outcome for public access.</li> <li>- There is no easily accessible, large, flat area of reserve within a 30 minute walk of Laurenson Park. Losing a reserve of these characteristics within an easy walking distance is likely to increase car use by local residents accessing Stoddart Point as the nearest alternative location. This is a poor outcome for community well-being and the local response to climate change.</li> <li>- Council services are likely to decrease in real terms. There is no commitment for current maintenance services in Laurenson Park to be reallocated to the proposed community garden, or redeployed to other reserve areas in Diamond Harbour. In the context of Council's already limited maintenance regime for Diamond Harbour reserves, this is a poor outcome for rate payers in the vicinity of Laurenson Park.</li> </ul>	Andy and Matthew Barbati-Ross

Submission ID	Support / do not support	Comments - Please be as specific as possible to help us understand your views	Name
		<p>- Council has proposed selling land at Hunters Road which can instead be used as a location for a new community garden, without displacing existing users of Laurenson Park. Developing a new reserve on Hunters Road land can promote community well-being by adding to existing reserve areas. The opportunity to develop a community garden at Hunters Road should be addressed.</p> <p>- The online consultation materials are inadequate, and the matters above are not identified. Council has provided no meaningful analysis of how the change will promote community well-being, impact existing users, or its consideration of alternative options. This is poor practice for consultation and decision-making.</p> <p>Our submission is made in a private capacity as residents of Diamond Harbour.</p> <p>We would like to be heard if a hearing is to be held.</p>	
44020	No	I like it as a park	Alexandra Clark
44019	No	<p>It is appreciated by those who use it now.</p> <p>Why should a small group take it over. It is also used as a training area by the local fire brigade</p>	Tom Clark
44009	No	I believe this should be left as a park. There are other sites that would be more suitable, e.g. to top of Whero Ave. The park is well used as a place for walking dogs, as a helicopter base in emergencies and also used by the fire brigade for practice. A vacant area in Diamond Harbour has just been turned into a park and now a named park is wanted to be turned into a community garden. I would like to see Laurenson Park left as is.	S AUDREY HUGHES
43995	No	<p>Whilst in theory a community garden sounds like a good idea, in practice, there are concerns as to how and where it would function and the suggested positioning. I outline my concerns and consequent objection to it being sited at Laurenson Park below:</p> <ol style="list-style-type: none"> <li>1. Contrary to what may be believed, local residents do currently use the park. I use the park to walk my dogs off lead, as do others. I've also seen people use it as a pleasant walk-through, children play on there, post-earthquake someone camped on there for a short time, and today someone is having a party on there. Whilst the proposal states that "the gardens will not restrict public access into and through the park" it most definitely will restrict usage. I want to be able to walk my dogs off lead and play ball with them on the park, as I can now. If structures were put in place, this would not be possible.</li> <li>2. A previous community garden housed in Purau was, I understand, vandalised and sadly, only a couple of weeks ago, the pouwhena at Pony Point Reserve, near Rapaki and Cass Bay was destroyed by vandals. If a community garden went ahead at Laurenson Park it would, I believe be wide open to theft of produce and vandalism as it is on the main thoroughfare to Diamond Harbour.</li> <li>3. Funding of the park and longevity of members is also a potential concern. Management committee members might be excited about developing it now, but what happens when someone loses interest in growing or maintaining the garden, or becomes too old/ill or leaves the area altogether? Finding people who can spend the time and energy required to maintain it may not be always forthcoming.</li> </ol> <p>The bottom line is that Laurenson Park should not have its use changed. You wouldn't suggest converting Hagley Park into a community garden such as is proposed here, so why should our local residents have to accept this proposal?</p> <p>The community garden management committee would be much better looking into areas that are less likely to be vandalised and would not cause upset to local residents. Possibly using some of the Whero Avenue council land which has recently come up for review could be an option, provided dogs could continue to be walked off lead round the outside perimeter of the fenced area. Or better still, the committee should approach Orton Bradley to see if they could house it there. It would be much safer there as the gates are locked every evening.</p>	Maddi Naylor
43989	No	<p>This submission is on behalf of Richard and Gloria Heazlewood</p> <p>We have attended both the meetings (one held by Council and one held Saturday 4 December by the group involved) and we have been giving this a lot of consideration. Please note that in principle we do support the concept of community gardens where there is an established and proven need. We live at █ Ranui Crescent so our property backs onto Laurenson Park therefore affect us directly. We have endeavoured to look at this idea from all possible angles. It seems that on the two occasions we</p>	Richard & Gloria Heazlewood

Submission ID	Support / do not support	Comments - Please be as specific as possible to help us understand your views	Name
		<p>have spoken to those involved in this, we have been given different answers and ideas about what is proposed. The ideas seems very fluid and seem to change depending on who you talk to. At the meeting on Saturday 4 December Gloria was told that the Hearings Panel will be deciding whether the concept of a community garden is want the local community want. However the title of this feedback form does not indicate this, rather that it is whether a Lease should be offered to this group for the use of Laurensen Park. Very confusing. This morning I was told that they are now only going to initially lease the lower portion of the land where they intend to put a 'small potting shed, storage shed and hopefully a tunnel house'. These facilities would be directly behind our house.</p> <p>There was no consultation in the local community before the group approached Council about this and we do not believe proper due diligence has been done regarding consultation. The first we knew about the idea of turning Laurensen Park into a community garden was in September via a flyer in our letterbox. We received this as our house backs onto the park. It appears that any house that does not back onto the Park was NOT contacted. Some neighbours still knew nothing about this idea even when the Council had an onsite meeting about it in November. The Council representative (Samantha) said the only properties that were informed of the proposal by the Council by a letterbox drop are the houses that back onto the Park. Neighbours opposite our house in Ranui Crescent were not informed of this and knew nothing about these proposals until after the onsite Council meeting in November when we mentioned it to them.</p> <p>We believe the group 'put the cart before the horse' by not talking with the wider local community before approaching Council about the possibility of leasing the Park. Council should have asked questions of the group about what consultation they had done in the community prior to any further talks. By not taking the time to talk with the local community, and those home owners that would be directly affected as they back onto the Park, it feels like Council are in a hurry to get rid of their responsibility for the Park. Also, it does not give us much confidence in future decisions the Leasee may make regarding the Park. Are we going to be lumped with a whole lot of old, untidy buildings that our home would overlook?</p> <p>We do not believe that enough research has been carried out to establish the need for a community garden in this area. We have asked the group involved how they established the need for a community garden in this area and it appears it was just a vague 'people we have talked to said it's a good idea'! Many things can seem a good idea until you get into the nitty gritty of the details.</p> <p>We are concerned that if a lease is granted to this group for Laurensen Park then another open, public space is lost forever. Our family use the Park regularly with our grandchildren where we play cricket, throw frisbees and organise games activities for them when they visit. Last summer the local youth group used the Park during week nights for activities. During the past two summers we have seen groups of young adults spending the day at the Park picnicking, throwing frisbees and generally enjoying the shade of the trees and open space. It was reiterated at the December 4th meeting that 'nobody uses the park and in my 17 years here have never seen anyone using it'. We can absolutely assure the Hearings Panel that Laurensen Park is used throughout every day by many locals - to go for a walk, to exercise their dog (great place for those who are physically unable to use other open spaces due to their physical disabilities), parents walk their children through the Park on their way to &amp; from from school, children ride their bikes in there when the grass is not too long (not cut often enough!) and many folk exercise their dog(s) there daily (some very noisy for 20 minutes a day, others quietly).</p> <p>We think the group have good intentions but do not believe Laurensen Park is the best option for a community garden. Two of the folk at the December meeting said they had not looked at any other options for a community garden. Why not? Surely they should have looked at other options in the area and then consulted the local community on their thoughts.</p> <p>We are concerned about buildings being put onto the land near our home and quite near the walkway from Ranui Crescent. This area is not very visible from the road but is highly visible for the home owners who live this end of the Park. This could lead to more noise, water run-off problems as they irrigate and has the potential for criminal activities in the surrounding properties. Unattended buildings do tend to be an attraction to some people with ill intent.</p> <p>How would Council control what happens in Laurensen Park once the lease was signed? The minutes of the group talk about various possibilities: a children's play area, a BBQ area, a 3m wide path around the outer perimeter of the Park, turning the walking entry from Ranui Crescent into a driveway to access their buildings easier, dividing an area into allotments (and renting them out), building a tunnel house, building an educational facility and building storage facilities for equipment. At the onsite Council meeting in November I asked what kind of buildings would be allowed and would they have to removable/transportable type buildings. The lady from the Council who was leading the meeting (sorry cannot remember her name) said they would not be required to be removable and providing they met the Buildings Codes then they could build what they want if they pay for it. Will there be any caveats in the lease to protect the neighbouring area? Will Council require a business plan? I realise they are not a business and when I asked at the December meeting was told they have a vision for what they want to do but they don't have anything actually planned yet. But</p>	

Submission ID	Support / do not support	Comments - Please be as specific as possible to help us understand your views	Name
		<p>should this vision not be given more details or will they just be given carte blanche once they hold a lease? And what rights would adjoining home owners have if they did not agree with what was happening? Or if it became too much for the group to handle and it became unsightly and unkempt?</p> <p>In the three years we have owned and lived in our property we have experienced drainage problems from the Park when it rains. In a heavy rain the water runs off the Park in sheets and floods our property. To try and alleviate this we have been building a garden bed on the Park side of the property boundary by deep digging to try and slow the water down so it can flow into the sub-soil. To aid this, lots of gypsum has been applied to help break up the clay sub-soil and we have begun planting to help slow the water down and allow it to soak into the ground rather than putting drains in to have it flow into the stormwater system and so out into the Harbour. In our backyard we have built raised beds as well as heavily mulching all pathways to try and stem this water flow. This was begun long before we heard anything about the current proposal. So we am concerned irrigation in a community garden would exacerbate this problem.</p> <p>Earlier this year I (Gloria) had been considering putting out feelers in the local community to see if there was any interest from other folk joining me to create a group Friends of Laurensen Park. We find the Park a charming place to spend time and it was one of the reasons we were drawn to purchase this property. It has a gentle slope and so is easy for me (Gloria) to walk around since I had a stroke nearly 4 years ago which has pretty much made it impossible to walk around the footpaths in Diamond Harbour as they are too narrow and uneven. Richard was diagnosed two years ago with incurable cancer and earlier this year also developed a different cancer which involved major surgery - hence Gloria's idea for a 'Friends of Laurensen Park' group has been put on hold due to currant time constraints. Our vision was to have a children's play ground (nearer to the road so it's more visible &amp; we were willing to personally put some finance into this), some picnic seats near the play area, other seats around the Park for quiet enjoyment, a sealed track around the outer perimeter for children to ride scooters &amp; bikes and to make it easier for those with disabilities to walk their dog, exercise and enjoy the open space. Some more planting of native trees in the middle of the Park would also give shade, food sources for native birds and some places to sit in the shade on a hot day or to shelter from the fierce southerlies we get here!</p> <p>We believe the lovely open area of Laurensen Park could be used and appreciated in a much greater way than through a community garden as it is a large area and quite unique area in Diamond Harbour/Church Bay as it is on a very gentle slope with lovely views over to Lyttelton and of the Harbour. Two other options the group could consider for a community garden in Diamond Harbour could be the top of Whero Avenue or the section in Waipapa Avenue that used to have the wooden water tank. We are sure there are more options too.</p> <p>Our plea to Council is to not grant a lease for Laurensen Park for a community garden. Let us continue to enjoy it for the easy to access, open space that it currently is.</p> <p>Thank you for your time in reading my ramblings.</p>	
43972	No	Most residents have the opportunity to grow food in their own gardens and there is a community garden at DH school. Why does every piece of bare land have to be developed to some degree? There are lots of opportunities for the community of DH to get together that already exist.	Karen Gourley
43949	No	Leave as a flat oark as it is. As for many elderly this is the onlt place where they can walk.	Vanessa Marshall
43924	No	<p>Most community gardens are not well maintained as they suffer from the tragedy of the commons - aka: when shared spaces go unregulated, they are often neglected or exploited because no one is in charge.</p> <p>If all the park is a garden the amount of work required to keep up with weeding, planting and maintenance is large.</p> <p>It is not clear will be responsible for security in the park if the community garden is established.</p> <p>Laurensen Park is an alternate driveway for a number of houses that do not have easy road access.</p> <p>If the garden is established and fails it may be possible for the CCC to revoke the reserve status of the park. There have been situations where use change has been used to alter reserve status.</p>	Hamish Laird
43913	No	<p>Park Use:</p> <p>I do not agree with the applicants view that Laurensen Park is "seldom used". In the 35 years I have resided opposite the area I have observed numerous activities which</p>	Kevin Wilton

Submission ID	Support / do not support	Comments - Please be as specific as possible to help us understand your views	Name
		<p>have included cricket, soccer, kite flying, drone operating, dog walking, fireworks, New year parties and picnics. I have also watched the Fire Service and Rescue Helicopter do training exercises.</p> <p>Parking:</p> <p>Laurenson Park is situated on a curve on the busy main road. Such a venture would require suitable off road parking with a well positioned entrance and exit. This was not mentioned in the applicants proposal. This hard standing area plus water reticulation and sewer installation would be quite costly.</p> <p>Privacy:</p> <p>The privacy and security of properties adjoining the proposed gardens would be compromised with people working the area at all hours.</p>	
43861	No	<p>There is a lack of information to allow me to make an informed decision to support or not. I have attached a document detailing some of my concerns, particularly a detailed budget and operational plan if they are successful.</p> <p><i>Text from attachment</i></p> <p>I am a property owner directly adjacent to Laurenson Park, Diamond Harbour. I wish to comment on the proposed lease and changes to the parks use. I attended a meeting with the team from the council, on site at 4:30 -5pm on the 10th of November, where I was surprised by the lack of information therefore, I cannot support the proposal. I have detailed a number of unanswered questions below:</p> <ol style="list-style-type: none"> <li>1) Has the council established a need for the proposed garden? Does the community need this or is it a select few residents who would benefit and engage in the gardens?</li> <li>2) Is there a proposal to accommodate parking? With a change in land use, it is likely patterns of parking will change and will need to be accommodated. This was demonstrated by the obvious lack in parking when attending the meeting of the 10th of November.</li> <li>3) There has been no reference to the use of the park by the rescue helicopter or the fire brigade. What will the impact be of the proposed changes to these essential services and will it effect how they can carry out their roles within the community?</li> <li>4) There has been no mention of the governance structure of The Mt Herbert Community Garden Group. Does it have a constitution or a board? The only details that have been forthcoming are that the group contains 40 members.</li> <li>5) The Garden Group has stated that it has funding of \$2000 from the Creasy Trust upon signing the lease. They also state that costs will be met by donations and begging off the community. Has due diligence been undertaken as to the appetite of community members and trusts to secure funding? I would deem the initial outlay to create the proposed changes to be fiscally significant not to mention ongoing costs of maintenance.</li> <li>6) Will there be provisions in the lease upon its termination that will require the lessee must meet the costs and undertake to return the park to its original pre lease condition?</li> <li>7) To ensure that lease costs are met by the lessee will an entity or individual be guaranteeing the lease?</li> <li>8) I have been given a sketch of the proposed plan but have subsequently discovered that proposed changes have been suggested. In particular the incorporation of a track where vehicles will be able to travel. In order to make an informed choice, a firm understanding of the actual changes that will be allowed needs to be detailed and rules stated. Has the council considered how they might ensure a final agreed plan submitted by the Garden Group is not deviated upon?</li> </ol>	Paul Rhodes

# Submission #43861

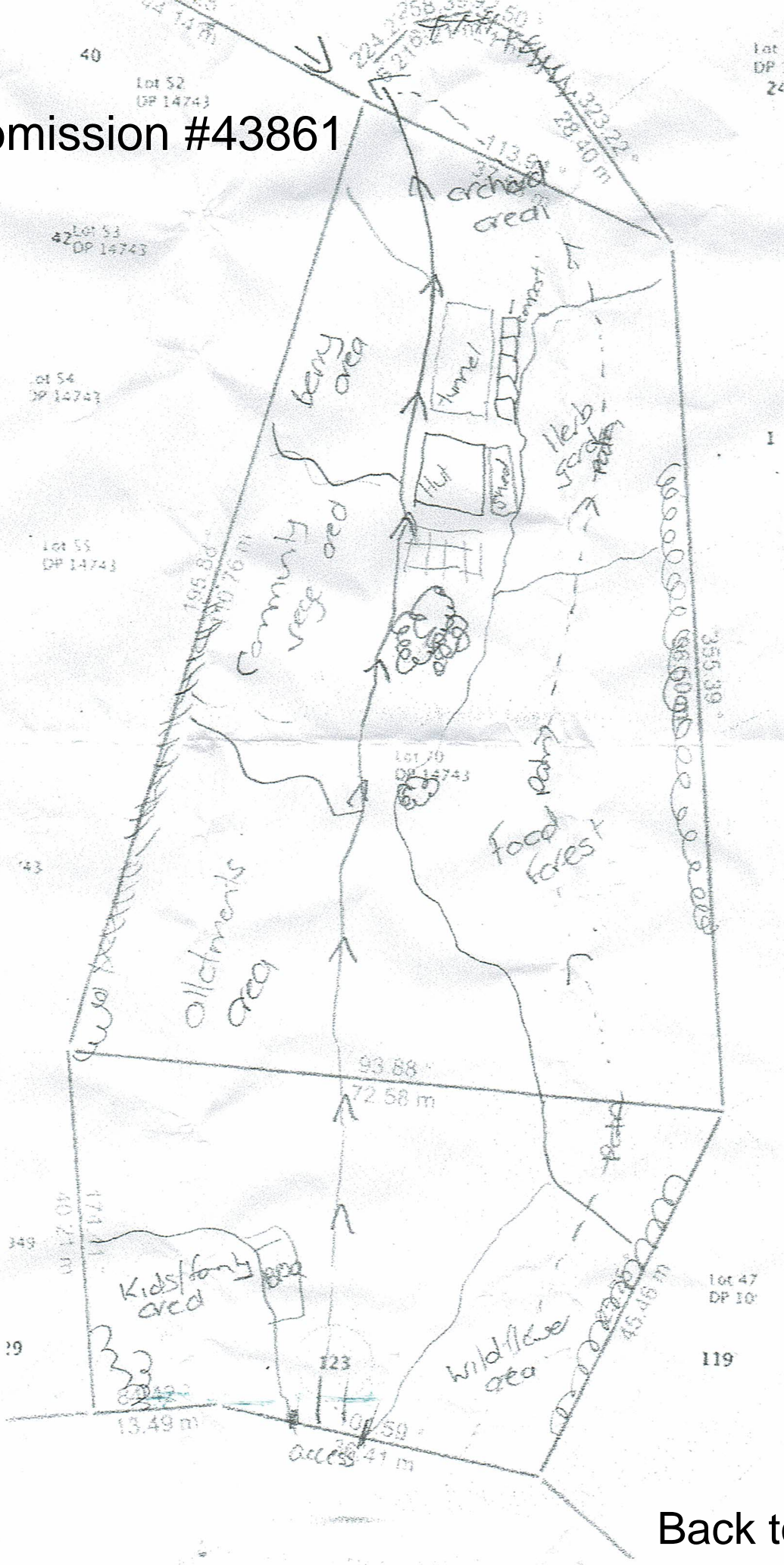

[Back to submissions](#)

Submission ID	Support / do not support	Comments - Please be as specific as possible to help us understand your views	Name
		<p>9) There is a significant seasonal variability in climate between wet and cold winter vs hot dry summers. Meaning additional costs and the use of local infrastructure. Have these costs and conditions been taken into account and investigations been undertaken as to the viability of connecting to and using local water infrastructure.</p> <p>10) The houses bordering the park were initially informed that they would have access to the park at all times. Subsequently a council representative has stated that each dwelling would have to make an individual application for a gate to access. I am seeking clarification.</p> <p>11) The proposed community garden which will total 8,498 m2 and demonstrated in the sketch plan takes up the vast majority of the park. A more modest plan that would allow multiple use of the land for recreation and gardening would be more reasonable. This could also serve to test the viability of the project. By starting smaller and then gauging community response and engagement, capacity to meet costs and value to the community. Does the Gardening Group have an alternative scaled back plan or have they considered multiple use of the park? Value and engagement could be increased by bringing others into the orbit of the project through sharing the parks use.</p> <p>12) A budget and plan are essential to the success and ongoing viability of the project. Why have these not been made available before trying to gain community support for the project?</p>	
43817	No	<p>Refer to Opposition to Laurenson Park Lease for Community Garden Activity</p> <p>Authors Winton and Marissa Buchanan</p>	Winton and Marissa Buchanan
43782	No	<p>Very few parks in diamond harbour, no guarantee that it will be kept tidy and not abandoned IN a few years when the drivers of the project move on.</p> <p>.most houses in diamond harbour have large sections so they can have gardens at home. For vegetables and fruit trees.</p>	Errol Walker
43574	No	<p>Hello! I live across the road from the park, and the park makes up the majority of our view. I have a good idea of how the park is used, and am concerned the current usage is not understood and is being disregarded. I do not believe the entirety of Laurenson Park is a suitable location for a community garden, and am not convinced there is even a need for a community garden in this area. The following are some of my concerns:</p> <ul style="list-style-type: none"> <li>- The reserve provides invaluable green space for the community, and is regularly used for dogs and children to run unencumbered. The space is used for sports games and picnics. The current usage does not seem to have been considered in this proposal.</li> <li>- The space is used for emergency services; the rescue helicopter lands on it, and the local fire brigade uses it regularly for training. This has not been adequately considered.</li> <li>- Access to properties that back onto the park is required, this has not been adequately considered.</li> <li>- The property owners who live on the reserve have not been consulted as to how their access, view, lifestyle and property value will be affected. The first information we are to be given about it is on December 4th, right before the submission period closes.</li> <li>- The group leading this project has currently 'adopted' the school garden, which is regularly left messy with waste piles, materials and equipment left out. This is a small space, was already established and also has others looking after it. I would estimate Laurenson Reserve as being about fifteen times the size. It is hard to feel confident in even basic tidiness.</li> <li>- Maintenance long term for two and a half acres seems infeasible, with the a small volunteer group meeting every second weekend for a few hours.</li> <li>- Maintenance long term for this scale project also seems infeasible without a sufficient funding plan or financial assessment.</li> <li>- There does not seem to have been any needs assessment. Community gardens struggle even in large cities. This is an area where most people have space for their own garden, often too much space, and there is already a successful produce swap group open to everyone. Need should come first.</li> </ul>	Bethany Pearson



## Opposition to Laurenson Park Lease for Community Garden Activity

*Submission 06 December 2021*

Authors Winton and Marissa Buchanan, 117 Marine Diamond Harbour



## Table of Contents

1.0	Opposition to Laurenson Park Lease for Community Garden Activity .....	2
1.1	Background .....	2
1.2	Buchanan Family Opposition .....	2
1.3	Laurenson Park Open Green Space Activity.....	3
1.4	Open Green Space Protection .....	3
1.5	Pros + Cons.....	4
1.5.1	Alternate Community Garden Site(s).....	4
1.5.2	Financial Viability/Resources/Sustainability .....	4
1.5.3	Park Maintenance Upkeep.....	5
1.5.4	Water Usage.....	5
1.5.5	Drainage .....	5
1.5.6	Vermin + Pests .....	5
1.5.7	Toilet Facilities .....	5
1.5.8	Rubbish.....	6
1.5.9	Fire Risk .....	6
1.5.10	Vehicle Access to Infrastructure/Vandalism .....	6
1.5.11	Community Benefits.....	6
2.0	Conclusion.....	7

### 1.0 Opposition to Laurenson Park Lease for Community Garden Activity

#### 1.1 Background

Laurenson Park was gifted to the residents of Diamond Harbour as part of a subdivision consent scheme plan for the area developed in the early 1950 s. The purpose of the Park was to provide recreational green space for local residents and visitors alike to enjoy.

Council, representing local residents were naturally assigned caretakers, responsible for overseeing the Park's upkeep with maintenance costs borne by local ratepayers. Council's role as the Park's administrator is twofold; accountable to ensure the park's deeded purpose remains upheld, and safeguarding the Park's reserve status to be held in perpetuity.

Laurenson Park has previously fallen victim to pressure from minority community groups seeking departure from the Park's deeded purpose. Incoming Councils following three amalgamations spanning seven decades since the creation of the Park have considered various proposals advocating variations to the Park's deeded purpose. Alternate land use ranging from sports fields to disposal for residential development has emerged for consideration. While Council have in the past looked favourably at alternate land use siting maintenance cost saving benefits as justification, strong local resident opposition has always protected the Park from any alternate land use gaining traction.

#### 1.2 Buchanan Family Opposition

A proposal to lease the entire Park for community garden activity is yet another attempt at departure from the park's deeded purpose. To take the entire park off local rate payers and the wider public for primarily one purpose is considered a most unreasonable request. Garden group members do not appear to live adjacent the park. The Buchanan family view the motive as utilising valuable open green space to occupy fruit trees and gardens that require considerable area not available within member(s) own properties.

The proposal appears to have been met with strong opposition from close local residents and park users whose consensus views fear their valued park funded from local rates is being unfairly hijacked for activity not congruent with the park's deeded purpose.

The Buchanan family who have lived next to Laurenson Park since the mid 1950s, share and support a strong collaborative local opposition voice with a clear message that the entire envelop of open green space be retained to accommodate the park's current multiple user group needs. Council upkeep, funded by local rates remains on-going, maintaining the park's natural beauty and panoramic harbour views. Retaining the park for open green space activity aligns its deeded purpose for current and future generations to enjoy.

The Buchanan family's strong opposition to leasing Laurenson Park for community garden activity is a result of drawbacks outweighing perceived benefits 8:2. Negatives [Cons] and positive [pros] of perceived outcomes documented in the body of this submission will inevitably swing in the opposition's favour to follow the tracks of historical outcomes, with an objective to protect Laurenson Park from falling victim to yet another attempt at departure from its deeded purpose.

### 1.3 Laurenson Park Open Green Space Activity

Laurenson Park is reasonably level with a gentle slope falling towards Ranui Crescent, making it attractive for elderly residents to safely walk through with ease. Pedestrian access to the Park from Ranui Crescent is convenient and enjoys high utilisation.

Development of tunnel houses, tool sheds, compost bins and raised beds for gardening activity at the northern end of the park with vehicular access to such infrastructure from Marine Drive added to filling the park with fruit trees and the like, will critically impact current park usage, severely compromising, moreover eliminating open green space user activity.

Infrastructure, vegetation and access ways will introduce health and safety risks for park recreational users. Current open green space utilisation is high with multiple residents benefiting and enjoying the wide range of activity the park accommodates. Open green space activity impacted with constraints and/or elimination as a result of the proposal, are summarised in Table 1.

Open Green Space Activity	Use Frequency	Green Space Activity Impacted Constrained/Eliminated by Garden Activity
Helicopter 24 Hour Emergency Landing	As Required	Eliminated
Earthquake Refuge + Civil Defence Assembly Point	Multiple Use in a Decade of Quakes 2010-2020	Eliminated
Clear Helicopter Access for Fire Brigade	As Required	Eliminated
Fire Brigade Practice	Monthly	Eliminated
Walkers	Daily	Constrained
Dog Exercise Walkers	Daily	Eliminated
Exercise Classes	Daily	Constrained
Ball Games	Daily	Eliminated
Picnic Groups	Daily	Constrained
Survey Reference Point	Periodically	Constrained

Table 1

### 1.4 Open Green Space Protection

The wider Diamond Harbour area remains serviced with only 3 Recreation Parks; James Dr, Laurenson Park and the Domain, each open green space strategically set apart from its peer providing easy reachable access for nearby residents to enjoy.

Environmental enhancement projects in the wider Diamond Harbour area have emerged in recent years. While such desirable projects compliment the natural beauty of the area, maintained level open green spaces remain scarce with Laurenson Park and the Domain the only two that can fulfil the needs of each respective sector of the village. Both open green spaces need to be retained and protected. With further residential development for Diamond Harbour inevitable, the demand for desirable open green space such as Laurenson Park will only increase in line with development, placing a higher value on this precious valuable community asset.

**1.5 Pros + Cons**

Positives and Negatives [pros & cons] matched with perceived outcomes described in the following section are summarised in Table 2.

Activity	Pros/Cons	Perceived Outcome
Alternative Community Garden Site	Positive	Achievable, Cost Effective and Manageable
LP Financial Viability	Negative	Unachievable
LP Park Maintenance Upkeep	Negative	Unachievable Degrades Adjacent Properties
LP Water Usage	Negative	Excessive
LP Drainage	Negative	Impacts Adjacent properties
LP Vermin + Pests	Negative	Mitigation Required
LP Toilet Facilities	Negative	Cost + H & S burden
LP Fire Risk	Negative	Mitigation Required
LP Vehicle Access	Negative	Cost security nuisance issues
Community Garden Benefit	Positive	Education, Cohesion, Support

Table 2 Acronym - LP = Laurenson Park

**1.5.1 Alternate Community Garden Site(s)**

The proposal to lease the entire 8500 square metres of Laurenson Park for dedicated garden activity is considered over ambitious and not economically viable. The proposal is considered most unpalatable given Council have a large parcel of vacant land destined for sale for residential development and other purposes that could easily accommodate community garden activity. This alternate site offers the garden group a wide variety of choices, opening opportunity to establish more shelter, tailoring development in a managed way, staged and built on a more appropriate scale that is viable and sustainable. Various other Diamond Harbour garden sites such as Stoddards Point and in conjunction with the school can also be explored.

Laurenson Park has clearly been the target of a start-up garden group eyeing an easy flat site without any concrete plan or financial backing statement to cover considerable setup and on-going maintenance costs. Moreover, prior consultation with local adjacent park residents and frequent park users has been lacking.

**1.5.2 Financial Viability/Resources/Sustainability**

The Buchanan family does not oppose the concept of a community garden. Many Diamond Harbour residents take advantage of its sun swept location to build and enjoy their own gardens. A community garden can be viewed as duplication. As keen gardeners, the Buchanan family have a clear understanding of the demanding resources required to achieve garden success to yield benefit. Having lived next to Laurenson Park for over seven decades and being closely associated with local organisations, we understand the volunteer capacity and fundraising efforts required to support the intended gardening activity. On the scale proposed, this will inevitably be a huge challenge. Setup

and on-going maintenance costs are considered well beyond the reach of the advocates for the community garden proposal.

### **1.5.3 Park Maintenance Upkeep**

Council contractors who mow the grass and maintain Laurenson Park fortnightly need to be commended for their high standard of work associated with the park's upkeep, making it a desirable place for locals/visitors to congregate and enjoy. Mowing this substantial parcel of land requires large machinery. The ability of the garden group to maintain current upkeep standards on a volunteer basis is considered unachievable. No evidence has been provided supporting how current maintenance standards will be upheld. This is most concerning in view of the park becoming visually degraded, a feat difficult to accept when rate funding for park maintenance will be siphoned off and utilised elsewhere.

### **1.5.4 Water Usage**

Water reticulation in Diamond Harbour is a precious commodity, pumped from Heathcote at a considerable cost borne by rate payers. With pending government reforms and high upgrade costs inevitable, water usage will become closely monitored by service providers and users will be charged accordingly. High usage demands of a community garden are considered overtaxing on an already stretched resource, particularly in the summer garden season when rationing in the area is often applied. Water usage for a garden community on the scale proposed is considered excessive. Funding the real cost of water usage for the scale of gardening activity proposed is considered unachievable.

### **1.5.5 Drainage**

With community garden water usage considered high, drainage into neighbouring properties is concerning. In times of heavy rain, introduced catchment areas such as tunnel houses and associated infrastructure will harvest storm water in concentrated quantities, creating water flow channels that do not naturally exist. Issues may require adequate drains to correctly direct concentrated storm water through private properties. Drainage setup infrastructure and maintenance costs are considered uneconomic and not viable.

### **1.5.6 Vermin + Pests**

Community garden activity on the scale proposed will attract vermin and pests, demanding a need for pest control with an appreciable cost attached. Pest control is not currently required for Laurenson Park.

### **1.5.7 Toilet Facilities**

Community garden volunteer workers will require a toilet. No toilets currently exist in the park. The capital cost of installing a toilet is considered appreciable with on-going maintenance presenting a burden for the community garden group to administer and fund. Health and safety issues associated with COVID-19 mitigation measures where toilets are involved introduce a public health risk. Protocols will need to be put in place and administered. Toilets in Laurenson Park are considered uneconomic and not viable.

### 1.5.8 Rubbish

Community garden activity on the scale proposed for Laurenson Park will inevitably generate non-recyclable rubbish and green waste with volumes anticipated to equate at least eight residential properties. Frequent disposal of this high quantity of waste will inevitably require either a commercial collection arrangement or reliance on Council bin collections, both having considerable costs attached. A BBQ area will also require some form of rubbish collection facility, while recycling green waste will require machinery with a high price tag. Costs of rubbish disposal are considered beyond the reach of the garden group. Laurenson Park currently does not have any rubbish issue.

### 1.5.9 Fire Risk

Community garden activity will increase fire risk especially during the summer months as a result of compost processing, machinery or arson. Mitigation measures to protect garden infrastructure and neighbouring properties will be required. Currently the park has no fire risk and fire mitigation plans are not required.

### 1.5.10 Vehicle Access to Infrastructure/Vandalism

Laurenson Park becomes extremely dry in summer. On the contrary, the park has been known to be very wet underfoot in winter with authorised vehicles becoming bogged and stuck. A metal reinforced vehicle access way proposed to gain ingress/egress to garden activity infrastructure at the northern end of the park will occupy a substantial parcel of land, with a negative result of eliminating open green space activity.

Vehicle access will moreover attract undesirable visitors into the park, introducing noise at night. Vandalism will become inevitable. This problem is not new to Diamond Harbour. Autumn Bradley Park gets locked nightly. The community Scouts/Playcentre facility has been a vandalism target problem for decades. The Buchanan family strongly oppose any vehicle access being developed within Laurenson Park for this very concerning reason.

Capital and on-going maintenance costs associated with a metal reinforced vehicle access through Laurenson Park are considered substantial, uneconomic and not viable.

### 1.5.11 Community Benefits

The Buchanan family encourage and support in principal the concept of a community garden. Such activity can bring benefit to those not physically able or lacking adequate space and time to accommodate a garden within private property.

Education in view of a greener and sustainable future is currently undertaken at the local school; a duplicate garden group can complement such learning opportunity while building friendships and developing cohesion among local residents. These positive outcomes are supported but not at Laurenson Park.

### 2.0 Conclusion

Community garden activity needs to be proven viable by starting small and building up to a sustainable level. Space allocation requirements are considered to be way less than the whole area of Laurenson Park. Other garden groups located in Kaiapoi and earthquake evacuated areas of Christchurch occupy area only one tenth the size of Laurenson Park, with community volunteer capacity and servicing costs within reach and manageable.

Alternate Council locations in Diamond Harbour such as Whero Avenue, Stoddarts Point and Hunters Road destined for sale or alternate land use offer adequate setup garden activity space opportunity. New sites can be properly planned, sized, equipped with services, shelter and other requirements, to accommodate the community garden group's needs for the foreseeable future.

Laurenson Park's deeded purpose needs to be upheld with its reserve status protected in perpetuity. The Park needs to be safeguarded and retained in its current fit for purpose form, to accommodate open green space activity that local residents, visitors, and park users can enjoy for generations to come.

With cons outweighing pros, alternate sites readily available, the motive to take away open green space activity to make way for a community garden is unacceptable to local residents, park users, visitors and the wider community, hence the Buchanan family's strong opposition to the lease proposal is hereby lodged.

*W. D. Buchanan*



Submission #43574

[Back to submissions](#)



Submission ID	Support / do not support	Comments - Please be as specific as possible to help us understand your views	Name
		<p>Laurenson Park is valued by this community as open green space. Particularly as the area continues to be developed, this becomes ever more treasured. If consultation ascertains there is a need, I believe the community is open to a co-design process that could use a small portion of the reserve. Food resilience is an important issue that we can all support, if done thoughtfully.</p> <p>Thank you for ensuring this proposal goes through proper process.</p>	
43562	No	<p>Our property backs on to Laurenson Park. I have serious concerns about:</p> <p>Noise</p> <p>Negative visual impact of proposed buildings</p> <p>Negative visual impact of whole garden if it isn't maintained well, and who will be responsible if it isn't properly maintained?</p> <p>Loss of dog walking space (used often by locals)</p> <p>Loss of landing area for Westpac Rescue Helicopter</p> <p>Potential to be a gathering area for groups of people - undesirable behaviours?</p> <p>Loss of value to my property</p> <p>Potential run-off/drainage issues on my property</p> <p>Loss of back access from my property to the park</p> <p>Loss of area for community children and youth group to play</p> <p>Loss of green, open space for the community - most people have gardens, why do we need more? Could the volunteer group take on the school garden instead?</p>	Lou & Dave Heath
43547	No	<p>We have had at least 2 efforts at providing community gardens for this area in the past and neither were supported enough after the initial enthusiasm and turned to garden messes. The majority of people in this area have large enough sections to develop their own gardens or could share gardens. Laurenson Park although under-used as it has no play equipment, is used by emergency helicopters as one of the very few flat areas for landing. It is also used by the fire brigade for practices with hoses etc. It has also been used for boot camp training. We have no other large flatish areas here so if this is taken over, it would be a tragedy. There are existing community gardens at the school and an invitation one at Orton Bradley Park already now. How many of the people advocating for this are prepared to be involved for 15 years? The last community garden at a different area of Orton Bradley Park lasted 2 years and the one at Purau lasted 3 and was vandalised and fruit trees ripped out. Community gardens, to be successful need a large number of volunteers and especially for an area as large as this. There are so many volunteer groups already operating in this area to maintain the Hall gardens, Orton Bradley Gardens (all flower gardens) and the school vege garden to name a few. Are there enough volunteers with the time necessary to develop and continue a garden of this size in a prime position? What happens if it fails? Who is responsible for it then? There is a benefit to the CCC because they will no longer have to mow it and they have difficulty keeping up with the mowing in this area now. But if the garden does not have enough volunteers, then it will be a huge mess. One of the reasons the Purau Community Garden failed was that at that time, people came along to learn how to garden but then did their own gardens at their homes and no longer had a need. There was a shared produce stand at Diamond Harbour for a year but it too failed as most people had their own produce or got it from a neighbour. It is not as if we have apartments or small sections in this area where people don't have enough space to garden. There are a huge number of volunteer opportunities if it is company people want. Don't do this.</p>	Pat Pritchett
43494	No	<p>I think that a community garden would be fantastic. But a few thoughts.</p>	Kim Smith

# Submission #43494

Back to submissions

 **Dawn Sutton** ▸ **Diamond Harbour, New Zealand** ...  
29 October at 15:12 · 🌐

Hi All  
The Te Ahu Patiki/Mt Herbert Community Garden group just wants to do a big THANK YOU to the following people for helping out with items for the Diamond Harbour School Garden.  
Karen Broomhall and her daughter for loading and transporting the topsoil we needed.  
Trish Randall – for providing the soil  
Jenny Timothy and Christine Turner for the wheelbarrows  
Kathie Smith for the hose and sprinkler  
The Diamond Harbour Four Square Team for the supply of cardboard for the weed suppression.  
THANK YOU



 **Michele Cherry** ▸ **Diamond Harbour, New Zealand** ...  
11 October at 10:33 · 🌐

Hi everyone, A request for Te Ahu Patiki/Mt Herbert Community Garden. We're needing a trailer load of top soil. Can anyone help or does anyone know of someone who may be able to help?  
many thanks

👍 2 20 comments

👍 Like    💬 Comment

 **Dawn Sutton** ▸ **Diamond Harbour, New Zealand** ...  
24 October at 17:11 · 🌐

Hi All  
The Te Ahu Patiki/Mt Herbert Community garden group is currently helping out with regular working bees up at the Diamond Harbour School garden and we would love to "adopt/rehome" any unwanted/unused wheelbarrows out there. It would be a great help with the gardening work we are currently doing.  
Thanks



 **Michele Cherry** ▸ **Diamond Harbour, New Zealand** ...  
26 July at 10:17 · 🌐

We, as in Te Ahu Patiki/Mt Herbert Community Garden have very generously been given 14 different varieties of berry cane cuttings. We intend to put them in buckets of soil to heal until we begin planting the food forest. (yip very exciting) Does anyone have spare buckets we could use and also clean soil - enough for 14 buckets? Many thanks

 **Dawn Sutton** ▸ **Diamond Harbour, New Zealand** ...  
29 October at 15:24 · 🌐

Hi All  
The Te Ahu Patiki/Mt Herbert Community garden group is currently helping out with regular working bees up at the Diamond Harbour School garden and we would love to "adopt/rehome" any unwanted/unused **BATHTUBS** out there. The aim is to to add a series of raised beds to plant flowers/herbs etc to attract pollinators to the garden.  
If you can help out with this project just comment below - we can arrange pick up. Acrylic/fibreglass would be easier to transport but happy to pick up cast iron ones as well.

Thanks



 **Michele Cherry** ▸ **Diamond Harbour, New Zealand** ...  
8 March at 09:50 · 🌐

Hi Everyone,  
Re Exploring the possibility of a local community garden  
My sincerest apologies. There has been a wee hiccup re the room hire so I've needed to change the date of our inaugural meeting to the following evening **Tuesday 30th March at 7pm in the Green Room**. I'm so sorry and hope this won't inconvenience too many of you. Anyway hope to see you there and then to share our thoughts and ideas. A community garden is such an exciting possibility. P.S Would love you to share this info with anyone/neighbours you think may be interested but who aren't on FB. Many thanks  
Michele



Submission ID	Support / do not support	Comments - Please be as specific as possible to help us understand your views	Name
		<p>The group requesting it only formed their group this year, I think in June? They want a 15 year lease?How do we know they will stay a formed group etc? Will they be able to maintain such a large area?</p> <p>It may become a huge mess.</p> <p>They are constantly on The community Facebook page asking for trailers and soil and everything to make things. So don't feel they have the tools/materials to even start one.</p> <p>I understand it is a 'community' garden and it's great if others in the community can offer things they may have laying around BUT perhaps they may need to fundraise a bit more or invest to actually have funds to start one. If they were a group that had been around for years that might seem like they had the commitment etc</p> <p>Why not continue to use the school garden and help there to make that bigger and better?</p> <p>Will this be used for dumping green waste?</p> <p>If so that is a problem as How will they control that if it is, weeds etc.</p> <p>The location is on the main road, Have they thought of the possibility of it being vandalised etc</p> <p>It's also a spot that is used for lots of children/family after school, mostly in summer as it is right across the road from the school.</p> <p>I just feel the location is not the right one.</p>	
42617	No	<p>I live immediately adjacent to the park on Marine Drive and have lived there for almost 16 years. I am opposed to the leasing of Laurenson Park for a community garden for the following ten reasons:</p> <ol style="list-style-type: none"> <li>1. The Park is a large space that would require considerable upkeep and large resources to plant, water and maintain. It is a very windy space that is difficult to nurture plants ( we have been growing our hedge for 14 years with difficulty).</li> <li>2. The Park is currently used by many people each day as a free, open space. My children have used the park to run, explore, climb trees, fly kites, ride bikes without restrictions of structures or pathways.</li> <li>3. I am concerned about security and privacy for neighbouring properties. If the land is a gathering space how would this be managed? How would security of produce and plant stock be managed? Security of proposed sheds?</li> <li>4. The Park is used fairly regularly for the rescue helicopter to land and the DH Fire Brigade to train. How would this be impacted?</li> <li>5. The road shoulder on Marine Drive is in disrepair and not suitable to manage more vehicles.</li> <li>6. I have concerns about noise for neighbours (equipment and people gathering). How would this be managed?</li> <li>7. There is evidence that community gardens are difficult to sustain (even on a small scale) and I have concerns about what would happen in event of failure. How would the restoration of the Reserve be managed and who would be responsible to returning it to its current state?</li> <li>8. I have health and safety concerns around clear access to neighbouring properties in case of emergency and also the creation of hazards from garden structures and storage.</li> </ol>	Nicola Green

Submission ID	Support / do not support	Comments - Please be as specific as possible to help us understand your views	Name
		<p>9. Living adjacent to the park as a free, green space is part of the appeal of our property and one of the reasons we purchased it. I have concerns that a community garden would lessen this appeal and the subsequent value of our property. This particularly true if the garden was not successful and left in a state of disrepair.</p> <p>10. I question the need of a community garden in Diamond Harbour where many people have gardens and share produce. Diamond Harbour School has a garden which has been searching for volunteers throughout my 13 year involvement with the school- this would be a more appropriate and realistic place to reap the benefits of the enthusiasm of this gardening group.</p>	
42223	No	It will completely change my peaceful neighbourhood.	John Paton
42220	No	<p>I wish to strongly oppose lease of Laurensen Park For may reasons which I will willingly discuss at Hearing Panel.</p> <p>It is an idyllic setting as the property backs on to Laurensen Park.</p> <p>This park has many uses for locals including a haven for dog walkers, residents children as a safe place to play games.</p> <p>It is also used weekly as a training area for the local Fire Dept. Also used as a landing station for Rescue Helicopter.</p> <p>As a resident here for the last ten years, both my husband &amp; myself found it a safe haven after the trauma of losing our home in Mt.Pleasant due to the February Earthquake.</p> <p>We were homeless for some time as it was difficult finding a furnished home to rent &amp; were so grateful to find such a place in Diamond Harbour.</p> <p>I bitterly oppose any idea of leasing Laurensen Park.</p> <p>The simple reason is that there are ample amount of land elsewhere in area which does not impede on residents lifestyle or more importantly, peace of mind.</p> <p>I wish to attend any further discussion on this matter. As a resident &amp; ratepayer, it would appreciated if the public were made aware of further discussions instead of discovering plans via a flyer delivered outlining</p>	Rosaleen Margaret Paton

Submission ID	Support / do not support	Comments - Please be as specific as possible to help us understand your views	Name
42163	No	<p>As the proposed use is allotments and related facilities for residents from Purau to Teddington this is quite a wide geographic area and would mean that people would be expected to drive to get to the allotments. There is nowhere for people to park except for a small gravel area on Marine Drive in front of the park or on Marine Drive itself. The park is opposite one of the primary school entrances and the gravel area and surrounding parts of Marine Drive is heavily used by parents during the mornings and afternoons for drop off and pick up at the school. If the use was approved, there would have to be controls so that users of the allotments cannot park near Laurensen Park during these times as this would add to traffic congestion and pose a hazard for school children.</p> <p>I also question the need for another community garden/allotments in Diamond Harbour, a community garden was set up recently near Waipapa / Te Ra Crescent. Is there really demand for another one?</p> <p>The newspaper advertisement states that the land is held by the Council as recreation reserve and the lease is proposed to be granted under section 54 (1)(b) of the Reserves Act. This information is not mentioned in your information on your have your say page above which is misleading if people do not have a copy of the newspaper advertisement in front of them.</p> <p>It is not possible to grant a lease for allotments and a community garden on a recreation reserve under section 54 of the Reserves Act. Recreation reserve means a reserve for a sport and recreational use and a community garden would not fall under this use. Section 54 (1) (b) says a lease granted can be for outdoor sports and games and recreation and for the building of sports pavilions and associated buildings. A community garden and buildings for storage and education is not covered by this. There is mention of a childrens play area but this is clearly a minor associated use and the main use is the allotments use which is not possible on a recreation reserve.</p> <p>The park is very close to houses and at the moment is only used occasionally by people for picnics or for walks. I would be concerned at the increase in noise for the nearby residents that would be generated by the use proposed.</p>	Louise Dawson
42131	No	<p>I made a previous submission in support but wish to withdraw it as I am confused about how much of the park this will take up. We live opposite the park and regularly use it for dog walks, and with a growing family it is our nearest open space. I would like clarity about how much of the park will be taken up with this initiative and how much remains as open space. It is essential that open space remains the main use of the park.</p>	Sean Whitaker
42130	No	<p>Hi. I am writing about the above park in Diamond Harbour that someone has suggested it be turned into a big vege garden.</p> <p>I am totally against this idea as it is one of only a couple of parks in Diamond Harbour and is used by a lot of people as somewhere where you can run your dogs (as well as other uses), and these are few and far apart, especially as you can't take your dog to the local beaches for five (of the best) months of the year.</p> <p>Most people's properties over here are big enough to have a veg garden.</p> <p>When I first heard this idea I thought it would just be one corner or slice of the park, but I am totally astounded that no it's not, it's the whole park.</p> <p>I would like it turned into a fully fenced dog park if it's going to change at all.</p>	Jenny Warmington
42119	No	<p>My submission on Laurensen Park leased for a community garden as follows:</p> <p>I am opposed to the proposal of Laurensen Park being converted to a community garden. I am not opposed to a community garden in Diamond Harbour but not placed on the high value, open space named Laurensen Park.</p> <p>The alternative place for this community garden would be the land currently proposed for disposal by CCC named 27 Hunters Rad/42 Whero Avenue.</p> <p>Laurensen Park is used at least twice per day by my family. It is essential to our health and well being to have an open space to walk our dogs off lead, train and play with them.</p> <p>The closest open space to do this activity is Stoddart Point, approx 2.5km away and a car ride away. Surely using a car to go and walk my dogs would not be logical or</p>	Steve Kinnings

Submission ID	Support / do not support	Comments - Please be as specific as possible to help us understand your views	Name
		<p>ecological thing to do. I can also use the cliff track but that is sometimes inaccessible when overgrown or wet. I also cannot throw a ball or frisbee for my dogs on the cliff track.</p> <p>I believe a community garden is a good idea but not on Laurensen Park, there are many people that enjoy this space, the only open space available to the community within a 2.5km range.</p> <p>If you decide to proceed and place a community garden in the hands of the gardening club I would propose only a small part being allowed for this use and at least half be allowed as open space for the community as it is now used.</p> <p>I suggest CCC require a management plan of how the group are going to manage it over 15 years and who is directly responsible. Should it fall into disrepair, then this group should foot the bill or be responsible of putting the park back to what it was. Ratepayers should not foot the bill to repair the park. In this management plan, the group should outline what their objective is, how they are going to irrigate, the effects of irrigation (over use etc) drainage and use of machinery on site, with considering the needs of the neighbours.</p> <p>They said they will be gardening organically, this needs to be defined by the club, as organic gardening has different meanings to different people.</p> <p>The management plan also needs to address the soil chemistry and what can be grown on there and the proposed sheds construction and maintenance regime. I propose that this management be part of the lease agreement, it should be part of the terms and conditions of the lease. Any non-compliance to be put right and not just changed in the lease to accomodate the gardening club.</p> <p>To summarise, I am opposed to Laurensen Park being used as the community garden but am happy for it to be somewhere else in Diamond Harbour, such as the land available by CCC named 27 Hunters Road/42 Whero Ave. Laurensen Park is a high value open space that services a community and I do not want to be restricted in my ability to use it for the purposes of walking, training and playing with my dogs.</p>	
41906	No	It's the only open area public park at that end of town. A place to walk dogs, to Picnic, to play team games. We already have a community garden at the school. And who will care for the place in a few years time when the current contributors move on from the idea or away?	Alison Fitzgerald
41901	No	<p>Leave it as it is.</p> <p>Upgrade the playground at James Drive reserve instead.</p> <p>Or offer the land to the volunteer fire brigade who have outgrown their premises. I'm sure they could do with this land more.</p>	Laura Palmer
41900	No	The park is about the only flat, easily accessible space in and around DH that elderly & less able people can exercise themselves and their dogs. If the restrictions continue on where you can walk your dog then soon there will be nowhere.	Kev Mair
41899	No	I don't support this if the entire park is used for a community garden and not shared by those who currently use this for exercise and recreation and to walk their dogs. It's easily accessible by foot and by car for those less able to access the tracks and surrounding hills and beaches.	Michelle Sintes
41898	No	<p>Lots of gardens already, school has it's own</p> <p>successful garden. If it's about community then we would be better served by some way of organising swaps, sale of all the vegies that people grow already. Open space that the public can access close by is at a premium, why take this.</p>	Andrew Nugent
41896	No	<p>I am opposed to the proposal of Laurensen Park being converted to a community garden. I am not opposed to a community garden in Diamond Harbour but not placed on the high value, open space named Laurensen Park.</p> <p>The alternative place for this community garden would be the land currently proposed for disposal by CCC named 27 Hunters Rad/42 Whero Avenue.</p>	Emma Kinnings

Submission ID	Support / do not support	Comments - Please be as specific as possible to help us understand your views	Name
		<p>Laurenson Park is used at least twice per day by my family. It is essential to our health and well being to have an open space to walk our dogs off lead, train and play with them.</p> <p>The closest open space to do this activity is Stoddart Point, approx 2.5km away and a car ride away. Surely using a car to go and walk my dogs would not be logical or ecological thing to do. I can also use the cliff track but that is sometimes inaccessible when overgrown or wet. I also cannot throw a ball or frisbee for my dogs on the cliff track.</p> <p>I believe a community garden is a good idea but not on Laurenson Park, there are many people that enjoy this space, the only open space available to the community within a 2.5km range.</p> <p>If you decide to proceed and place a community garden in the hands of the gardening club I would propose only a small part being allowed for this use and at least half be allowed as open space for the community as it is now used.</p> <p>I suggest CCC require a management plan of how the group are going to manage it over 15 years and who is directly responsible. Should it fall into disrepair, then this group should foot the bill or be responsible of putting the park back to what it was. Ratepayers should not foot the bill to repair the park. In this management plan, the group should outline what their objective is, how they are going to irrigate, the effects of irrigation (over use etc) drainage and use of machinery on site, with considering the needs of the neighbours.</p> <p>They said they will be gardening organically, this needs to be defined by the club, as organic gardening has different meanings to different people.</p> <p>The management plan also needs to address the soil chemistry and what can be grown on there and the proposed sheds construction and maintenance regime. I propose that this management be part of the lease agreement, it should be part of the terms and conditions of the lease. Any non-compliance to be put right and not just changed in the lease to accomodate the gardening club.</p> <p>To summarise, I am opposed to Laurenson Park being used as the community garden but am happy for it to be somewhere else in Diamond Harbour, such as the land available by CCC named 27 Hunters Road/42 Whero Ave. Laurenson Park is a high value open space that services a community and I do not want to be restricted in my ability to use it for the purposes of walking, training and playing with my dogs.</p>	
41888	No	<p>This is one of the only places we can currently exercise dogs off lead in Diamond Harbour. There are a lot of dogs in the harbour, and increasingly a lot of people moving from the city that don't like dogs. Having a park to take dogs to, where they can run around off lead is critical for both people who love and/or hate dogs! If somewhere else could be specified as a dog park I would support this. But without anywhere else to go rifts will very quickly develop between dog owners and those who feel threatened by dogs.</p>	Luke Wood
41879	No	<p>It is a great idea in principle but could end up an untidy mess if future locals don't support it.</p> <p>Also it has been used by the Rescue Helicopter on several occasions.</p>	Hedges Robyn
41861	No	<p>While we appreciate a community garden would be great, this area is better kept as an open green space &amp; have this garden in the area above the school on Hunters Road. It is very built up around Laurenson Park at present &amp; we will come to a point where we have very few parks with continual increase in population year on year.</p>	Lynette Hughan
41860	No	<p>I think only a part of the park should be used as a garden.</p> <p>The rest should be kept for children, dogs, etc, ie, current use.</p>	Warwick Hornsby
41849	No	<p>A green open space as it is is our preference. I use it every day to run my dogs and enjoy the open feeling of it</p>	Kate Hitchings