

T CHRISTCHURCH CITY COUNCIL AERIAL PHOTOGRAPHY CREATIVE COMMONS ATTRIBUTION 3.0 NEW ZEALAND LICENSE



Legend

- Existing Tree To Be Retained
- Existing Tree To Be Removed
- Proposed Specimen Trees - *Dacrydium dacrydioides*
- Proposed Specimen Trees - *Podocarpus totara*
- Proposed Specimen Trees - *Prumnopitys taxifolia*
- Proposed Specimen Trees - *Pseudopanax crassifolius*
- Proposed Cabbage Trees (Refer to planting plans for more Cabbage trees & locations)
- Proposed Rock Boulders
- Proposed 60-100mm Round Gravel Area
- Proposed Asphalt Path
- Proposed Concrete Area
- Proposed Exposed Aggregate Concrete Area
- Proposed Compacted Grit Path
- Proposed Low Timber Boardwalk With Kickrail
- Proposed Dress with Soil To Smooth & Grade Lawn Areas & Hydro Seed
- Proposed General Plant Beds
- Proposed Swale / Wetland & Riparian Margin

NOTES:
 - All plants to be eco sourced.
 - Plant grade subject to change depending on availability
 - Planting design to factor CPTED considerations, eg sightlines
 - Refer to general specification and CSS

- A** Drinking Fountain With Bottle Fill & Dog Bowl (Walkspace - DF02)
- B** Te Mata Picnic Set 1800mm
Te Mata Picnic Table 2400mm for Accessible (Acc) (Street Furniture NZ)
- Seat** Te Mata Seat With Back & Armrests 1800mm (Street Furniture NZ)
- Bench** Te Mata Bench 1800mm (Street Furniture NZ)
- 1** Public Toilet (Exeloo Twin)
Floor finish level 11.20m
Total floor area 12.5msq
Total roof coverage area 43msq
- 2** Shelter with the timber structure
On concrete footing and floor
Steel profile roof (weatherproofed)
Picnic tables and seating
Total roof coverage area 68msq
Height 4.5m
- 3** Shelter with the timber structure
On concrete footing and floor area
Timber Slabs top (water permeable)
Seating area
Total roof coverage area 68msq
Height 4.5m
- 4** Proposed Entrance Vertical Art Sign
Concrete Foundation
Approx 1.5 x 1.5m dimension
Height 4 - 5m
- 5** Landing connection with water
providing river access area for the pedestrian
Design with a more natural approach
Gravel infill steps with timber edge sleeper
Gravel infill beach with rock boulders edge
Leave approx 2m of river bank undisturbed
Planting in between rock boulders & river edge

PROPOSED SITE PLAN

© COPYRIGHT CHRISTCHURCH CITY COUNCIL. AERIAL PHOTOGRAPHY CREATIVE COMMONS ATTRIBUTION 3.0 NEW ZEALAND LICENSE

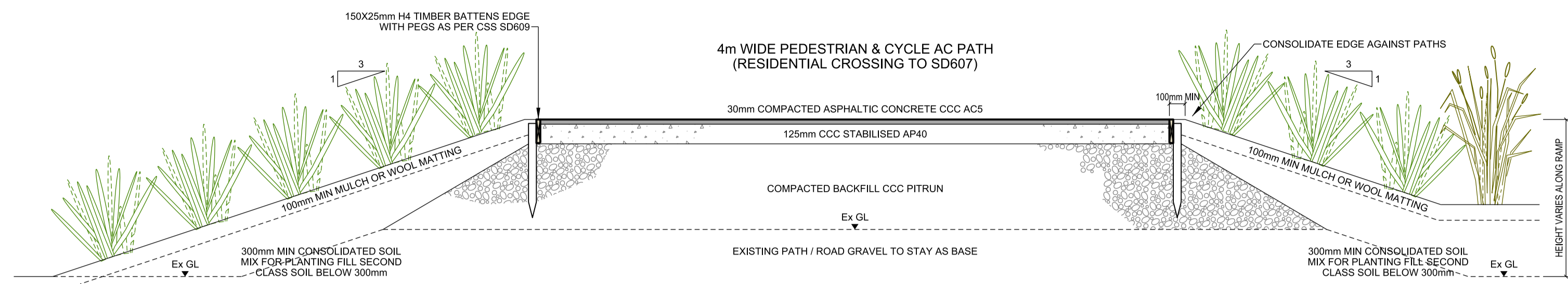

TYPICAL CROSS SECTION (A) 02
1:25

Notes:
All existing stopbank to be retained and protected during construction.
Stopbank shall be maintained at a minimum ground level RL11.00 at all time to prevent flooding.
Stopbank material compacted CAP100 (Pit Run with Silt blend) with 100mm topsoil for grass.

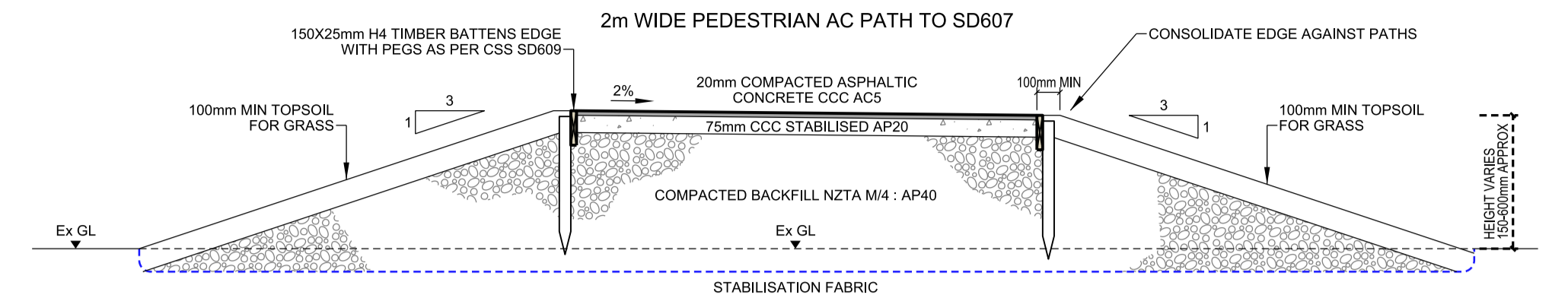

TYPICAL CROSS SECTION (B) 02
1:25

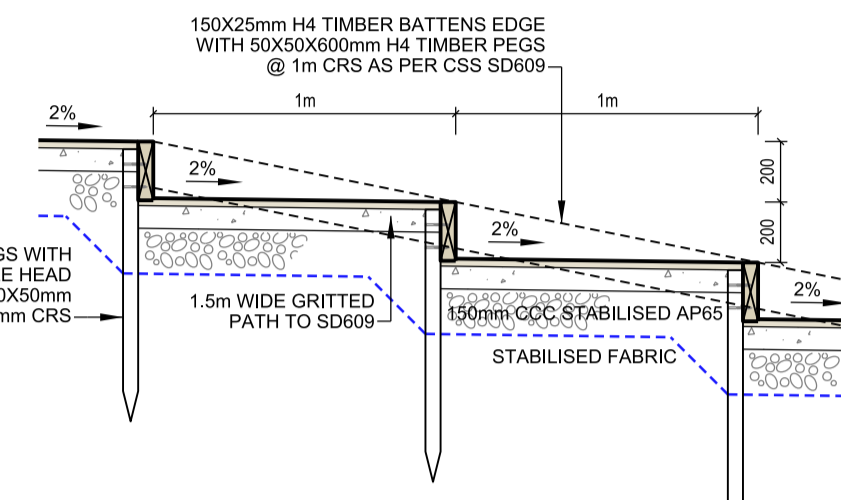

TYPICAL GRITTED STEPS CROSS SECTION (E) 02
1:25

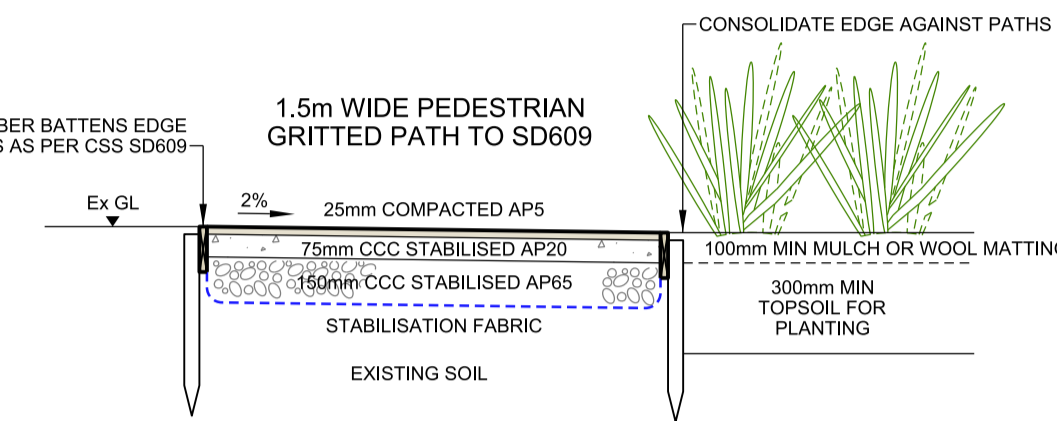

TYPICAL CROSS SECTION (C) 02
1:25

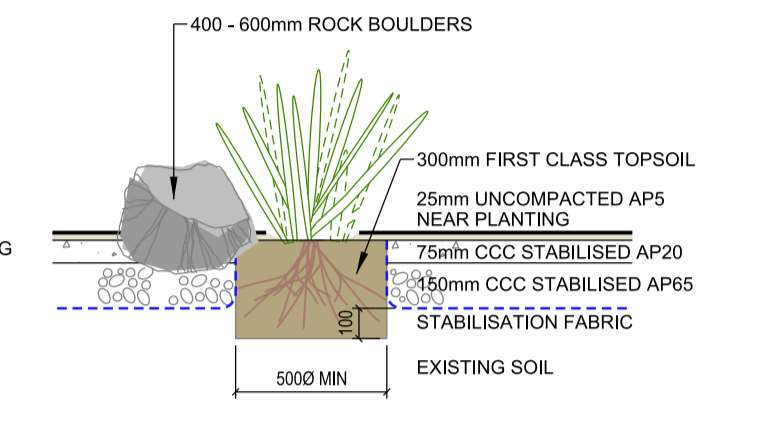

PLANTING IN GRITTED PATH
TYPICAL DETAIL 1:25

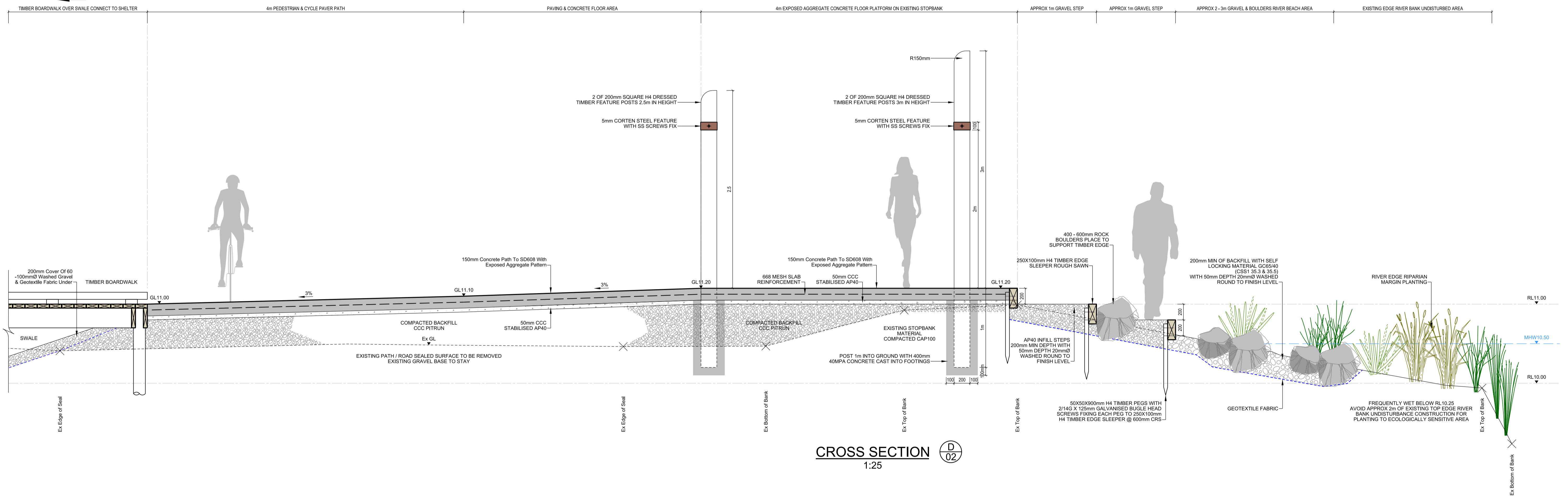

CROSS SECTION (D) 02
1:25

Note:
Existing Locksley Avenue gravel ramp near the bridge to stay as base.

© COPYRIGHT CHRISTCHURCH CITY COUNCIL. AERIAL PHOTOGRAPHY CREATIVE COMMONS ATTRIBUTION 3.0 NEW ZEALAND LICENSE

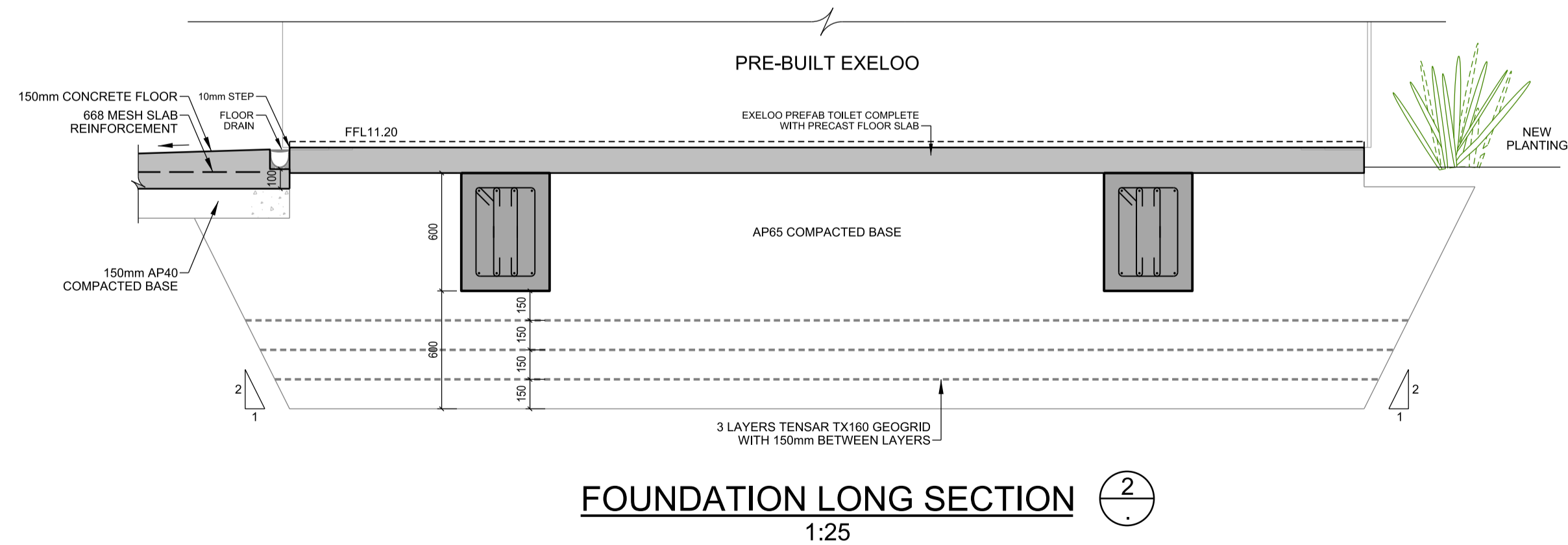
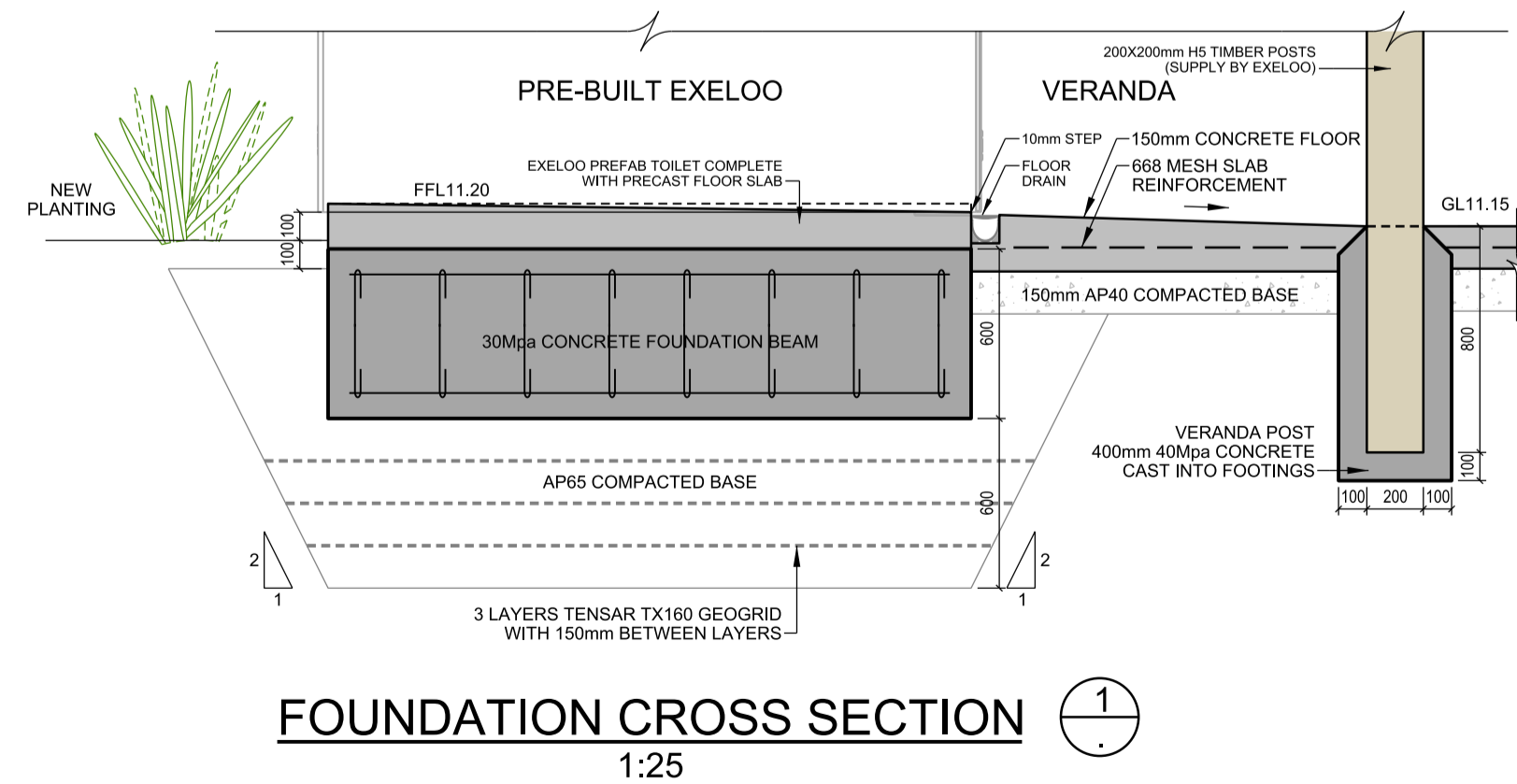
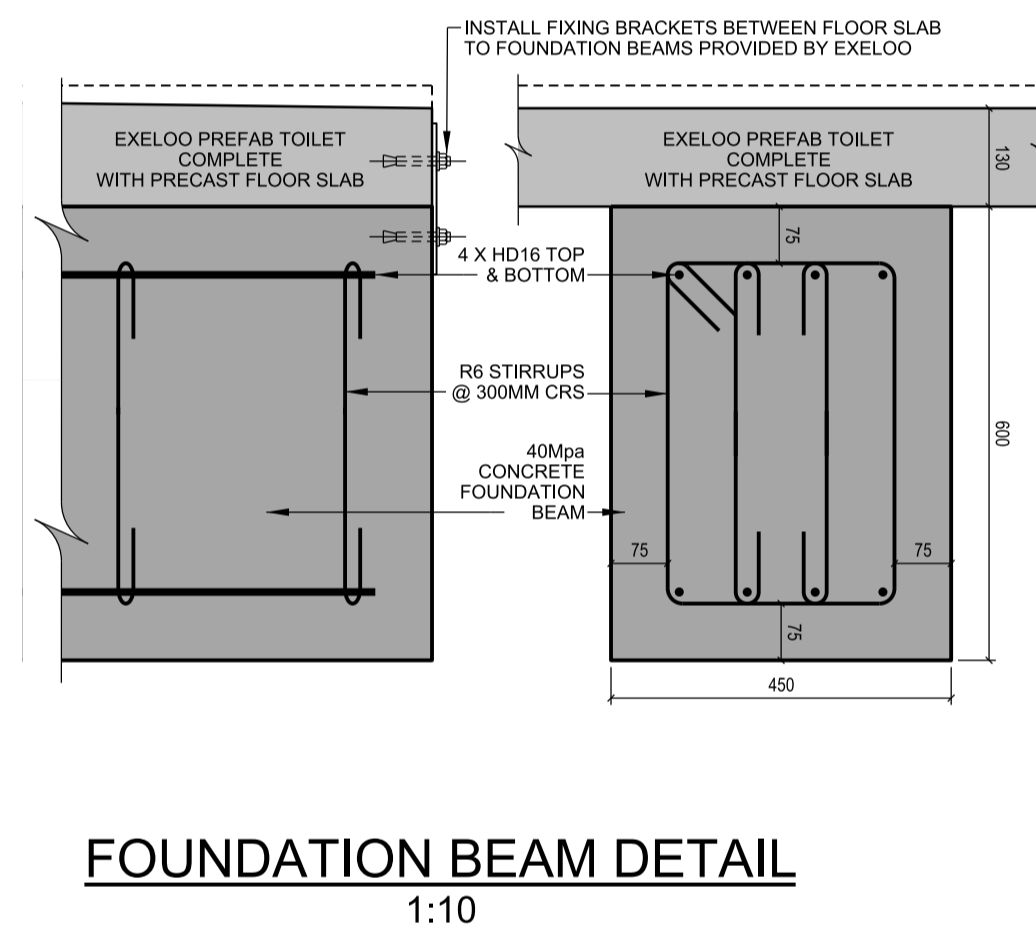
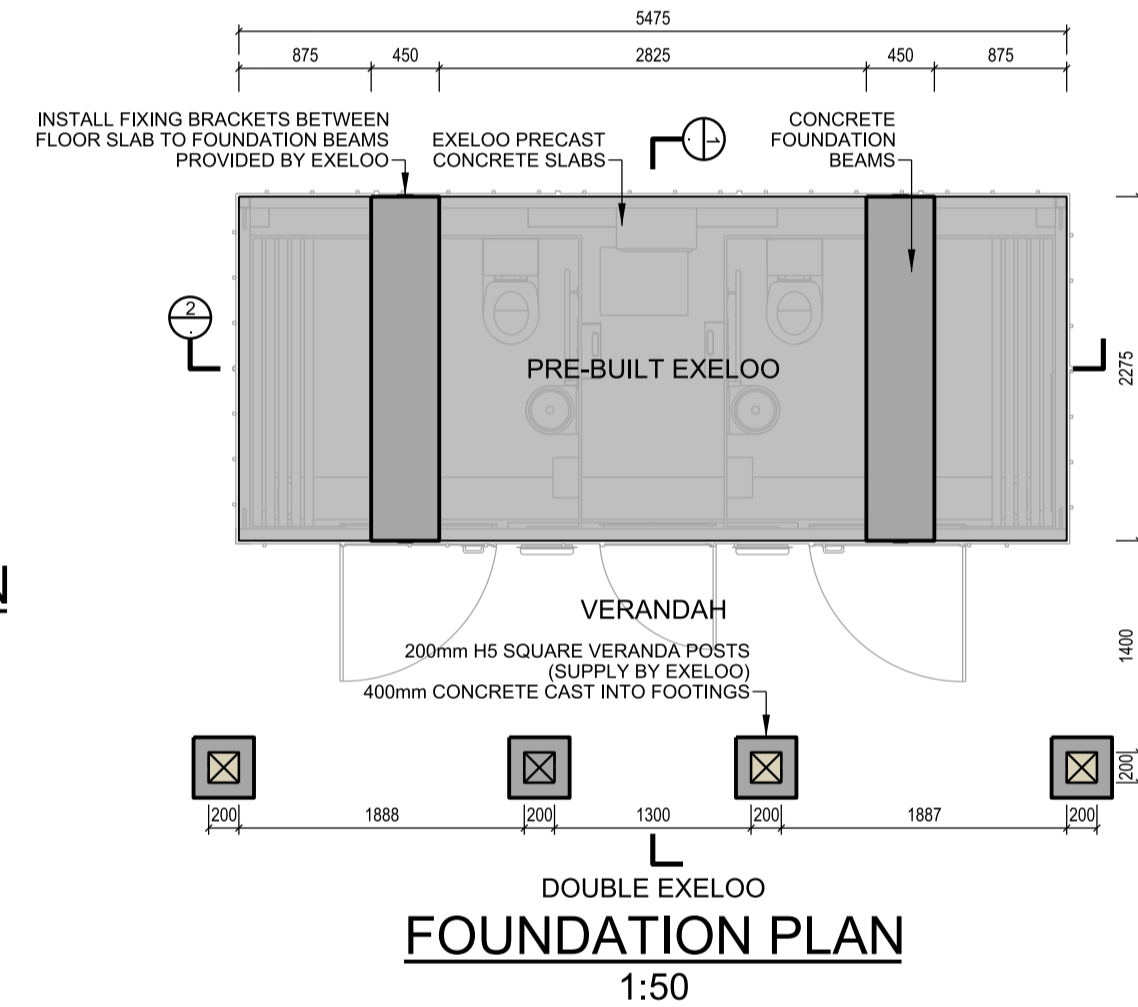
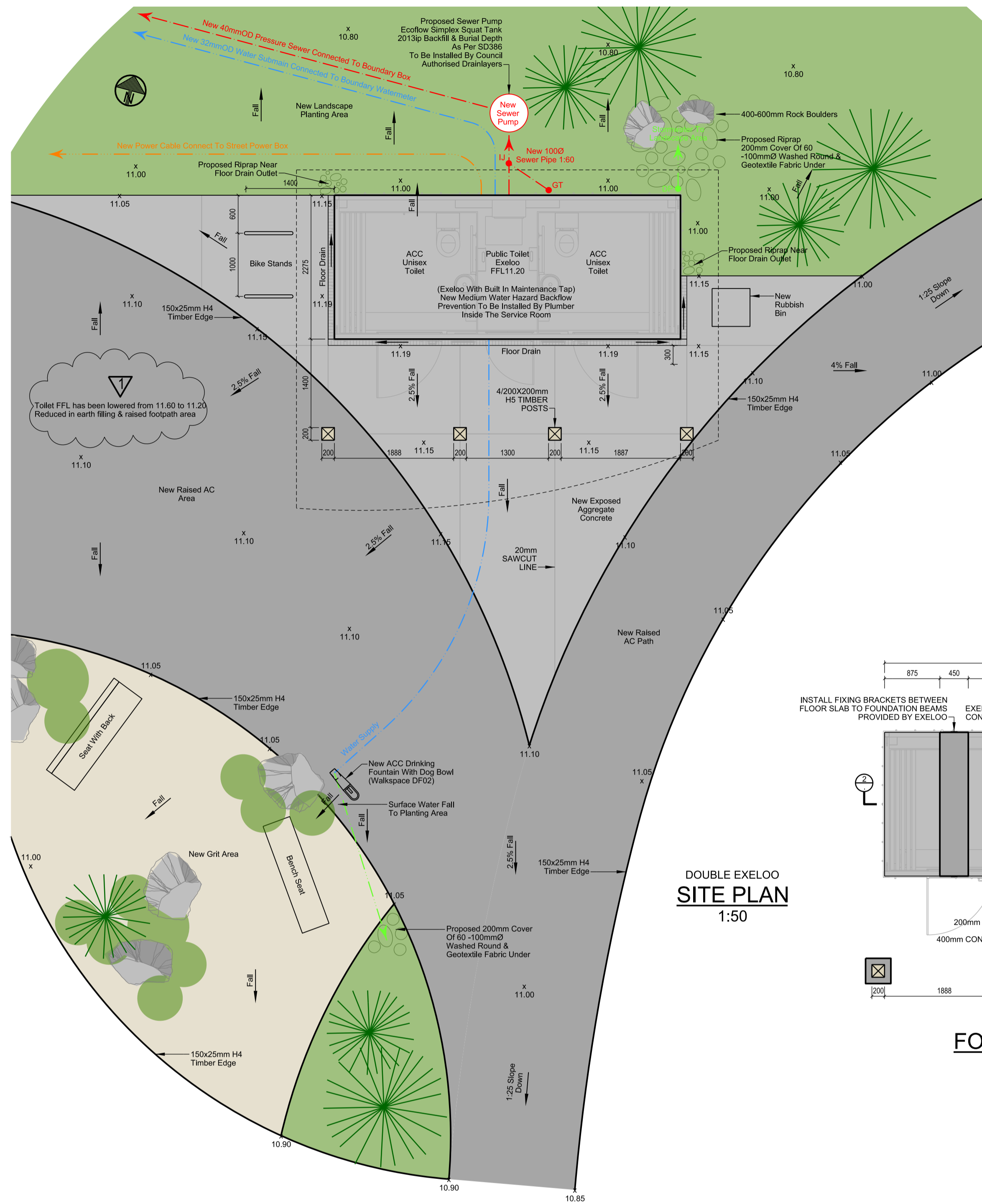

300 Original size mm
200
150
100
50
30
10
0
© COPYRIGHT CHRISTCHURCH CITY COUNCIL. AERIAL PHOTOGRAPHY CREATIVE COMMONS ATTRIBUTION 3.0 NEW ZEALAND LICENSE



Corrugated iron roof



70x45 timber slat roof

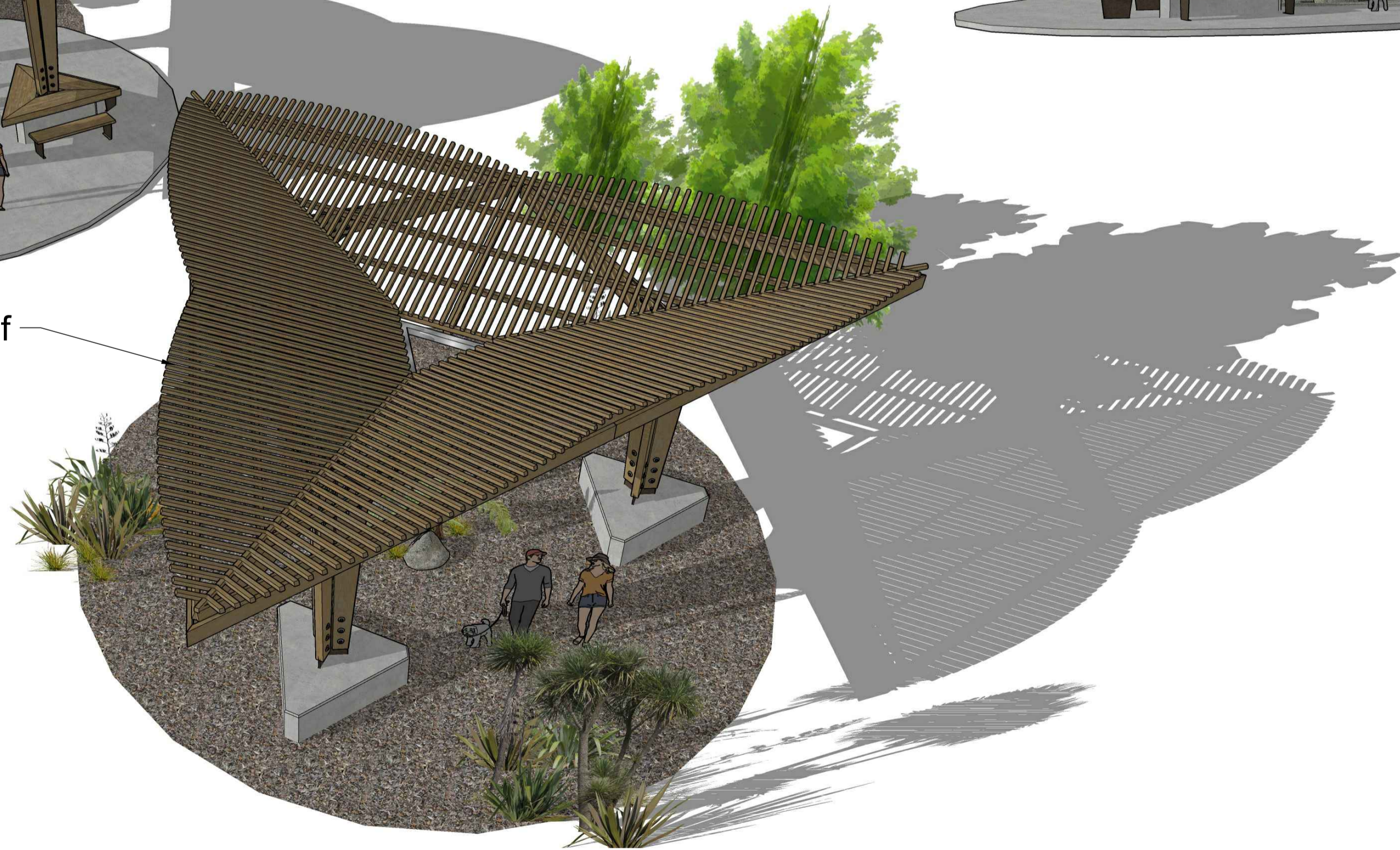

300 Original size mm
200
150
100
50
30
10
0
© COPYRIGHT CHRISTCHURCH CITY COUNCIL. AERIAL PHOTOGRAPHY CREATIVE COMMONS ATTRIBUTION 3.0 NEW ZEALAND LICENSE

