

Submissions in support of the proposal to lease an area of Elmwood Park to the Old Boys Collegians Cricket Club for cricket practice nets

Submission number	Comments	First name	Last name
32660	<p>Christchurch Metro Cricket submission</p> <p>Christchurch Metro Cricket (CMCA) are the governing body for adult and youth cricket in Christchurch. We manage and deliver all levels of community cricket. The Old Boys Collegians Cricket Club are a member of the CMCA whose men's and women's teams play in competitions under our jurisdiction.</p> <p>The Old Boys Collegians Cricket Club are the largest club in the South Island with over 600 members. This equates to 50 junior teams, 12 adult teams and in house programmes for 5-7 year olds from their community. In examining the club database, 85% of junior members live within a 5km radius of Elmwood Park, showing what an important role the club play in the fabric of the local community.</p> <p>Providing a safe and secure training facility for players and coaches, which also helps keep other park users safe is a must for Elmwood and the revamped proposal both meets that need and helps meet the concerns that were raised in the first consultation phase.</p> <p>Christchurch Metro Cricket are fully supportive of this plan.</p>	Mike Harvey General Manager Christchurch Metro Cricket	
33203	St Andrew's College are supportive of this proposal.	David Evans, General Manager St Andrews College	
32809	<p>St Andrew's College has a strong link with OBC especially in the Junior Grades. We have been able to share our facilities, but the current nets at Elmwood Park are in dire need of some upgrades as they have become very worn and run down.</p> <p>the proposal of shifting the nets around will have no impact on the current look of Elmwood Park they can only enhance the area with more modern and updated facilities.</p> <p>OBC plays a major part in the development of youth cricket and giving these youngsters the skills to play and enjoy cricket is a major factor in making sure we support the new cricket net design.</p>	Mike Johnston, Director of Cricket, St Andrews College	
32724	<p>Elmwood Croquet Club submission</p> <p>We support the new plans for the nets in the new position and do like the idea of retractable nets.</p> <p>The nets are placed near the new pavilion so good supervision is able to be provided by the club.</p> <p>The nets are parallel to the path so no stray balls towards the tennis club.</p> <p>The nets are used continuously by many children with and without parents which is great to see all year. When we are encouraging children to engage in sport it would be a great pity not to provide a facility for them to use continually .</p>	Jenny Tait, President Elmwood Croquet Club	
33331	Make's the ground safe for players the children to practice and the community to walk around the park	Mike	Hamel
33285	Why has this taken so long? The current nets pose a danger to both park users as well as pedestrians walking through Elmwood Park. The revised proposal, which in my opinion should not have been necessary seems like more than a reasonable compromise, which I would now dearly like to see progress.	Greg	Riach

33284	Fully supportive	Adrian	Simmons
33271	Most parks in Christchurch are used for sporting purposes and don't think this park should be an exception. We live next to Nunweek park which is used for a variety of sports, currently with goalposts that have been erected for rugby and soccer for this season. My son plays soccer at Tullet Park in the winter and plays cricket at Elmwood park over the summer. I believe that there should be a standard across all parks to encourage recreational/school-aged sports. It is a place where we can grow our future professional athletes or just to foster a good attitude towards exercise.	Megan	Brook
33261		Ross	Meade
33226	Elmwood is a beautiful park for Cricket.	Brett	Hales
33217	Outdoor sport is good for kids and adults. Although I live in SA I have been to the facility and would like to see it continue	Bert	Ewing
33215	Yes, but only if the nets are open to the public. The nets need to be available to all to use, as it means there's a greater chance of someone new trying the sport out. For example, a young child is down at Elmwood Park and thinks to him/herself "I want to try cricket out", but the nets are reserved for OBC use only, it could deteriorate that child from giving it a go.	Toby	Lambert
33213	The new nets look perfectly find in my view! My children have all played cricket for OBC. I would much prefer them to play in new nets that take up a small amount of grass than to be stuck inside on a play station!	Jane	Steel
33211		Rosalind & Alistair	Smith & Cocks
33210	Our three children play for Old Boys Collegians, and we spend a lot of time at Elmwood Park over the cricket season. I believe the proposed nets would make the area safer for all park users, as well as providing the much-needed upgrade to the net facilities.	Emma	Norrish
33209	I support new nets at the park. Our 3 kids play for OBC, and we spend a lot of time at the park, it will greatly improve safety for all park users.	Matt	Moore
33207	It is ridiculous that a cricket club like OBC, that boasts cricketing history beyond most other cricket clubs in NZ, has been held to ransom by a vigilante group of regressive thinking individuals. Elmwood Park was gifted to the city for two purposes - polo and cricket. Old Collegians Cricket Club have called it their home long before ANY of the locals that currently surround the park took up residence (or voice their opinion from homes well beyond a cricket ball throw of the park). Old Collegians merged with Old Boys Cricket Club in a strategic development move so that both clubs could survive and keep their history - progress. The newly formed OBC cricket club sold their Hagley Oval pavilion to allow the world class Hagley Oval to be established in its place - progress. The old changing rooms, post earthquake, were pulled down and temp building established so it conformed to CCA requirements - progress. New wooden deck installed to tidy up that corner of the park post earthquake - progress. Cricket nets proposal to turn them off the grass oval area (for aesthetics of the park) and enclose for safety - progress. For people to be against this sums up the pathetic thinking of some minority individuals and leads to question of 'why bother' trying to improve things for the community, both cricketing and local) when a process can be hijacked by the minority selfish.	Andrew	Hopping
33204	We live nearby Elmwood Park and use it almost every day and cannot see how the proposed new practice nets will have even a minor effect on the park environment. We have always thought the present practice nets are a disgrace and a detriment to developing high-class cricketers. The run-up area is a grassless, even dirt track that is not only dangerous for bowlers but does not allow the proper training and development facility that our young cricketers deserve	RW & SF	Colthart

33202	<p>Yes we are big supporters</p> <p>(a) Great to get more young people into sport, and getting them the skills required, so they have less chance of just giving up with sport. (b) Great to get increased safety for the public and players when matches are in progress (c) Enables practice and coaching to continue even as games are being played (d) Will look a lot better from a visual point of view (e) Lovely new club house, what is there at present is rather ugly! New design look awesome (f) Hope better and more toilets, for mens and womens are in the plan for the club house. (g) Don't know why the neighbours are complaining, cricket has always been played here and nothing really has changed for them. (h) Can be used in good or bad weather with the astro-turf</p> <p>11.05.2020</p> <p>Hello – Further to our submission Ref: 33202. If its not too late could you add this additional item to our submission if possible. I have read some of the history of Elmwood Park and the fact that the land was donated around 1910 to the citizens of Christchurch by the Heaton Rhodes family, and they also planted most of the beautiful big trees. The idea being for the park to be used for a sporting ground for Elmwood School and for other sporting events as well, and the tennis club and bowling greens and playground were all part of the scheme.</p> <p>Barbara and I think C.E Rhodes and Sir Cecil Rhodes and other family members would all be “turning in their graves,” if sport and spectator enjoyment was not brought into the modern world with the Club house and nets, where everyone can enjoy it and learn new skills at the same time!! Any householders in the area complaining would have known, before they bought a house in the area, that the park has always been quite busy and a bit noisy particularly on weekends</p> <p>Good luck fighting off the doom and gloom folks!</p>	Edward and Barbara	Mace
33201	<p>The current nets at the club desperately need an upgrade. The current nets are not good for safety, batsmen hit out into the park and near a pathway. The run ups are dusty. The new proposed nets are fully enclosed which will greatly improve health and safety. I see they can be retracted during the winter season, which is an excellent idea to reduce impact on the park.</p> <p>It appears that the improvement proposed to the existing nets will improve the park for all users. This facility is a great asset to the local community as well as cricketers. It is very important that it is maintained to a safe standard.</p> <p>Many local children and young adults use these nets, they are an important tool for training in cricket. The game of cricket is very important to the local community and it brings many people together every weekend. It is important that our players have good facilities to keep them in the game and enjoying their sport. Happy, busy sporty children and youth are good for the community!</p>	Joanne	Carrell
33200	<p>The current nets are old and dangerous. It has always been a wonderful park for cricket and after all the time in lock down children and adults need to have something positive to look forward to. People playing sport is a positive thing and the vocal minority is trying to destroy the enjoyment that the members of OBC find in playing cricket. As the saying goes kids in sport stay out of Court!</p>	Michelle	Mace
33199	<p>A non-profit sporting organization has raised \$100,000 entirely by itself in order to rebuild world-class cricket nets for PUBLIC use, in which literally thousands of people enjoy each Spring, Summer and Autumn.</p> <p>For the sake of common sense, humanity and the sporting enthusiast, I am great in favor of Granting this lease.</p>	Morgan	Williams

33198	<p>I am in full support of the new cricket practice nets at Elmwood Park by OBC Cricket club. I have 3 sons who have all played junior cricket for OBC with one still playing. Having spent many hours at the current nets these are outdated and dangerous. They have been there for many years and simply need updating and ensuring they are safe for the whole community. Balls fly out into the pathway and field on regular occasions and many children have been hit with balls and it is lucky there has not been more injuries.</p> <p>A new net facility will benefit all of the community as many in the area utilise these nets and the park in general. It would be great to ensure that these are as safe as possible and the new plan will make sure of this and help for many years to come.</p>	Paul	Brown
33197		Sean	O'Rawe
33196	<p>The Elmwood Cricket Club is a popular club, with existing practice facilities, that require upgrading to allow it to be used to its full potential. It is widely agreed that young people benefit from participation in outdoor activities, especially as society today presents many opportunities to take part in more sedentary, less healthy options. Upgrading the facilities in question will help to encourage young people to take part in a beneficial activity, which rundown, potentially less safe (for both players and the public) will not. People who take part in healthy options like sport are more likely to make a more positive contribution to the society (in this case Christchurch) in which they live. I ask you to favourably consider granting permission for the compromise proposal for the practice nets to go ahead, thus encouraging people, especially young people, to take part in sport rather than in less positive activities that occur in at times in and around Christchurch .</p> <p>Allowing for an upgrade will also make the best use of what is presently an attractive, but somewhat well worn facility. An upgrade has the potential to send a message to the youth of our city that their positive behaviour in their leisure time is valued by the residents of Christchurch.</p>	Barbara	Hill
33195	<p>I support the proposal for OBC to be able to lease part of Elmwood Park for cricket nets for the following reasons:</p> <ol style="list-style-type: none"> 1. Having community facilities such as these is vital to the health and well being of the local community - more than ever we need to have local resources that encourage people to be active 2. Community facilities like these bring the community together and promote connectedness - this is not just for the people using the nets but also for the whanau, family and friends who come together in this area of the Park to socialise when dropping off children for cricket practices and games, etc 3. The nets will be available for all people to use and not just limited to those who are members of OBC - they will provide equitable access 4. There are existing nets at Elmwood Park already, so the proposed new nets are only replacing what is already there - although on a slightly different footprint and meeting health and safety standards 5. The nets will only take up a very small part of the Park (and are not obtrusive), plus there will still be plenty of space for other recreational users to enjoy the Park 6. It makes sense to co-locate the nets with the cricket pavilion in one area of the Park 	Carmen	Marsh
33193	<p>The new nets will make it safer for players to train, safer for the members of the public who won't have to be worried about stray balls hitting them as they pass due to the nets being inclosed, and safer for fielders during games as they will no longer have nets extending into the outfield</p>	Mike	McIntyre
33191	<p>As a frequent user of the park I consider the current nets to be unsafe and require an upgrade. The club is very popular, especially with young people, and I think there will be a lot of future use for new nets.</p>	Craig	Stapley
33190	<p>The proposed training enclosure at Elmwood Park should go ahead. There should be no compromise for public and participant safety during the cricket season. Having suitable training facilities would protect the public from flying cricket balls which are currently a risk.</p> <p>It would also improve the aesthetics of the park replacing the shoddy, run down, out-of-date existing training facilities.</p>	Ben	Ward

33189	<p>This club provides people of all ages with the ability to play cricket, and learn life skills, be active and socialise accordingly.</p> <p>The nets suggested are a great alternative to fixed nets, and the ability to move them will ensure Elmwood Park keeps its look and feel.</p> <p>The club has operated at Elmwood Park for a very long time and when the clubs merged back in the early 200's it was because Hagley Park was going to be re-developed into what it is today therefore taking away a place for that club to play cricket.</p>	Will	Eastgate
33188	<p>I support the cricket club needing nets and they have investigated many options to support all those involved including local folk.</p> <p>The Astro turf would be easily maintained and would suit all purposes. The retractable nets giving more space for other activities in the winter..</p> <p>Elmwood is a lovely community park and a small area dedicated to warm up nets would be value added.</p>	Antoinette	Searle
33187	<p>I have always loved Elmwood Park. I have many fond memories from growing up around there with school and cricket. The cricket club is a big part of this. They need the nets and they will be an improvement on previous ones. There is already a huge tennis facility so updating the old nets shouldn't take away from any beauty the park has. The large retractable nets will also stop balls going into neighbouring properties as I recall happening when my brother would train there. It support this 100%.</p>	Cameron	Anderson
33186	<p>This net design is innovative. It's fantastic to see the club compromise to meet the local residents half way while still providing facilities for young and old to practice and exercise.</p>	Shannon	McAleer

33185	<p>I support the proposed cricket nets for two reasons - first is that this provides a modern fit-for-purpose recreational resource for the cricketing community of the Elmwood Park and surrounding suburbs. The OBC cricket club currently supports around 600 playing members the majority of whom are primary age children living within a few kilometres of the park. These facilities will be a focus for the development of these young sports people as well as for the adult club members.</p> <p>Secondly I support the proposed nets for safety reasons, both for the players and the community. The existing net facility is over 35 years old and offer function and safety below current expectations (though to my knowledge there has never been a serious injury during my association with the club). Any modern net facility needs to be fit-for-purpose for cricket practice while providing a safe environment for both junior cricketers and any other park users and passers-by. A fully enclosed facility can deliver on both requirements.</p> <p>I am aware that there have been criticisms of the shading effect of the nets on the pathway - however the nets are beside large trees which overhang the path and create substantial solid shade for much of the day. While the proposed nets may cause some minor mottled/partial shade later in the day with the sun in the west, during much of the rest of the day the path is fully shaded by the Elmwood park trees. I do not believe shade effects constitutes grounds for objection to the proposal.</p> <p>I'm also aware that there have been some claims that the park is being "taken over" by cricket. I think it is only fair to point out that both Old Collegians' and Old Boys Cricket Clubs (OBCCC's parent clubs) have a history of cricket being played at this park since the 1920's - nearly 100 years of near continuous cricketing history. When I joined Old Collegians in 1986 the ground had 4 senior wickets where now there are only three. During the 1990s when Junior cricket numbers at Old Collegians peaked - on Saturday mornings up to 10 or 12 junior games (nearly 200 junior players plus supporters) plus the cricket nursery with more than 100 children and parents supporting them would attend the park each morning, to be followed by 4 senior games (88 players) all afternoon. During the week junior crickets trained all over Elmwood park on as many as 4 days a week after school followed by senior cricketers in the evening 2 days per week. By comparison current levels of cricket activity are significantly lower. In addition the proposed net facility will actually localize the impact of junior cricket training to a much smaller footprint on the park and be much safer. I would have characterized the proposed development as a win-win for the club and the community.</p> <p>I would also like to point out that both Old Collegians' and OBC, during their near 100 years occupation of the park as a cricket club, members have expended many 1000s of hours of usually voluntary labour maintaining and developing their corner of the park. While some members of the community may choose to criticize the appearance of the cricket club facilities, the club has always striven to be a good neighbour, and within its sometimes limited resources to meet its duty of care over its facilities. Many community members seem to be unaware of the length of presence and investment of effort and resources the cricket club has made over the years.</p>	James	Barringer
33184	<p>The existing nets are in bad condition and at the end of their life. Also, the fact they are open-ended is totally unacceptable. In these days of Health and Safety, I'm astounded this has been allowed to continue. The Old Boys CCC have listened to the fears and objections of neighbours and interested persons, and altered the size etc, and hopefully these changes will meet with the approval of all.</p>	Sandra	Shaw
33183	<p>I have found it very intimidating approaching the nets whilst picking up my son from practice on a number of occasions with balls flying everywhere, it would be a great improvement to have these new enclosed nets for the safety of the public in the park and also for the young ones themselves, they can be very distracted during practice at times and are not always concentrating on balls that could be flying towards them from a few directions. These would be a great addition to the park and being retractable would not be an eyesore.</p>	Matthew	Lamb
33182	<p>Cricket and community have built the very fabric of NZ's summer sporting history. Christchurch needs communities to rally together and support the cities rebuild and offer our youth areas in which to participate. As they say "a kid in sport stays out of court". Let's give our young every chance to be involved in sport in our wonderful open spaces.</p>	Tim	O'Loughlin
33181	<p>It is already a place to practice and play cricket and long may it continue. People young and old should be encouraged to play sport, be part of a team & a community.</p>	Teresa	Barnes
33180	<p>A cricket club practice facility is, without doubt, one of the most important requirements of any cricket club. Without a decent facility that is fit for purpose, you deny all members, of all shapes, ages and sizes, the opportunity to take part in a game that has given me so much joy and friendships across the World. This is a must for the club to continue to progress and blossom.</p>	Andrew	Robertson

33179		Tim	Kirby
33178	<p>These new practise facilities are long overdue. Existing facilites are not ideal, & in some respects dangerous as balls are hit towards pedestrian areas.</p> <p>Every effort has been made to accomodate residents concerns, and at some point recognition must be given to the clubs status as the South Islands largest cricket club & it's historical occupancy of Elmwood Park.</p>	Geoff	Cotton
33177		Mikaela	Gilbert
33175		Zoe	Smail
33174	Club cricket needs all the support it can get being able to practice at your own ground is neede to create a club culture	Andrew	Sherwood
33173	As a fan of the game of cricket I want to see the game continue to grow, new facilities for junior and senior teams to use is crucial. This is a large club and is very important for the continued participation of kids in the sport, upgrading of facilities over time is very important, I would love to see this go ahead	Kieran	Hight
33172	I think this is a great idea! The safety of the nets currently is not okay. Too many times have I been training and seen someone been hit or close to getting hit. This needs to change! I think this is the best and safest way possible with minimal disruption to normal park activities	Jessica	Simmons
33171	I think that it is a good thing as the nets have not been upgraded in many years. It will be able to be used by the public. It is not much need of an upgrade	David	Henderson
33170		Henry	Adams
33169	OBC is a great cricket club with a long history at Elmwood park. It would be a great shame to ignore this history when making decisions on its longevity and expansion as a Cricket Club	Bradley	Simmons
33168	I have been involved in cricket in Canterbury as a player and administrator for over 60 years & am well aware of the benefit which cricket, like any other sport, offers to the community & particularly to both male & female youth. Cricket has been played at Elmwood Park for longer than I can remember (well over 70 years ?) & the park itself is regarded by many cricket lovers as the prettiest club cricket venue in the city. I believe the applicant club with its practice nets proposal has acted reasonably & responsibly in ensuring that the natural beauty of the ground is maintained & public safety guaranteed while at the same time giving proper emphasis to the views of those who have previously opposed the erection of the practice nets with whom the club have extensively consulted over many months. There is no danger to the public with the nets being fully enclosed & they will not detrimentally affect surrounding residential properties as a result of them being erected parallel to the adjoining tennis courts & far enough away so as not to be a noise nuisance. This city has had more than its share of difficulties starting with the 2010/11 earthquakes & only now is the rebuild reaching the stage of providing a vital & exciting environment for young energetic people - they are the future of this city. High quality sporting facilities are important to them . The applicant club is making a contribution to the city by giving the community the opportunity of participating in a popular sport & has over 600 members with the majority being Saturday morning junior players. It needs high quality practice facilities & the present proposal is to replace the existing practice nets ,which are well past their "used by" date, with a far superior product which is in no way detrimental to either other users of the park or residential neighbours.	Cran	Bull
33166		John	Quirk

33164	<p>This project is critical to ensuring the ongoing quality of our community sports teams. Without the chance to redevelop the current practice nets the safety and performance of the players of today and the future will be compromised.</p> <p>There is NO adverse impact on other park users - any such suggestion of the case is pure hyperbole by local residents who are opposing it for their own shortsighted, selfish reasons.</p> <p>The cricket club provides immense local community benefit, particularly through encouraging young children to partake in a sport that they can see has the opportunity for progression and perfection of their skills - this is enhanced the quality of the facilities which are, at present, inadequate.</p> <p>The Club should be given every encouragement and assistance to improve both the nets and the club rooms/pavilion to create a refreshed and high quality facility that reflects the ambition and aspiration of the neighbourhood rather than a run-down, dilapidated eyesore that it currently is.</p> <p>Council needs to take responsibility and no longer entertain a bunch of NIMBY's who are a very small minority and getting far more airtime than they deserve to the detriment of a much larger group of people who stand to add more value to our community.</p>	Simon	Wall
33163	Great addition for a great club.	Jackson	Pearce
33161	The cricket nets are old and dangerous, the club has proposed a safe and modern solution for a cricket park. The nets are used by many people during the summer months and provide enjoyment and fitness. This is a Great club that has supplied many Canterbury and New Zealand representatives, Any stopping of this progress is churlish and negates people being outside. I propose that any objectors get their house turned into a cycleway. The clubs proposal is safe and sensible with minimum impact on the environment.	Paul	O'Connor
33160	My son has had the opportunity to learn his cricket skills with OBCC and central to this was the ability to train Elmwood Park using the nets. Coming from the UK we greatly appreciated the opportunity, convenience and cricketing community and it is essential for cricket that children have a place to learn and develop safely, so we strongly support this proposal.	John	Liddiard
33159	I wholeheartedly support the new net proposal. I think the new design is a suitable compromise - it is functional but not visually intrusive. It is imperative that new nets be approved chiefly for safety reasons; the current nets are unsafe to the public and both junior and senior players alike. For senior players the current net run ups are on to the main field and are dry and bumpy, the risk to a fielder on the boundary trying to stop the ball in this region of the field is high and I have witnessed many close calls. Because the run ups for the nets are on to the main senior field, children either don't use the nets during Saturdays out of fear of getting hit by balls from the main field. Those that do are often getting told off for hitting balls out on to the main field, delaying the game on the main field. This is terrible in building club culture as the juniors feel like the senior club are stopping them from using club facilities on a Saturday when children are most likely to want to use the nets. The risk to the public is extremely high as the path cuts between the current pavilion and the nets and are one errant shot away from being hit. The fact that the new nets are fully contained removes the risk of the public being hit. So, in summation, the new nets proposed would be beneficial for the public, junior players and senior players. Not only are they safer, but the current nets are getting run down so new nets would be more visually appealing.	Ryan	Astle
33157		Will	Duston
33156	Gives the club better facilities to get the most out of older and younger players	Jarrold	Mealings
33154	I have two cricket playing boys that use the nets on a very regular basis and I firmly believe that new nets are necessary for a number of reasons. 1. Currently batsmen hit balls towards the path making it dangerous for the general public. 2. The dusty run-ups are dangerous. 3. The new netting structure will be fully enclosed during the season and will take away any threat to public health and safety, which will be a great development for Elmwood. 4. It is a great idea which will benefit current and future generations of cricketers to come, particularly as it will be a community asset which the Club is attempting to provide. I understand they are trying to replace what already exists and is at the end of its life, and make the Park safer for all community users – whether cricketers or not. The improved safety of Park users in general is the primary reason for this net proposal.	Louise	Clancy

33153	I support the proposal to make nets and training areas safer for the general public and cricketers alike. Servicing such a large club in a small space is incredibly important for both players and park users. The proposal allows for a compromise, as is needed in a public space.	Sarah	Kerkhofs
33152	safety for the public using the park needs to be a priority.	John	Hastilow
33151	Big improvement to the safety of the public and the users of the nets (especially junior cricketers)	Adam	Hastilow
33150		Mirza Aman	Deshmukh
33149		Megan	Wright
33148	Fully support the idea to lease	Cameron	Penney
33146	I am 13 years old and use to play for OBC. I would either practice or go to the nets a couple of times a week. I still do as they are the closest The current ones are dangerous for walkers as you can hit the ball onto the path. The run up is also grass and ends up being just dirt after a few weeks of practice. New nets would be better for everybody – safer and better for cricket	Thomas	Vesty
33145	New nets would be better for all those who use the park. Safer for walkers and fit for purpose for cricketers. My son has played for OBC since he was 5 and has used them extensively. As he has got older, he hits the ball further – he can quite easily hit the ball out of the nets 40m or more. With the amount of use the nets get each week and I am surprised nobody has been injured. I am also pleased that the whole area will be astro-turfed as the run up of the current nets (again with the amount of use) ends getting torn up and difficult to use a proper run up. I would like to see that they are set up for use 12 months of the year as well	Simon	Vesty
33143	I am a mother of 3 sons, all of whom have played cricket for OBC Cricket Club. One of them still pays for the club, 20 years after he started. I believe in the benefits of sport to physical and mental wellness, growth of character and self confidence in young men (and women), and the social benefits of these sports clubs like OBC to our community. To play the sport effectively the players need to practice, and to practice cricket you must have cricket nets. The club has gone to great lengths to work with the community and the CCC to come up with a safe design that protects the neighbours, players and all park users from flying cricket balls which present a hazard. I whole heartedly support the proposal, and I am asking the Community Board to support the proposal, and the club in its efforts to improve the facilities at Elmwood Park.	Helen	Wakefield
33142	These are a much needed community asset supporting a sense of place and inclusiveness for women, men, girls and boys of many cultures to be able to come together through practice of the beautiful game of cricket. These nets will then make it safer for others who don't share the same love of the beautiful game and who don't like seeing people happy and enjoying a sense of community to also still use the park in a way that makes them happy or continue to be sad, I am not here to judge. If the nets aren't allowed here, then CCC need to support the club to find an alternative location where they can be supported.	Craig	Redmond
33141	Nets look to be well positioned so that flying balls don't impact other park users. I think cricket is a great sport to bring communities together, and the OBC club is great for this. Unfortunately it's old nets are ageing, so this would really revitalise the club and be great for the community	Harry	Reece

33137	<p>I believe the case for the nets is sound. Safety is paramount for passers by and these nets will provide a safe and secure training environment.</p> <p>I am a local resident for over 40 years and a former member of the HSOB Cricket Club.</p>	Barry	Hadlee
33133	<p>At the moment players risk injury using the current nets due to the state of the grass run ups and the state of the turf in the nets. Practicing on the blocks reduces the number of new pitches that can be developed throughout the season, hence, reducing the quality of pitches used for game play.</p>	Allie	Mace-Cochrane
33128	<p>Cricket has been played at Elmwood Park for over 70 years, the players need an area to practice the proposed area set aside for the nets is only a small area considering the size of the park please do not be influenced by a minority who probably have never played cricket</p>	JOHN	CARTHY
33127		Liz	Hirst
33124	<p>The arrangement of the nets along the east boundary that has the new nets further away from the existing residential homes is preferable to the existing location of the nets. Having the new nets next to the tennis courts is a good idea. This will reduce the impact that the existing nets have on the residents.</p> <p>It is noted that the location of the nets are to be outside of the drip line of the trees and assume that this will not result in any physical impact to the trees. i.e no trimming of branches required.</p> <p>The location of the nets being to the side of the park will also reduce the visual impacts of the net structure as viewed from Heaton Street and so is a preferable location.</p> <p>The temporary nature of half of the net structure will also reduce the visual impacts of the nets particularly during the winter season when the temporary part is removed entirely.</p> <p>The new nets will also be enclosed when they are in use during the summer period. This will enhance the safety of all the park users during this period as the danger of cricket balls coming out of the nets is an issue to other users of the park.</p> <p>As previously noted there are existing nets and so by changing the location of the existing nets the OBC are not introducing any additional adverse effects.</p> <p>The proposal as outlined will in fact reduce the adverse effects that exist with the current arrangement and provided a better outcome for all users, be they cricketers or other park users.</p>	Neil	Cox
33120	<p>Fully support this. OBC is a huge club and the current facilities don't quite cut it with the number of cricketers playing cricket throughout the summer.</p>	Aaron	Price
33117		Stewart	Harrison
33115	<p>It is good to see these grounds utilized by as many people as possible in order to make the destination popular. It has plenty of parking on both sides and is very handy to a great cross section of people. I would support it.</p>	Tony	Andersen
33114	<p>Yes I support the lease to OBC for cricket practice nets. I have three children - two of which play or have played for the club. It is an excellent club.</p> <p>The lease of the area to OBC for cricket nets won't impact on the use of the park or the aesthetic of the park. It would be a wonderful use of that space and would enhance the area. It is a community space and should be used as such. The nets are also used outside of OBC club practice times by individuals.</p>	Kate	Butterfield
33112		Will	Graham

33109	<p>Hi My family are active users of Elmwood Park for biking, walking the dog, kicking the ball around, jogging and having a few hits in the cricket nets. My Son (15) is a past player for the club, and my daughter (11) currently plays and used the nets on a regular basis. OBC is a wonderful cricket club with a large amount of kids teams, I have nothing to do with the club but think they are fantastic for our young children, and do a great job. I support the proposed cricket net proposal for a number of reasons.</p> <ol style="list-style-type: none"> 1. The current nets (only public ones in loacal area) are very well utilised particularly by young aspiring children, but are unsafe in that balls can be hit at bowlers in the adjoining nets, spectators, other park users, and are generally unsafe when compared to modern cricket net facilities. The new proposed nets will be safe and practical for all park users. 2. Having the proposed cricket nets and upgraded Cricket pavillion at Elmwood park will be a great community asset to be enjoyed by current, and future generations of this city. 3. Common sence there is already nets in place, I cant believe the utter nonsense involved with upgrading a tired community facility to a safe standard that brings benefit to our community, encourages outdoor activity, team sports, and communtiy spirit. Replacing these nets is a no-brainer and one that the majority of the surrounding community would support although nay not put in a submission. Be very carefull of small minority naysayers directing the attention of decision makers as this issue appears to be about from reading previous atricles in the Press. 	Matt	Butterfield
33108		TONY	CAMPBELL
33107	<p>Many Christchurch people have grown up using the Cricket facilities. I'm saddened by some locals negative comments. Elmwood Park is an outstanding reserve for Cricket to be played. It mirrors the English County Cricket areas.</p>	Noel	Pinn
33105	<p>This absolutely must be approved by the Community Board. Old Boys Collegians Cricket Club has 50 Junior teams and 10 Senior teams, and is one of the largest and most historically significant Cricket Clubs in New Zealand. It has a proud history of fostering high profile international cricketers like the Hadlee family, Geoff Allott, Brendon McCullum, Shane Bond, Corey Anderson, Todd Astle, Katey Martin, Erin Bermingham and many others - but more importantly it helps strengthen the community by instilling within our 400+ Juniors the values that cricket provides which help to mould great people.</p> <p>The nets at Elmwood Park are heavily used with Junior and Senior members of the community (whether Club members or not) using the 4 lanes currently there on a daily basis - often these are full during the summer from 3pm until sundown all week long - they are a great community asset. However, as they currently stand, they pose real dangers to the community - both those using the nets as cricketers, and general park users - they are open and allow hard balls to fly out towards park users and neighbours alike. The nets also overlap with the boundary of a field which is used every weekend - meaning the practice nets are unable to be used when cricket matches are happening at Elmwood Park. The grass run ups are used so often that they are now uneven dirt strips which are dangerous and unsatisfactory. Further, the current nets have holes in the metal wiring from the wear and tear they've endured with thousands of hours of use and enjoyment they've provided - which clearly is also dangerous and in need of change.</p> <p>The new proposal is a great one - it aims to update the existing facilities, addressing the health and safety issues by having a fully enclosed design and will be able to be used by the general public as a community asset (as the current nets are). The removable enclosure is a result of community consultation and concessions made to alleviate concerns from some locals who have been involved in the feedback process. The footprint increase is a result of fully enclosing the run ups - which is for safety purposes, and the location of the nets must be different when taking into account where the approved Pavilion is going to be. Concerns regarding aesthetics and size must be overrode by the need to protect users of Elmwood Park from hard cricket balls flying around. Please remember this proposal is simply updating existing facilities.</p> <p>The community board now simply MUST support this project. The club has made significant compromises to ensure they reasonably include and consider the community and non-cricket users of the park, now is the time to accept these changes and get out of the clubs way to make Elmwood park a safer and more improved space! It is not the Club vs the Community, we are all a part of this community who love Elmwood Park.</p>	Chris	Wakefield

33104	<p>This park has been used for cricket for decades and this needs to continue. It gives me great satisfaction to see the park utilised for organised sporting activities, and seeing the local mums and dads in the nets with their kids is terrific. This park must not be forced to be something that only allows for individuals to walk their dogs or the odd family activity, it is too good a space for that. I feel that declining the nets again risks pushing the club out of the park. It is great to see that the proposed design addresses the hazard to the public and cricket players of flying cricket balls that we have now and works to minimise the visual impact to the park by having a removal-able section to it for the winter months.</p> <p>I would like to express my concern that the nets were rejected last time even though the on-line voting was, as I recall it, around 70% in favour. It appeared to me that the decision was based too much on a meeting, which seemed to be organised by the "no" voters and which presumably had very few people at it supporting the application to provide a balance of opinions at the meeting. There were notices about the meeting displayed at the park that clearly stated its intent was to petition against the proposal and made me, as supporter of the proposal, feel that I should not attend. There was no communication that board members would be attending and basing their decision upon the one-sided discussions at the meeting. All submitters to the on-line feedback should have received notification of the meeting from the council and that a decision would be made based upon the views at the meeting. If any further such meetings are to be held, please ensure that all submitters are officially invited.</p>	Jeff	Brunton
33101	New nets will equal to more and better cricketers to be produced by the region	Josh	Simpson
33099	From a cricket standpoint, the facilities at Elmwood are quite poor at the moment. It is important for the OBC club to be able to get on with their project to support the sport of cricket for our community. It is also important they are able to construct proper nets that allow them to train while also keeping the public safe from flying cricket balls.	Matthew	Hill
33098	<p>As a local living in this area we regularly walk through Elmwood Park and regularly notice people practicing cricket in the existing nets and see that cricket is very much part of activities on this park and I totally support the new cricket facilities including the lease of the area to the Old Boys Collegians Cricket Club for the cricket practice nets.</p> <p>As an architect I can totally picture this facility in operation and do not think that it will in any way have an adverse effect on the visual amenity of this park</p>	Tim	Dagg
33096	Adding great facilities to an existing cricket ground is a no brainer. The current facilities are below par for training and need improvement	Jackson	Latham
33095	I have 2 children who play cricket for the OBC club. It is a fantastic community minded club which has great participation and really looks after its members. Unfortunately for a club of its size the facilities are lacking - particularly the club rooms and practice nets. When there with the children the nets are very busy for the number of people wanting to use them, and as they're not covered there are often balls flying everywhere, often close to young children walking/biking past and families. I would totally support the construction of the new nets.	Lucy	Cameron
33094	The location away from housing is ideal, and the ability to retract seems a pragmatic compromise. Most importantly, the ability to contain the ball within the practice nets is eminently sensible and safe, more so than the existing nets.	Rebecca	Brinkhurst
33093	Elmwood Park is a beautiful park, cricket in summer soccer in winter, plenty of space for everybody, people with dogs, people with children, cricket has been here since 1925, to say it's going to turn into a cricket park, it is already but for how many days a week, come on people this gives our future generation of girls and boys the ability to play and train. Nets are really good theses day, being safe to all that use the park. When people moved into nearby streets, they knew Elmwood Park was there.	David	Quested
33092	I have just finished my first season as a senior men's player at OBC having played premier men's cricket for another club for the last 10 years and played many games at Elmwood Park over this time. The current nets, are a hazard to all cricketers playing on Elmwood Park. With them facing the current cricket block and being open, the nets are unusable when their is a game being played. With new fully enclosed nets, kids are able to practice and play whilst being able to watch some quality cricket. The health benefits of kids being out and exercising safely can not be understated. The current nets are a hazard to not just cricketers, but all general public using the park due to hard cricket balls flying about. It would be a shame for something to have to happen to someone for action to be taken. This club has a proud history of success and providing players to provincial and national teams. The new nets would help enhance the hopes of the club for its future	Chris	Case

33091	This would be a great safe facility for users of the park, both inside and outside of the nets	Brad	Adlam
33090	Elm wood park and it's wider area are full of sporting venues from tennis lawn bowls and croquet, all provided for with purpose use areas. Elmwood parks beauty lies not just in the surrounds but the fact that people fill it and family's spend time together. The improved cricket nets would simple make it a safer use park and without the metal cages most likely a more attractive space non season.	Brandon	Evans
33089	This proposal will be an improvement on the current nets and an enhancement for young cricketers and will improve safety. At present many young OBC cricketers use nets elsewhere rather than use their local park. The players are taught to be mindful of other park users and do not impinge on other park users.	Malcolm	Wallace
33088		Daniel	Stanley
33087	I fully support the proposal. I am 70 years old, and have lived in and known this suburb all my life. In fact, I went to Elmwood School in the 1950s and played cricket, way back then, on Elmwood Park. One of the many things that this Coronavirus crisis will have taught us - is how much we treasure our ability to socialize with others, and being outdoors. Also, the importance of family and healthy activities for the young. In these times, where so many spend exhorbitant hours on their cell phone, and doing individual things, team sports, like cricket, are so important. You'd have to be short-sighted, grumpy, selfish & old to deny the next generations the facilities & opportunities this cricket club wish to offer. For both girls and boys. Practice is essential in sport, and these nets will provide a safe environment for batting & bowling. On health & safety grounds alone, you'd have to support the proposal. The designated area is ideal. It's close to the clubrooms and in an unobtrusive corner of the park.	Bruce	Bascand
33085	I feel the nets there are ugly and unsafe. Dont think it's to much yo ask to put I new safe and smart looking nets for public use. Great work OBC	Nicole	Miles
33084	Ever since the earthquake elmwood park has been neglected with deteriorating nets and 'tempory' changing sheds. This would be a big step in the direction of bring the facilities up to what is need and to an acceptable saftey level.	Joseph	Edgerton-Till
33081	I don't think the new nets impose too greatly on the park and am in favour of encouraging sport in communities. Sport is great for social, mental and neighbourhood health.	Sarah	Gamble
33079		Peter & Val	Williams
33068	The Council should actively support all sporting and recreational activities undertaken by its residents. In this case the Council isn't being asked to contribute financially - an added bonus	Ewan	Godfrey
33067	This proposal will be of immense benefit to junior cricket	Bruce	Taylor
33066		Gerard	Sherwood
33065	1. Given the recent mendacious actions by Cant. Cricket can we assume that there is also a proposal for lighting yet to be declared? 2. How could we be confident that the 'retractable nets' will be temporary or 'retractable lights'!!	Rex	Johnstone
33064	It is a park, let the local community encourage sport to be played on it, ad a new pavilion will be great!	Alan	Dodgson

33063	<p>1. I believe the nets & poles should be painted green to merge in with the surroundings, & this be less obtrusive.</p> <p>2. If the permanent structure was extended say 3 bays, would the ugly retractable netting be even necessary? Back in the 1960's we used similar netting that in my opinion looks ugly.</p> <p>3. Some people tried to argue at the early community meeting that cricket was trying to take over the park. In the late 1800's Elmwood Park was Sir Robert Heaton Rhodes's polo ground and where his stables once sat. I believe cricket has been played there since 1924</p> <p>14.04.2020</p> <p>I have lived close to the park since the late 1950's apart from 6 years overseas.</p> <p>It may also be of interest that back in the 60's the park had 4 wicket blocks one of which was reserved for suburban cricket & 3 used by Canterbury Cricket Assn. The argument that cricket is now trying to take over the park is absolute nonsense..</p> <p>Some more history, the park has also been used for rugby in the winter & now it is a real pleasure to watch young & old, boys & girls, playing soccer & hopefully they will have access to the new pavilion's changing facilities.</p>	Warren	Price
33062	<p>This club is an essential part of community spirit. Introduces young children to a sport, even if it is just for observation excitement.</p> <p>Too many sports activities are being snapped for armchair activities - resulting in to 10 year old couch potatoes!! for life</p> <p>Give people something to do</p> <p>Given them Nets Space!</p>	John	Pegley
33061	Everytime walk through Elmwood park we only see cricket activities going on. We fully support the cricket clubs use of the park and wider facilities	Claire	McCallum
33060	Prefer this proposal to previous one	Penny	Fox
33059	The current nets pose a serious threat to the safety of both players and general park users. I've played and practiced at these nets for a number of years and have lost count in the number of close calls there have been to serious injury. New safer nets need to be built at Elmwood Park, otherwise we have lost an opportunity to prevent serious injuries.	Lewys	Jones
33057	Yes, this is a fantastic idea and a great way to encourage people to play cricket	Jacky	Dobson
33028	Cricket is the sport of the New Zealand summer. Cricket is a game that promotes community, team work and selflessness. While the elmwood cricket club has been successful for years and years now, one thing that has always held the club back has been its practice facilities. The nets are outdated and in bad bad shape, I would know I'm there most days	Ryan	O'Dwyer
33005	As a cricket coach i understand the challenge of keeping kids safe which ultimately falls back on the coach during training sessions. Upgrading pitches, nets and surrounds are an important part of doing this, and this project contributes to that.	Mike	Bell
33004		Jack	Marshall
33003	The current nets are pass their useful life and now pose a heightened Health and Safety Risk. The opportunity for new cricket nets is an asset that will benefit a large part of the Community, not just club players but mum, dads kids and mates that want to enjoy them.	Analisa	Elstob

32992		Nick	Ducray
32991	I support the growth of OBC during a time of challenge for all sports. This is important for the long term benefit of the community.	Kelly	Baxter
32990	A great solution for all parties to ensure the growth of the game of cricket and support the development of future Black Caps and White Ferns.	Ben	Rae
32987	I support OBC with this proposal.	Gianna	Chalmers
32986	I support OBC with this proposal.	Maddison	Chalmers
32985	I support OBC with this proposal.	Philippa	Chalmers
32984		Riki	Mills
32983	<p>I myself have used the cricket nets at Elmwood Park ("Park") many of times and recall for a number of years now that it is in need of an upgrade. The reasons for me opinion are as follows:</p> <p>a) The nets are well beyond their time and the quality is below a standard which players need to be able to train properly. The current nature of the nets (i.e. concrete and metal netting) means equipment, such as cricket balls, are easily damaged.</p> <p>b) The nets could be a lot safer as cricket balls can ricochet off the metal poles and concrete and hit other people. The new design diminishes this risk, as new mesh netting restricts the risk of ricochet. The run ups for the bowlers are also a lot safer as they are less likely to fall over, given the new design will give the bowlers are better suited surface to bowl from.</p> <p>Cricket is a major part of the Park and the nets are a fantastic facility for the wider community. The nets allow people to practice their cricket in a safe way which does not impact other people using the park or people within a close proximity. People are able to walk / run behind the nets, as they currently do, with almost no risk of being affected by people using the nets. One disruption to neighbors is noise, however, I do not think this can be taken into consideration. Noise is already created from people using the already established nets at the Park, as well as, all the other possible activities you can do at the Park. (This is what a park is meant for anyway).</p>	Jack	Nuttall
32978		Rachel	Colman
32976	I think the current positioning of the nets isnt practical for a park that is used by both runners and cricketers, the decay in the nets makes them more dangerous for those using the park. I think the proposal will encourage youth sport in the region and with limited opportunities available like this it would be a good idea to go ahead.	Henry	Shiple

32973	<p>This is an excellent proposal and one that has been arrived at by the OBC Cricket Club after taking into account community views and opinions. The Club has been bending over backwards to listen to the community, and to the Council staff and Community Board, to get the best solution for everyone. We have changed the proposed solution to get the best possible result for everyone.</p> <p>These nets will be safer for the players and for all park users, which is important given that we don't want anyone to be hurt by flying cricket balls. The existing nets are at the end of their life, and we need to have the Community Board approve the updated design for these nets now, so that we can get the nets built before the next cricket season.</p> <p>We can't have a public democratic process being used by one or two people to hijack a beneficial project for a very large number of the community, including around 600 cricket players in the club, their families and supporters, and a significant number of park users who can see the benefits to them and their neighbours, and who have taken the time to understand and see that this is a reasonable and well thought out proposal.</p> <p>The job of the Community Board is to support and encourage beneficial community projects, and its time for Community Board members to stand up for what is right and to support this project. Since we have lost funding that we had organised for this project due to the long and frustrating delays that we have encountered due to the Community board elections, the changes in designs, and the multiple community consultation processes, I would hope that the community board could also consider assisting this project with financial support to recognise the value of progressing this project as well. Thank you.</p>	Steve	Wakefield
32970	<p>The new nets will significantly enhance the development and opportunity for junior cricketers to engage in physical activity during the summer. Cricket is an important team summer sport in NZ and offers young boys and girls the chance to develop fundamental skills such as throwing, catching, improving co-ordination and adds the natural competitive environment. The new nets will allow both junior and senior players in the community to greater enhance these skills .</p> <p>The old nets are very run-down and are definitely due for a renewal.</p> <p>The club has a strong junior and senior member base and adding nets will only grow this, providing better opportunities for the active community to engage in team sport both competitively and socially.</p>	Cam	Fletcher
32969	<p>Cricket has been played at Elmwood since the 1920s and has provided community recreation and enjoyments since those times. Today more than ever we need to do as much as possible to foster youth and community sport and recreation. These proposed facilities will benefit many people across all age groups and at the same time enhance health and safety for all users of Elmwood Park.</p>	ANDREW	NUTTALL
32968	<p>I fully support this initiative. The current nets are not safe enough, with holes in the side meaning balls can fly out unsafely. Having quality sporting facilities is an important thing for our community. This provides the things we need to ensure physical and mental wellbeing for our community. New nets will provide an uplift in participation, which again improves the overall wellbeing of the community.</p>	Andrew	Dorgan
32967	<p>An upgrade of the cricket nets at the park has been needed for a long time. This proposal will give the park a first class cricket net facility helping to foster the game while also protecting other users of the park with a more appropriate and safety conscious design.</p>	Bill	Walsh
32966	<p>This will be a great addition to the park and improve safety for all park users</p>	Katherine	Huggins
32965	<p>Long over due upgrade of dilapidated facilities and a positive enhancement for the community</p>	Kerry	Hebden
32963	<p>I think it is great that the park is being used to promote and play a sport. The nets along with the new pavilion proposal are a great addition to the area. I hope that it is able to go ahead.</p>	Sonja	Alborough
32961	<p>surely common sense will prevail here.</p>	John	Ross

32960		Jordan	Merito
32959		Ritchie	Dodd
32958	As an existing member of Old Boys Cricket Club, albeit from another country, I know that the current cricket nets are unsafe and dangerous for practise. As a successful club within the community I believe that by supporting the proposed redevelopment the community will only benefit from the success the club will bring.	Shaun	Roberts
32957	It's great for the community and being retractable will be good visually.	Nick	Schepemaker
32956		William	Stribling
32955	Fantastic idea.	Guy	Cartwright
32954		Jeremy	Moore
32953		Muhammad Amir	Daud
32952	Every club should have facilities to train!!	Danny	Gleeson
32951		Veresha	Padayachee
32950	The nets are in serious need of an upgrade to stay modern and function better. This will be great for the current OBC cricket players but also help the development of future cricketers. With cricket numbers in decline, this will be an important asset that can promote movement and cricket to all.	Phil	Watson
32949		Jared	Williamson
32948		Brad	Gilbert
32946		mikayla	dyer
32944	They are trying to accommodate people and still keeping people active. If this was rugby would it be an issue?	Suzy	Garriock
32942	As I have a good friend who teaches and plays Cricket, I believe it would be beneficial for her to have a good space where they can train and she can have equipment that is health and safety approved as she teaches.	Hadassah	Topp
32941	As a past member of the Old Boys Collegians Cricket Club I played and practiced at Elmwood Park for a number of years. The addition of the practice nets at the park would be a huge asset to both the cricket club and the park as a community facility and I am highly supportive of the proposal.	Nicholas	Hawke
32940	What a great idea	Donna	Henderson
32939		Riley	Adams

32938	<p>In today's society being surrounded by technology, we are constantly trying to get our young people off screens and getting active, I find it hard to understand why there would be opposition to this, anyone that would prevent people especially our younger generations getting involved in any sport is frankly pig headed.</p> <p>I fully support OBC cricket club with this proposal,</p>	Deon	Hoeksema
32937		Michael	McCarthy
32936	<p>Good afternoon</p> <p>I am fully in support of Old Boys Collegians' proposal to lease an area of Elmwood Park for their practice nets.</p> <p>This club has been a fixture of Elmwood Park for many years and great enjoyment has been had by past and present players as well as members of the public as spectators because of this. For this to continue and the Clubs presence at this Park to continue to be tenable, they require up to date and fit for purpose practice facilities so that player development can occur and players can train at an elite level, as well as drawing potential recruits to the club. The current facilities are clearly not up to this level, and you only need to do a little bit of research as to what the proposed nets have to offer compared to the current ones to see this.</p> <p>Granted, an argument can be made that Elmwood Park is a shared space and the cricket facilities should not dominate this area, however the proposed nets are only on a small part of the park which already has practice nets located there and the retractable nature of these new nets mitigates any perceived encroachment on the park.</p> <p>Aesthetically an update on the old nets is also of benefit for the park on the whole, as old nets pose the risk of turning into eyesore and anyone enjoying the great area that is Elmwood Park would be left wondering why these old nets exist and are so out of place when the rest of the space looks so great.</p> <p>I for one see benefits for both young and old, parents and children present and of future generations if these nets are given the green light, and I look forward to being able to enjoy the use of these upon their construction.</p>	Reid	Trewin
32935		Laura	Fairbrass
32934		Trina	Leeson
32933		Ella	Jamieson
32932		Kenzie	Pringle
32931		Stacy	Mcmillan
32930		Sam	Ashworth
32929	<p>I live at [REDACTED] and cricket club is good for community there since it's the biggest in the South Island.</p> <p>I love playing Cricket and its one of the best sport I feel.</p>	Sheetal	Bakshi
32928		Gabby	Sullivan

32927	There is no reason why any sporting facilities should not be allowed on public recreation zoned land Cricket nets are used very seldom over a week and not all for 6 months of the year	Christian	Taylor
32926		Emma	Kench
32925		Miki	Tiltman
32924		Alli	Kennedy
32923		Caitlin	Reid
32922	OBC Cricket Club bring a lot of activity to Elmwood park. I played for them for four years and really looked forward to practice every Tuesday and Thursday afternoon during the cricket season! The nets were getting a little bit old when I left in 2017, so I think they are definitely ready for an upgrade. I remember the small improvements that were made when I was there, like the upgraded changing rooms, toilets, and deck area where I spent Saturday afternoons reflecting on a great (or awful) day of cricket. There have been a lot of top quality cricketers play for OBC over the years, and you can see them on display in the changing rooms. So if the club and Elmwood has the best facilities in Christchurch, then that will attract the best players for years to come, and hopefully bring more and more success, support, and trophies to Elmwood. Finally, I always remember the kids training before us and they will also benefit from an upgrade to the facilities. The men's team often consisted of a few coaches for the kids to help grow the club from the ground up.	William	Gillard
32921		Isabel	Condon
32920		Jacinta	Savage
32919		Paul	Adams
32918		Grace	Flanagan
32917	I think this would be a great facility for not only obc but any local cricketers and park users	Melissa	Banks
32916		Georgia	Edge
32915	As an overseas player who played at old boys collegians cc this year, the club allowed some fantastic opportunities. Unfortunately the lack of suitable nets made practice difficult and not as rewarding as it could have been. In my role as a coach at the club, running sessions with juniors in dusty, concrete nets meant they couldn't display and attain their full potential in trainings and therefore on the field. I think new nets would be a fantastic addition to the community.	Tom	Scott
32914	The current nets are dangerous. I feel unsafe walking around Elmwood Park when they are being used (I'm there every week during summer). I love seeing people enjoy cricket, and the fact the nets are always full is great - but the current nets are past their best before date and poorly designed - it is only a matter of time before someone gets seriously hurt. The Club look like they're trying to be proactive to make sure this doesn't happen - and I couldn't support this development of the existing facilities any more. Look forward to seeing it completed!	Mollie	Barrell
32913	I have played cricket at Elmwood Park since I was 5 years old (now 22), and the nets since then have not changed at all. The run ups are dodgy, and nets are not enclosed enough to ensure the safety of those using the areas around them. They are in desperate need of an upgrade, not just to support the players at the club but for the safety of everybody whether affiliated with the club or part of the general public who use Elmwood park. The upgrade is on something that already	Sam	Boyles

	exists and will continue to exist regardless of whether they are upgraded, however this upgrade ensures that safety is a priority and that up and coming cricketers have a modern area to practice in. I completely support the need for an upgrade to the OBC/Elmwood park cricket practice nets.		
32912		Madeline	McCormack
32911	As a parent of a junior cricket player, we are always looking for practice facilities to use and it would be fantastic for the local community and developing the sport.	Nicola	Adams
32910		Josh	Smith
32909		Josh	Smith
32908	I support this due to having been a former player at OBCCC and being a resident of the park area. Having trained and played here I believe that the existing training nets have been dangerous for years. The general public while I played here also came into danger whilst walking the park with balls being hit towards paths. Another example is children using the nets while a game is being played which put them in danger. This is and always has been a cricket park and opposing this will over time effect children's ability to safely train here and eventually a member of the public will be harmed.	Dave	Johnston
32907	These nets will benefit the entire community and give children and adults the opportunity to be outside in a much safer environment.	Caryn	Stevens
32906	I would definitely support to this proposal so club can be able to get sufficient facilities which is required for players and community. First of all, Old boys Collegians is one of the best cricket club in South Island. Most of the greatest cricketers were part of this club in their struggling days such as Brendon McClum, Sir Richard Hadlee, Corey Anderson, Todd Astle who is currently part of our club. Old boys Collegians cricket club produced heaps of great cricketers and there is no doubt that this club will keep producing future stars which will help our city, community and country and will make us all proud. But we definitely need to get Council's support so the players can get good facilities. Please consider my words as these nets are one of the important thing we need for all current players and future cricketers. I would be really thankful to you if you pass this proposal.	Mohit	Marya
32905	The retractable netting is a great idea.	Theo	van Woerkom
32904	The proposal of the new nets are much safer for players and the community. There would be less risk of someone getting injured.	Hannah	Stevens
32903		Emma	Blundell
32902	We really need a proper nets area to have nets, without the fear of hitting someone's head. We should think of it as community asset which the Club is attempting to provide to us and our future generations to come. Safety of the people around the nets is more important to me, and having this approved and developed, it will be more safer for the people using the park for running, jogging, playing with their kids and walking their pets; as they wont have to worry about them getting hit with a ball.	Faisal	Abbas
32901	This will be a great asset to the park. OBC is one of the biggest cricket clubs in the country and it needs the quality facilities to provide for its members.	Logan	van Beek
32900	Would be great for the club and the community	Fraser	Sheat

32899		Miranda	Laney
32898		Deacon	Laney
32897		Akira	Laney
32896	Great Idea I play girls cricket for OBC	Sia	Laney
32895	Big believer in promoting healthy sporting activities in the community, as a way or promoting good physical, mental and social health.	Howard	Smith
32893	Yes great idea and will be great for the park also safer than the ones there at the moment	Brendan	Laney
32892	I think these nets will be a wonderful and beneficial asset to the community.	Ben	Bellamy
32891		Michelle	Little
32890	supporting users of these nets. It's a great sport, good social and physical activity is good for mental health. Cricket is the backbone of our country and these nets would support up and coming cricketers in the future and provide a fair and safe place for many users	Ambyr	Clay
32889		Braeden	Jones
32888		Philip	moyle
32887	An essential safety requirement. The current nets are dangerous and require reconfiguration. Many people walk around the corner and all it takes is one loose bowl and someone could receive serious head injury. The proposed is excellent being fully enclosed therefore removing this risk. Cricket has been and hopefully always will be played at Elmwood park so it is now relevant to move with the times especially around H&S focus in todays world. I have 3 children all members of the club and we all use the nets (6, 9, 11 yrs old) with varying degrees of safety (Hard, semi hard, kiwi balls). I know from personal experience the risks the current nets pose and I am very surprised there has not been a serious accident to date. The retractable nature of the proposed is well considered to ensure the park retains its football focus in winter. I fully support the proposal.	Tim	Elstob
32886	Any move to facilitate access to sports, is good.	Gerald	Weenink
32885		Karen	Letchford
32884	I support OBC with this proposal	Bill	Potter
32883	A must for young cricketers in the area	levi	macpherson
32882		Scott	Weenink
32881	I support OBC with this proposal	Anthony	Dawson
32880	I support OBC with this proposal	Nicki	Dawson
32879	My son is a current cricket player with OBC and I coach his team. We live locally and use the current cricket nets . I have been continually concerned at using these nets for cricket trainings with the team not only because of the risk to the boys training but also to the spectators and passers by. We have had boys hit by	Richard	Shepherd

	balls from other nets and many near misses with balls hit over or through the nets. Additionally the boys cannot practise when there is a game going on and the current state of disrepair of the nets is causing safety issues for the boys slipping on the dusty dirt. We need a modern safe practice facility for all members of the public.		
32878		Jolene	Cliff
32877		Henry	Little
32876	It is great to have a private organisation wanting to invest their own money into a park to increase its use and better the facilities for sportsmen and the general public.	Ed	Hadfield
32875		Wendy	Doesburg
32874	My kids love the cricket club and new nets would go a long way to keeping them safe while being active	Reagan	Hadfield
32873	Kids playing / practice cricket	Christopher	Lewis
32872	<p>My son played several seasons for OBC juniors so we are very familiar with the existing nets and requirement for upgrading. The existing nets are outdated, too close to the walking path for safety and the grass bowlers run up very quickly gets badly scuffed and potted making them also dangerous. My son reported being unable to even play proper cricket shots during club practices (mandated by coaches) for fear of hitting walkers, passers by and gym members doing workout classes. We attended the park at various times to use the nets but due to games on the main ground or the grass under poor repair the nets were closed or unable to be used due to the run up encroaching the ground or balls being hit onto the field.</p> <p>I favour the proposed new nets location, position and style because; 1. they will be safer as the balls will not be hit where there are walkers or members of the public and the new nets will contain the ball much more effectively 2. Their impact can be reduced during the off season by the non-permanent section being folded away 3. The new turf will be a much better playing surface 4. this will be a great facility that will encourage fitness and health and well being of all that use it, it will be a desirable place to practice so will be well utilised 5. its well away from residential housing and can be used even when matches are being played on the main ground and the new pavillion is in use 6. the old nets need</p> <p>replacing this is a great solution for that, the wire mesh and hard concrete are rough on the expensive cricket gear.</p>	David	Wright
32871		Duncan	Spear
32869	I support OBC with their proposal	Craig	Chalmers
32868		Grace	Lemon
32867		Gary	Woolf
32866	Sport good.	Isaac	Findley
32865		Maddie	Tasker
32864		Donna	Hartley
32863	The club have spent a lot of time and thought into getting training nets built at the park. The upgrade of nets and new position of the nets create a safer environment for players and surrounding neighbours. The new proposal is far better than how the park is set up currently.	Cindy	Churchill

32862	The net will protect the public from accidents happening.	NICK	LEE
32861		Totoa	Auvaa
32860	I currently reside next to the Merivale-Papanui Cricket Club, which is located on the Edgar MacIntosh park. During the cricket season, the number of cricket balls that flies over our fence is rather very worrying. I support the sport and it certainly bring people together. However, I would highly recommend for cricket clubs to have a net to minimise or prevent fly away balls.	JIN YOUNG	LEE
32859		Angie	Forrest
32858		Jay	Patrick
32857	Supporting the proposal for safe training nets to be installed.	Evangeline	Hill
32856	Vitality important to keep growing all levels of cricket in the region and adequate training facilities are a must.	Todd	Astle
32855	<p>I first joined OBC Cricket Club as a 8 year old. I ended up playing and coaching at the club for the following 30 years.</p> <p>Its always been a well run cricket club attracting many players from other clubs due to its friendly and family orientated atmosphere. As a coach of junior cricket club in the 2000's I always spoke to the locals that walked around the park....and everyone loved seeing the kids out on the park playing cricket. I am very surprised now when I hear the a small group of local people are against the development of the cricket club.</p> <p>Sport and team sports in particular are a great environment for young people to learn, be activate an interact with others in a team environment. Old Boys Collegians Cricket Club has been, and should continue to be a great place for kids and young adults to play sport and and help develop them into great people...and who knows, that could go on and represent their country like past player from the club!</p>	Corey	Barron
32854	Self funded. Consulted locals. Benefits the club	Andrea	Ting
32853	I'm supportive of OBC's revised approach to upgrade the nets.	Aaron	Spowart
32852	The sight of players in white practising cricket has been part of the scenery at Elmwood Park for decades. Many would say it's a major contributor to the leafy ambience of the neighbourhood and keeps other not so desirable elements out. In addition it's a strong force for social good, bringing together people of all ages and walks of life. Making room for this well-designed practice facility seems a very worthwhile community investment that does no harm to the environment.	Alistair	Armstrong
32851		Vicky	Duff
32850	Having a safe facility for a club to train is needed. Especially for a club of this size. The current layout and facility is not up to standard and the improvements that have been provided will not solve these issues but create a great community training facility.	Gareth	Greenfield
32849	Think this is a great initiative to help keep kiwis active.	Erin	Webley
32848		Erin	Hyde
32847		Georgia	Cottrell

32846	This would be a great thing for the community, particularly for the hundreds of children who use the park to play cricket regularly. It sounds like a much safer option than what is currently being used, both for the children and members of the public passing by.	Joel	Abraham
32845		Tony	McClelland
32844		Prudvi	raj
32843		Brendon	Rosie
32842	Cricket is a popular summer sport and the club is the largest cricket club in the south island with numerous junior and senior teams so is an integral part of the community. Upgraded facilities will help to promote the game and also make it safer for other users of the park and local residents.	Abhi	Shrikhande
32841		Alex	Groves
32840	I am supportive of the clubs proposal after viewing its documentation	Mark	Brown
32839	I support OBC with this proposal.	Sophie	Copeland
32838	Safety! Without the nets someone might get seriously injured in their own backyard!	Emma	Jones-Burne
32836		GEOFF	TINEY
32835	I support this proposal as it is important that we upgrade facilities for the future players coming through, not enough is done for the ordinary sports players that just want to get out and practice and play a sport they love.	Sue	Cliff
32834	I support OBC with this proposal	Charlotte	Anderson
32833	Anything to improve and promote safe sporting is good for CHCH and NZ.	Tony	Mortensen
32832		laihua	jin
32831	i support the Proposal of OBC for this at Elmwood Park	Matt	McEwan
32830	I support OBC with this proposal	Helen	Spear
32828	I support the proposal.	Lucy	Knight
32827	I support the proposal.	Samantha	Knight

32826	<p>To whom it may concern,</p> <p>As a proactive cricket club we are simply looking to upgrade our old nets that are past their use by date, that dont meet current standards and make sure that all park users are safe in any situation when they use the park. All of this is self funded without a demand of any monetary contribution from the CCC.</p> <p>With collaboration with the CCC team, we have jumped through every conceivable hoop to make sure that we utalise these facilities in the correct space within the park. We have also compromised with our design. We have tried to be as flexible as possible in every facet to provide a facility that the wider cricketing fraternity in Christchurch is able to use. We have a large member base that needs this upgrade to facilitate our basic needs for training. A large proportion of our member base lives within 5klm of Elmwood Park, so the users of the park will be locals. Also we anticipate that the local schools specifically Elmwood and Heaton will be active users of the nets also. So this isn't just an OBC specific nets, these are for the wider Elmwood Park community. Again this is something that we are incredibly mindful of, simply we want as many people using the nets as possible from the local community.</p> <p>As Hagley demonstrates, if we are able to have great cricketing facilities within Christchurch people will come and utalise them. We are trying to help the next generation of cricketers improve and fall in love with the game, so that they have the opportunity to come down to the best park in Christchurch and play cricket, its not a difficult request. Throughout Christchurch there is a distinct lack of decent training facilities and this is the first step in the right direction to help lift the standards.</p> <p>Throughout this whole consolation we have tried our best to be as open, transparent and collaborative as possible. We have the wider park users at heart, as we want them to be as safe as the net users. We love Elmwood Park, its a true privilege to call it our home, our club in one way or another has been based at the park for coming up on 100 years. We respect that we are a small part of the wider group of park users, and in no way are we looking to dominate the park, we are looking to upgrade or facilities, which will have a wider impact on the local area. We just want as many people playing cricket as possible and we feel this is a great way to get people to do that.</p>	Paul	Knight
32824	Implicating this proposal will ensure that the park is safe for public use as the nets will be enclosed.	Ammar	Mohammed vithodawala

32823	<p>I began playing cricket at Old Boys Collegians when I was roughly 7 years old. I remember training at Elmwood Park and using the practice nets when I was a junior member of the club. The current design of the cricket nets hasn't changed since I started, to when I continue to train as an adult member today. I'm 25 years old, and as a very proud member of the Old Boys Collegians Cricket Club I have significant concerns with the current design and state of the practice nets.</p> <p>Simply, the current nets are too dangerous. I am a registered physiotherapist in New Zealand and see a range of different people in our clinic with a wide ranging degree of issues they seek help for. One ACC contract I work on is the NZ concussion contract. I see people that have had what is classed as mild to moderate 'concussion' injuries who in some cases have had ongoing symptoms for 1 year or more. The effect on these peoples lives, their families lives, their work and social lives is significant. To say that a concussion based injury, other bodily injury or a severe head injury is possible from the design of these nets is an understatement. The main safety issue I see with the current nets are;</p> <p>- The open nature of the bowling lanes means batsman are hitting back toward other people, often across to other lanes endangering those training in other net lanes. Moreover, the direction the nets are facing means batsman are hitting out toward the middle of the park. Many members of the public and community often walk or exercise in this area and are certainly endangered.</p> <p>I would hate to see anyone hit by a cricket ball and suffer a life changing injury. I see these types of injuries in my workplace and understand the effect it could have on their life and the lives of others. To understand the risks now and know that we can take action to prevent injuries of this nature is potentially then life changing. The new design of the nets would significantly reduce the risk of these types of injuries occurring. The key benefit of the new design is;</p> <p>- The new nets are fully enclosed. This completely reduces the risk of balls flying out of the net endangering the public and other people using the nets. This could clearly, significantly reduce the risk of mild or severe injuries.</p> <p>I would be more comforted knowing that for future generations and community users of the Elmwood Park nets, that we have done all we can to reduce the risk of future serious injury. The only possibility I see is to take action and replace the existing nets with the new design proposed. I truly hope my fellow community members and members of the Council also see this in the same light.</p>	Tim	Braid
32821	We look forward to the completion of the new clubrooms and nets. We wouldn't have any problem if the temporary nets were permanent	Sally	Smith
32820		Craig	Gibb
32819	<p>My 10 year old son is a member of the OBC cricket club and loves the game. He plays in one of the 50 junior OBC teams and has just had his first season of "hard ball". Unfortunately his team had very limited opportunity for batting practice during the season due to the limited number of nets available in the summer. Alternatively I would take him down during the school holidays or Sunday afternoons and quite often we would be required to wait for a net to become available.</p> <p>Doubling the capacity of the nets during the summer season would provide more opportunities for budding young cricketers to practice and have fun with their team mates, with enhanced facilities (particularly the current uneven ground at bowlers end) enabling for an overall better experience for all cricketers at the club</p>	Mark	Weeds
32816	I have two daughters who train at Elmwood and the current position of the nets is dangerous. I have seen so many near misses and I know it's just a matter of time before someone is seriously injured by a flying cricket ball. The proposed new location for the nets makes perfect sense and would decrease the risk a lot.	Joanna	Spear
32815	will be a fantastic addition for ground where children and adults have always played cricket	andrew	steel
32814	<p>The existing nets are worn and dangerous. It is difficult to understand any objection to the replacement or upgrading of an existing facility.</p> <p>The new nets will compliment the proposed new cricket pavilion in the park, and enhance the park's appearance.</p>	Lois	Williams

32811	As a parent of a young cricketer who uses Elmwood park weekly for cricket practise I can attest to the current dangers outlined in the proposal in relation to the cricket nets as they stand. Cricket balls are flying everywhere, in extremely close proximity to the clubhouse and sitting area. Cricket is a highly engaging sport for our young people and Elmwood park is the most local and utilised park that needs sustainable, practical but most importantly safe nets. I support this proposal.	Nick	Leith
32810	There are limited supply of outdoor facilities for cricket payers in Canterbury. This submission is very generous and it also provides community access to the facilities. I support providing opportunity for all ages to get out and about and a facility like this would provide another option for the community to be outdoors and pursue healthy activities.	Craig	O'Loughlin
32808	We need to encourage any outdoor activity for all ages . Group activity for people has far more benefits than sitting at home on play stations etc .	Stephen	Daly
32807	Our kids have played for OBC for a number of years. The current facilities are unsafe and embarrassing for a club of this size and reputation. I fully support this application and I am reminded of the same issue that a small vocal minority had with the Hagley Oval, look what happened with that, a resounding success.	Shannon	Parnham
32805		Julian	Marsh
32803	I don't see any possible objection here - the club is basically just renewing something that already exists and at the same time making it safer for the general public. Where is there any downside in that? Furthermore, when one considers the number of club members - most of them young boys - who will have their recreation enhanced by these nets, surely it is exactly the sort of initiative that should be supported in the name of good health, both physical and mental. I have exercised in Elmwood Park for many years, and it always adds to my experience to see young kids practicing cricket in the OBC nets, in fact it makes me happy. Upgrading this facility and at the same time making it safer for all is surely to be applauded.	Greg	Russell
32802	As locals we use the nets all the time during the summer and fully support the proposal to make them safer and enclosed. They are a heavily used community resource with children and OBC cricketers and they will be an asset to the community. The new design makes them so much safer as cricket balls will not be sent flying into Elmwood park. I have noticed that cricketers have to use them backwards so as not to send balls into the field of play currently! Whenever we walk past there is always someone using them and this will surely increase when the nets are updated and made safer.	Claire	Collins
32801	I think these will be a great asset to the public and especially children keeping them busy and active.	Daniel	Vann
32799	Being an active player I would love to be part of such a club and sports should be given a priority.	Mirza Aman	Deshmukh
32798	The nets would be a great improvement of the current ones which are out dated and quite dangerous with the lack of protection and technology. OBC being Chch's largest club it would be huge for the juniors in providing a resource for them to get better at the game they love and potentially get more kids into the sport which provides such great opportunities to them. The current nets are not a fair resource for the size of the club and the quality of juniors that are playing there. The nets would also provide the public a great and safe resource to try out cricket at any time of the week. This would mean a lot to the community around elmwood park and the whole cricket community.	Edward	Nuttall
32797	This is a sound investment for the club and the community. The current nets are in need of significant repair and this proposal provides improved/safer nets for the club and community.	Peter	Hay
32796	The nets are widely utilise by children and adults that play cricket not necessarily for OBC. They are currently in a tired space with poor run ups and open to the main ground. This means that there are health & safety issues both for the players and general public. Elmwood park is a great community asset and the development would only further support this. My children and family are fully supportive of this to allow improved access and utilisation by all visitors.	Mike	Whitty

32795	<p>This absolutely must be approved by the Community Board. Old Boys Collegians Cricket Club has 50 Junior teams and 10 Senior teams, and is one of the largest and most historically significant Cricket Clubs in New Zealand. It has a proud history of fostering high profile international cricketers like the Hadlee family, Geoff Allott, Brendon McCullum, Shane Bond, Corey Anderson, Todd Astle, Katey Martin, Erin Bermingham and many others - but more importantly it helps strengthen the community by instilling within our 400+ Juniors the values that cricket provides which help to mould great people.</p> <p>The nets at Elmwood Park are heavily used with Junior and Senior members of the community (whether Club members or not) using the 4 lanes currently there on a daily basis - often these are full during the summer from 3pm until sundown all week long - they are a great community asset. However, as they currently stand, they pose real dangers to the community - both those using the nets as cricketers, and general park users - they are open and allow hard balls to fly out towards park users and neighbours alike. The nets also overlap with the boundary of a field which is used every weekend - meaning the practice nets are unable to be used when cricket matches are happening at Elmwood Park. The grass run ups are used so often that they are now uneven dirt strips which are dangerous and unsatisfactory. Further, the current nets have holes in the metal wiring from the wear and tear they've endured with thousands of hours of use and enjoyment they've provided - which clearly is also dangerous and in need of change.</p> <p>The new proposal is a great one - it aims to update the existing facilities, addressing the health and safety issues by having a fully enclosed design and will be able to be used by the general public as a community asset (as the current nets are). The removable enclosure is a result of community consultation and concessions made to alleviate concerns from some locals who have been involved in the feedback process. The footprint increase is a result of fully enclosing the run ups - which is for safety purposes, and the location of the nets must be different when taking into account where the approved Pavilion is going to be. Concerns regarding aesthetics and size must be overrode by the need to protect users of Elmwood Park from hard cricket balls flying around. Please remember this proposal is simply updating existing facilities.</p> <p>The community board now simply MUST support this project. A previous version of the proposal was supported by over 100 positive submissions during the last consultation process, but this was railroaded by a select few - with these consistent delays and inefficiencies in the process costing the Club both thousands of dollars thanks essentially to one loud dissenter. To not listen to the overwhelming majority who want these developments would set a very dangerous precedent for progressive sports clubs around the city. As local councillors it is your job to make sure the vocal minority does not unjustly stop such projects. Having been involved with this process from the start and being privy to the interactions between the CCC, the Local Board, interested community members and the Club I feel very strongly about this being approved - and to not gain your approval at this meeting would substantially erode my faith in the Board as a whole and local body politics generally. I hope this is not the case and the right outcome is achieved for the benefit of future generations - the loud voice of one angry man should not be given the same weight as a cricket club that has 600 current playing members, with countless family and friends on top of this who support the proposed developments - it is not the Club vs the Community, we are all a part of this community who love Elmwood Park. Thanks</p>	David	Wakefield
32794	A heavy user of the current nets and clear to see they are no longer up to standard and can not be maintained enough, along with the current nets being on the field of play for competition matches.	Nick	Gibb
32793	<p>This will be an amazing facility for Elmwood Park and the community. Surely anything that is encouraging children and adults to get outside is fantastic. Such a shame it hasn't happened already.</p> <p>The location and proposal appears well thought out, and allows for a wide path and plenty of park area for everyone else.</p>	Deborah	Simpson
32791	I am in favour of the nets to go ahead. having played at the club for the last 3 years it is evident that the current nets are very hazardous and are not upto standard for the number of players that wish to use them. more often than not there is someone being hit by cricket balls that fly out of the nets or every 5 minutes someone is shouting heads as the ball lands 5 meters away from a group of people. it is not only dangerous for the people using the nets but also to the public walking close by. countless occasions kids or dog walkers using the path are being hit or just missed and it is unacceptable when we have the resources to upgrade them for everyone's safety.	Nic	Clark
32789	<p>The existing cricket nets are worn and dangerous, and need replacement. It is difficult to understand any objection to the replacement or upgrading of an existing facility.</p> <p>The new nets will compliment the proposed new cricket pavilion, improving the appearance of the park.</p>	Lois	Williams

32788	Participation at all levels are struggling in Cricket. Any opportunity we can take to provide facilities to try and engage the community are highly important.	Joshua	Bates
32787	Participation at all levels are struggling in Cricket. Any opportunity we can take to provide facilities to try and engage the community are highly important.	Joshua	Bates
32786	The existing are dangerous for general park users and cricketers. This proposal makes these facilities much safer while improving the parks facilities.	Philip	COWAN
32785		Matt	Farrant
32784	There is a general lack of cricket nets for players in Christchurch. It is essential for players to be able to practice and clubs to have nets available so they can encourage and develop players. Sport is very important to the mental and physical well being of children and adults, only positive outcomes can come from having enhanced cricket practice nets. Our family use the nets a lot but find the current nets are substandard and definitely need to be replaced. We need these nets now, more than ever!	Glenn	Nuttall
32783	Great proposal and ground needs this upgrade	Ben	Langrope
32782		Caleb	Heyns
32781		Jason	Pawson
32780	I have two boys that play junior cricket for OBC. The current cricket nets are too close to the temporary pavilion area (where kids and adults hang out) and are old and not for for purpose. For safety's sake, the nets need to be replaced / improved. The retractable version looks to make a lot of sense, as does setting the nets as far away from the houses as practical.	Nigel	Murphy
32779		Rick	Walker
32778	I support the proposal for new cricket nets at Elmwood Park. As someone new to cricket I believe the new nets will be safer and more enjoyable for people who are new to cricket due to the new nets being much safer then the nets currently in place. I also believe the current nets are not safe and need to be replaced by new safer nets which will allow the community and cricketers using the park to feel safer	Nick	Daniels

32777	<p>OBC should be granted approval to build new nets at Elmwood Park.</p> <p>If we could see the bigger picture here for a minute. We as community members, I would hope, want to ensure that the members of our community are protected from unnecessary harm at Elmwood Park. And that our members can frequent the park without having to worry about the health and safety of children, teenagers and adults.</p> <p>At present, the current OBC practice nets face the public path. They are a hazard to passers by and to those coming and going from Elmwood fitness. They jeopardise the public's health and safety because they are open and allow cricket balls to fly up into the air and land directly onto the public path and onto the decking where many park goers walk, or run and congregate in groups respectively.</p> <p>Too many times during junior training sessions I have witnessed cricket balls flying passed children's heads. During one game, I witnessed one child, no more than 10 years old, get hit by a cricket ball on the full, on the back of his thigh while he practiced in the nets with his back to the game. If that ball hit him a couple of inches higher, we could have had a very serious situation on our hands.</p> <p>In their current state, the nets are a danger to men, women and children, particularly children and passers by. It is literally a matter of time before someone is seriously injured from getting hit in the head by a cricket ball. And for those who don't know getting hit by a cricket ball in the head at speed can be a matter of life and death.</p> <p>Right now, it is in the interests of our community to make a decision that avoids causing unnecessary harm to our community members. This ought to be our priority. If the new nets can circumvent causing unnecessary harm to our community members, they ought to be approved. The alternative is simply dangerous and reckless. We have a responsibility to make the right decision and protect those who can't protect themselves before a terrible accident occurs.</p> <p>I wholeheartedly support the decision to lease an area to OBC for safer practice nets. The park can then be a safer place for everyone and I really hope that all members of the community can see that.</p>	Gwen	Morgan
32776		Asaad	Ali
32775	<p>It is busy club and lot of young and adult teams are using it for practice. New nets are necessary as batsmen hitting towards the path making it dangerous for the general public, dangerous dusty run ups – the new netting structure will be fully enclosed during the season and will take away any threat to public health and safety, which will be a great development for Elmwood. It is a great idea which will benefit current and future generations of cricketers to come, particularly as it will be a community asset.</p>	Habib	Ullah
32774		John	Quirk
32773	<p>This health and safety issue cannot be ignored anymore. The council must be held partly culpable in the event that a serious injury occurs as a result of the current, dilapidated nets. Not only will new nets make Elmwood park a safer place to be, it will also allow the 500-600 Old Boys Collegians players (+ the hundreds more members of the public who use these nets) to enjoy the outdoors and play our national summer sport. The largest club in the South Island deserves better and the people of Christchurch deserve better</p>	Callum	Curnow
32772		Natasha	Leith
32771	<p>It is within the club, public and council's best interests to allow this project to go ahead. It is genuinely a matter of time before a child, stranger walking their dog or player is seriously injured if not killed due to the current set up of these nets, give us the chance to correct this but allowing this to go ahead. It could save someone's life and will also increase children's opportunities to make the most of the nets. It's an investment of safety and is the common sense move to give this the green light.</p>	Jack	Lewis
32770		Becky	Wilson

32769		Ben	Brady
32768	<p>I am one of a number of coaches aligned with a number of teams across the week, between 3.30 - 6.30pm daily with the OBC cricket club. We are a group, responsible for delivering a safe and meaningful experience for all of our Junior club cricket players for the OBC club. This Junior Club has been and will continue to be an important community sporting organisation that respects the opportunity to be a part of the history and future of a wonderful facility that is ELMWOOD Park.</p> <p>The safety design of the nets that are due for replacement reflect the ongoing commitment the club is making for all of our Club users of this facility , along with many other cricketing people across Chch who use this facility and all other park users who are utmost in our minds when we plan the delivery of our programme. The design features outlined will enhance the safety of all Park users and improve the aesthetic value of what currently exists.</p>	Richard	Lough
32767	The nets are a wonderful facility for the community my boys have spent many an hour using the nets. Its one of the only available facilities that they can use for practice.	Paul	Belcher
32766		Jordan	Buchanan
32765	As a local resident for 11 years (until May 2019), and a parent of two cricketing boys, as a family we used Elmwood Park and the cricket facilities several times a week. The existing nets are extremely dangerous due to their axis and open-ended design and I have witnessed first hand on numerous occasions adults, children and animals getting hit by flying cricket balls. The proposed design would make the park safer and more enjoyable for all park users. This park is and will continue to be a cricket ground but is a popular space that is enjoyed by everyone. The proposed new nets will not prevent anybody from enjoying using the park for a multitude of activities but will provide a much safer and family-friendly environment for them to do so.	Nina	Baillie
32764	I reckon that would be real good idea to do that . It would help to make security to public and other stakeholders. Thank you	Amandeep	Singh
32763	The club is outstanding at providing the local community with an environment in which to enjoy sport. They are critical to the local area, having over 600 members. The nets are in their last stages of life and i applaud the club for doing everything possible, including using alot of their own money, to make sure the right and necessary changes are made for the safety and enjoyment of all who frequent the park, not just club members. I can honestly say there have been ALOT of near misses due to the poor state of the nets this season for bystanders. It is crucial this is improved.	Jeff	Case
32762		Jason	Tualima
32761	This would be fantastic for the club and all involved. Would be great to give kids and adults alike the opportunity to get involved in sports and being retractable they would keep everyone who uses the park happy.	Luke	Germon
32760	They have been suffering through inadequate facilities for the best part of a decade now and it's surely time to let them get on with it. Even the nimbys must see that this latest proposal is basically the same as the old nets.	Richard	Derham
32759	OBC Cricket has been a part of Elmwood Park since the early 1900's. The proposal to replace old dilapidated nets with a new far safer version and at no cost to the council just makes sense. The compromised design and scale has come at great cost of time and money to the club and shows the clubs willingness to work with the community when both parties are acting in good faith. The location is optimal to reduce noise for the surrounding residents, the space requirements have been minimized as much as possible while maintaining the capability the club needs. This is a win win scenario and will actually foster cricket and other sports due to the public being able to use the space to train.	Jason	Middlemiss
32758	I grew up going to the local nets in my hometown learning to love the game. Why should local children in the area miss out on the same opportunity. Its my understanding that OBCC has worked tirelessly to work with people who are in opposition of the previous proposal. A temporary net solution is a fantastic compromise.	Mark	Barnes

32757	As a past player with plans to play for the club in future I would love to see the club develop in terms of the facilities that they have, the amount of work gone into rebuilding OBC after the earthquakes has been immense, I've witnessed some of the work that's gone into getting to the stage that they are at both on and off the field. These nets would ensure that the club have a safe training facility and still provide the public space that the local community need. This net proposal will make this local park a safer place to be during summer evenings while cricket is being played, it will provide a safer space for children to play cricket in. It will encourage the development of cricket in the area and promote it safely. It may seem like the club is being selfish in developing this site but ultimately there should be no price on the health and safety of everyone and the current situation that the cricket nets are in are not up to the required standards and will not reach those standards unless they are developed out from their outdated design.	Scott	Willoughby
32756	The current nets are not up to standard of the park and club numbers.	Matt	Hay
32755		Sean	Davey
32754		Tony	Banks
32737	As someone who walks my dog twice every day and who has been hit by a cricket ball and whose dog has been by a cricket ball neither serious I would consider its a no brainer that the nets are safe for the hundreds of locals that use Elmwood Park. Over the more than 20 years it is great that the Park is being used especially by school children compared with 20 years ago.	Brian	Smith
32733	I fully support this proposal as providing a facility for the junior and senior cricket players to develop and participate in this great sport is key.	Darin	Cusack
32731	Cricket has been part of Elmwood park for as long as I can remember; the new pavilion & practice nets will enhance the park, especially what has become a tatty corner. The nets will add to the enjoyment & skill level of not only the adult teams, but young players practising. I wholeheartedly support this proposal.	Penelope	Paynter
32725	Yes it's a great place for cricket and nets. My Grandfather lived at 83 St Andrews Square his whole life and cricket was a favorite weekend fixture.	PETER	BURN
32721	The Club is open to all and enjoyed by many young people in Christchurch, not just those in the immediate area of Elmwood Park. Nets practice is part of cricket and it can only be an advantage to all players that those nets at Elmwood Park are up to standard.	Elizabeth	Spear
32718	Cricket has always been a feature of Elmwood Park and the development of players in the club is important. Having played for both HSOB and Old Collegians when I was younger, I want my son to grow up loving the club he now plays for. Community and facilities are a big factor in his development in the club and the new nets are definitely needed to support this.	Gus	Pickering
32717	This is a cricket ground has been for over 100 years. There are nets already there, they are due a new set, this adds to the club and makes the park more attractive.	Jason	Tibbotts
32716	Yes. The Club is an important part of our local community and the lease to enable the net upgrade would be widely used by a number of local families. I personally see this as no different to the children's playground (albeit with an older target audience!).	Karen	Taylor
32715	Current set up not appropriate for use, big park well used and supported by the cricket club without taking away space from recreational users. The new nets would make it safer for all. Would be a great addition to the park and all the keen junior cricket players in the area.	Lisa	Stribling

32714	Having played and trained at Elmwood Park and now having an 11 year old son at OBC, an upgrade of the facilities are long overdue. OBC is one of the larger cricket clubs in Christchurch. Cricket facilities in the city are lacking (particularly indoor facilities). The sport needs to continually provide facilities that attract kids to sport but just as importantly retain them. Elmwood Park has been a cricket park for as long as I can remember. I don't believe the new nets detract from the park but instead will continue to see the park used and enjoyed by another generation of cricketers.	Shane	Bond
32712	I think this would be of great value to the cricket club and the park as it would drive younger players to play cricket and get into it	Riley	Smith
32711	<p>I am the Manager of the OBC 31 Junior team of 8 year old boys. We desperately need enclosed cricket nets at Elmwood Park. The existing open nets are very dangerous with balls flying towards unsuspecting bystanders. You will see from our photos our team have a lot of younger siblings that are exposed to risk during practices. The proposed enclosed facilities would be a huge improvement to the amenity of Elmwood Park.</p> <p>I would be very happy to attend a public consultation meeting should one be held. Please keep me posted.</p> 	Graham	Brown
32710	These will be a great resource for our young boys and girls who love to play cricket. It gets kids playing sports, keeping active, gives them something to do and give kids and families a community.	Lisa	Llewellyn
32697	These are a club and community need. A large number of non-cricket club people use these outside of the club. The club has listened and modified their design, well beyond what might have been deemed necessary. The new design looks to minimise impact on the environment, which was a previous concern of residents. #letsdothis	Simon	Carter
32687	<p>I am a member of the Elmwood Gym and have been a long term Merivale resident .</p> <p>The proposed solution looks an excellent solution which I hope is accepted.</p> <p>I view the Cricket Club as being part of the historical fabric of Elmwood park and integral to it use</p>	Chris	Sherratt
32682	<p>New nets will be an improvement to the park. The new cricket pavilion and facility will improve the outlook and appeal of Elmwood Park and can only increase the value of all adjacent properties. I can see no downside to the proposal.</p> <p>Let the kids play.</p>	Roy	Williams

32679	<p>As a regular user of the park and local resident I strongly support this proposal.</p> <p>The current cricket nets are used extensively throughout the summer and as a community we should be supporting initiatives that promote the use of the park and recreation generally.</p> <p>The nets are an especially important resource for junior cricketers in terms of having a safe, durable and accessible space to practice and play. The existing nets are clearly in high demand by local children on weekday afternoons and weekends for casual practice and it is not uncommon to see children waiting for space in the nets, or playing against the nets due to their use by others.</p> <p>The proposed nets are in a sensible location and will have no effect whatsoever on other users of the park relative to the status quo. In fact, the proposed nets will enhance the amenity of the Park (improved/modern facilities, protection/maintenance of turf, etc) and provide improved safety for Park users (i.e. protection from stray cricket balls).</p> <p>As a regular user of the adjacent pedestrian pathway in this section of the Park, I consider there will be negligible impacts on this path and users of it - noting the open/lightweight nature of the nets, the fact that they are clearly a recreational facility consistent with the purpose of the Park, and the very small extent of the park and path that they will occupy/adjoin.</p> <p>I wholeheartedly support this proposal.</p>	Jeremy	Phillips
32673	<p>The nets are well in need of updating. Not only for safety but the old nets are had it and need urgent replacement. These are used not only by the club but by a number of members of the public and surrounding schools. By having it all closed means these can be used while there are games going on.</p>	Hayley	Abur
32671	<p>My boys both play cricket for the OBC club, and practice at the current unsafe facility. We also, as nearby residents, should be able to use the facility for general practice, but due to the unsafe and substandard nature of the nets are forced to drive elsewhere to a facility that provides the required safety elements.</p> <p>The original proposal was far superior to this current one... but any improvement will be welcomed for our club and the community.</p>	Nick	Carter
32669	<p>I fully support the club's desire to re-position the nets to service the needs of the cricketers. The new position will limit the encroachment onto the playing field which means that both the game and training can proceed concurrently. No one will be disadvantaged by this proposal. I would strongly urge the club to include a firm surface for the bowlers to deliver balls safely, rather than continuing to bowl off an unsafe landing area.</p>	Dayle	Hadlee
32668	<p>It is extremely disappointing that the original proposal was rejected. These are the absolute minimum although will not be as safe for all park users as the original proposal. These nets will benefit so many active young people - and will have a less than insignificant impact on those who rejected the original proposal.</p>	Robin	Simpson
32666	<p>I think everyone has always supported the nets apart from a couple of locals, these nets are a good for the area brings kids to the park. The club need to appreciate the community will use them as well</p> <p>Clubrooms need to be multi purpose so they get use all year and earn some revenue if they are smart about it</p>	Tom	Gorman
32665		Nathanael	Paltridge
32663	<p>Absolutely in support of any sporting initiative which provides our children with improved access and or assets that encourage them to embrace sporting activities</p>	Tracey	Sparrow
32662	<p>Great proposal and to have specific purpose build nets with ability to have retractable nets in off season is a great idea, new nets will provide higher level of safety for all involved, keep cricket at Elmwood!!</p>	David	Tudehope

32661	At a time when we need to be encouraging sporting activity for both adults and children I was very surprised with the previous decision not to support the cricket nets. Having proper facilities for male and female participation at all ages is crucial for their personal development in the sport and I therefore totally support this new proposal. The OBC club has been incredibly accommodating with this proposal and their willingness to offer an alternative is a credit to their consideration of the public. We must however support this volunteer based club that does so much to add to our community.	Geoff	Allott
32659	As a player at the club nets are a vital part of the environment within a club. The club is at a disadvantage all the time that this proposal is not being allowed. The cricket club has been at the park for a very long period of time and this is a replacement and yes an upgrade to make the facility better and safer for everyone not just the user but the member of the public walking past. Over the years I have seen lots of people injured from flying cricket balls. This needs to be addressed.	Mandie	Godliman
32658	New nets are a desperate need for the over 500 member that use them every year and the numerous members of the public that utilise them. The current ones are extremely unsafe.	Amanda	Godliman
32657	I feel the current nets need an upgrade. I love the fact that families turn up to use these on different days and hours and I would still prefer the old design but see this and good middle ground. with this proposal the people who use the park to walk their dogs will be happy.	Bryan	Walker
32656	The previous proposal had overwhelming support at the public meeting but was rejected through opposition from a minority of non local residents. This proposal must go ahead to support the cricket club. There is considerable concern that vandalism will be a problem with this new netting.	Brian	SPEAR
32655	These revised plans are great and will be a great addition to the park. I fully support. The Cricket Club should also be encouraged to keep the current gym that operated all year round and independently of the Cricket Club/season, that can be accessed by the paying public.	mark	doyle
32654	The club is a big one and has a large positive influence in the community getting many girls and boys playing active sport. The adult teams seem to train on grass mainly so this proposal's biggest affect is to enhance sport for young people which is very important for me having had my children using the existing facilities. Enclosed nets will also be much safer for other park users.	Martin	Paltridge
32653	The current nets are a health hazard with members of the public and junior cricketers at risk every time they are used. The largest club in the South Island needs better facilities in order to grow the game in Christchurch. The council has a duty to nurture sport in the garden city	Callum	Curnow
32651	I have 3 daughters, all playing cricket since a young age and each girl has now progressed into Intermediate and Senior grade cricket. My girls practice cricket most weeks be that for the club or for their school (Heaton and St Margarets) and the current nets provided at Elmwood Park are inadequate from both a safety and the general state of the surfacebut there are no options for alternate areas to practice in all weather. Whilst OBCC are the key users and provide the bulk of the funding for the cricket nets, Heaton Intermediate (current NZ Primary School National Cricket Champions) and local players from other clubs also utilise the nets that are currently in place outside of the OBCC teams practicing. I attended the meeting last held at the Elmwood Club and, by a long way there were more people supporting the decision for OBCC to erect new nets than against. The arguments of shade being a factor were quite easily dismissed given the area where the nets are proposed to be moved to is surrounded by mature trees in excess of 35 metres tall.	Cam	Spear
32649	Long overdue!	Matt	Parr

32647	<p>I approve this submission for the following reasons:</p> <ol style="list-style-type: none"> 1. The proposed plans are much safer for all users of the park, not just cricketers. 2. The current pavilion has reached its end of life and a new pavilion would improve the aesthetics of the area. 3. The new net facilities would enable children to access them on a Saturday during game time, which is not a possibility at the moment due to senior games being played. 4. The existing net facilities have become run down and require an upgrade, regardless of location. 5. OBC have the largest junior section in the South Island and to improve the cricket experience and keep them interested and active then the facilities should be of a decent standard. <p>On a personal note, OBC had a huge impact on my life as a youngster growing up around the club (and its predecessor Old Collegians CC), and I have many positive experiences and memories from the 20+ years i spent at the club as a junior and during university and adulthood before moving to the UK. The club was wonderful throughout this time and survived on the commitment and efforts of its members, as the facilities were never top quality. I would love to see the club granted this licence so they can move forward and provide more positive experiences and memories to new children, with the facilities that they deserve.</p>	Timothy	Barringer
32646	A new pavilion will be a welcome addition than that current temporary and unsightly cabins. The retractable nets provide a perfect compromised solution.	Jo	Spillane
32642		Brendan	Fahey
32641	Necessary for any cricket club. Nets need to be safe for both players and the public. The only query I would have is if the nets are aligned parallel to the existing footpath is there a risk of the public getting injured by balls exiting the end of the nets?	Ben	Larter

Submissions not in support of the proposal to lease an area of Elmwood Park to the Old Boys Collegians Cricket Club for cricket practice nets

Submission number	Comments	First name	Last name
33333	<p>SUBMISSION AGAINST LEASE/LICENCE For New Pavilion and Practice Nets</p> <p>I am all for new sports facilities to replace the damaged buildings at Elmwood Park.</p> <p>However, they must be proportionate within the park and balanced as to accommodate all the local community park users. Contemporaneously, the design, layout and purpose of these facilities must not have detrimental impact that would discriminate any person or persons of the local community that are in walking distance of this park.</p> <p>OBJECTIONS In light of the size of the Pavilion that has been agreed to lease by the Christchurch City Council, I must object, in their entirety, to any permanent cricket net structure for the following reasons.</p> <p>OBJECT TO THE LOSS OF GREENSPACE - The value of community parks has become even more precious to the local communities as evident by the Covid pandemic, at times it was even difficult to abide by the social distance rules due to the number of local park users throughout lockdown.</p> <p>- Mental Health is of growing concern throughout the country and to combat mental health taking a 30minute daily walk is given as the highest advice by medical experts. That advice is typical of the distance the highest local users in the immediate vicinity of the park travel. Many of whom have not had the opportunity to have their say in both applications by Pavilion & Nets.</p> <p>OBJECT TO THE ADDITIONAL SHADING - The additional building structure and permanent net structure combined will greatly impact local community taking a walk through the park, impacting ½ of the entire path of the Northern end of park. The original cricket structure only impedes a small portion of this area.</p> <p>- There will be a loss of enjoyment from park users entering from St Andrews Square on this more frequently used path, as it is bathed in sun in the Winter. Park users will have to walk past these large structures and half way to Heaton St before being able to look out into the park. This will severely impede the ambient feel of entering the open green-space as it is dominated by these oversized sports facilities on this small park.</p> <p>OBJECT TO THESE LARGE FACILITIES ATTRACTING ADDITIONAL PARK USERS FROM OUTSIDE THE LOCAL COMMUNITY CREATING INCREASE PROBLEMS WITH:-</p> <ol style="list-style-type: none"> 1. Additional load on traffic; this additional traffic is already at hazard levels for young children on this busy road. 2. Parking already at capacity with the existing facilities. No additional parking has been provided for with the amalgamation of the two cricket clubs. 3. Additional rubbish. The rear side of most sports facilities lead to unsightly areas of unused equipment, rubbish bins and skips. These must be housed within the building footprint and hidden from the walking community. 4. Additional noise pollution (combination of pavilion, nets + other proposed facilities) attracting much larger numbers of people on top of the local community users. <p>OBJECT TO LOCAL COMMUNITY PARK BEING DOMINATED BY CRICKET EFFECTING - Local community needing somewhere to go to walk and relax, unable to because the large cricket events due to the amalgamated clubs, with members travelling from outer suburbs.</p>	Gordon	Stamper

OBJECT TO CONDUCT OF COUNCIL FOR THE INITIAL CONSULTATION OF PAVILION WITHOUT PROPER PROCEDURE & NOTIFICATION OF LOCAL PARK USERS

- being conducted during school holiday period with notices being sent out after start of holidays so people missed the notice
- Council not notifying park users that are in walking distance from the park as identified by the numerous people spoken to when concerned residence started to talk to the local community by conducting their own letter box drop.
- Object to the building area claimed by the Cricket as “existing” as these temporary buildings were only installed after the Earthquakes, and do not form part of the original lease. Therefore can not be claimed as existing to give the impression that the new area is only slightly larger. The council board was completely misled and misguided on this issue by the Cricket club.

OBJECT TO CONDUCT OF COUNCIL FOR CONSULTATION OF NETS

- Conducted whilst country is in a Pandemic and community movements have been impeded, businesses suffering and other major problems causing people not to be in the capacity to look at the effects of these proposals.
- Council not notifying park users that are in walking distance from the park as identified by a few people spoken to at the park
- Council made an extension to this time but did not publically notify the extension and only advised a handful of people.

OBJECT TO COMMERCIAL GYM THAT IS OPERATING FROM ORIGINAL CRICKET PAVILLION

- This facility is advertised on Heaton Street
- Adds to traffic problems.
- Is being operated illegally with the Councils knowledge

OBJECT TO THE MESS THAT THE CRICKET CLUB LEAVES THE PARK AND THEIR USERS

- beer bottle lids thrown around park after matches
- bottles & litter dropped around the park, overflowing bins and litter around surrounding houses left for neighbours to clean
- apparatus and equipment dumped behind buildings, area that is part of the green-space and raises concern that this area will only be much larger if pavilion is enlarged and pushed out into the green-space

OBJECT TO THE NOISE POLLUTION

- The additional facilities add to the larger numbers of cricket users and the after game celebrations and drinking in this public open park. This evidence has been shown in photos showing the numerous crates of beer bottles behind the temporary cricket buildings.

GROWTH IN LOCAL COMMUNITY

There is continued growth in the local community with infill housing. For well being and mental health, green-space is of absolute importance to this growing community and Elmwood Park plays a very important role, especially for the local community that are in walking/running distance from the park.

The park has been shared by other sports for local community clubs for many years with good balance. Although the local community is growing with infill housing, Elmwood park can not. Amalgamation of clubs on top of the growing infill housing is creating undue pressure on the nature of this precious green-space.

The amalgamation of Old Collegians and High School Old Boys in 2004 has more than doubled the number of people and made the club more of a regional club, rather than a local club. This has added to the growing park user numbers that continue to climb due to infill housing.

This is even more troublesome with the so-called sub-tenants of the Elmwood Bowling Club that entered the area post earthquake. The Elmwood Club moved into the Earthquake ravaged Elmwood Bowling Club building. They even come from out of Christchurch district with associated clubs from Selwyn district such as Lincoln and I believe Prebbleton as well as all over Christchurch.

Elmwood Park can only grow if the council acquires further property. Taking away the green-space from the community to add more buildings and structures only provides for even more overcrowding of this already overcrowded park.

QUESTIONS

	<p>How many of the local park users (ie. that are in walking distance from the park) were notified about the new lease and licence? Were all of the local residence that rely on this park to get their daily exercise in notified? In particular all of the residents that are in a 15 minute walk (in each direction) that would make up the most regular local community users? During the Pandemic Lockdown people were told by the PM to stay at home and stay in your bubble. The local community has therefore has been severely impeded in properly taking this matter on board and discussing the magnitude and impact it will have on the community. Has the council taken this into consideration for a true and balance argument before making a decision that will effect the future generations? How many people were notified that the submission timeframe had been extended to the 18th June 2020? How many of the local park users (ie. that are in walking distance from the park) were notified that the submission timeframe had been extended to the 18th June 2020? How many of the local park users (ie. that are in walking distance from the park) were notified about the previous Cricket Pavilion Application? Ie. Did the Council notify all of these local people? How many people are aware of the bigger impact that this park faces with the current planning of the proposed sports and commercial activities by the people that call themselves the Elmwood Club which includes the newly amalgamated Cricket Club? Can the council please put an immediate stop to the commercial activity going on in Elmwood Park, such as the commercial gym and commercial nature of operations at the Elmwood Bowling Club?</p> <p>CONCLUSION The Cricket Nets and the Pavilion require proper public notification as one application.</p> <p>The application must clearly show the original pre-earthquake facilities in relation to the proposed new facilities, so that is it clear to the councillors and the public what the additional impact is.</p> <p>Notification must be mailed to all local park users that are in walking/running distance to the park – these are the real local community users that were not properly notified of the first lease.</p> <p>The notification period can not be during a period that will impact ability of the local community park users to properly respond. Ie. such that the heavy weight that Covid has had on people’s businesses and lives.</p> <p>REQUEST I wish to speak at the council meeting regarding my submission.I wish to be able to display photos and videos to demonstrate my objections.</p>		
33332	Any expansion to the currently allowed activities in Elmwood Park must be seen in conjunction with the impact they would or could, bring to the immediate neighbourhood, including the adjacent streets and road corridors, plus cycle and walkways.	David	Gower
33298	See full submission below Clarification: I have answered "No" to the above question because I do not support leasing 518 square metres for practice as per the proposal. I am not however opposed to OBCCC having practice nets albeit on an alternative basis which does not dominate the parks Eastern boundary, has significantly less impact on the park, but still provides first class practice net facilities. Refer submission attached.	Bob	Pringle
33289	See submission below	Sue	Cowper
33276		Catherine	Matthews
33266	This park is for public use. The cricket association already dominates the park several evenings of the week during summer.	Wendy	Clarke
33244	I do not object in principle to the nets, but not to the extended area proposed. I wish to be heard at any public meeting.	Gerard	Richardson
33208	The council has allowed and encouraged groups to ruin Christchurchs parks Note the derelict ruin that is Qe11	chris	mcdowell
33206		John	Trott

33205	<p>a. My name is Euan Hilson. I am a retired Accountant, and have lived in the area since 1977.</p> <p>b. This paper "Have Your Say" was NOT delivered to all affected residents.</p> <p>c. The closing date for submissions (7th May 2020) should have been extended because of other priorities resulting from lockdown.</p> <p>d. It is my understanding that Elmwood Park was initially gifted to the City as a "Community" asset - not as a sportsground</p> <p>e. The facility is utilised by a huge number of local families, and this right is being lost to people from all over the city.</p> <p>f. The aerial photos provided in your "Undated" handout are misleading. They do not even remotely portray the obtrusive nature of the proposed additional nets. I spent a good hour plotting where the nets would actually stand, and in my view the use of the park by individuals, like myself, will be compromised for 7 months of each year.</p> <p>g. I only became aware of these proposals after attending a meeting to discuss new facilities wanted by the Bowling Club.</p> <p>h. You own aerial photos also indicate that approval has been granted for a new Clubhouse building which seems to be much larger than the facility it replaces. Was this proposal ever circulated or approved by local residents?</p> <p>i. I oppose any suggestion that allowing these practice nets will not seriously affect nearby residents</p>	Euan	Hilson
33194	<p>To confirm – I do Not support the proposal to lease the requested area of Elmwood Park to the Old Collegians Cricket Club for cricket practice nets.</p> <p>The wording of the ‘Have your say’ page 2, is irrelevant and very misleading “ The land lease is the same size as originally requested – 518sqm” .</p> <p>This does not highlight the fact that the net area requested is considerably larger in area than the existing area. Consequently you are hiding the true facts from the local residents.</p> <p>I have reworded my previous submission as it gives the community board the background to my objection to which I wish to speak. Can you also ensure that this will be sent to all the community board members, as last time it was obvious from the questions asked, that a number of the board had obviously not read the submissions. Could you confirm that the photographs submitted will be available on the large screen when I speak.</p> <p>I have attached two new professionally produced images from the data as specified by the council . This is what was promised by the council at the last hearing. They highlight the size of the proposed net structure, the additional green park space that is lost and the blocking of visual views of trees from every position on the path space (as was the purpose of the path and planting of the trees by head of the botanic gardens from the park’s inception)</p> <p>See additional information below</p>	Frank	Pipe
33192	<p>We are very close to Elmwood Park and are very frequent users. I am deeply concerned about the proposed expansion of the cricket nets and club house. We see the nature of this lovely park which is at present very informal, low key and inviting to all users will be changed and refocused into a very one sporting code place.</p> <p>The very size of this park is not consistent with the idea of accommodating both its present nature and users with the huge expansion of the club rooms and nets. Additional traffic will also result in changing the very quite nature of St Andrews Square.</p> <p>With this proposal, if granted the cricket clubs I’m sure will be sooner or later wanting to get a licence which we would very strongly opposed to as well. We will be very closely watching with interest any future developments. Please keep us informed.</p>	Edward	Christian

33167	<p>Elmwood Park is home to seven sports clubs, however, only one club impacts on the 'Green Space'. The Christchurch City Council has already approved a new cricket pavilion (420 sqm) whose footprint will now impact on the 'Green Space' both visually and physically.</p> <p>The request for 518 sqm (Double their existing net space) is excessive. The combination of both pavilion and proposed nets will dominate the park turning its focus from a community park to a dedicated 'cricket park'.</p> <p>The proposed site for the nets is of concern given the land becomes water logged and floods in winter. An astroturf block will only exacerbate this issue, significant drainage work will be required. The path running parallel to the proposed cricket nets is the main thoroughfare for cyclists and pedestrians and congestion will be an issue.</p> <p>I believe OBCCC expectations are too large for Elmwood Park (District Plan - Listed Heritage Place Heritage Assessment - Statement of Significance Heritage Number 243) and truly wonder what their full agenda is given they are 'members of the Elmwood Club (a completely separate issue)</p> <p>The Christchurch City Council are the guardians of Elmwood Park for all the residents of Christchurch.</p>	Robyn	O'Gorman
33165	<p>I do not support the extension of the Elmwood Park - Old Boys Collegians Cricket Club practice cricket nets (nor the relocation of its proposed rebuilt and extended club pavilion).</p> <p>Elmwood Park is a beautiful park which could be permanently downgraded by the proposed extension of the practice cricket net's concrete pad which will be environmentally and aesthetically polluting. Water from it will flood onto adjoining grass areas and saturate that ground, resulting in muddy, unusable areas.</p> <p>The concrete pad for the practice cricket nets will exclude use of that area permanently for non-cricketers, and reduces the grassed area for general overall enjoyment.</p> <p>Parking in St Andrews Square and other areas surrounding Elmwood Park will be even more difficult than at present. (On numerous times personal visitors have commented that they could not get a car park nearby as there were so many vehicles in the area associated with the cricket club). More facilities will be an excuse for more cricket club members resulting in more traffic movements and parking in the area.</p> <p>The proposed site for the nets beside the only sealed walk/cycleway through the park is daily used by probably hundreds: school children, dog walkers, adults to and from work and for pleasure. At the moment (during L3 Lockdown) the park is used by many family groups who in relaxed ways just enjoy what it offers - a small park made for relaxed recreation. To introduce an industrial sized concrete pad area for a 'select' group erodes that aspect. With cricket dominating on summer Saturdays, and practices through out the week eating into the area available for relaxed/enjoyable recreation the quality of the park for general use is severely lessened. It is no fun and quite unsafe trying to walk through there, (and even the gravel path on the northwestern side) when cricket balls are flying in all directions.</p> <p>The proposed moving of the pavilion to the inside of the perimeter walking path, and the extension of the practice net area will add to the compression of the area available for its three 'match' cricket pitches. As they overlap the outfielders for all pitches, in central positions, are exposed by being back on and unsighted to batting action from adjoining games. This is a really unsafe situation and I wonder how the OBCCC and the City Council can reconcile this to current Health and Safety regulations.</p> <p>I accept that cricket has been played in the park for decades and do not wish for that to cease. However it is a local recreation area with many stakeholders and as such, no one organization should dominate in its use, which is what will happen if this proposed cricket club practice net extension is to go ahead.</p>	Ruth	Hansen

33162	<p>As the most immediate neighbour to Elmwood Park and also relatively recent to the neighbourhood, we were not aware of the potential developments when we purchased our property at [REDACTED]. We also feel the process of public notification has not been open or transparent and was conducted at a time when a lot of people were away - Easter/School holidays 2019. This appears to be a manipulation of the consultation process in favour of the Cricket Club and not the affected community, the rushed meeting in January 2020. still in holiday time, seconds that - repeated strategised movements to engage as few as possible.</p> <p>The Council/Ward has already approved the lease renewal to the Club without very clear building plans and footprint on the space. The new Club is not compatible with the Park's green space and will be imposing in its size and orientation. Therefore, the nets are the last thing we can be heard on and say no to. We were drawn to the area and its park, seeking quiet green space and a neighbourhood environment. We did not imagine or anticipate the changes and scale of the Cricket Club's developments and we feel they are out of scale for the Park and are incompatible with the original heritage purpose of the Park. The scale and ramifications on the Park in terms of dominance of green space, aesthetic changes and changes to how other (non-cricket associated persons) will use the space or have their current use and enjoyment altered is more important than simply placing a large club scale development onto a small green space just because it was there in the past and now has a very large number of members who come from far afield to what was supposed to be a temporary post earthquake solution. This is without considering the implications and downstream effect of noise and light pollution, late night events potential, current site management/rubbish issues, parking and traffic.</p> <p>The time is nigh to take a pause, think of what we have been working toward as a nation these past months and stand up for community, peace and equal opportunity and enjoyment of green space with the intention from which it came, not to be domineered or persuaded by the larger sports entity on the block. I say no to the nets not only because that is all there is left for us to choose now.</p>	Sherwyn	Veldhuizen
33158	<p>We live locally and enjoy using elmwood park regularly. Although we don't mind cricket games being played on Saturday's, we find it intrusive and it is not relaxing to walk and enjoy the park quietly at other times when the nets are in use. If the new nets are installed, they will be used extensively on numerous days each week when cricketers are practicing, the noise of the balls can be alarming, the number of people and cars does not make it a relaxing park for the neighbourhood to use. The local streets are already clogged with parked cars which are parked all day, and we dont need extra congestion from numerous cricketers coming to practice. Elmwood Park is not a large park and there are many other parks in Christchurch which are much larger and are not used nearly as much and with greater parking facilities where the cricket nets could be better placed. Thanks</p>	Deborah	Knudson
33155	<p>Elmwood Park is firstly and foremost a community park that is enjoyed by many adults, young people and children for a variety of recreational and sporting events.</p> <p>While cricket is, and has been for many years, an important activity at Elmwood Park the extent of the proposed practice nets facility would negatively impact both on the appearance and community use of that area of the park.</p> <p>Having played cricket for many years myself and being aware of practice facilities at other parks around Christchurch it becomes obvious that the proposed facility is more aligned to the needs of the provincial level of the game rather than that of a club. As a local resident and having been a cricketer who in the past played on numerous occasions at ElmwoodPark I understand the need to provide a practice facilities. However I strongly believe that the proposed plan provides a facility that is more aligned to scope required at the provincial level, eg. Hagley Oval, rather than is required by a club.</p> <p>Elmwood Park is a community recreational area that should not be dominated to meet the preferred needs of one sporting club.</p>	Russell	Voller
33147	<p>I submit that the plans for the new cricket practice nets proposed for Elmwood Park are not in keeping with the values stated in the Statement of Significance Heritage Item Number 243, in particular, the values of 'Architectural and Aesthetic Significance' and 'Cultural and Spiritual Significance' (https://districtplan.ccc.govt.nz/Images/DistrictPlanImages/Statement%20of%20Significance/Christchurch/HID%20243.pdf).</p> <p>While I enjoy the presence of the cricket club and its players at Elmwood Park in general, I oppose the current plans for the cricket practice nets in terms of the size of the area they would take up and the placement of the nets along a significant portion of the eastern side of the park.</p> <p>I understand the cricket club's desire for improved practice nets and I appreciate that players of all ages enjoy having this facility available at Elmwood Park. However, I do not support the current proposal the club is putting forward. It encroaches too much on the enjoyment of the park's beauty and open spaces by other users.</p> <p>I would welcome a revised proposal that gives greater consideration to the ways the park is enjoyed by other members of the community, and that is more aligned with the values contained in the Statement of Significance Heritage Item Number 243.</p> <p>Architectural and Aesthetic Significance</p> <p>"Elmwood Park has aesthetic significance due to its balance of large mature trees and open expanse of green space. The park was designed to accommodate both</p>	Skye	Rutherford

	<p>active and passive recreation with a large open grassed area and a perimeter walk edged with mature trees including Lime, Elm Ash and many other species.” (page 3 of Statement of Significance Heritage Item Number 243).</p> <p>I submit that the proposed plans for the nets conflict with this heritage assessment as they will not only obscure the views across the park from the eastern side, which are enjoyed by passive users of the park, they will also limit access to the open space of the park from the eastern pathway and limit space for people to sit on this side of the park.</p> <p>Cultural and Spiritual Significance</p> <p>As stated in the ‘Assessment Statement’ (page 4 of Statement of Significance Heritage Item Number 243), “Elmwood Park has cultural significance as it reflects the importance of open public spaces to the people of Christchurch...”.</p> <p>The proposed plans for the area dedicated to the cricket club’s practice nets would interfere with the enjoyment of the eastern side of Elmwood Park as an ‘open public space’ for the many members of the public who use the park for other forms of recreation and as a place for contemplation.</p> <p>The importance of maintaining the character of the eastern side of the park as an ‘open public space’, without further encroachment by built structures such as an extension to the practice nets, is particularly highlighted later in the day, when members of the community enjoy both active and passive recreation (such as walking, playing with their families and sitting on the seats looking towards the west) in this area towards sunset.</p> <p>I acknowledge the longstanding use of Elmwood Park “...for sport and general recreation, including croquet, tennis and cricket...” and that it “...is the home ground for the Old Boys Collegians Cricket Club, one of seven affiliated clubs that use the park...” (page 3 of Statement of Significance Heritage Item Number 243). However, I do not see that this entitles the cricket club to place practice nets that will dominate such a significant area of the eastern boundary of the park and which will obscure the vista across the park for other members of the community. There are other options available to the club (such as a smaller area dedicated to practice nets and / or fully retractable nets) that would enable all members of the community to continue to enjoy the full value of the park.</p> <p>I would like to thank the council for the opportunity to make a submission on this proposal.</p>		
33144	<p>I write to provide feedback comment to the proposal by the Old Boys Collegians Cricket Club to build a new cricket net practice area in Elmwood park.</p> <p>I ask that -</p> <ul style="list-style-type: none"> - to reduce the visual impact that the nets will create that they be fully retractable - to reduce the impact on the " green space " the size be reduced to allow 2 lanes, in keeping with the Club's current use - that appropriate provision be made to ensure adequate drainage to an already flood prone area of the Park - that consideration be given by both the OBCC Club and the Christchurch City Council that the club is out -growing the space available at Elmwood park and an alternative site for ongoing development be appropriately considered. <p>Firstly, I would endorse the concerns raised by others in the local community that all is done to minimise the overall impact on the green space, which is the essence of the park, and reduction in the potential for others to enjoy the use of the park, such that Elmwood Park does not effectively become " a cricket ground." As per District Plan Heritage Assessment 243 " Elmwood park has aesthetic significance for its balance of open green space and large mature trees."</p> <p>I note the large number of people in the local area who have used and enjoyed the park during the national lock-down period. It does seem to me that this is increased and that this would not have happened in the same way with cricket going on (?).</p> <p>I also comment on the process to date which I understand has seen the replacement of the Cricket pavilion be approved with effectively no public discussion, and thereby see the foot print moved with encroachment into the green space. The visual depictions offered of both the pavilion and new nets appear to significantly minimise the actual size. I can understand how the process to date has seen the local community feel disconnected , if not alienated.</p> <p>Two underlying principles forwarded by the Club to justify the proposal so far are the size of the club and public safety.</p>	Paul	O'Gorman

	<p>The original and long standing Elmwood resident Old Collegians Cricket Club has combined with the High School Old Boys Club which was based at Hagley Oval. This merger has seen the size of the club greatly increased with associated increasing demand for facilities. Equally though, this increase sees membership drawn from all over the city, rather than the original local area, and raises the suggestion that the club should be re-located in a larger space to more appropriately accommodate the greater size and numbers of players. And again, the increased size and numbers impacts on the safety questions. The Club is very concerned that the current net designs are not fully enclosed allowing cricket balls to be hit into the park and potentially hit passers- by. But the ground currently tries to accommodate 3 separate games simultaneously which has players from one game standing in (and with backs to) the neighbouring field, which seems much more dangerous.</p> <p>And so, with regards to the current proposal to build new extended practice nets along the northeast boundary, against the path, parallel to the tennis club. I would ask that these structures be as least imposing and intrusive as possible. I note that the suggestion is that the nets be partially retractable but understand that there are options which allow fully retractable nets, which would be much more acceptable in terms of visual impact. Further, the Club currently has exclusive use of two cricket practice nets, with two more open to public use, and so to allow for 2 lanes to be replaced would further reduce the negative impact on the green space as a whole and use an approximately equal footprint rather than double as is proposed.</p> <p>In addition, I am aware that the area proposed along the path is prone to flooding during the winter months and so would ask that appropriate drainage requirements be included in the project proposal so that this problem is not significantly exacerbated. At 518 sq m the foot is the equivalent of a small residential section and should be subject to the same requirements.</p> <p>Finally, I note the OBCCC has recorded its affiliation to the (proposed) Elmwood sports Club facility, a much larger envisioned enterprise drawing membership from all over the city (cf St Nicholas Netball, Shirley Beach Volleyball are listed). Again this suggests an incremental approach toward a much larger final vision, likely to include social and hospitality elements, all of which go a lot further than " replacement practice nets". Hence the growing understanding and concerns from the local community.</p> <p>In Summary,</p> <p>Re Practice nets :</p> <ul style="list-style-type: none"> - to minimise the visual impact these should be fully retractable - to reduce impact on the green space provision be made for 2 lanes rather than 4 - to address local flooding problems already evident drainage capability needs to be included - consideration be given to including the practice nets in the (proposed) indoor facility, along side planned indoor tennis and bowls (addressing both safety and green space concerns in one !) <p>re General :</p> <ul style="list-style-type: none"> - given the size and planned further development of the cricket Club and associated facilities is this the time to consider if there is room and capability to accommodate the expanded club at Elmwood and whether this is the opportunity to look further to the future with options of a larger space to appropriately accommodate the visions of the club supporters from around the city. <p>I am happy to speak to these concerns if that will be helpful. Please advise when the "decision meeting " is to be scheduled.</p>		
33138	<p>I understand that the proposed new pavilion has already been approved. From the drawings above, this proposal gives the Club more building space than now. My submission opposes extra public park space for nets for the following reasons: 1. Cricket days will attract bigger audiences with extra car-parking needed in St Andrews Square, 2. Non-match days will attract cricket players from all over the city, who will come for practice, 3. Bigger audiences and players will need more pavilion space, with attendant noise, and drinking problems, especially Saturdays.</p> <p>The whole "ethos" of the park will be changed from that of "quiet enjoyment" by local residents to a large cricket facility, available to Club members only.</p>	Martin	Griffiths

33135	<p>I do not support the erosion of this park to provide for one entity (the cricket club) above all others.</p> <p>Elmwood Park is of overall significance to the citizens of Christchurch and in particular those who live within the neighbourhood of Elmwood Park.</p> <p>The park has historical and social significance due to its association with the Rhodes family, and its acquisition by the city for use as a suburban park. It was generously bequeathed to the people of the area for use by ALL.</p> <p>Elmwood Park has cultural significance as it reflects the importance of open public spaces to the people of Christchurch. This has been amply demonstrated by the heavy pedestrian use during the month long isolation of local residents.</p> <p>The park also has cultural significance as a site of commemoration.</p> <p>Elmwood Park has aesthetic significance for its balance of open greenspace and large mature trees.</p> <p>Supporting documentation - link below.</p> <p>The council district plan, from which I have quoted above, clearly demonstrates that this park is one of immense significance to the people of Elmwood/Strowan/Merivale. It is currently widely used by many who respect and enjoy the benefits of this park. To disseminate park usage for the benefit of just a few risks alienating the wider public for whom the park was originally gifted to and this act would also be contrary to the findings of the District Plan which outlines the special heritage features of this park.</p> <p>https://districtplan.ccc.govt.nz/Images/DistrictPlanImages/Statement%20of%20Significance/Christchurch/HID%20243.pdf</p>	Julie	Florkowski
33134	<p>OBCC need nets. They should consider a reduction in size as the nets and pavilion are both encroaching further into the park than what currently exists. The OBCC are a very large and expanding club, so the alternatives are fully retractable nets, or looking at working in other grounds for bigger practice facility and keeping Elmwood Park as the main playing field. OBCC need nets, but this proposal is a very minor adjustment from what the CCC rejected in 2019.</p>	Naomi	Soper
33125	<p>Elmwood Park is a lovely small community park, well loved and used by locals. Christ's College is a wealthy school. Old Boys Collegians need to approach College and suggest some school land/property be sold, then come to a mutually acceptable financial arrangement with the school. OBC can then purchase their own land elsewhere to develop their cricket facility. They should not continue to encroach on Council land which, in turn, encroaches on the enjoyment of park users. In addition, the new pavilion is very intrusive, as are the nets, and the parking will become even more of a continued nightmare for residents of St. Andrews Square, who are already coping, weekdays, with a multitude of vehicles driven by St. Andrews College students. I oppose the granting of this lease.</p>	Lee	Townshend
33123	<p>The proposed large expansion of the cricket practice nets area and the relocation of the pavilion to inside the walkway will become a dominant feature of the park, detrimental to the enjoyment of use of local and visiting non-cricket park users. On Saturdays, use of the area is reduced because of cricket matches and the inherent danger from balls passing in every direction</p> <p>More concreted areas of parks are not environmentally friendly and in winter will be an eyesore and in summer with erected nets will be even more of an intrusion.</p> <p>A reason given by the club necessitating these proposals is that they are catering for many players from outside the Strowan area. I believe that is unreasonable as it is the local ratepayers who theoretically finance the facility and should be able to use the park without the fear of being hit by an errant ball</p> <p>I believe the replacement of the clubrooms is a positive move forward for the club. I do wonder though why the rooms need such an increase in floor area, and do not in any way support the proposed repositioning and expansion of the practice nets.</p> <p>Perhaps the club should limit the size of its player intake, redirecting potential members to cricket clubs in the applicants' local areas.</p> <p>Elmwood Park is a local park for local use and should not be overtaken by one organization whose proposals will make it look like an industrial site, which I am sure was not the original intention.</p>	Ray	Hansen

33118	As a small park, which I regularly visit, there is simply insufficient space for an expansion of the cricket net facility. Families must take priority to use the park for recreation and personal exercise. Elmwood Park is a treasured neighbourhood asset and as such must be protected from cricket expansion activity.	Valerie	Sykes
33103	I think the cricket practise nets should be over on the Hagley cricket fields. I think the Elmwood proposals gives the park away visually and socially. The retractable nets dominate the edge. The number of old boys that must use the space to make this investment attractive to the Old Boys club is too many and will overwhelm those of us that use the park that aren't in the Old BOys CLub/	marilyn	wells
33080	The proposal for the Nets goes in tandem with the lease agreement. You cannot separate these. Sadly the lease agreement was given to a new club which was the amalgamation of clubs - therefore not the existing club, allowing a huge upscale not suitable to Elmwood Park. This has caused problems for any further movement mainly due to the scale. Discussion for the practise nets has really been about placement and no compromise on scale. You cannot have a cricket club without nets. I would be happy if the nets were placed behind the club building which would have to be moved slightly forward on the field but instead of having 3 runs allow the nets to have 2. The nets could have permanent structure. I feel this would be a good compromise and means the Clubhouse would not have to be moved further into the park as it would with 3 runs. Just a note how disappointed I am about how this whole process has been handled. An initial lack of understanding from the lease agreement, poor consultation, railroading of the public both by CCC staff and a Cricket Club that is not made up of this community.	Richie	Dudding
33070	The area is too small to support the size and use of a facility of this size. We support total inability all week to park outside our properties due to high use of vehicles by St Andrews College. Other functions at St Andrews take up parking at other times. The park is utilised by dog walkers and pedestrians; and I feel they should have existing space provided without diminishing it. Find a larger suitable park to build your facility. We have no other park in this area; and want to keep this one for our neighbourhood recreation. Picnicers enjoy the space and quiet environment; and this facility will change this space to much.	Miss J I	Jones
33069	1. Why the new building cannot be re-built on the existing foot print? - Is there a neighbour issue here? 2. If building is positioned as suggested this produces too much area for the Club itself, with limited public access in the front. It provides the Club with too much park space. 3. If the building "was" replaced on foot print and existing wickets are retained, plus the additional removable wickets were agreed to, I would support the whole concept. To me this is a "fair" compromise provided the netting for all wickets was maintained to a high standard, and not dilapidated as per now. The mention of safety requirements is due to the poor state of present wickets. Failure to do so would mean no more temporary wickets until all are put back to the required "condition".	A W	Norbert-Munns
33058	Hi, I am a local resident and would like to propose that you take down the complete structure during the winter months when it is not utilised. I use the park twice a day and during the autumn and winter very rarely see anyone using the nets. I do not support the nets being any larger than the existing.	Dale	Savage

32977	<p>1. The state of the existing nets are unsightly, inadequate and completely unsafe. The club has made an attempt to patch existing holes (see attached photos). It appears that these repairs are unprofessional and not done in a timely manner to ensure safety and visual appeal. It is of concern that the club cannot manage and maintain their current assets. We remain unconvinced that other assets would be any better cared for.</p> <p>2. Elmwood Park is a small suburban recreational park, used by many locals and should not be dominated by cricket. The club already has cricket nets, both permanent and mobile. It also commandeers 3 large pitches that are roped or fenced off which restricts public access all year round. It would be a shame to increase their footprint in such a permanent manner.</p> <p>3. No attempt has been made to landscape and soften the look of the proposed new nets. Although they are meant to be retractable, it remains a concern that they will seldom be retracted and thus take up even more of the park area.</p> 	Teresa and Julian	Price
32825	<p>These nets will be more obstructive to the view of the park when people circumnavigate the park. From previous meetings I understand the original concept was to have un-obstructive views of the park. Can we not have the nets in the same location? and the same size? yet upgrade them? I would love to see these upgraded in their same location so club members can enjoy better facilities. The length of these nets, combined with the proposed pavilion (I would like to say I do not like this suggested new location and prefer it in the original position) is halfway down the length of the footpath. This is significantly longer than what is currently present and will pose an eye saw and ruin my current view of the park when I walk, bike, or run around it with my family.</p> <p>I am not against cricket and have played before but why can't it simply be an upgrade of the current structure in the same locations? Can any nets (perhaps one lane wide nets) fit down the eastern alley way heading toward St Andrews Square?</p> <p>I believe the part was not intended to be a home for cricket to dominate and would like the nets (which affect the position of the pavilion, which I also do not agree with the pavilion location) to remain in their current location.</p>	Joseph	Petelo
32727	<p>Elmwood Park is not a park that was built for sporting events and/or sporting facilities. My family and I have been to elmwood park for nice walks for a couple of Years now. Adding this facility would completely ruin the park for my family and I. I personally think that the nets set up currently are enough, and if not, they should find somewhere else more accommodating to their needs. Thank you, and please make sure that this does not happen.</p>	Katie	Taylor
32707	<p>I feel that the Cricket Clubs already are too intrusive. As they continue to expand, traffic will increase and the Park will function less and less like a suburban park. Our street, St Andrews Square becomes clogged with cars jammed together parked on both sides of the road for the day, on cricket days. This restricts residents having visitors. The street is not really designed for two-way car traffic with parking on both sides of the road.</p> <p>The impression I get is that all levels of all cricket within the city are being held here, and everyone comes by private car. Christchurch should be trying to be less of a 'car culture'.</p> <p>Written up to this point is what I wrote in March.</p> <p>*****</p> <p>I'll just add a point today. I have just come inside after walking around the Park. These 'lock-down' days, Elmwood Park has felt much more like a community park.</p>	Lois	Griffiths

	Different ages of walkers, little ones learning to ride wee bicycles, little kids kicking a ball in the center of the Park.		
32706	The existing nets already take up too much of the park when in use as it is difficult to avoid the balls and they need to be given a very wide berth. This park is used by any walkers, dog walkers etc and I feel it will adversely affect the enjoyment of the park by many	Lesley	Airey
32700	<p>I use Elmwood Park every day, either to walk my two dogs, or to go for a run. I spend at least half an hour to an hour a day in the park. Sometimes I walk in the park twice a day. I have done this for many years. It is good for my health and for the health of my dogs.</p> <p>I do not support the proposal because I think the representations of the net proposal minimises how it will impact the park and do not represent accurately how the beauty and use of the park will be adversely affected. I walk past the current nets every day and it is very clear that not only do the nets take up an area which represents their actual footprint, but the area in front of the nets is worn down by an equal footprint where bowlers run up to the nets to make a bowl. This means the proposed nets, which will take up twice the footprint of the existing nets, will actually cause defacing of the grass area of the park over about a quarter of the park. This would be very brutal and would seriously detract from the attractiveness and and serenity of the park. These characteristics are crucial to the value of the park to users who do not use it only for sport, but use it for their wellbeing and happiness. In short, the proposal would still be too dominating and obtrusive to be an acceptable use for the community. The needs of the cricket club should not outweigh the needs of the wider community in this case.</p> <p>Further, when the nets are being used, although they do prevent hard cricket balls from impacting the tennis courts and anyone using the path behind the nets, the batters in the nets hit the balls out of the nets on the other side, making it difficult and dangerous for runners and walkers like myself to actually use and enjoy the park without being in fear of being hit. If the nets are increased, they will increase in use and therefore in the incidence of balls becoming dangerous and unpredictable missiles which inhibit the use that others can make of the park.</p> <p>Finally, the cricket nets are predominantly used by boys and men to play their sport. I would prefer to see the park used for more sport for women and girls if it is to be used for more sport at all, although I have to say I do not support an increased use for sport overall.</p> <p>I am not against cricket, but I do believe the cricket club currently dominates the park to the detriment of other users, and therefore would not support an increase in that activity.</p>	Ursula	Cheer
32688	Not yet. Please show the plan for traffic control & car parking when some game happens. Fore example - car park for 150 - 200 cars around Elmwood Park	Hiroaki	Takei
32664	<p>The Club need to practice mid-week and teams require net use on match day to warm up players. The public (non-Club members) also benefit from using the nets outside of the Club's use. I agree the club require nets, but do not agree with the proposed design, size and location.</p> <p>The Club profess to be one of the largest clubs in New Zealand with a growing membership and home to some of New Zealand's representatives, but the Club's home ground is a small general recreation suburban park. The club require four lanes and are not prepared to compromise on this. The total playable green space is similar in size to the Hagley Oval, but instead of one oval, contains three overlapping ovals. It is already a crowded space for cricketers without accounting for the public users. The purpose of the park is for general recreation and to home a number of sporting clubs. The proposed size and location of the nets cannot be viewed in isolation to the proposed pavilion size and placement. Both encroach further on to that green space and gives the appearance of an exclusive cricket oval. The size and placement of the nets are far too excessive and disproportionate to the balance of green space.</p> <p>Practice and matches do not exclusively occur in netted off areas and so the public will always be exposed to being struck by cricket balls. The public need to exercise caution when cricket is being played just in the same way the club exercises caution around the public.</p> <p>As at today's date, the Club do not have the necessary funding for the pavilion or the nets. What is proposed may not eventuate unless the Club can fund the proposal. The Club may have to compromise on the current proposal if they fall short on fundraising. Either way, whatever proposal ends up being accepted should be conditional on the Club's ability to finance both the construction of the nets and pavilion and for construction to occur simultaneously to minimise disruption to the public users and residents in the area.</p>	Paul	McGarry

	<p>Examples of alternatives are: Radford Ezy net fully retractable system; reducing the number of lanes; forgoing full enclosure; relocatable nets; working in with another club to use its space.</p> <p>[Am I able to add something please? It was just another alternative that I do not think has been investigated. I have cut and pasted the whole extract and made the amendment].</p> <p>The Club need to practice mid-week and teams require net use on match day to warm up players. The public (non-Club members) also benefit from using the nets outside of the Club's use. I agree the club require nets, but do not agree with the proposed design, size and location. The Club profess to be one of the largest clubs in New Zealand with a growing membership who come from all over the city and the Club is home to some of New Zealand's representatives, but the Club's home ground is a small general recreation suburban park. The club require four lanes and are not prepared to compromise on this. The initial proposal was rejected. The only change for the new proposal is to partially retract the nets. The total playable green space is similar in size to the Hagley Oval, but instead of one oval, contains three overlapping ovals. It is already a crowded space for cricketers without accounting for the public users. The purpose of the park is for general recreation and to home a number of sporting clubs. The proposed size and location of the nets cannot be viewed in isolation to the proposed pavilion size and placement. Both encroach further on to that green space and gives the appearance of an exclusive cricket oval. The size and placement of the nets are far too excessive and disproportionate to the balance of green space. Practice and matches do not exclusively occur in netted off areas and so the public will always be exposed to being struck by cricket balls. The public need to exercise caution when cricket is being played just in the same way the club during practice exercise caution around the public users. As at today's date, the Club do not have the necessary funding for the pavilion or the nets. What is proposed may not eventuate unless the Club can fund the proposal. The Club may have to compromise on the current proposal if they fall short on fundraising. Either way, whatever proposal ends up being accepted should be conditional on the Club's ability to finance both the construction of the nets and pavilion and for construction to occur simultaneously to minimise disruption to the public users and residents in the area. Examples of alternatives are: Radford Ezy net fully retractable system which looks tidy and is not intrusive; reducing the number of lanes; forgoing full enclosure and sending balls back into the middle of the park as per the current configuration; keeping Elmwood as the number 1 pitch, but work with another park or club for larger practice facilities.</p>		
32650	<p>We are turning a lovely neighbourhood park and open space into a stadium-like facility that has low usage, among an economically undiverse set of the community and for a limited interest sport. The majestic trees and outlook should not be further downgraded by these structures. Facilities exist for batting elsewhere and can and should be planned for in the new sports complex downtown not in a central neighbourhood park. The Astro Turf pad is not useable but other or multi-use and the nets themselves are an eyesore on the natural outlook. Importantly the size and scale of these nets are unnecessary given the very low utilisation of the current net structure. What is the month by month planned utilisation of the nets? How many children are additionally served by increasing the volume and footprint of these nets. This is an unnecessary overreach by the club.</p>	Bernard	Del Rey

Elmwood Park Submission – Bob Pringle

We have lived in [REDACTED] for 23 years. Our property boundaries the Elmwood Park north boundary fence and is directly in line with the main oval wickets.

We did not object to the OBCCC new pavilion proposal nor do we object to Elmwood Park being the home ground and base for a successful and competitive cricket club. Having lived in close proximity to the main wicket and the existing practice nets/clubrooms for 23 years we are very familiar with noise issues associated with cricket irrespective of whether that noise is generated during senior weekend or week night competition, twilight club practice sessions or junior cricket coaching sessions, all of which are literally over our back fence. The level of noise generated to date from playing or practicing cricket in the park is no more and no less than any reasonable person would expect and we do not find it objectionable. Likewise we have never complained about the peppering our back yard has received from sixes hit from the main pitch over the last 23 years nor have we begrudged helping players find/retrieve balls. In summary we have to date had no axe to grind with OBCCC. More particularly the club has had no axe to grind with us.

I however, along with my extended family (and hundreds of other members of the public) are regular users of this beautiful and unique park. **I am totally opposed to the OBCCC proposal to construct a 37m x 14m (518m²) four lane practice net configuration adjacent to the parks Eastern pathway.**

According to data supplied by Council, the new pavilion, in conjunction with the proposed net configuration will impact 93 metres of the East boundary, compared with the current clubrooms/nets configuration, which impacts only 45 metres of the East boundary.

Additionally, the proposed nets being four lanes wide, will require 5 x 37m lengths of 'view obliterating' rows of netting and is untenable given the unique heritage status of Elmwood Park and is an insult to the hundreds of citizens who use the park.

Background:

OBCCC initially proposed siting fully enclosed nets on the western side of the park, near the Croquet Club. Neighbours, along with the Croquet Club, objected to this proposal. In response to these objections OBCCC, presumably in conjunction with Council staff, proposed moving the 518m² net configuration to the East path boundary.

The club's proposal was then returned to the Community Board meeting on 9 September 2019. The lease was not granted at that time, with Council staff requested to further consult with the Club and the community.

This decision by the Community Board was carried by a vote of 5 – 3 and the board members who voted in favour of this motion are to be congratulated for their foresight in recognising that simply approving moving the 518m² net configuration from one side of the park to another, without further consultation, would not be in the best interests of the park or the large numbers of the public, other than cricketers, who use the park. Particularly when many of the objections raised to

this initial proposal, other than those based on NIMBY reasons, equally applied to the same nets configuration being constructed on the other side of the park i.e. adjacent to the Eastern pathway.

Further Consultation:

At a meeting attended by OBCCC representatives, Council staff and members of the public held at Elmwood Park on 8 January, Steve Wakefield, on behalf of the OBCCC, gave a presentation on other options for nets considered by the club.

Option 6: The club concluded for various reasons, not all convincing, that the position of the new nets needed to remain 'as proposed' adjacent to the Eastern pathway i.e. 4 x 37m x 3.5m netted lanes on Astroturf covering an area of 518m² except that 18m of the 37m length would be permanent with the remaining 19m retractable i.e. removed during the off season (stated as 1 April-31 August).

I disagree with this proposal for the following reasons:

- a) I doubt the nets will be reduced in size from 1 April. This is based on the fact that the existing nets continue to be used throughout April.
- b) The impact of the 37m long 518m configuration for 8 months of the year is untenable.
- c) One assumes, given the Astroturf, that the reduced nets will remain available for use during the winter. Their North-South orientation i.e. running parallel to the Eastern pathway and open ended, will be a greater safety risk than the East-West orientation of the existing nets.
- d) There are alternative options to the OBCCC Option 6 proposal (refer Alternative Proposal below).**

Cricket Club Associated Submissions – Other Christchurch Cricket Clubs

While a number of submissions in support of the initial proposal (Pavilion, net area configuration etc.) are valid, I am somewhat appalled that the cricket clubs proposals give little consideration to aesthetics or the historical, social, cultural and architectural significance of the park.

My summary of the situation is that the club view Elmwood Park being there primarily to provide for their needs, with little consideration given to the views of the wider community.

I would also make the point that the 'Have Your Say' document put out by Council failed to show what actual impact the new pavilion and nets proposal would have on the parks Eastern boundary. Of the people I discussed the proposal with, none were aware of the total impact the nets configuration would have. Consequently there are many people who rely on the Community Boards integrity to look after the park.

In order to understand what is necessary, fair and/or reasonable I have had to carry out significant research. This includes gathering information from Council as well as travelling to numerous other cricket clubs/grounds (none of which are as unique as Elmwood Park) to look at their practice facilities. **I am totally convinced after visiting other cricket grounds in Christchurch (refer Appendix 2) that the Community Board should not approve the OBCCC Option 6 proposal.**

Alternative Proposal

Without wanting to criticise any of the parties involved, the consultation process (post the Community Board meeting of 12 August 2019) has, to a large extent, been about the OBCCC presenting positional variations of the same nets configuration proposal. There has been little opportunity to consider alternatives. There is an alternative however which is documented below that will substantially reduce the impact of the club proposals on Elmwood Parks Eastern boundary and which caters for the OBCCC needs. I firmly believe this is a very fair compromise.

The 'alternative proposal' is explained in the attached drawing (**Appendix 1**) complete with measurements. Although self-explanatory, the main points of the 'alternative proposal' are:

- 1) There would be two 37m x 3.5m 'closed in nets' on Astro turf situated in the North East corner. Note that this area is already taken up by club buildings.
- 2) The proposal involves the new/proposed pavilion being moved approximately 6m further south.
- 3) Two 12m x 3.3m mobile nets on Astro turf south of the pavilion. These nets would be used in situ or moved on to the main cricket wicket for practice as and when required. These nets would be netted on top. At 3.3m wide these nets are designed to fit inside the closed nets during the winter months. Note that the mobile nets are aligned parallel to the south end of the new pavilion so the open end of nets face away from the pavilion as well as the Eastern pathway.
- 4) Neither the fixed nor the mobile nets positioning will impede the view of the main cricket ground from the new pavilion.
- 5) This alternative proposal has less impact on the main ground boundaries than the club proposal.
- 6) Currently the old club rooms and existing nets configuration extends 45 metres south from the north fence boundary and impact only **24%** of the total length of the East boundary.

The OBCCC new pavilion/new nets proposal will extend 93 metres south from the north fence boundary and impact **50%** of the total length of the East boundary.

The 'Alternative' new pavilion/new nets proposal will extend 66 metres south from the north fence boundary and impact **35%** of the total length of the East boundary.

Given this alternative proposal I do not buy into the argument that safety at Elmwood Park during the cricket season or at other times of the year is dependent on the club having a 4 x 37m x 3.5m lane 'closed in nets' configuration spread over 518m². I would further argue given basic common sense and taking into account practice net facilities at other Christchurch clubs (refer Appendix 2), that if the club cannot adequately manage safety associated with two mobile nets (each of which is 12m long and netted top, sides and batting end), it raises the question of safety with respect to there being three separate cricket grounds with overlapping boundaries and pedestrian pathways that are well within striking distance of a good shot from any of the three pitches.

I am available to discuss my ideas with Council staff, OBCCC representatives or any Community Board member should they seek further clarification on my submission.

Finally, I would like to speak at the next Fendalton-Waimairi-Hareward Community Board meeting where the Elmwood Park lease is on the agenda.

Appendix 1

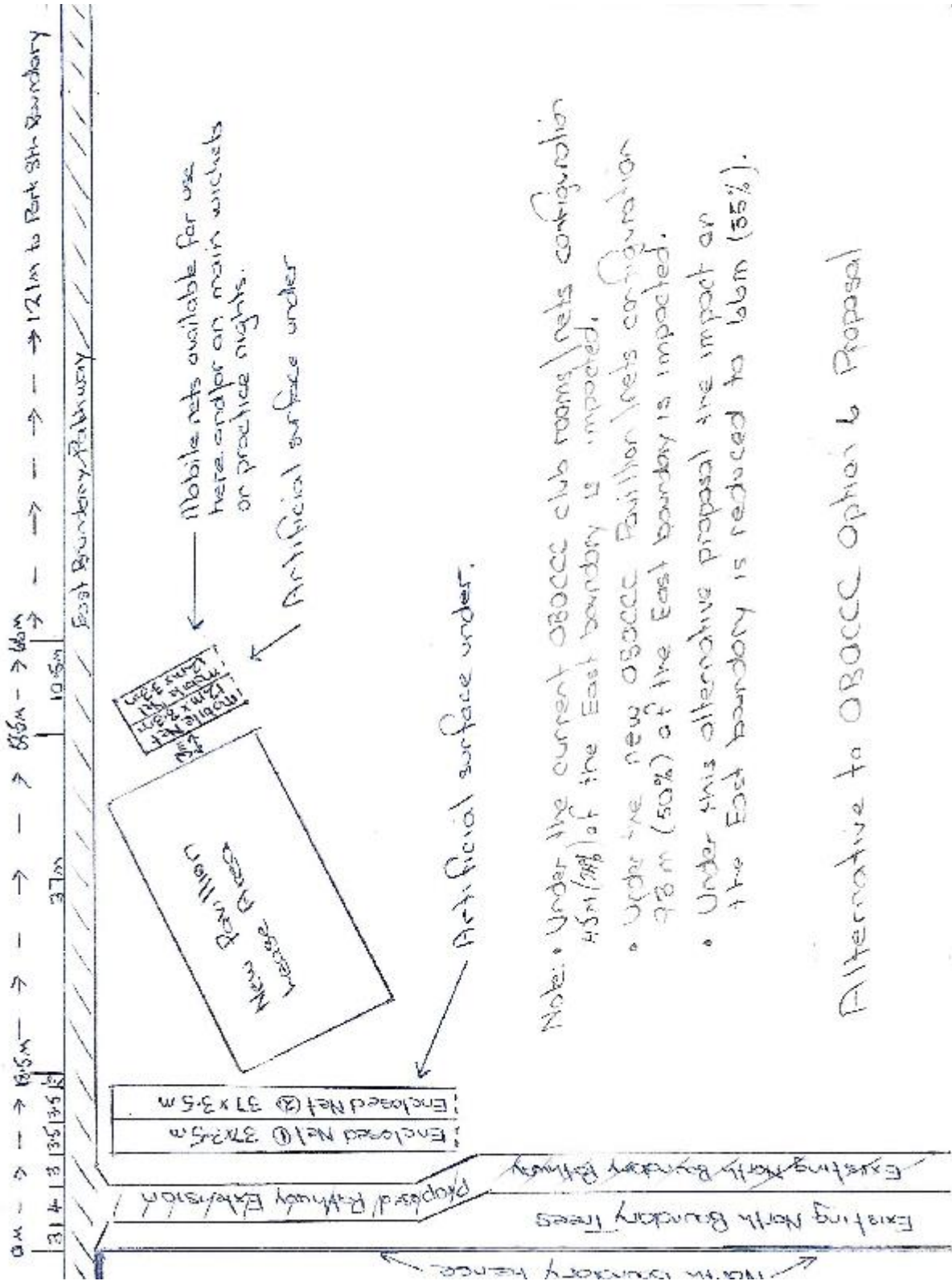

- Note:
- Under the current OBACC club rooms/nets configuration 45% (38%) of the East boundary is impacted.
 - Under the new OBACC Pavilion/nets configuration 98m (50%) of the East boundary is impacted.
 - Under this alternative proposal the impact on the East boundary is reduced to 66m (35%).

Alternative to OBACC Option 6 Proposal

Appendix 2 – Practice Nets – Other Christchurch Cricket Clubs

Edgar McIntosh Park

Merivale Papanui CC



Redwood Park

Marist Harewood CC



Parklands Reserve

Parklands CC



Rawhiti Domain

New Brighton CC



Burwood park

Shirley East Christchurch CC



Heathcote Domain

Heathcote CC



Burnside Park

Burnside West ChCh CC



Hagley Park

Riccarton CC



Upper Riccarton Domain

Riccarton CC



Hagley Park

St Albans CC



Garrick Memorial Park

Lancaster Park CC

The club had their base for the 2019/2020 season at Garrick Park adjacent to the Woolston Club.
Two mobile nets, not photographed.

Beckenham Park

Southern Districts CC

No nets visible.

Submission on net area

Sue Cowper [REDACTED]

I am writing to explain my opposition to the proposal from the cricket club on the following grounds:

1. This proposal involves at its heart a take-over of Elmwood Park by what is at the end of the day a minority group. Call it public interest (local community) versus private interest (cricket club) if you like. Whether the club has 600 members or whatever it is still a private group impacting on a public space. With respect I do wonder if the Council has lost sight of this fact. If granted this proposal will without doubt turn this lovely park into a cricket ground.
2. Mr Wakefield representing the cricket club says we do not recognise the hundreds of families who collectively use the park. We are the hundreds of families who collectively use the park as our local amenity. We don't drive here to use it as most cricket club members do. By the enlarged size of the proposed pavilion, the position of the building encroaching far more into the green central space that is in essence the heart of Elmwood Park, and the sheer size and position of the nets, the park is in essence tipped too much in favour of the club's interests and local families of whom there are hundreds have their interests placed firmly second.

My strong objection is to the sheer size and footprint of their project on the green space which is the park's identity and its reason for being as a suburban park first and foremost, not the project itself.

3. The information put in the public domain by both the Council and cricket club has been misleading and incomplete. The whole process has been difficult for people like me to even get an accurate idea of what the finished sports complex would look like in the flesh. The material on the Council's website is not very clear and gives a misleading idea of the impact of the sports complex in total. I have included visuals I got done to illustrate this fact and you will see what I mean. The current cricket club is shown on the basis of what was consented by Council in the past.

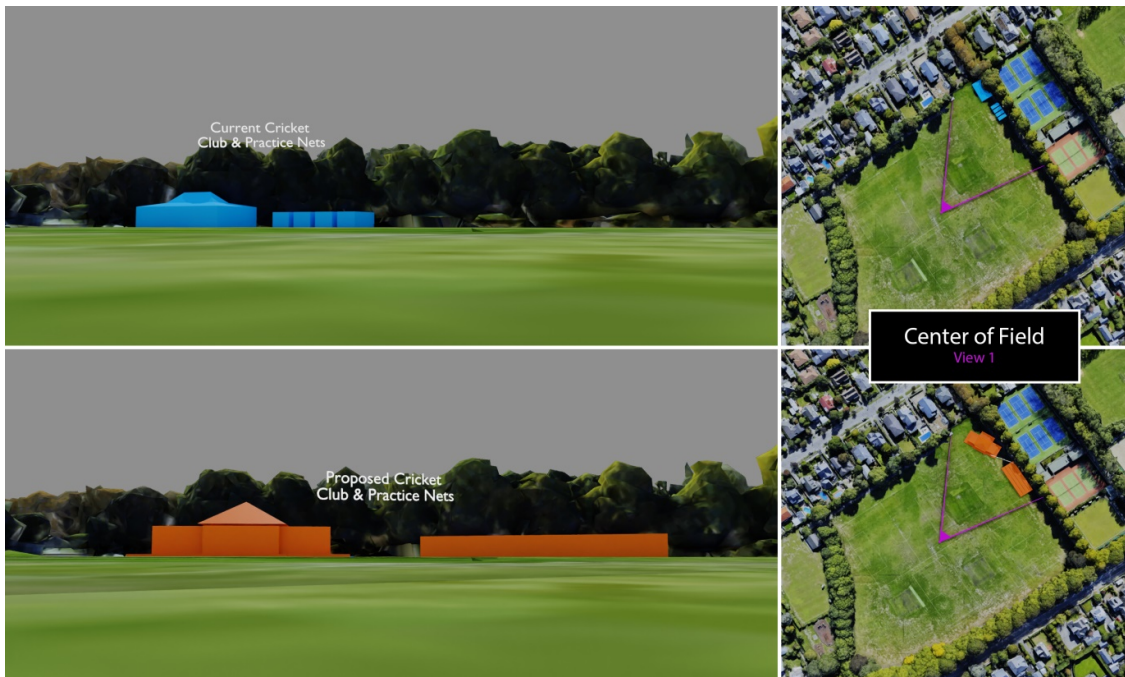



The signs erected at the entrances to the park are similarly misleading and if I didn't know better looking at them I would think the impact of the complex wasn't that great. I have spoken to a number of local residents who formed that view and have not bothered to object. But in reality it is a much bigger footprint on the central green space than what is currently there now. Also the article in The Press of April 14 which I also include yet again misleads the public as to the impact of this proposed complex, in part due to the angle of the shots and the lack of an accurate portrayal of the 3 D proportions of the pavilion and nets as a whole particularly as compared to the present set-up. The whole thing looks slightly ghostly and transparent!



As a neighbour of the park it has been really hard during the Covid crisis to talk effectively with other people in the park's vicinity. Calling a meeting or doing a letter drop etc was not permitted. This has also put us at a disadvantage.

4. I am left with many unanswered questions both about the physical side of the proposal and also what I have heard the Council term the 'functionality' of the cricket club's sports complex.
 - Will the park be more of a cricket academy for the city as a whole and expand even further from its present club base? If not why the need for 4 huge nets?
 - What about mobile nets? How many will be placed at the park and where?
 - What is proposed for the land behind the pavilion? I gather the path is proposed to go there – again reinforcing the dominance of the cricket ground look and feel over the park.

- Where will the club and others store excess gear? Will an extra storage facility like a container be brought in and put somewhere for this?
- What's the back of the pavilion which will be highly visible going to look like exactly?
- How exactly will the club block off access by the public to the large space between the end of the pavilion building and the start of the proposed nets? This will effectively block off the lovely view of the treelines on the other side of the park and prevent access to the public along half that main pathway between St Andrew's Square and Heaton Street.

At no point has the club shown a real willingness to engage with the community on all this, quite the opposite in fact. When Mr Wakefield states in The Press article April 14 that he spoke face to face to 'community members' about his retractable netting proposal and nearly all agreed with it, he needs to appreciate that they are the Council, not the community, which he has not approached at all.

5. We need to look after this treasure and respect its history. This park is for the surrounding community first and foremost as are all suburban parks. The community loves and values it greatly as is apparent by the number of locals using it at any time of the day. It is one of Christchurch's treasures. Does the Council agree with that statement? If it does, please do not allow the club to take over the park with a sporting complex of this size. Again I reiterate it is the sheer size of this sports complex that absolutely steps over the mark.

If the Club wants and needs this sort of complex then Elmwood is not the appropriate park for them size-wise, despite its appeal for other aesthetic reasons. The combining of clubs was their decision to make but having made it, the consequence is they are now too big for this park if this is what they need to operate.

If they absolutely need 4 huge permanent nets with artificial turf then their needs would override too greatly the needs and wants of the community for whom the area was originally formed.

6. I do question why the net area needs to be so vast. That the nets extend about half way down the main entrance pathway between the fence along the back neighbours and Heaton Street entrance and necessitate such a large expanse of astro turf makes this proposal an unreasonable increase on the present net size and that impact is of course exacerbated by the pavilion being pulled out so far from the corner where it is at the moment.

Decrease this impact by less net area, not by nets that will be there for well over half the year in the warmer months and show a real willingness to compromise and decrease the net area all year round permanently.

The temporary net suggestion is simply not workable the way it's proposed. If the temporary net area were to be taken down from April 1 each year how safe will it be for people using the adjacent pathway when balls can easily be hit out onto the path of such users? If the club is concerned about safety what's their view on this?

I personally am yet to be convinced the nets will be altered as suggested anyway given how the club has totally ignored any requests over the years to clean up the eyesore behind the present pavilion building.

I would also like to see a change in the proposed colour of a smaller net area to grey not black so they blend in a bit better with the environment.

Just offering to have ugly removable nets that are there 7 or 8 months of the year leaving possibly large poles, concrete and astro turf is not meeting the community half-way it seems to me.

Finally I would like to thank you most sincerely for your care and attention in reading my submission and especially perusing the photos etc I have attached which reinforce my main argument of this proposal being just too big for this local park.

I would also like to record my wish to speak at any further Council meeting on this issue.

Re: Elmwood Park

– Old Collegians Cricket Club

– New lease/licence for new pavilion and practice nets.

My name is **Frank Pipe** and I raise the following questions and points of concern as owner of [REDACTED] and a user of Elmwood Park for over 30 years. My family and I have belonged to the Elmwood Tennis club and have played sport, walked our dogs and run at this park almost daily. We meet other residents and community members doing the same and have always found it a great social environment.

I note that the Christchurch City Council hold Elmwood Park as a place of **historical and social significance**.

“ ASSESSMENT STATEMENT

Elmwood Park is of overall significance to Christchurch, including Banks Peninsula. The park has historical and social significance due to its association with the **Rhodes family**, its acquisition by the city for use as a suburban park, and its development from a private estate to a public park by James Young, Curator of the Christchurch Botanic Gardens and Superintendent of Reserves.

Elmwood Park has cultural significance as it reflects the importance of open public spaces to the people of Christchurch and the growing recognition of the need for children’s suburban playgrounds. The park also has cultural significance as a site of commemoration.

Elmwood Park has aesthetic significance for its balance of open greenspace and large mature trees.

The park has technological and craftsmanship significance for its ornamental landscape fabric (surviving posts from Victoria Square, the Halswell stone fence and iron gates) which predates the parks development. It also has technological value for the evidence it may contain relating to its arboriculture record. Elmwood Park is of contextual significance as a local landmark on a busy Christchurch residential street, and of archaeological significance because it has the potential to provide archaeological evidence relating to human activity, including that which pre dates-1900.

CCC Heritage File, Elmwood Park “

Question - Have the Heritage team provided a review of the suggested pavilion and nets, with particular reference t the impact on the **“importance of open public spaces to people of Christchurch and the growing recognition of the need for childrens suburban playgrounds.”** ?

Question - Is the pavilion owned and funded by the CHCH council and leased to the cricket Club?

Question - Who is responsible for the facility as the current facilities are often an eyesore and unkempt?

It is accepted that a new pavilion would improve the current situation for the cricket club but this should be balanced with the fact that cricket is a summer sport and the park is for the whole community, not just sports people. It should be an environment that continues to provide the open greenspace and relaxed treed landscape, unencumbered or dominated by buildings and structures.

The New Pavilion - as part of the consent;-

- A complete building – the pavilion should be able to house all the equipment associated with any sports and additional items used ie wicket covers, rollers, waste bins, screens. (No additional Containers parked up alongside.)
- Provide a water fountain for players, park users and dog walkers (as per other parks within ChCh)
- Additional rubbish bins adjacent to the decking / seating area.
- Toilets – which are maintained and open daily to users of the park. (the toilets currently provided by the council are outdated and of average quality)
- Detailed floorplan. No detail layout of the pavilion was presented so it is hard to gauge the room sizes. It is stated that the pavilion is not to provide a large space for social functions but is to meet the requirements for senior cricket competition. This is all too ambiguous and a detailed floor layout should be provided so the community and affected parties can be clear as to proportions and then comment objectively.
- The main hall /room of the current Club rooms is used as a gym which begs the question “why are they after a large room when they never use their existing one”.
- And will the gym cease to operate out of the pavilion. I find it hard to believe that commercial operations are allowed to run in the park. Clarity on this would be appreciated.
- The council have advise that
“The commercial gym is currently operating from the remaining section of the Club’s former pavilion building under a temporary approval under the Canterbury Earthquake (Resource Management Act Permitted Activities) Order 2011 for which there is a final expiry date. “ could you please advise us what that expiry date is?
- Parking - as parking is already an issue on Heaton Street and in the surrounding streets, especially St Andrews square . What traffic assessments have been completed on this new facility?
- Noise- What assessments have been done?
- Practice Nets
I regard the placement of these to be both selfish and atheistically out of place within the greenspace that is Elmwood Park. The net location takes up more space than the pavilion, yet is used for such a limited time.
 - Has there been investigation into seasonal / removable options?
 - Could not two nets be incorporated at the same side as the pavilion . On the fence / north side of the new pavilion.
 - In summer very rarely do you see more than two nets used and in winter are rarely used at all.
 - My research found only four other clubs have permanent nets- all have large sports grounds as opposed to a park.

Moveable Cricket Nets

I have attached a very positive alternative for the proposed fixed cricket nets at Elmwood Park. This option took me less than a day to obtain from a local supplier/manufacturer. (NB - I have no connection with this supplier)

Please review the visuals attached, the pricing and dimensions

This option is;-

- Very cost effect
- Alleviates the need for a permanent structure and concrete base.
- Allows for the nets to be stacked inside each other when not used.
- The nets can easily be deconstructed and stored over the off session (leaving a net out for those who train over winter months)

I would request that there be full disclosure as to reasons why moveable nets are not a suitable solution.

- **Health and Safety issue.** I have reported to the council that one of their staff have given gate key access to members of the Elmwood Croquet Club. They leave these gates open and cars are driven and parked on the grass opposite the Croquet Club. More than once I have had to stop vehicles speeding here when dogs and children are running and playing between the park and children's playground. One time in particular it was inches between a toddler's safety and a terrible accident by an elderly driver. I feel a large structure in that area would further distract and confuse people.

Elmwood Park - the bigger picture - Full Disclosure required

There have been some discussions around a newly formed group called **The Elmwood Club**. The name appeared on the park hoardings around 2015 and we were told by the council that it represented a number of clubs that had lost their facilities due to the earthquake. One could then rightly assume that once life in Christchurch returns to some form of normality that they too would return to their former communities. But this now does not seem to be their intention at all. It would appear that they wish now to take over our community park and erect a mini Cowles stadium.

In April 2015, the board offered full disclosure of the Elmwood Club and its plans. The Old Collegians discussion should not be done in isolation as it is the collective changes that will scare our park if not done correctly.

What is the link to this current application?

OBC state on their website that they are proud members of The Elmwood Club. And on further investigation you would find that 4 of the 6 Elmwood club board members have been prominent members of the OBC - past president and board members.

Why are the public not being told the true picture, full disclosure is what I am expecting from the Council. Gather all the facts and advise those who elected you.

With all the cards on the table the local community, who are the people directly affected can make fact based decisions .

The Vision – as stated by The Elmwood Club (TEC) is to build a facility on Christchurch City Council leased land and Ministry of Education Land. A partnership between school and community.

Problem

- There is no parking , Traffic in Heaton Street and surrounding streets are to capacity already
- Who would fund such a project? The Council or the groups themselves? Talk is around \$6M.
- Why is the club trying to draw residents from all over Christchurch to an already over used park with no excess space. If they are truly passionate sports people then great go ahead and talk to the council about all the spare land around Dallington , QEII, or Kerrs Reach, Avonside.
- Members of the Elmwood Club - come on !!! Affiliated groups out of zone and nothing to do with our community.
 - Lincoln University Sport and Shirley Volleyball , St Nicholas Netball as a member of our local community is a long bow to draw. I am sure that many groups across Christchurch have residents living in Merivale - that doesn't give them a right to include for instance surf clubs, equestrian groups etc to align themselves to an Elmwood Club.
 - We have NO Netball Courts or hockey fields.

In summary

I feel that **the proposal was lacking background, context and detail.** I have tried to provide this with the above summation but must insist that the community board (especially the new board members) are given all the facts before they make a decision that will change the face of this piece of Christchurch culture and history.

The timing of the submission around the school holidays was always a problem. Which combined with the Covid-19 Level 4 and 3 restrictions has made it impossible for the community to fairly assess and communicate on this matter. We are not able to gather and discuss the options as a community nor are we able to distribute leaflets around the area.

There are too many unanswered questions and a need for;

- A complete traffic and parking assessment given the amalgamation of the two clubs and their boasts as the largest Cricket Club in the South Island.
- A noise assessment and plan to give surety to local residents that the Club will not turn into a function centre.
- Full disclosure of the plans for The Elmwood Club. What is the need for this when the Cricket and croquet already have club rooms.

If you are able to provide some answers to these points I would be most grateful. These are decisions that affect not only the community now, but generations to come.

We should protect this greenspace heritage for a further 100 years.

Thank you for your time

Frank Pipe

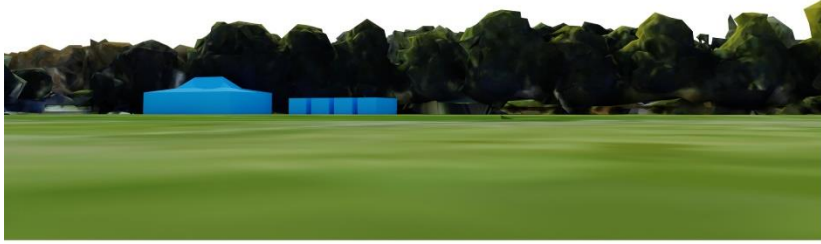

Center of Feild
View 1

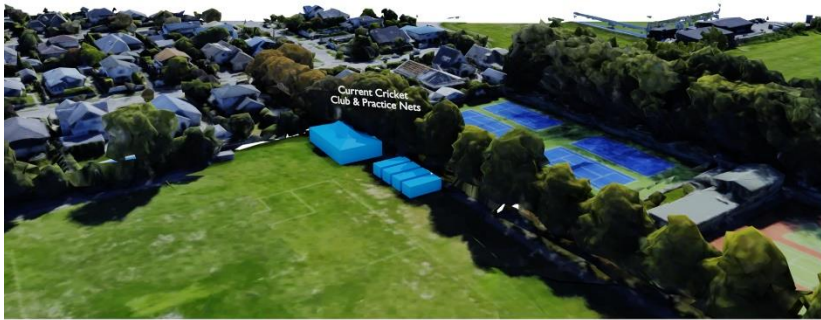

Sky View
View 2

