

~~Handwritten scribbles and text, possibly "with a po"~~



I want a sushi shop



Robbie



Ollie Vosper

SUSHI BAR



This is a cafe

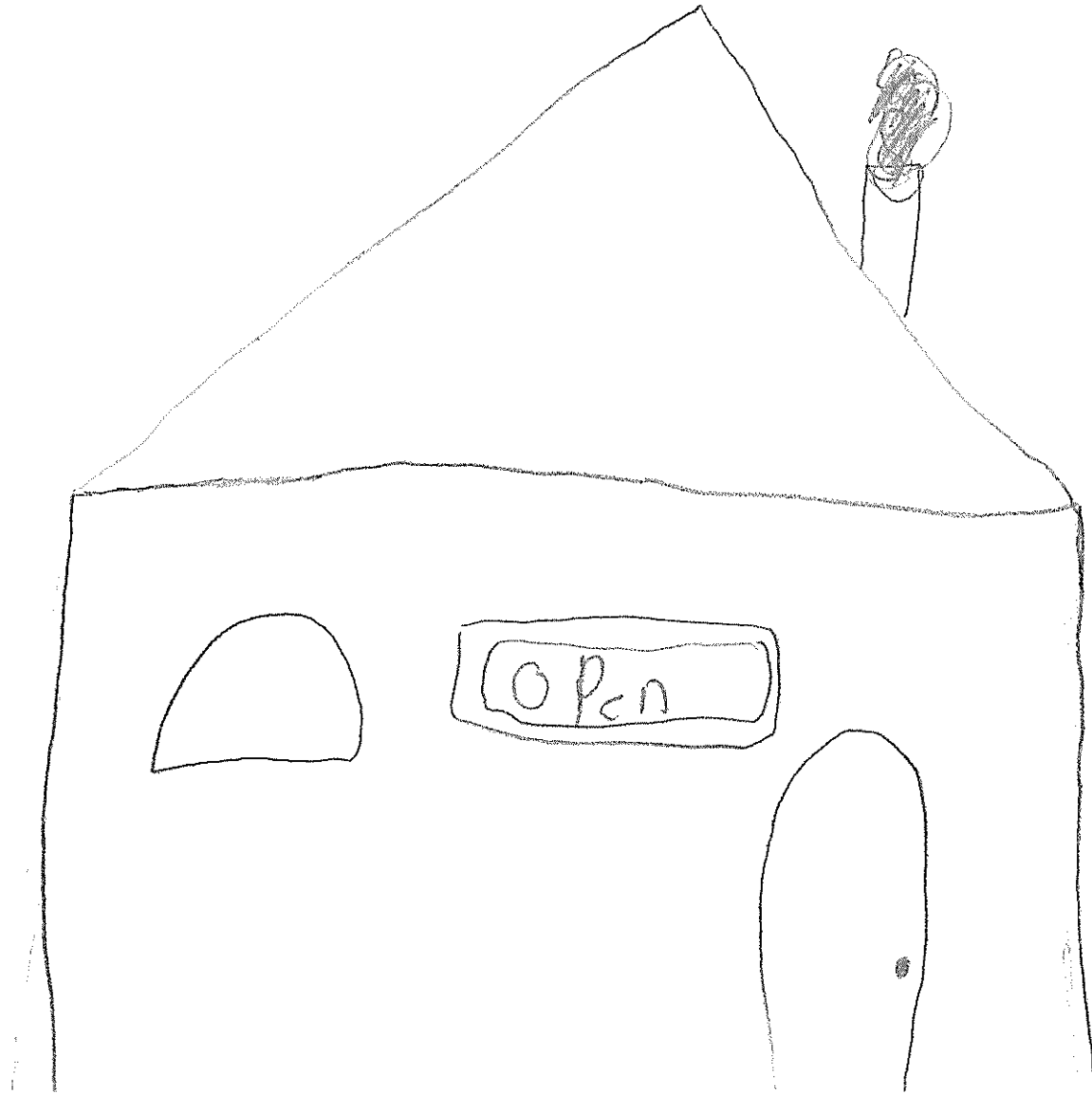

Playground

and

Pool

and

a

~~hotellie~~

• and

at

a

Saber

like

maker

and

I

Sosn der



I would like to have a park that is very, very wide and tall and a pool that's next to it with an animal park.

Nirvana

Pools

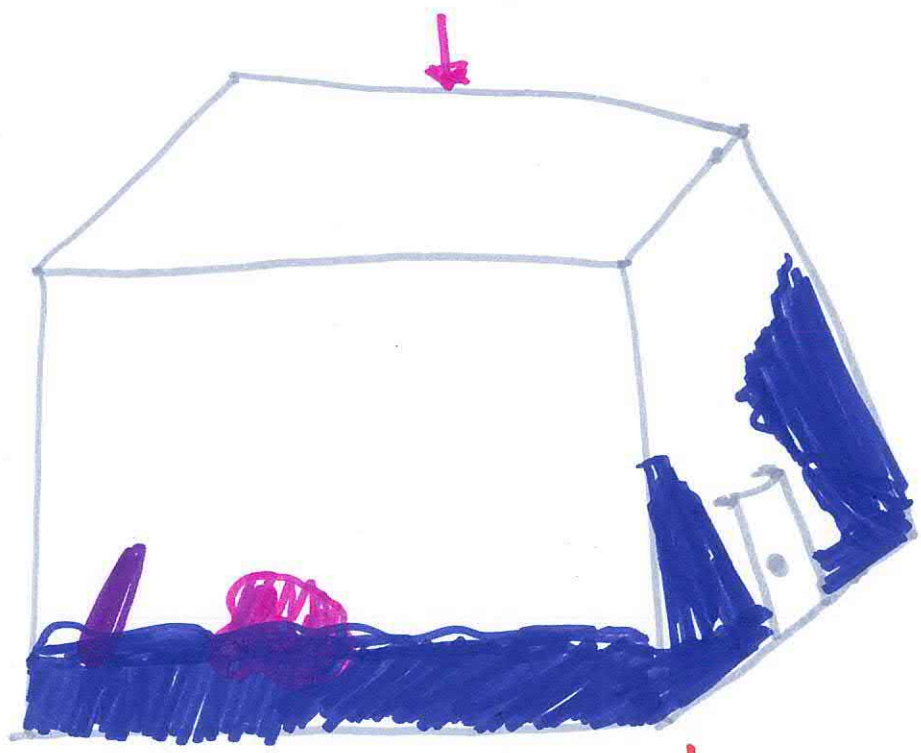

animal park

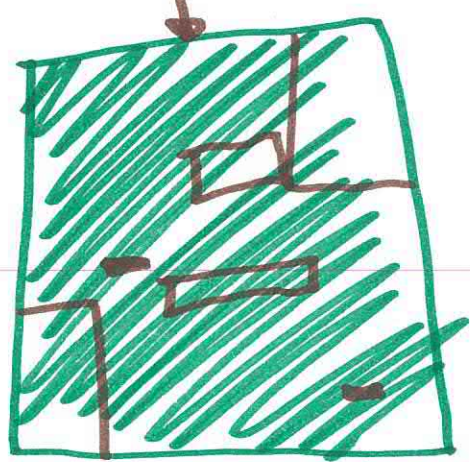

Park

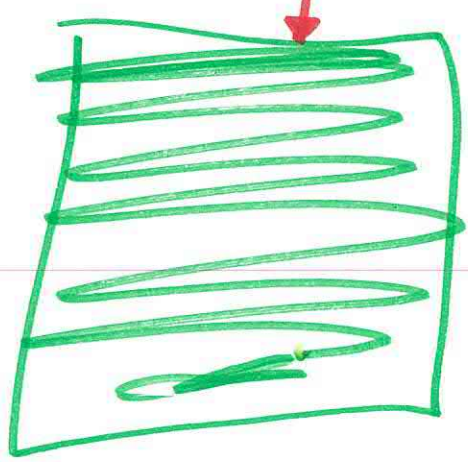

Skate Park

a

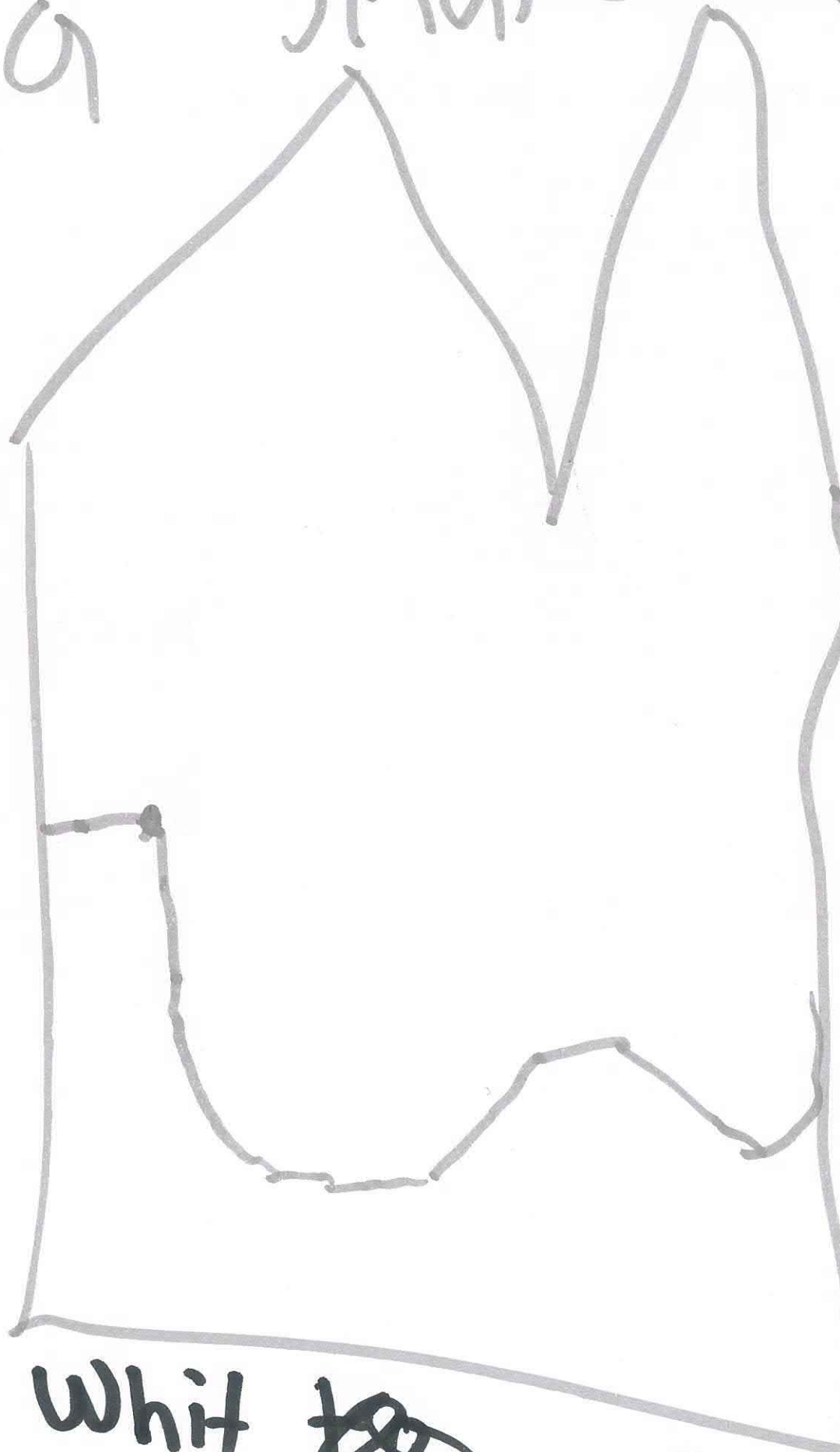

Ollie White

Whit

a cafe

for

Bmx

Skate

and

~~Scout~~

100

Whit to

Scoote

The Playhouse
0-70
Preserved
Car Park

Dark Stars 

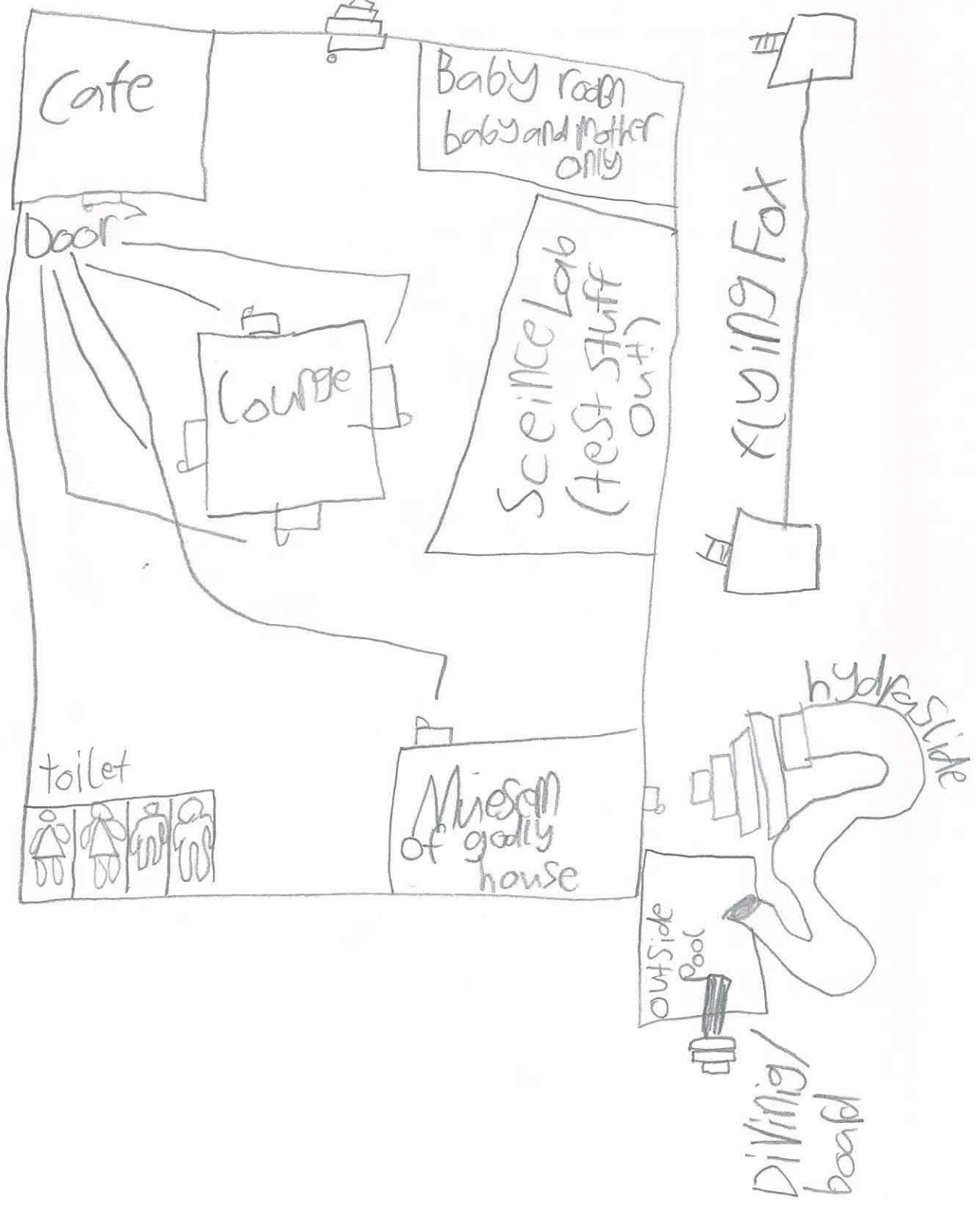

by Josh

Felt still
science lab and
cafe

10-80
years old

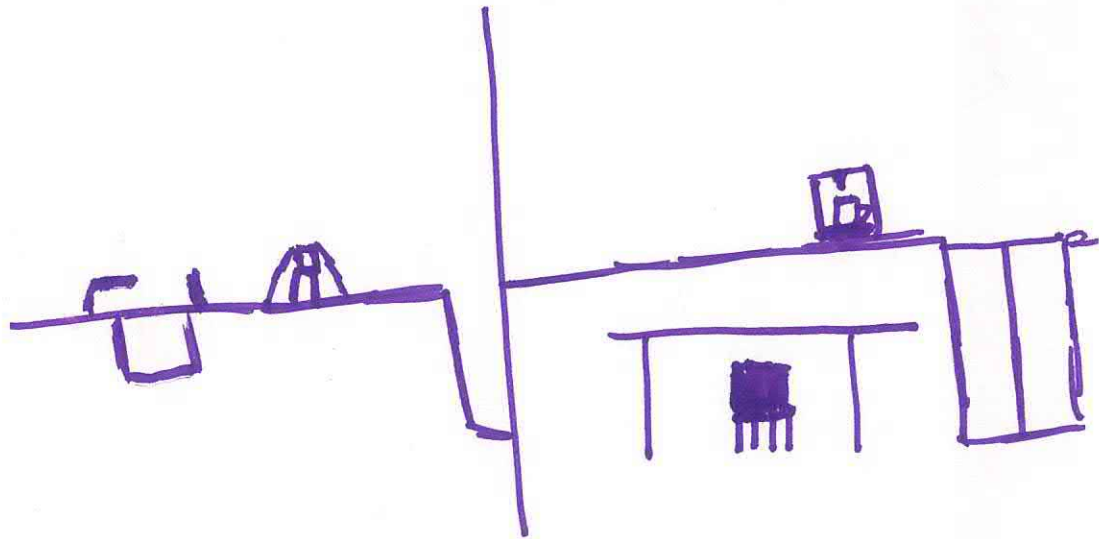

Playground ~~and pool~~

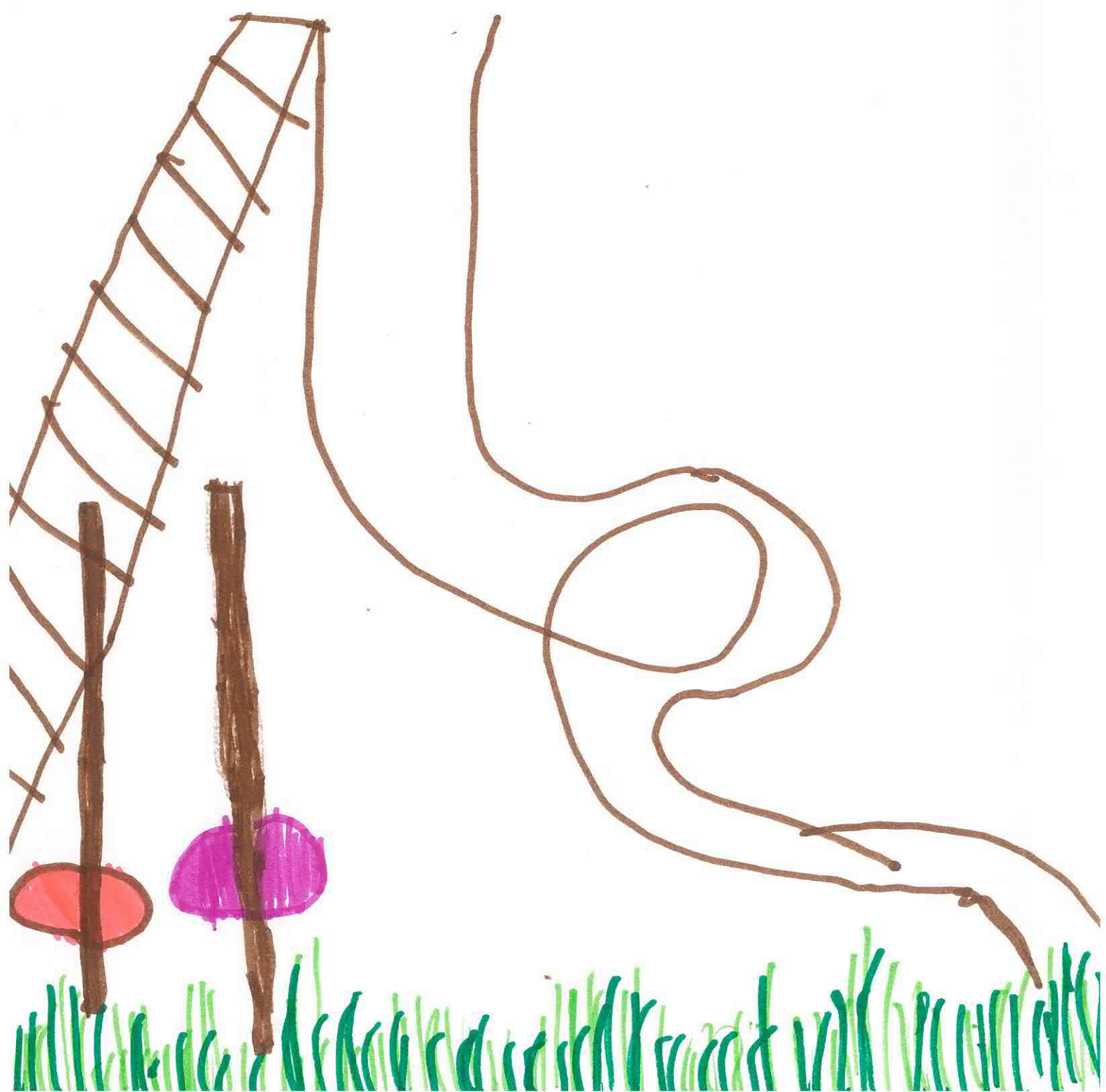



Restront on hotele and a cinerma
and higroslides!



fran Jamie

Tayla Leech ☺

Library 

Small diamond harbour

History museum 

Native park 

Pool + hydroslide
garden

cafe

Vr

Toilet

park

myseum

LUKE

Sweeney

Christchurch
City Council



LEA GILMORE

Library 

resteraunt 

Small native

bakery 

Small diamond
harbour history
museum 

park 

replica of godley
house turned into
a cafe 

BETHany Davis

Cafe 
modern

Library 

bakery

park 

a small history museum 

Restaurant 

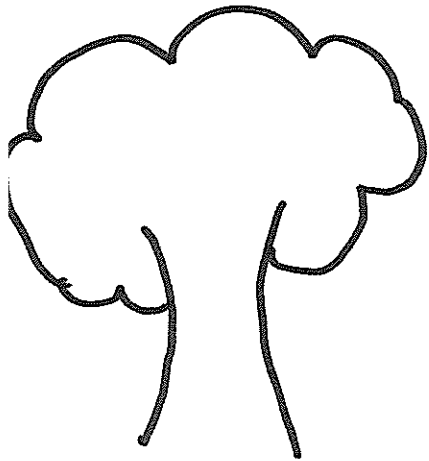

Hotel JACKANORY

restaurant
meeting room
pool
gardens



shad



slid

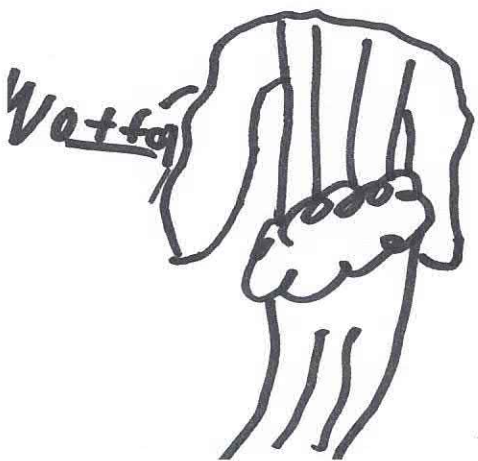

Water

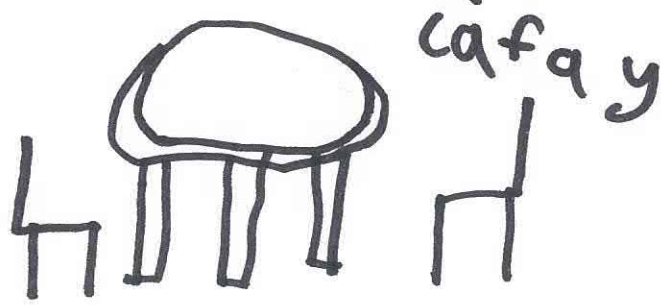

cafa y



giftshop
gallery
little history
cafe
library

Park

restaurant
library
cafe
historical museum
native park
godley house
library
pub

A tree hit
made out
of natural
material
godley
tree

(Afe)

WOTS Sls Pale With a catin of it

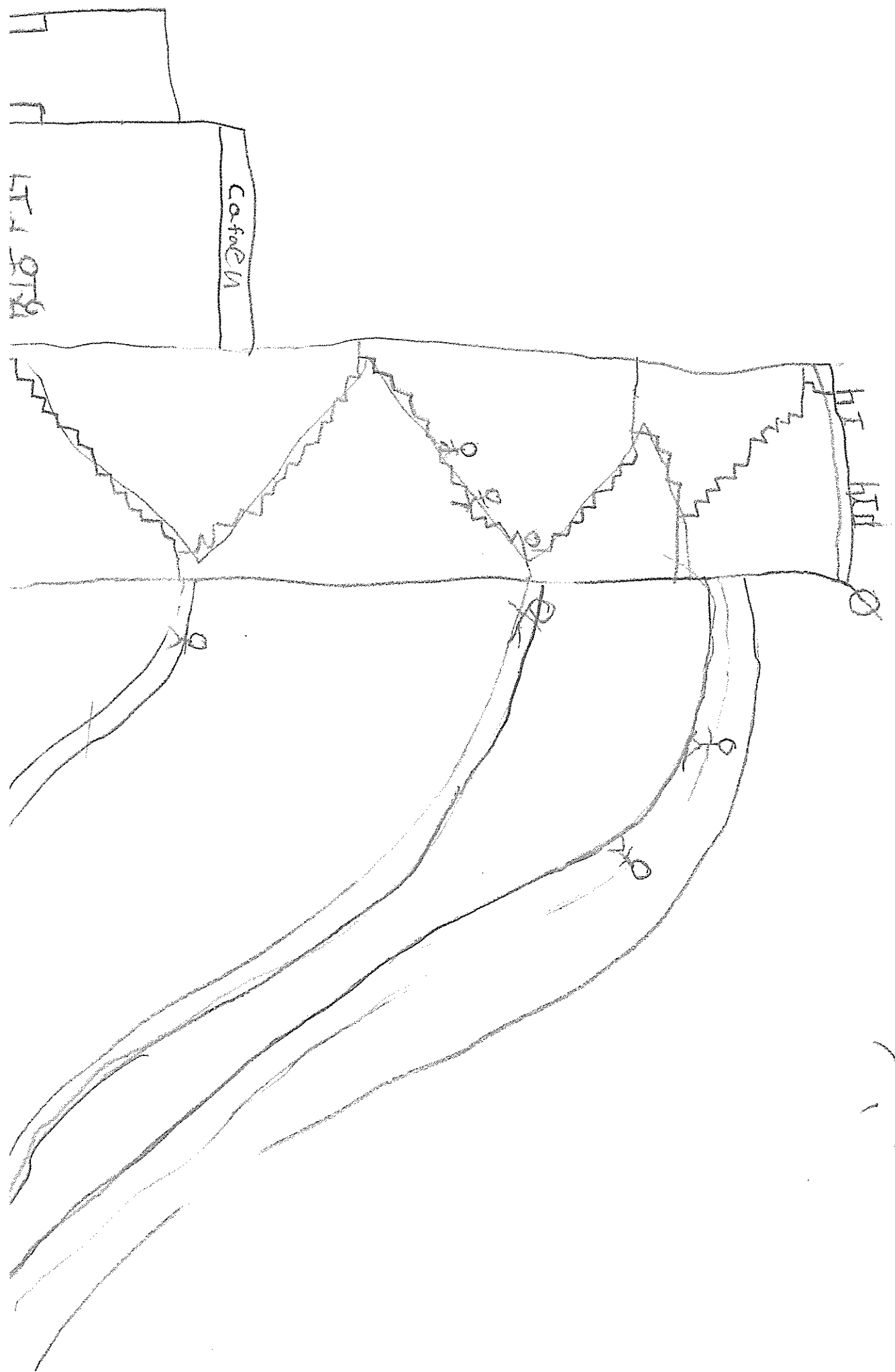
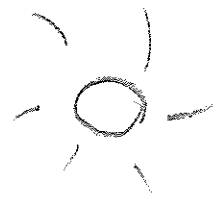

History Small Museum

Shows history of DIMOND harbour such as:
(storr cottage and old Godley + Addley Point.)
GODELY HOUSE

First Settlers

Old Pictures

Olden days

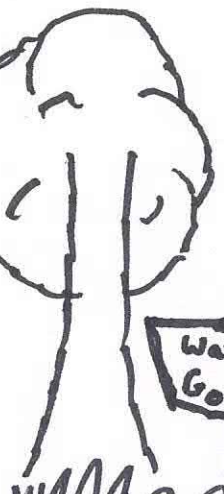

Was here:
Godley house



Was here:
Godley house

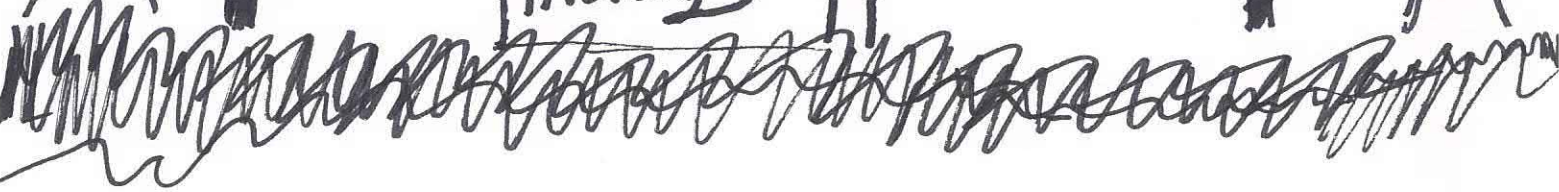
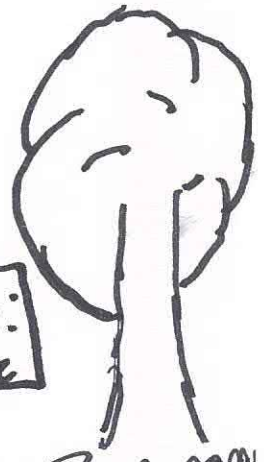

the library will have long open hours
and it will be very local. There
would be lots of facts picture
on the wall of Godley house and
a sculpture of Godley and a fountain.

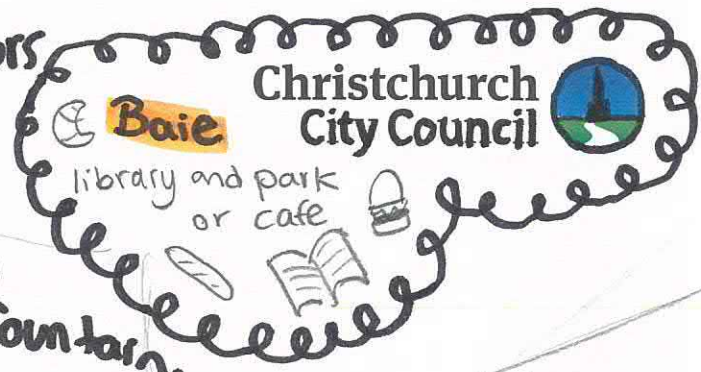

Library

local
information
board

Native bush + bird feeders
made by school
kids

Godley house
was here

Godley

library

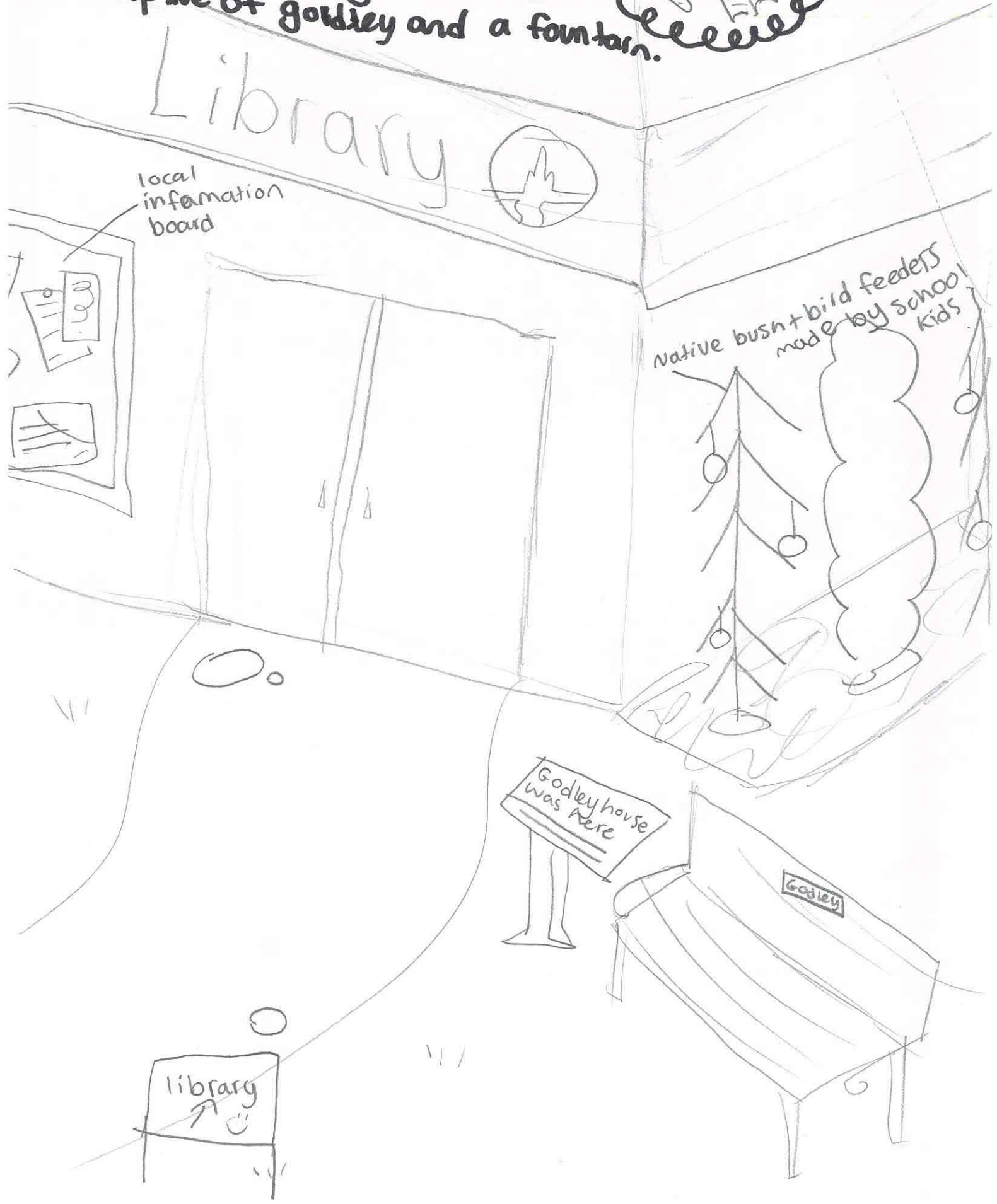

Bebe Cotter
~~not a~~ vestront
notal higslig
Pool

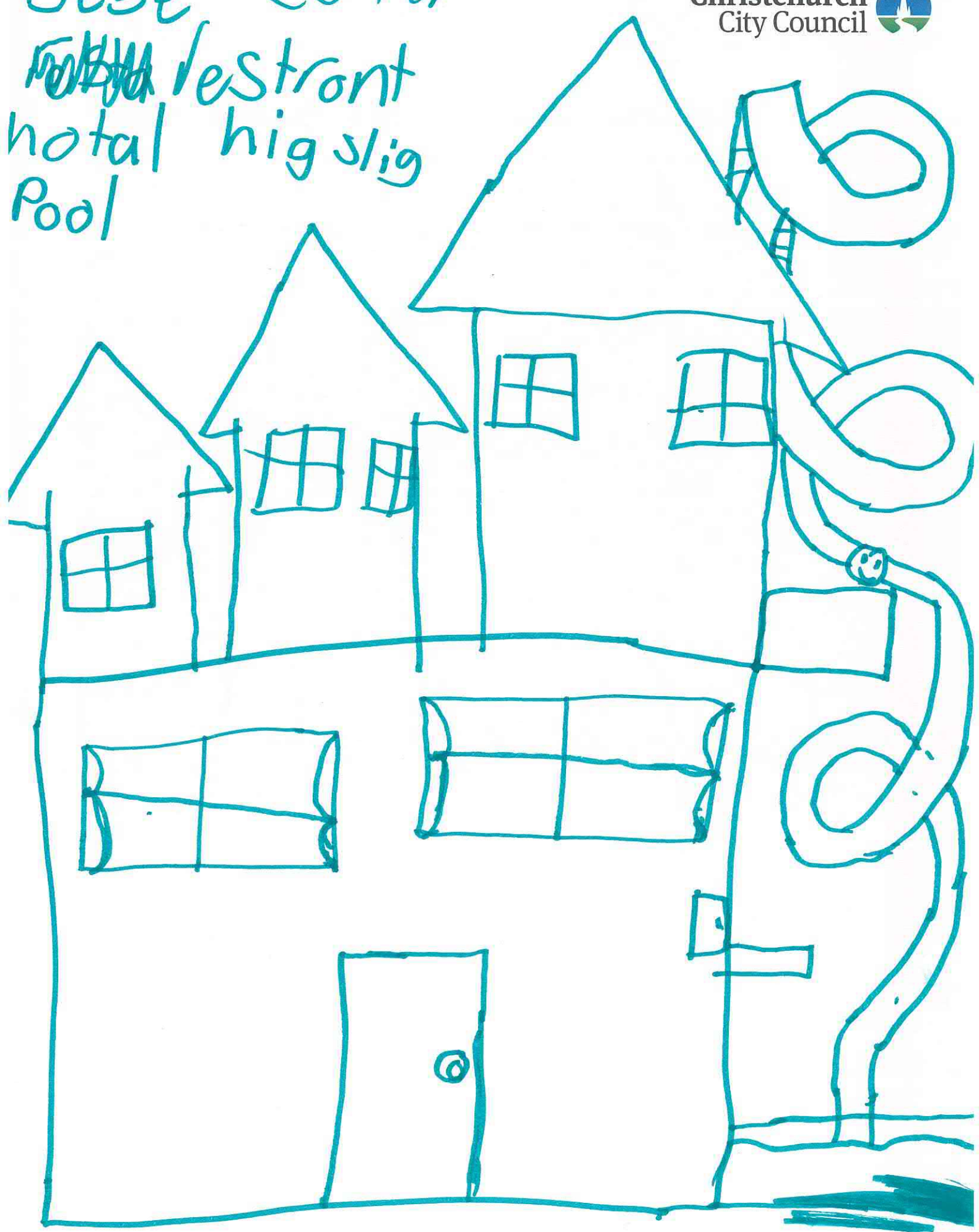

Library!!!
↓



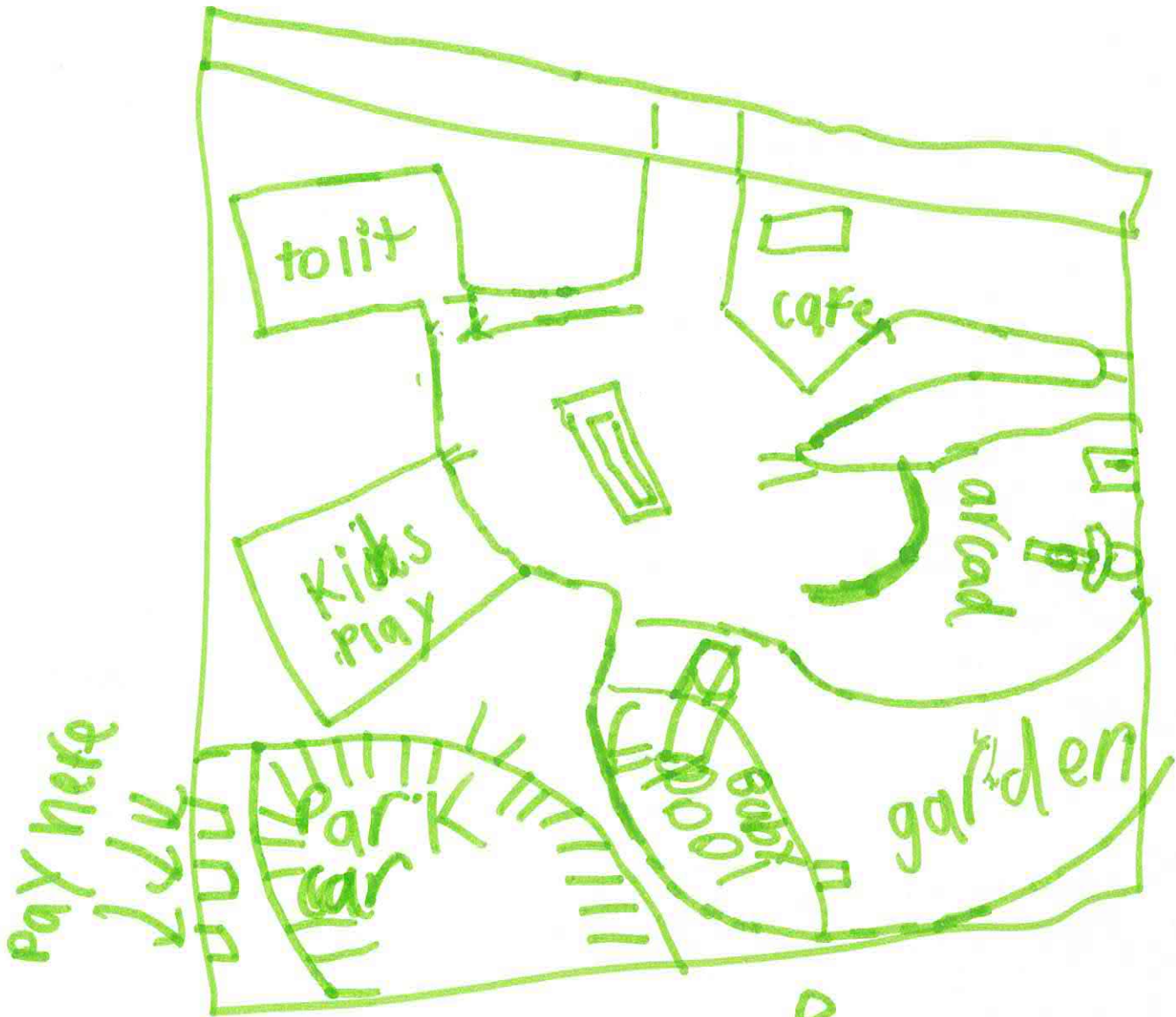

By James

I want a pool and a park.

Pippa



I would like ~~xx~~ godley have
back but with a room full
Of animals and a science lab.

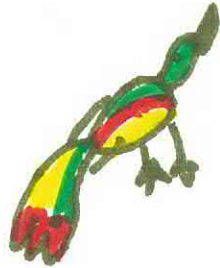

To 6

bar
↓

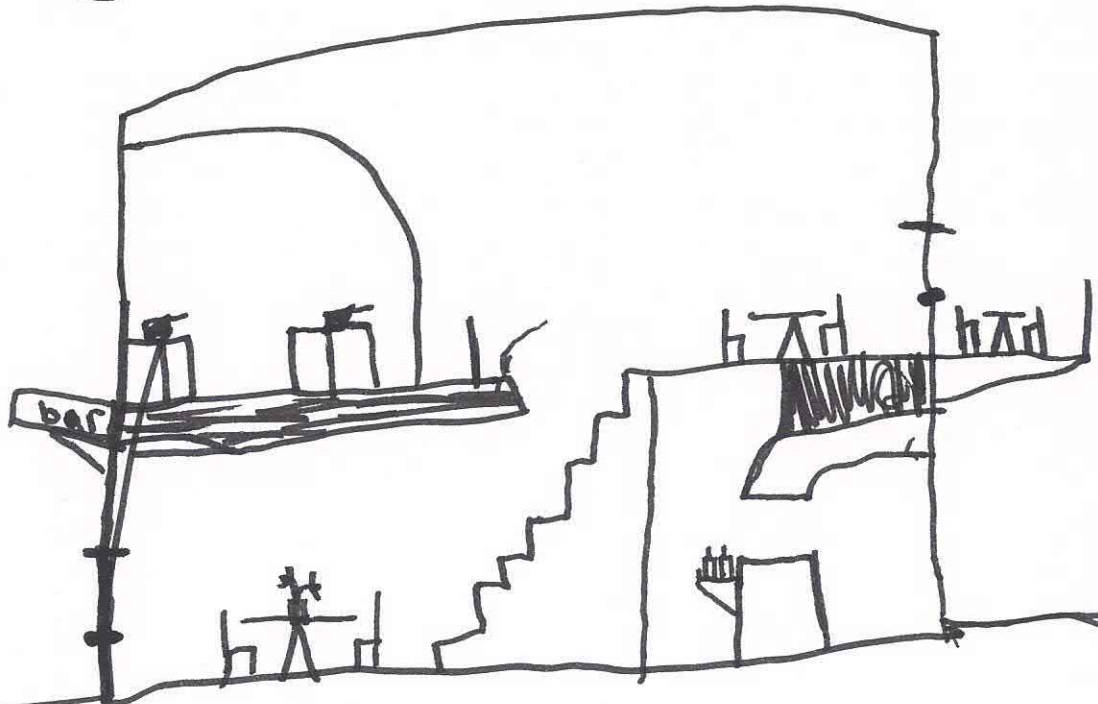

Science lab for kids

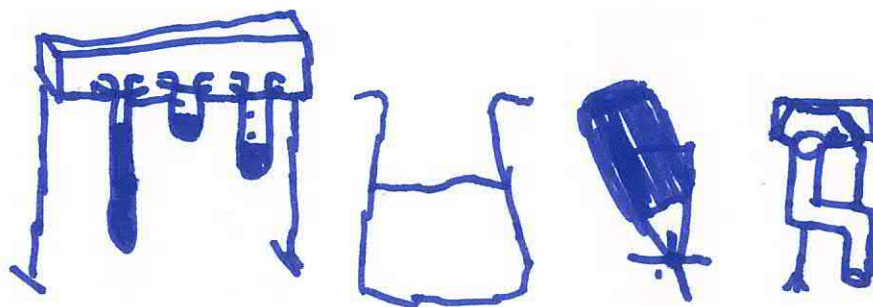

Swimming
Pool

Benjamin

heightometer



Jack Powell

1. ten rooms of legs
2. toilets.
3. catfa
4. restant.
5. Kittys cat room

Godley house



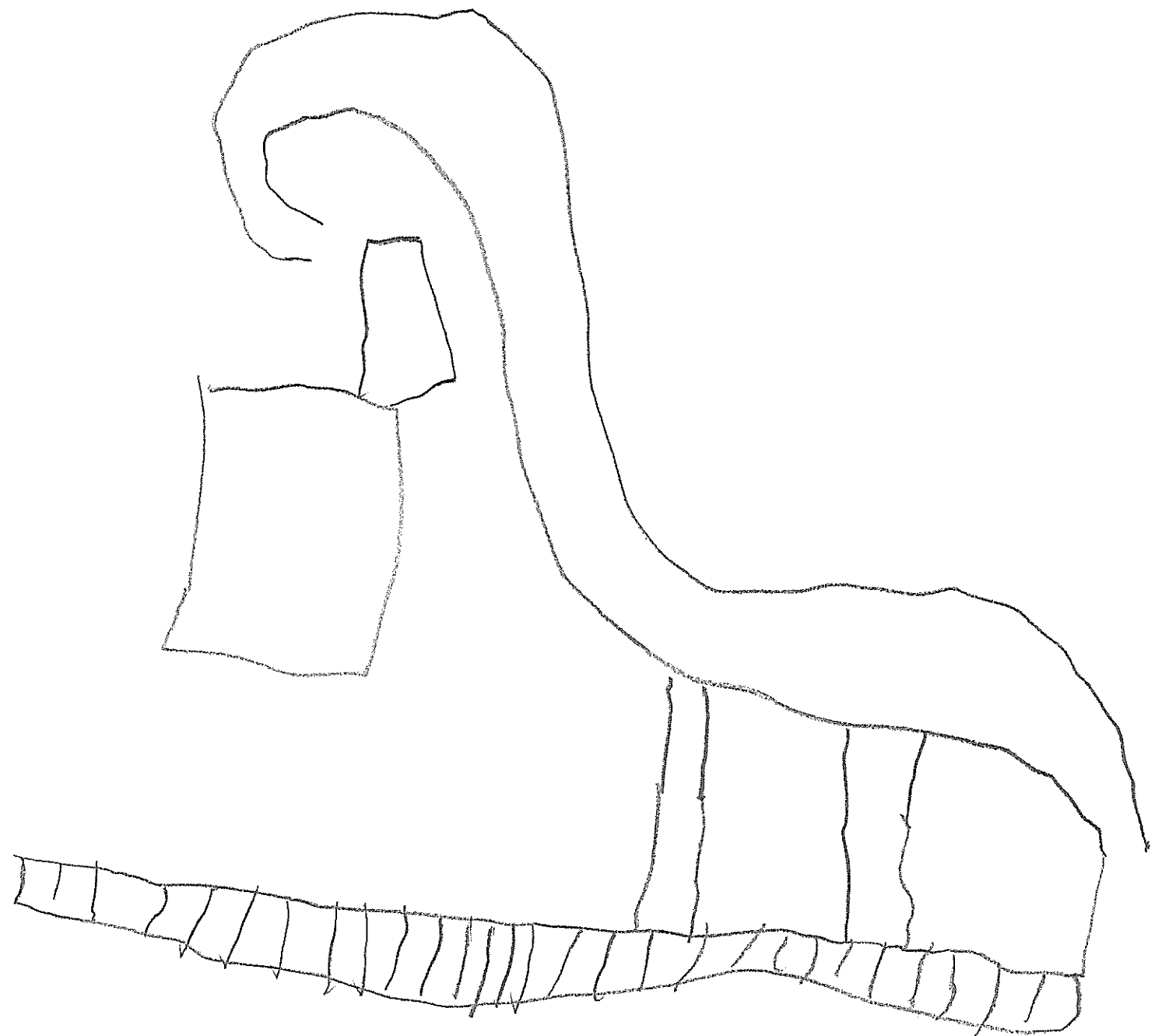

Water slide

Sam Cotton





James

Pool



Jimmy

~~Pre his~~ prehistoric history ^{Lab} ~~and~~ and
science lab for kids and ^{archeology} ~~and~~

Rory

Cafe!

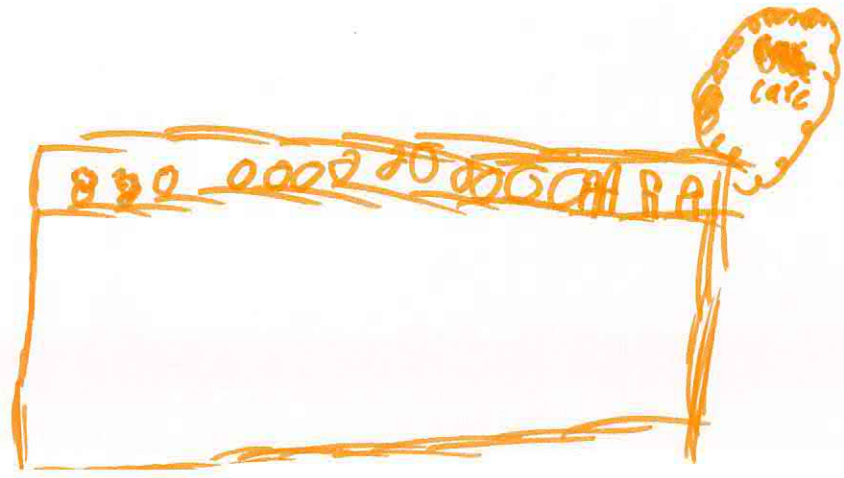

Emma

I would like godley house back ~~to~~ but
Inside the house I would like
a Science lab

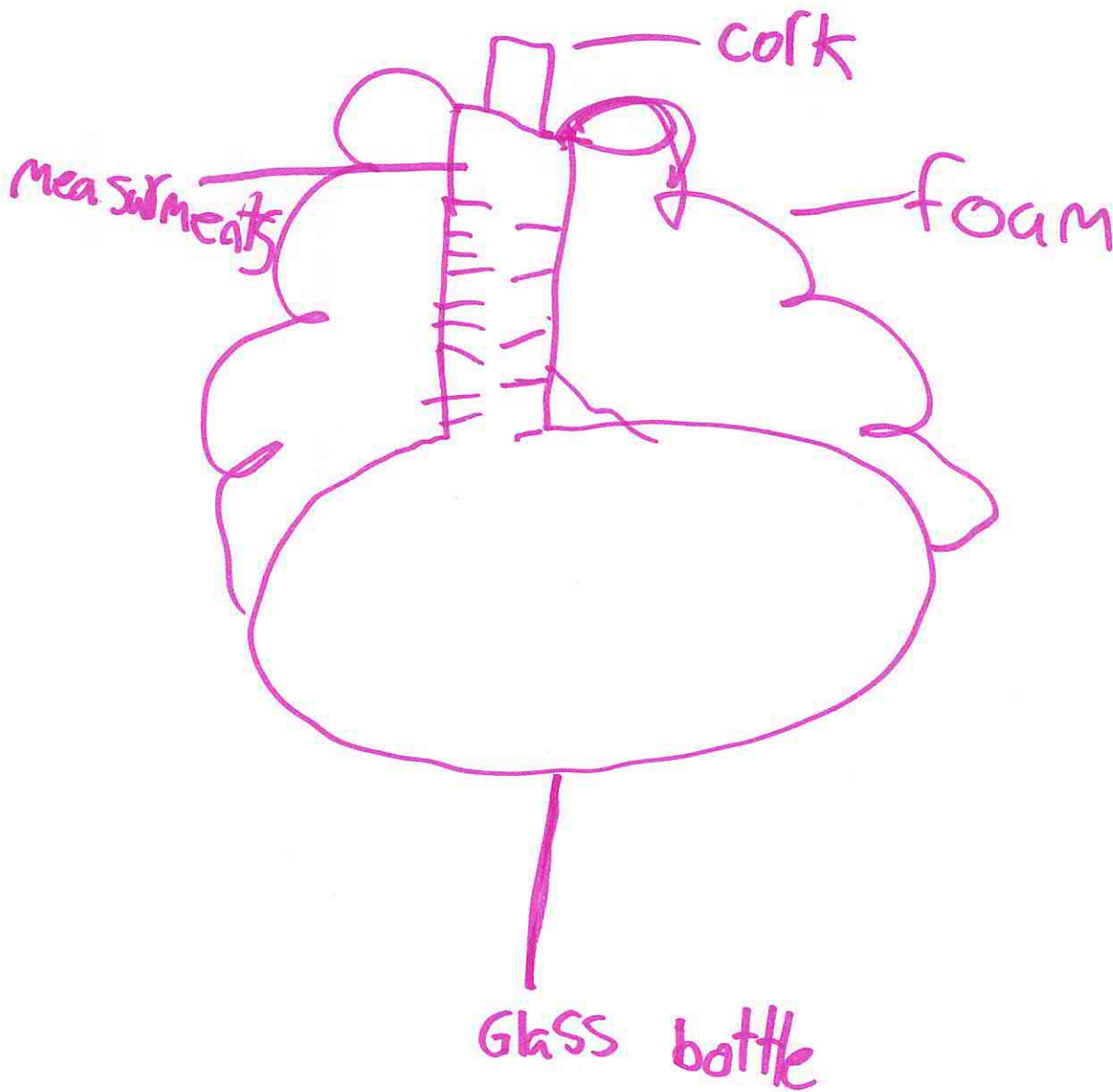



Christchurch
City Council

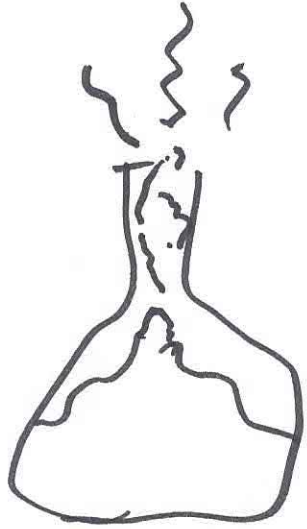

Science Lab

S

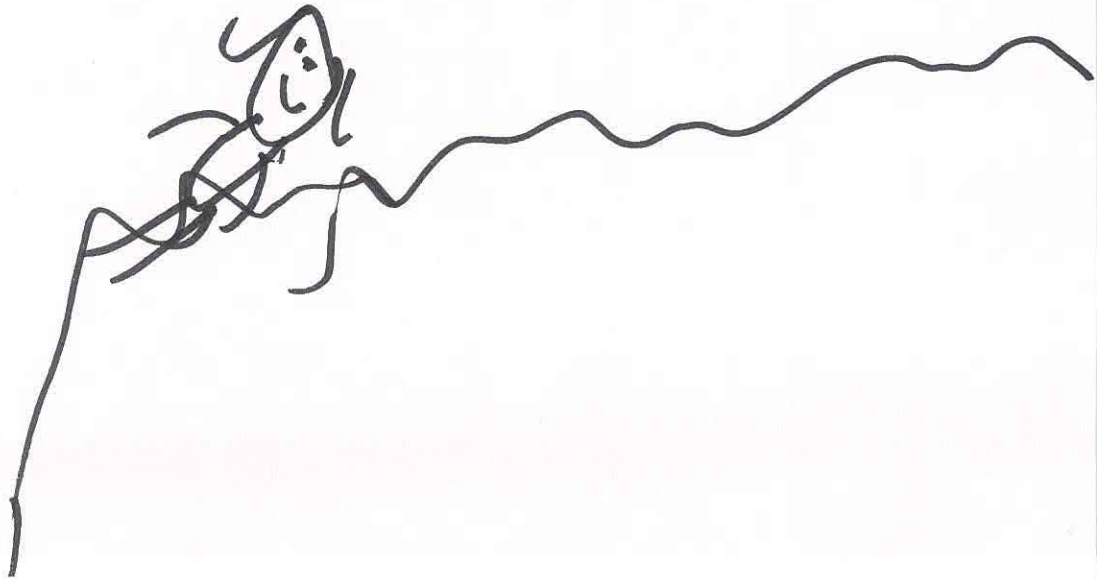

want
I ~~was~~ a cafe



Nate

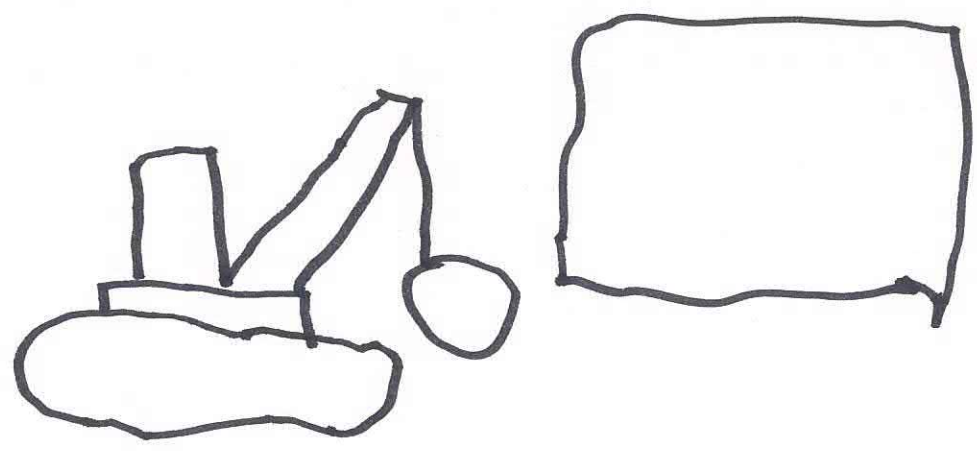

Johnny

A (afay
A toilet
A pool
A (SASH))

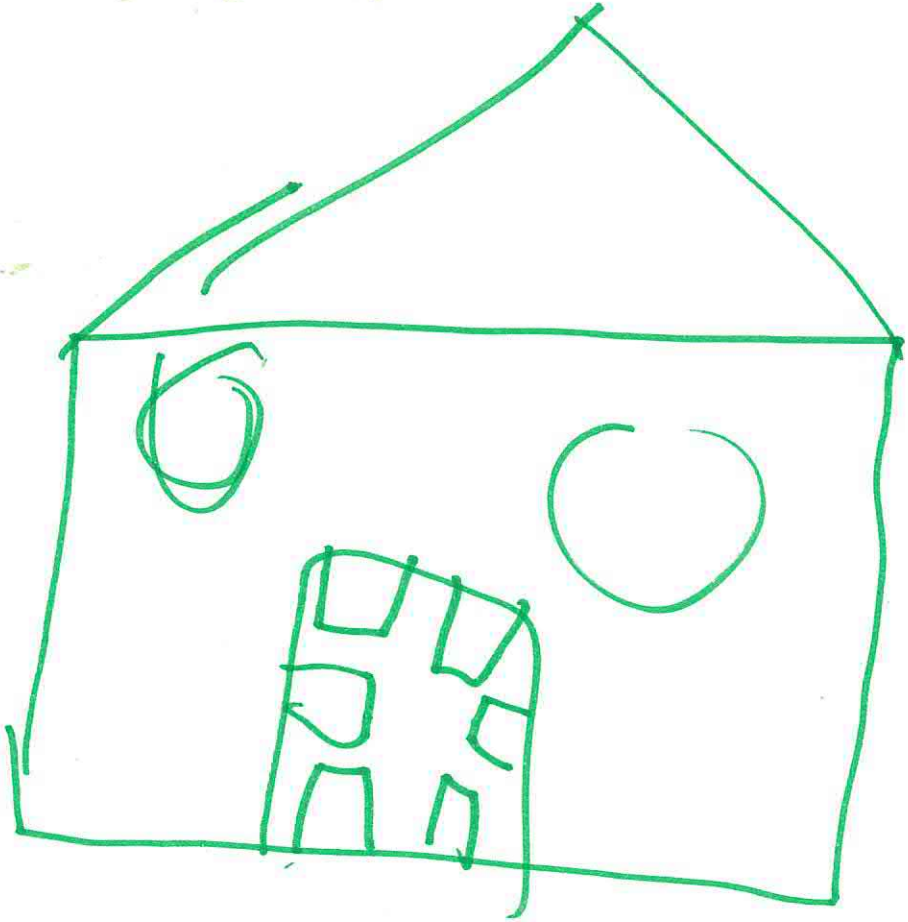

Goodly
nase