

Jeffreys Suction Tank Tree Removal Plan

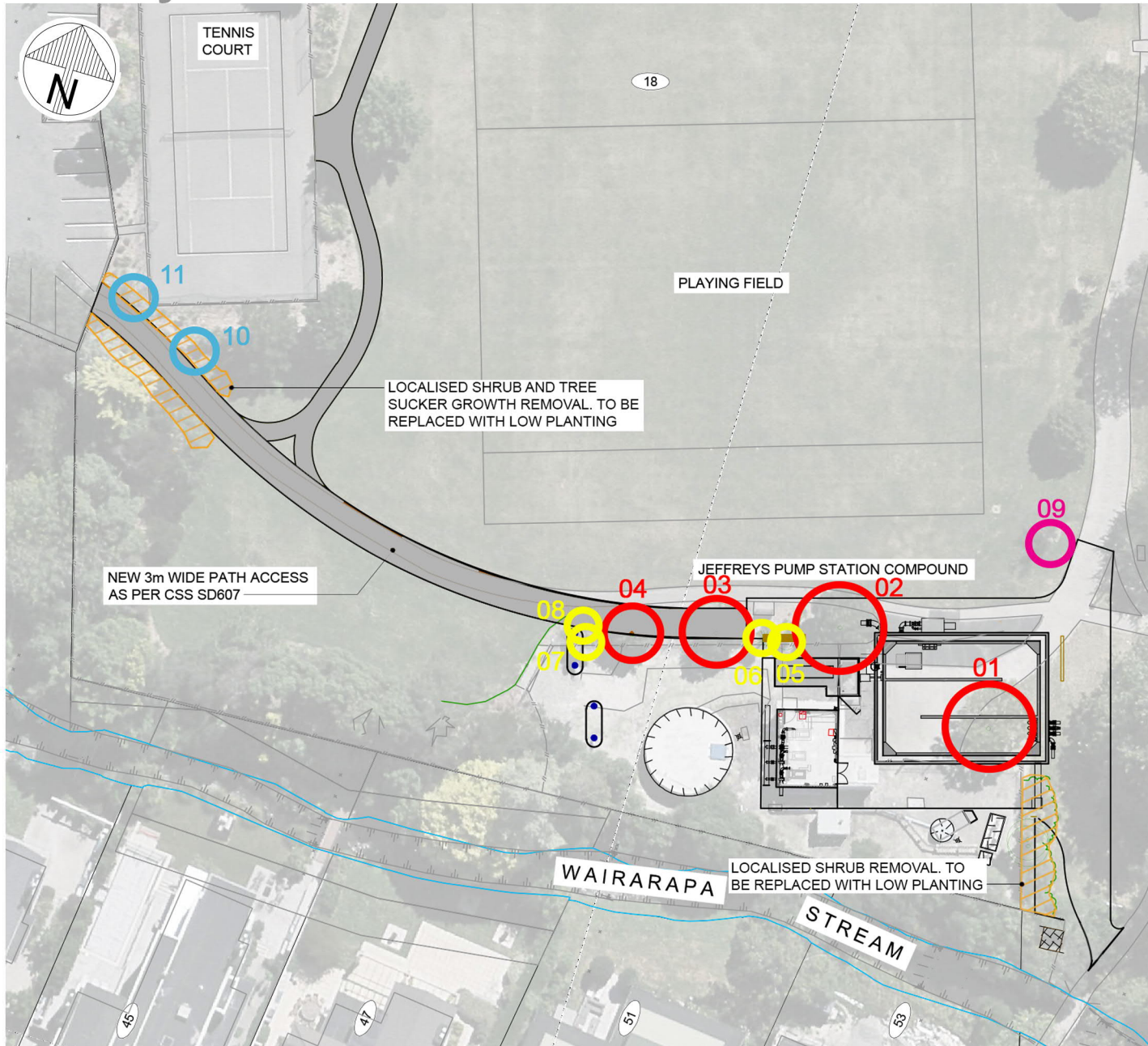

Tree ID	Reason for removal
01	Japanese Zelkova originally identified to be removed, within the building footprint.
02	Hornbeam originally identified to be removed, within the alignment of new pipes and path.
03	Ribbonwood originally identified to be removed, within the alignment of new pipes and path.
04	Hazel originally identified to be removed, within the alignment of new pipes and path.
05	Cabbage Tree to be removed, within the alignment of new pipes and path.
06	Cabbage Tree to be removed, within the alignment of new pipes and path.
07	Cabbage Tree to be removed, within the alignment of new pipes and path.
08	Lancewood to be removed, within the alignment of new pipes and path.
09	Flowering Cherry to be removed for construction access and due to poor condition.
10	Cabbage Tree to be removed and replaced for construction access.
11	Katsura Tree to be removed and replaced for construction access.

* All other existing trees are to be retained.