

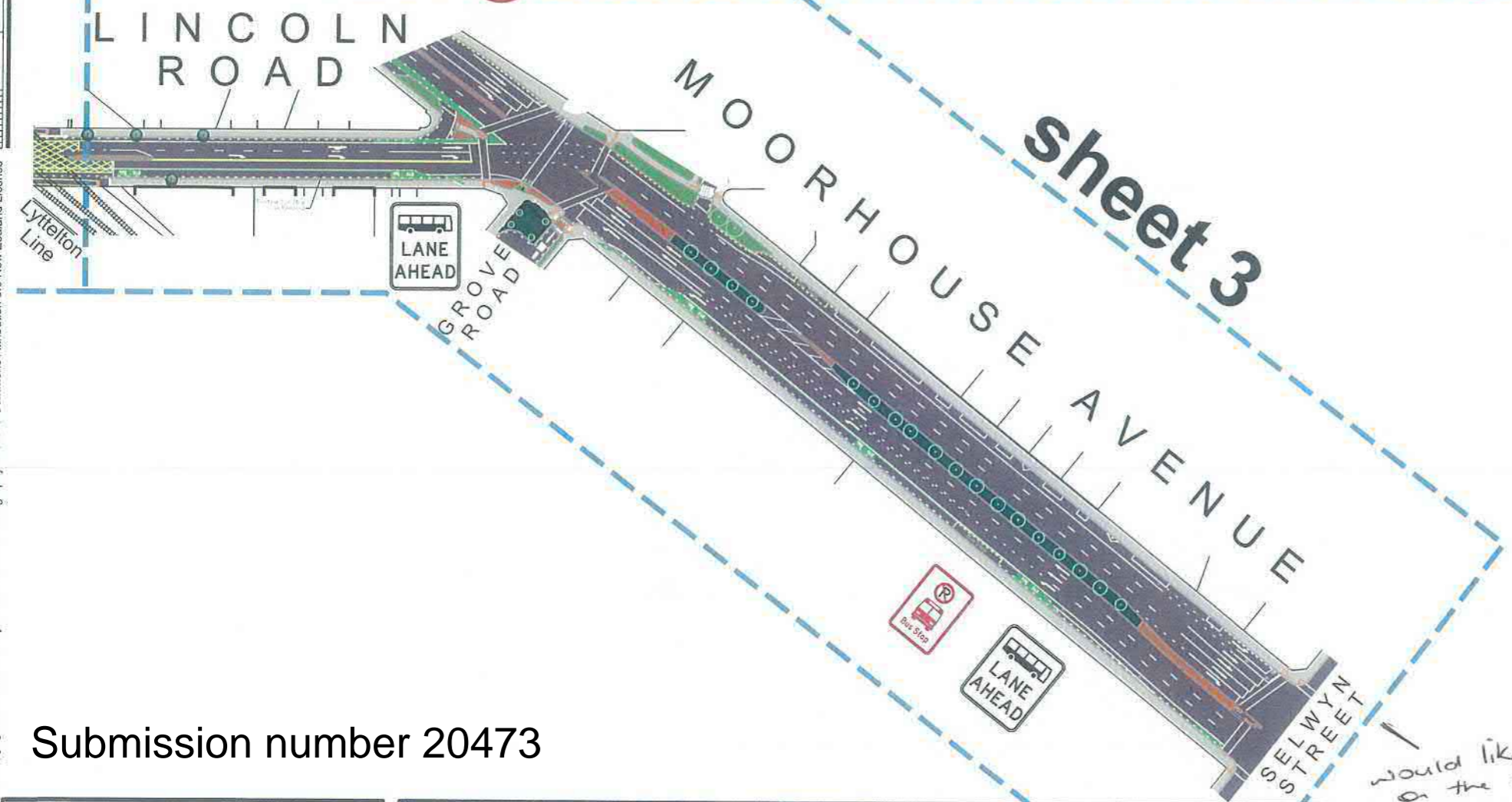

sheet 1

sheet 2

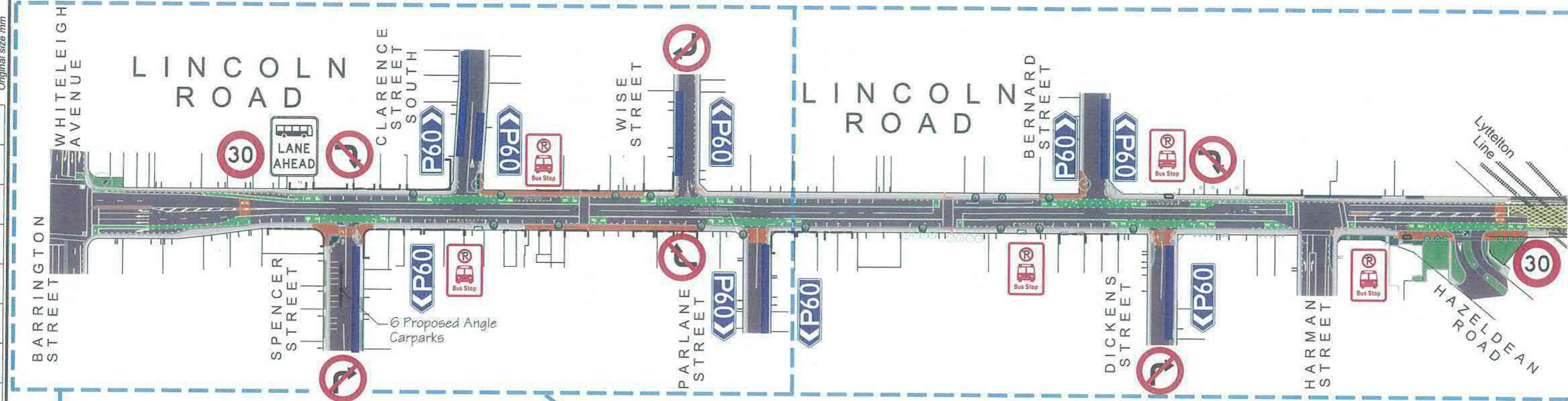

sheet 3

KEY

Parking in Side Street

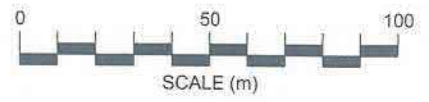

would like to see parking charges on the other side of Selwyn Street - busy turning lane at peak traffic that pushes out cyclists. (By 2 station)

Submission number 20473



Addington Township Overview
 Lincoln Road Bus Priority Curletts Road - Selwyn Street
 Consultation Plan

Original Plan Size: A3
 ISSUE.1 10/09/2018
 TP352401 VMI

Overview 3

Original size mm
 Copyright: Unimashura City Council / Aerial Photography Creative Commons Attribution 3.0 New Zealand License



Original size mm
© Copyright Christchurch City Council / Aerial Photography Creative Commons Attribution 3.0 New Zealand License

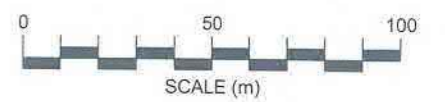
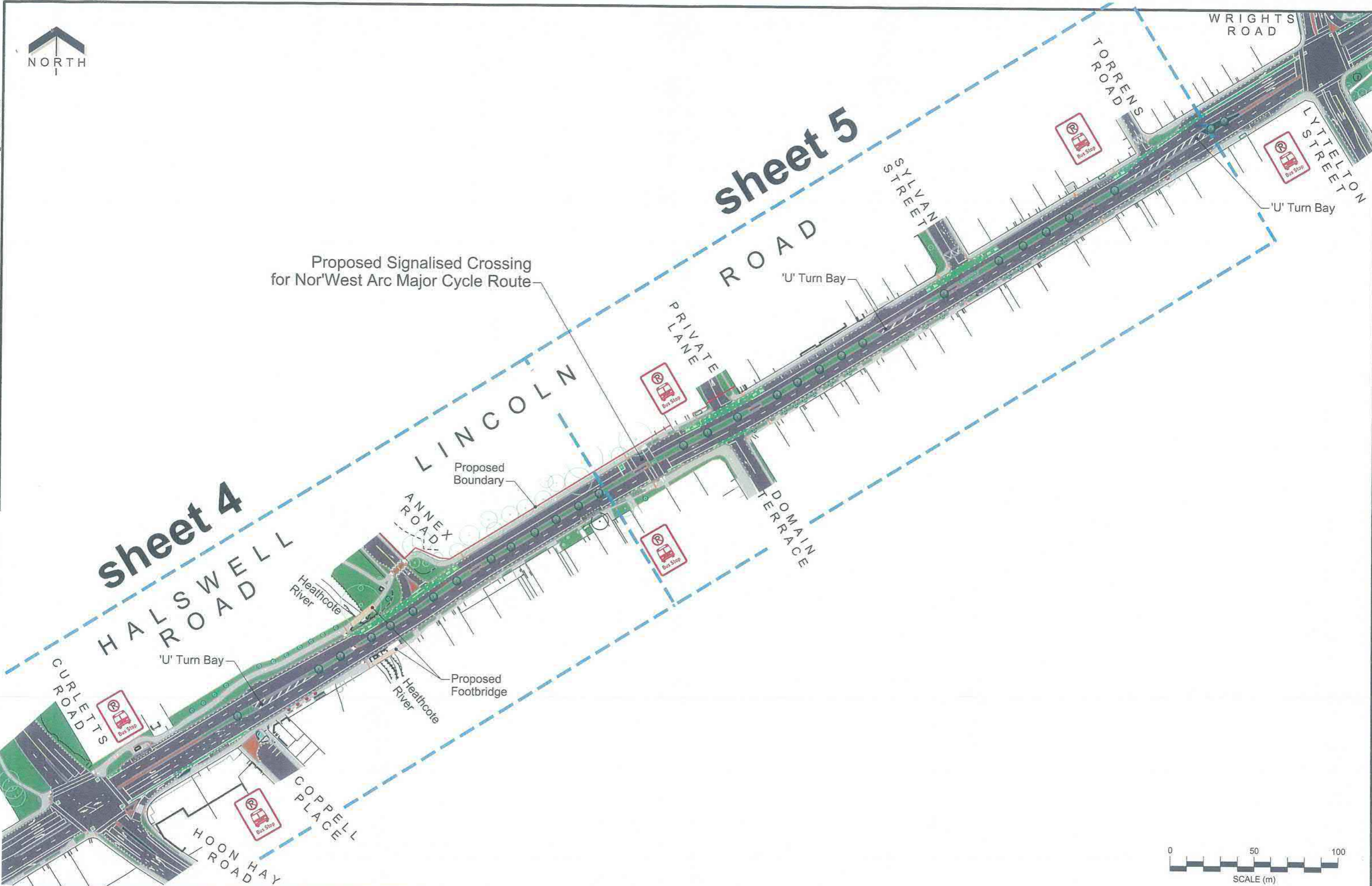

Original size mm

© Copyright Christchurch City Council / Aerial Photography Creative Commons Attribution 3.0 New Zealand License



no cka pedestrian crossing facility.
← radii does not support aligned kerb cut downs: easy path journey. Join Line H
Can this be remedied in the plans? The stages required for Tgsi

WHITELEIGH AVENUE
challenging to be visible for peak.

This will also slow vehicle movements which wait be that noticeable in peak traffic or with the 30 speed limit.

KEY	
	Existing Kerb
	Proposed Kerb
	No Stopping
	Bus Lane
	Grass
	Landscape Planting
	Patterned Surface
	Tactile Paver
	Seat
	Existing Tree
	Proposed Trees:
	Fagus Sylvatica "Dawyc Gold"
	Fashgate Beech



LINCOLN ROAD

CLARENCE STREET SOUTH

BARRINGTON STREET

LINCOLN ROAD

WISE STREET

SPEYER STREET

Join Line I

Join Line J

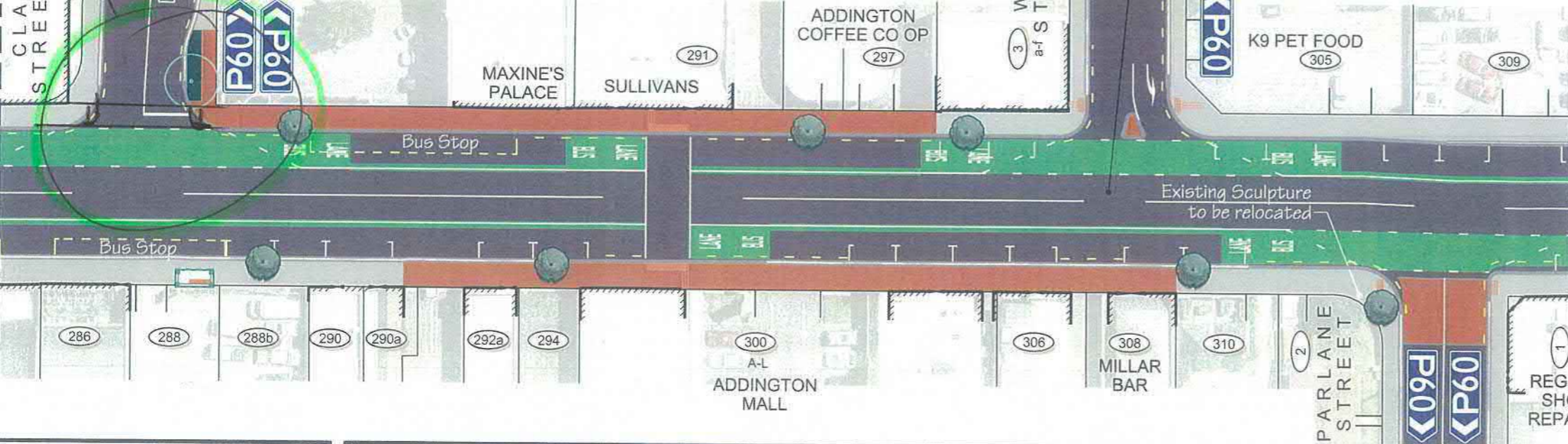

Is this maintaining a detectable kerb either side of the crossing?
Otherwise nothing to alert pedestrians to indent
- Need directional Tgsi as indicated.

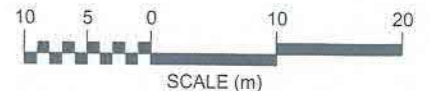



LINCOLN ROAD

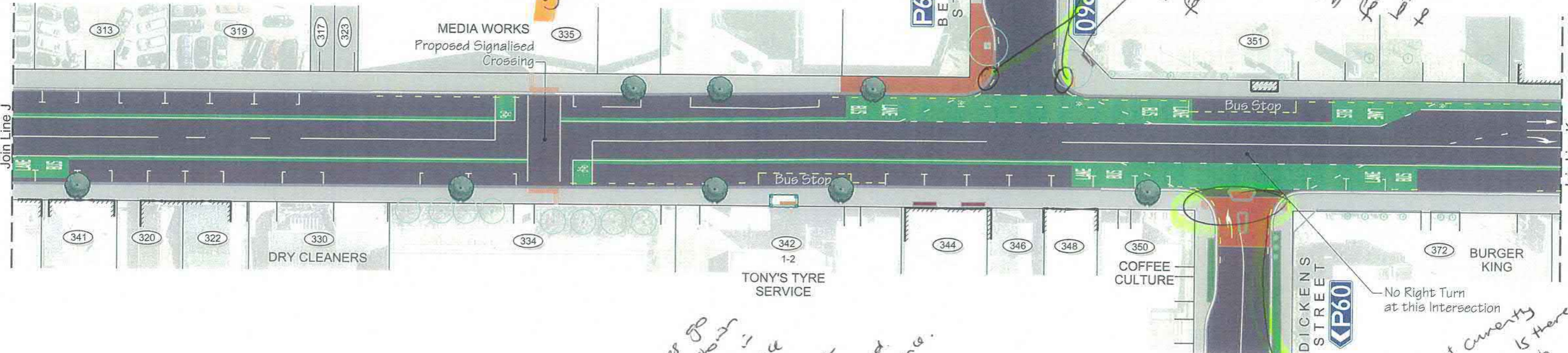

LINCOLN ROAD

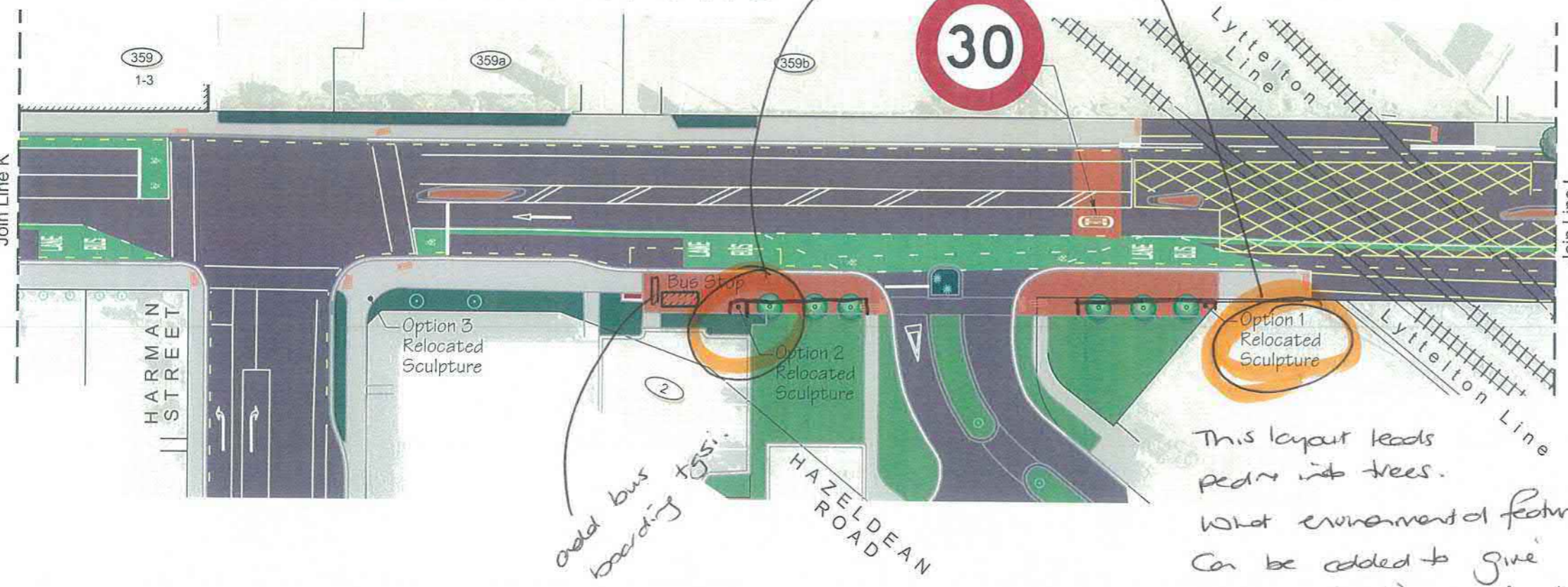

KEY	
	Existing Kerb
	Proposed Kerb
	No Stopping
	Bus Lane
	Grass
	Landscape Planting
	Patterned Surface
	Tactile Paver
	Seat
	Existing Tree
	Proposed Trees:
	Fagus Sylvatica "Dawyc Gold"
	Fashgate Beech
	Podocarpus totara - Totara

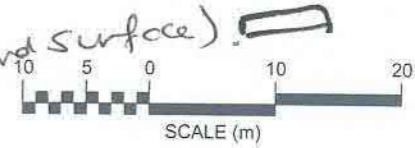

Original size mm
© Copyright Christchurch City Council / Aerial Photography Creative Commons Attribution 3.0 New Zealand License

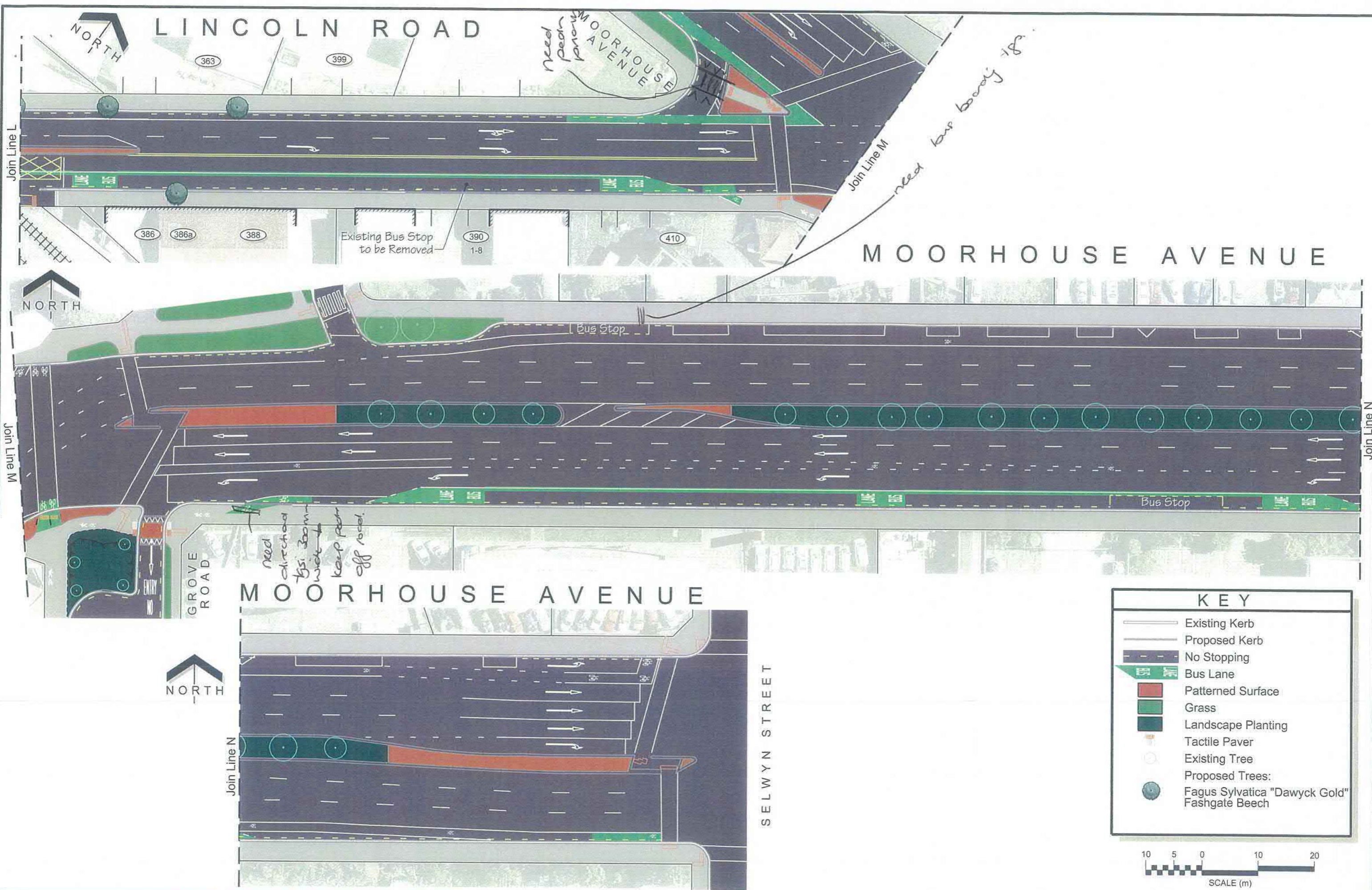

LINCOLN ROAD

MOORHOUSE AVENUE

MOORHOUSE AVENUE

SELWYN STREET

GROVE ROAD

Join Line L

Join Line M

Join Line N

Join Line M

Join Line N

Existing Bus Stop to be Removed

Bus Stop

Bus Stop

need direction sign from west to keep pean off road.

Need pean from Moorhouse Avenue

need low board 180

KEY	
	Existing Kerb
	Proposed Kerb
	No Stopping
	Bus Lane
	Patterned Surface
	Grass
	Landscape Planting
	Tactile Paver
	Existing Tree
	Proposed Trees:
	Fagus Sylvatica "Dawyck Gold"
	Fashgate Beech

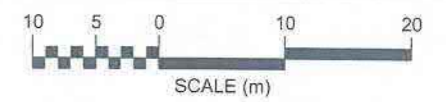

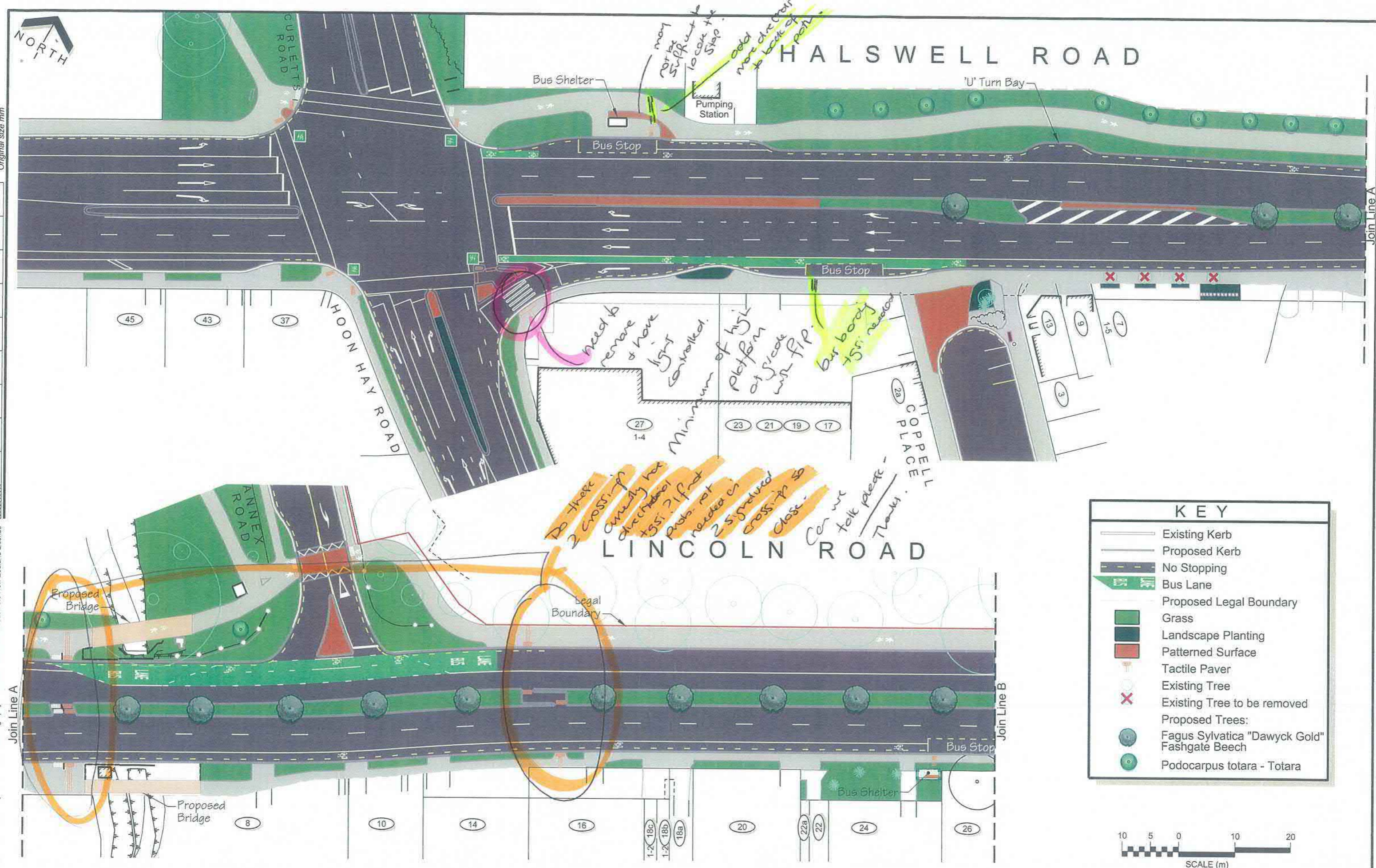

KEY	
	Existing Kerb
	Proposed Kerb
	No Stopping
	Bus Lane
	Proposed Legal Boundary
	Grass
	Landscape Planting
	Patterned Surface
	Tactile Paver
	Existing Tree
	Existing Tree to be removed
	Proposed Trees:
	Fagus Sylvania "Dawyck Gold"
	Fashgate Beech
	Podocarpus totara - Totara

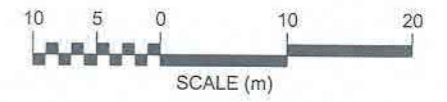



Proposed Signalised Crossing for NorWest Arc Major Cycle Route

Legal Boundary

Private Lane
Legal Boundary

Bus Shelter

Bus Stop

LINCOLN ROAD

Proposed 'U' Turn Bay

P10 | P10 | P10 | P10 | P10 | P10 | P10

DOMAIN TERRACE

LINCOLN ROAD

TORRENS ROAD

Bus Shelter

Bus Stop

Proposed 'U' Turn Bay

KEY

- Existing Kerb
- Proposed Kerb
- No Stopping
- Bus Lane
- Proposed Legal Boundary
- Grass
- Landscape Planting
- Patterned Surface
- Tactile Paver
- Existing Tree
- Existing Tree to be removed
- Proposed Trees:**
- Fagus Sylvatica "Dawyck Gold"
- Fashgate Beech
- Podocarpus totara - Totara

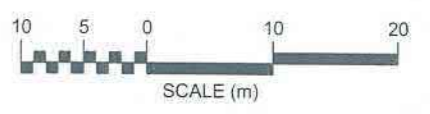

Join Line B

Join Line C

Join Line C

Join Line D

Original size mm

© Copyright Christchurch City Council / Aerial Photography Creative Commons Attribution 3.0 New Zealand License